

**NEW MEXICO OIL CONSERVATION COMMISSION
WELL LOCATION AND ACREAGE DEDICATION PLAT**

Form C-102
Supersedes C-128
Effective 1-1-65

All distances must be from the outer boundaries of the Section.

Operator COQUINA OIL CORP.			Lease CITIES-SERVICE-STATE		Well No. 2
Unit Letter "K"	Section 26	Township 14-S	Range 34-E	County LEA	
Actual Footage Location of Well: <div style="display: flex; justify-content: space-between;"> 1980 feet from the SOUTH line and 1830 feet from the WEST line </div>					
Ground Level Elev. 4078	Producing Formation SAUNDERS LIME	Pool UNDESIGNATED		Dedicated Acreage: 160 Acres	

1. Outline the acreage dedicated to the subject well by colored pencil or hachure marks on the plat below.
2. If more than one lease is dedicated to the well, outline each and identify the ownership thereof (both as to working interest and royalty).
3. If more than one lease of different ownership is dedicated to the well, have the interests of all owners been consolidated by communitization, unitization, force-pooling, etc?

☐ Yes ☐ No If answer is "yes," type of consolidation _____

If answer is "no," list the owners and tract descriptions which have actually been consolidated. (Use reverse side of this form if necessary.) _____

No allowable will be assigned to the well until all interests have been consolidated (by communitization, unitization, forced-pooling, or otherwise) or until a non-standard unit, eliminating such interests, has been approved by the Commission.

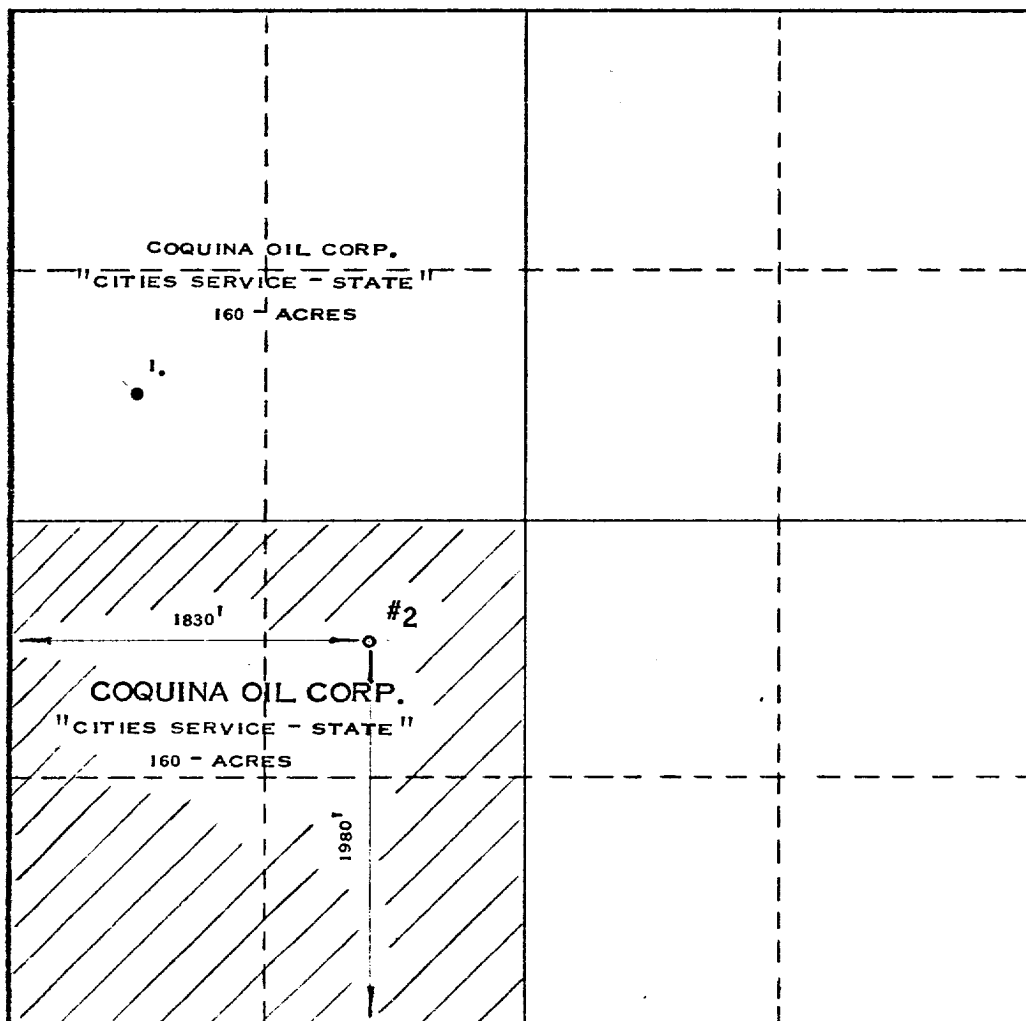

CERTIFICATION

I hereby certify that the information contained herein is true and complete to the best of my knowledge and belief.

Name

Ben D. Gould

Position

Superintendent

Company

Coquina Oil Corporation

Date

September 7, 1973

I hereby certify that the well location shown on this plat was plotted from field notes of actual surveys made by me or under my supervision, and that the same is true and correct to the best of my knowledge and belief.

Date Surveyed

AUGUST 30, 1973

Registered Professional Engineer
and/or Land Surveyor

Max A. Schumann Jr.
MAX A. SCHUMANN JR

Certificate No.

1510

0 330 660 990 1320 1650 1980 2310 2640 2000 1500 1000 500 0

RECEIVED
SEP 10 1973
O. C. C.
ARTESIA, OFFICE