

NEW MEXICO OIL CONSERVATION COMMISSION
WELL LOCATION AND ACREAGE DEDICATION PLAT

Form C-102
Supersedes C-1
Effective 1-1-65

All distances must be from the outer boundaries of the Section.

Operator MWJ PRODUCING COMPANY		Lease Baum 6 Com		Well No. 2
Unit Letter H	Section 6	Township 14 South	Range 33 East	County Lea
Actual Footage Location of Well:				
1980 feet from the North line and		660 feet from the East line		
Ground Level Elev. 4273'	Producing Formation Upper Pennsylvanian	Pool Baum - Upper Penn	Dedicated Acreage: 160.27 Acres	

1. Outline the acreage dedicated to the subject well by colored pencil or hatchure marks on the plat below.
2. If more than one lease is dedicated to the well, outline each and identify the ownership thereof (both as to working interest and royalty).
3. If more than one lease of different ownership is dedicated to the well, have the interests of all owners been consolidated by communitization, unitization, force-pooling, etc?

☒ Yes ☐ No If answer is "yes," type of consolidation Communitization Agreement SW-478

If answer is "no," list the owners and tract descriptions which have actually been consolidated. (Use reverse side of this form if necessary.)

No allowable will be assigned to the well until all interests have been consolidated (by communitization, unitization, forced-pooling, or otherwise) or until a non-standard unit, eliminating such interests, has been approved by the Commission.

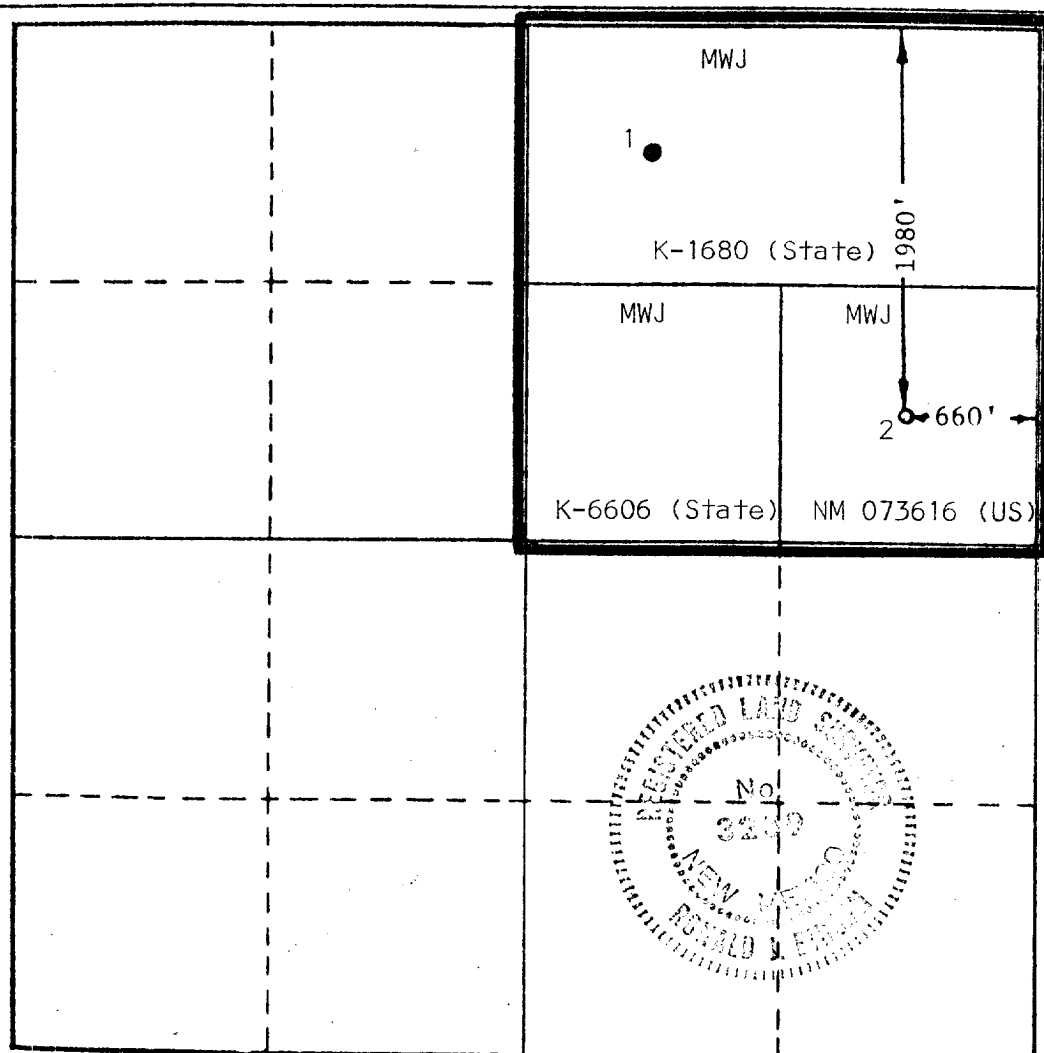

CERTIFICATION

I hereby certify that the information contained herein is true and complete to the best of my knowledge and belief.

James A. Knauf
Name

James A. Knauf

Position
Agent

Company
MWJ PRODUCING COMPANY

Date
August 31, 1983

I hereby certify that the well location shown on this plat was plotted from field notes of actual surveys made by me or under my supervision, and that the same is true and correct to the best of my knowledge and belief.

Date Surveyed

August 30, 1983

Registered Professional Engineer
and/or Land Surveyor

Ronald J. Eidson

Certificate No. JOHN W. WEST 876
- PATRICK A. ROMERO 888
Ronald J. Eidson 323

