

NO. OF COPIES RECEIVED	
DISTRIBUTION	
SANTA FE	
FILE	
U.S.G.S.	
LAND OFFICE	
OPERATOR	

NEW MEXICO OIL CONSERVATION COMMISSION

Form C-101
Revised 1-1-65

5A. Indicate Type of Lease
STATE FEE

5. State Oil & Gas Lease No.

APPLICATION FOR PERMIT TO DRILL, DEEPEN, OR PLUG BACK

1a. Type of Work		7. Unit Agreement Name	
b. Type of Well DRILL <input checked="" type="checkbox"/> DEEPEN <input type="checkbox"/> PLUG BACK <input type="checkbox"/>		8. Farm or Lease Name Johnson	
2. Name of Operator Leede and Pine		9. Well No. 1-Y	
3. Address of Operator 516 Building of the Southwest, Midland, Texas 79701		10. Field and Pool, or Wildcat Wildcat	
4. Location of Well UNIT LETTER <u>0</u> LOCATED <u>635</u> FEET FROM THE <u>South</u> LINE AND <u>1980</u> FEET FROM THE <u>East</u> LINE OF SEC. <u>20</u> TWP. <u>1-N</u> RGE. <u>35-E</u> NMPM		12. County Roosevelt	
		19. Proposed Depth 7500'	19A. Formation Montoya
		20. Rotary or C.T. Rotary	
21. Elevations (Show whether DF, RT, etc.) 4142.5 GR	21A. Kind & Status Plug. Bond Blanket	21B. Drilling Contractor Tri-Service	22. Approx. Date Work will start 12-6-72

23.

PROPOSED CASING AND CEMENT PROGRAM

SIZE OF HOLE	SIZE OF CASING	WEIGHT PER FOOT	SETTING DEPTH	SACKS OF CEMENT	EST. TOP
17"	12 3/4"	34	± 350	350	Circ.
11"	8 5/8"	24 & 28	± 3200	260	± 2200
7 7/8"	4 1/2"	10.5 & 11.6	± 7500	265	± 5800

Propose to drill a Montoya wildcat test using rotary tools to approximately 7500'. Cement will be circulated on the surface casing, intermediate will be set into the San Andres. Plan to test all significant shows and run BHC Acoustilog, GR-Caliper, Focused Dual Induction Log and Epithermal Sidewall Neutron Logs at intermediate and total depth. Completion or abandonment will be performed in accordance with prudent practices and regulatory body requirements. Will use double ram 900 series BOP from surface casing to total depth.

APPROVAL VALID
FOR 90 DAYS UNLESS
DRILLING COMMENCED,

EXPIRES 3-8-73

IN ABOVE SPACE DESCRIBE PROPOSED PROGRAM; IF PROPOSAL IS TO DEEPEN OR PLUG BACK, GIVE DATA ON PRESENT PRODUCTIVE ZONE AND PROPOSED NEW PRODUCTIVE ZONE. GIVE BLOWOUT PREVENTER PROGRAM, IF ANY.

I hereby certify that the information above is true and complete to the best of my knowledge and belief.

Signed [Signature] Title Agent Date 12-4-72

(This space for State Use)

APPROVED BY [Signature] TITLE SUPERVISOR DISTRICT I DATE DEC 8 1972

CONDITIONS OF APPROVAL, IF ANY:

NEW MEXICO OIL CONSERVATION COMMISSION
WELL LOCATION AND ACREAGE DEDICATION PLAT

Form 1-1-71
Supersedes O-128
Revised 1965

All distances must be from the outer boundaries of the Section

Operator LEEDE & PINE			Lease JOHNSON			Section 1-Y		
Section Letter O	Section 20	Township 1 NORTH	Range 35 EAST	County ROOSEVELT				
Actual Final Location of Well:								
1980 feet from the EAST line and			635 feet from the SOUTH line					
Ground Level Elevation 4142.5'		Formulating Formation Montoya			Rock Wildcat		Section 40	

1. Outline the acreage dedicated to the subject well by colored pencil or hachure marks on the plat below.
2. If more than one lease is dedicated to the well, outline each and identify the ownership thereof (that is to working interest and royalty)
3. If more than one lease of different ownership is dedicated to the well, have the interests of all owners been consolidated by communitization, unitization, force-pooling, etc?

Yes No If answer is "yes," type of consolidation _____

If answer is "no" list the owners and tract descriptions which have actually been consolidated (use reverse side of this form if necessary.) _____

No allowable will be assigned to the well until all interests have been consolidated (by communitization, unitization, forced-pooling, or otherwise) or until a non-standard unit, eliminating such interests, has been approved by the Commission.

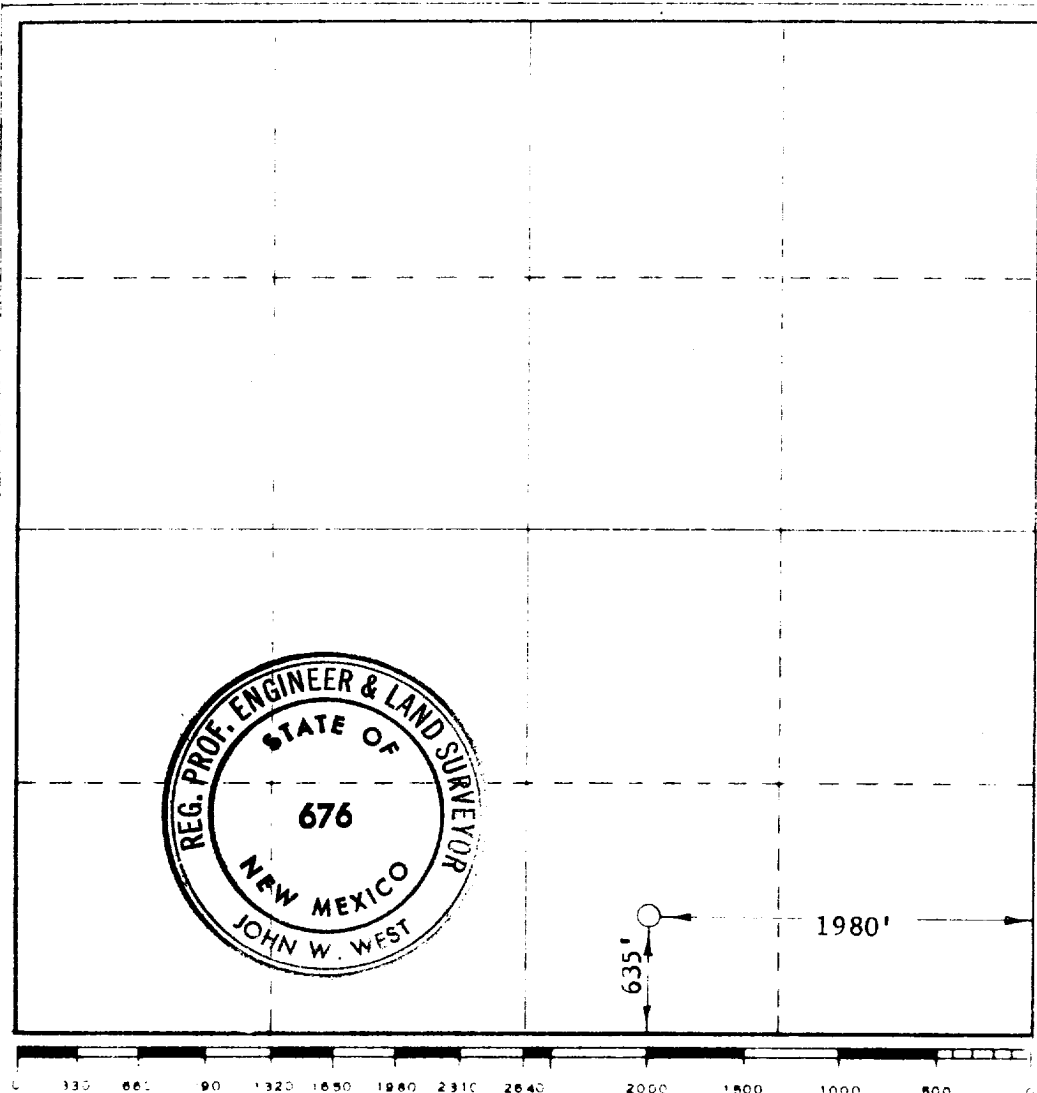

CERTIFICATION

I hereby certify that the information contained herein is true and complete to the best of my knowledge and belief.

Foy W. Boyd, Jr.

Foy W. Boyd, Jr.

Agent

12-5-72

I hereby certify that the well location shown on this plat was plotted from field notes of actual surveys made by me or under my supervision and that the same is true and correct to the best of my knowledge and belief.

JULY 11, 1972

John W. West

676

173

RECEIVED

1932

THE CONSERVATION SOCIETY
100 N. 10th St.