

| | |
|------------------------|-----|
| NUMBER OF COPIES REC'D | D |
| DISTRICT | N |
| SANTA FE | |
| FILE | |
| U.S.G.S. | |
| LAND OFFICE | |
| TRANSPORTER | OIL |
| | GAS |
| PRORATION OFFICE | |
| OPERATOR | |

NEW MEXICO OIL CONSERVATION COMMISSION
WELL LOCATION AND ACREAGE DEDICATION PLAT
 SEE INSTRUCTIONS FOR COMPLETING THIS FORM ON THE REVERSE SIDE

FORM C-128
 Revised 5/1/57

1962 MAY 10 PM 2:35
 11888 OFFICE 000

| | | | | |
|---|--|--|---------------------------------------|-------------------------|
| SECTION A | | | | |
| Operator Union Oil Company of California | | Lease North Anderson Ranch Unit | | Well No. 4-32 |
| Unit Letter I | Section 32 | Township 15-S | Range 32-E | County Lea |
| Actual Footage Location of Well: 2310 feet from the south line and 330 feet from the east line | | | | |
| Ground Level Elev. 4315' | Producing Formation Wolfcamp | Pool North Anderson Ranch Wolfcamp | Dedicated Acreage: 80 Acres | |

1. Is the Operator the only owner in the dedicated acreage outlined on the plat below? YES _____ NO X. ("Owner" means the person who has the right to drill into and to produce from any pool and to appropriate the production either for himself or for himself and another. (65-3-29 (e) NMSA 1935 Comp.)
2. If the answer to question one is "no," have the interests of all the owners been consolidated by communitization agreement or otherwise? YES X NO _____. If answer is "yes," Type of Consolidation Communitization agreement
3. If the answer to question two is "no," list all the owners and their respective interests below:

| Owner | Land Description |
|-------|------------------|
| | |

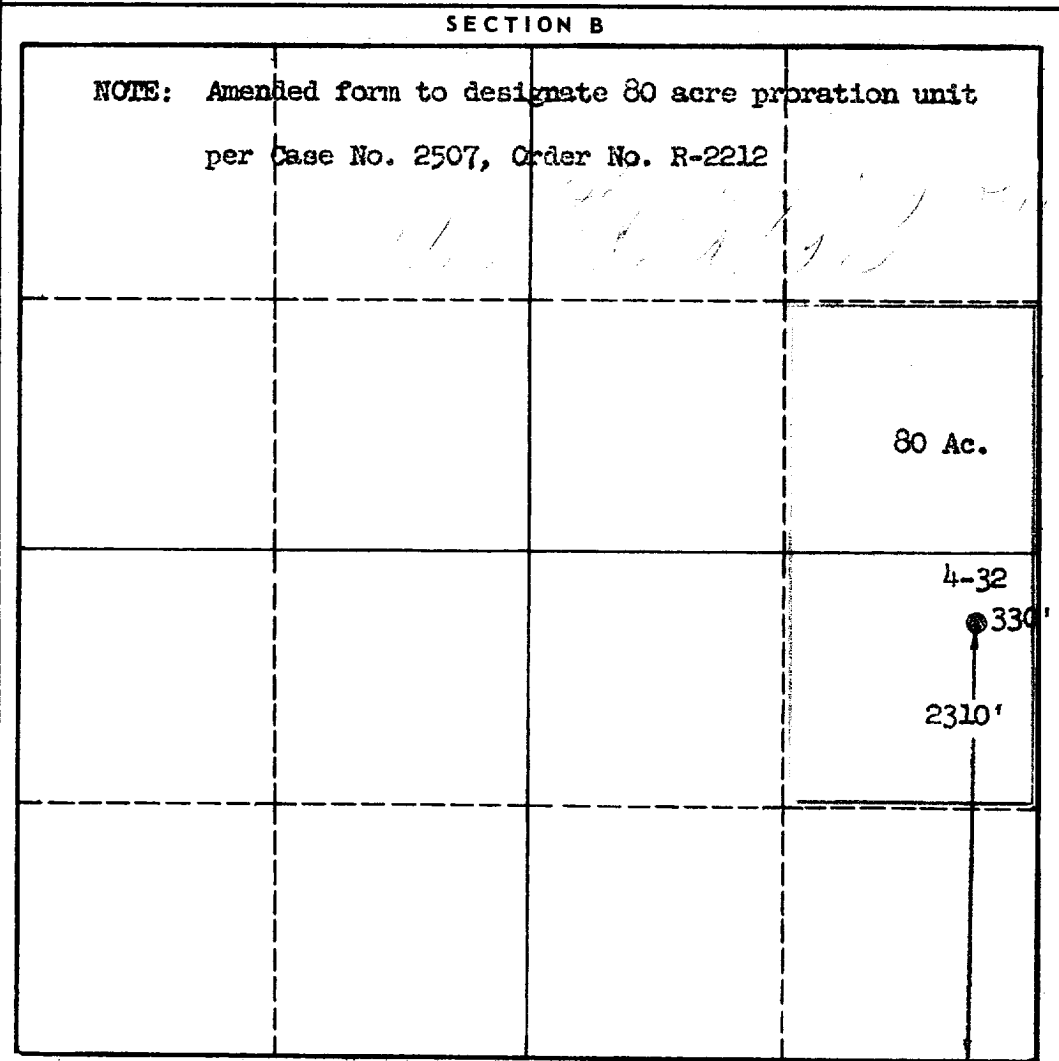

CERTIFICATION

I hereby certify that the information in SECTION A above is true and complete to the best of my knowledge and belief.

Name Gene Smith

Position **Production Clerk**

Company **Union Oil Co. of Calif.**

Date **May 9, 1962**

I hereby certify that the well location shown on the plat in SECTION B was plotted from field notes of actual surveys made by me or under my supervision, and that the same is true and correct to the best of my knowledge and belief.

Date Surveyed _____

Registered Professional Engineer and/or Land Surveyor _____

Certificate No. _____

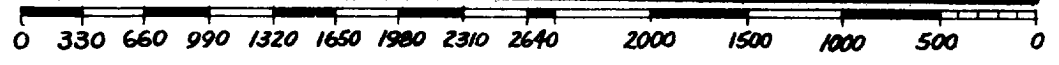

INSTRUCTIONS FOR COMPLETION OF FORM C-128

1. Operator shall furnish and certify to the information called for in Section A.
2. Operator shall outline the dedicated acreage for *both* oil and gas wells on the plat in Section B.
3. A registered professional engineer or land surveyor registered in the State of New Mexico or approved by the Commission shall show on the plat the location of the well and certify this information in the space provided.
4. All distances shown on the plat must be from the outer boundaries of the Section.
5. If additional space is needed for listing owners and their respective interests as required in question 3 of Section A, please use space below.