

(SUBMIT IN TRIPLICATE)

UNITED STATES
DEPARTMENT OF THE INTERIOR
GEOLOGICAL SURVEY

Field Office

Las Cruces

Lease No.

039576

Unit

RECEIVED

NOV 2 1960

SUNDRY NOTICES AND REPORTS ON WELLS

O. D. G.
ARTESIA

NOTICE OF INTENTION TO DRILL		SUBSEQUENT REPORT OF WATER SHUT-OFF	
NOTICE OF INTENTION TO CHANGE PLANS	<input checked="" type="checkbox"/>	SUBSEQUENT REPORT OF SHOOTING OR ACIDIZING	
NOTICE OF INTENTION TO TEST WATER SHUT-OFF		SUBSEQUENT REPORT OF ALTERING CASING	
NOTICE OF INTENTION TO RE-DRILL OR REPAIR WELL		SUBSEQUENT REPORT OF RE-DRILLING OR REPAIR	
NOTICE OF INTENTION TO SHOOT OR ACIDIZE		SUBSEQUENT REPORT OF ABANDONMENT	
NOTICE OF INTENTION TO PULL OR ALTER CASING		SUPPLEMENTARY WELL HISTORY	
NOTICE OF INTENTION TO ABANDON WELL			

(INDICATE ABOVE BY CHECK MARK NATURE OF REPORT, NOTICE, OR OTHER DATA)

October 27, 1960

Well No. 115-2-12 is located 1900 ft. from $\begin{bmatrix} N \\ S \end{bmatrix}$ line and 660 ft. from $\begin{bmatrix} E \\ W \end{bmatrix}$ line of sec. 4

XXXX

NE 1/4 of Sec. 4 (1/4 Sec. and Sec. No.) 17 (Twp.) 32 (Range) N 28° E (Meridian)
Beljaire (Field) 100 (County or Subdivision) New Mexico (State or Territory)

The elevation of the derrick floor above sea level is 2171 ft. (G.L.)

DETAILS OF WORK

(State names of and expected depths to objective sands; show sizes, weights, and lengths of proposed casings; indicate mudding jobs, cementing points, and all other important proposed work)

2 5/8" casing 300 feet Circulate cement
 5 1/2" casing 4000 feet 450 sacks cement
 Drill with rotary from top to bottom
 approximately 4000 feet Grayburg formation.

RECEIVED

OCT 28 1960

U. S. GEOLOGICAL SURVEY
ARTESIA, NEW MEXICO

I understand that this plan of work must receive approval in writing by the Geological Survey before operations may be commenced.

Company Diller and Nichols

Address Beljaire, N.M.

By C. F. Mott

Title

NEW MEXICO OIL CONSERVATION COMMISSION
WELL LOCATION AND ACREAGE DEDICATION PLAT

FORM C-128
 Revised 5/1/57

SEE INSTRUCTIONS FOR COMPLETING THIS FORM ON THE REVERSE SIDE

SECTION A

Operator <i>Baller + Nichols</i>			Lease <i>Iles</i>		13 Well No. <i>14</i>
Unit Letter <i>I</i>	Section <i>4</i>	Township <i>17 South</i>	Range <i>32 East</i>	County <i>Lea</i>	
Actual Footage Location of Well: <i>1980</i> feet from the <i>South</i> line and <i>660</i> feet from the <i>East</i> line					
Ground Level Elev. <i>4171</i>	Producing Formation		Pool		Dedicated Acreage: <i>40</i> Acres

1. Is the Operator the only owner in the dedicated acreage outlined on the plat below? YES _____ NO _____. ("Owner" means the person who has the right to drill into and to produce from any pool and to appropriate the production either for himself or for himself and another. (65-3-29 (e) NMSA 1935 Comp.)
2. If the answer to question one is "no," have the interests of all the owners been consolidated by communitization agreement or otherwise? YES _____ NO _____. If answer is "yes," Type of Consolidation _____
3. If the answer to question two is "no," list all the owners and their respective interests below:

RECEIVED

Owner <i>Baller + Nichols</i>	Land Description	OCT 28 1960 U. S. GEOLOGICAL SURVEY ARTESIA, NEW MEXICO
-------------------------------	------------------	---

SECTION B

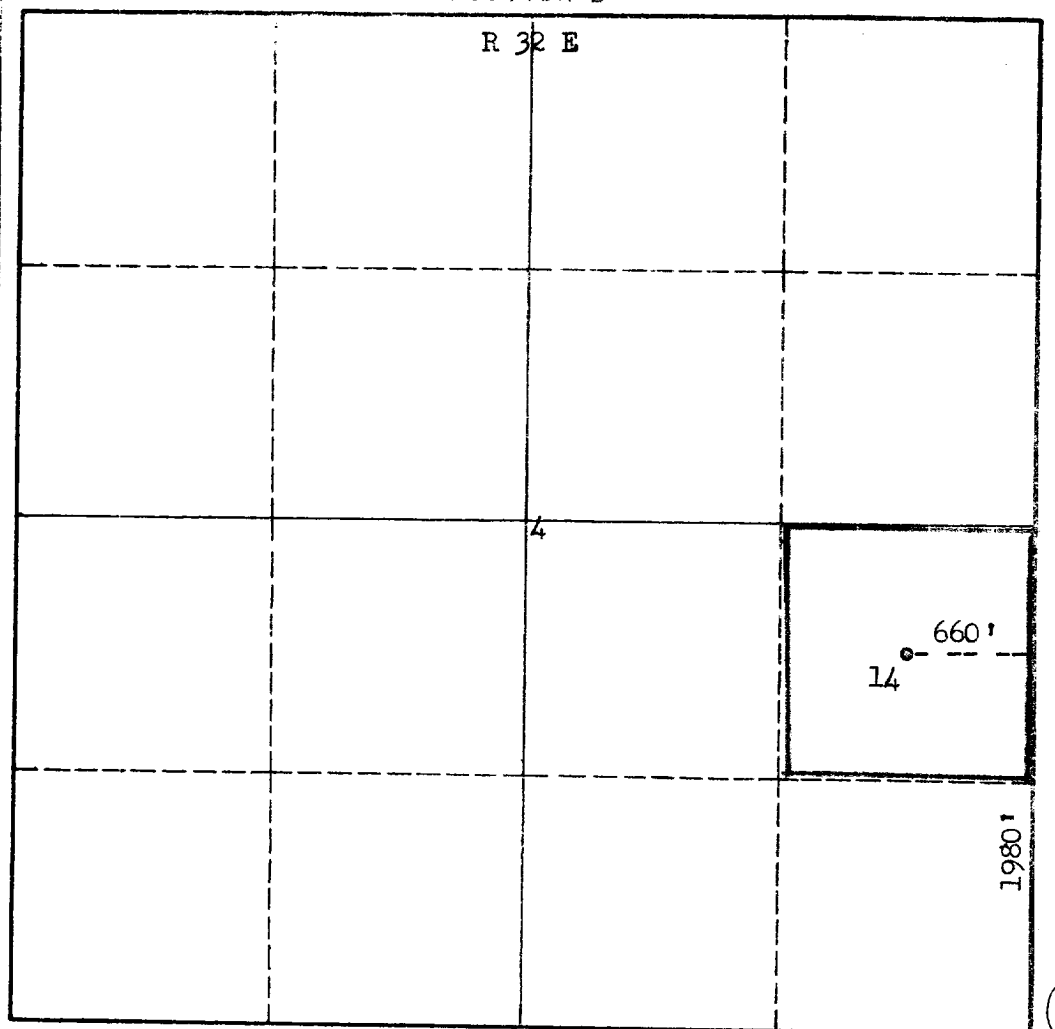

CERTIFICATION

I hereby certify that the information in SECTION A above is true and complete to the best of my knowledge and belief.

<i>D. L. McCutcheon</i>
Name
<i>supt.</i>
Position
<i>Baller + Nichols</i>
Company
<i>11-26-1960</i>
Date

I hereby certify that the well location shown on the plat in SECTION B was plotted from field notes of actual surveys made by me or under my supervision, and that the same is true and correct to the best of my knowledge and belief.

Date Surveyed
<i>July 25, 1960</i>
Registered Professional Engineer and/or Land Surveyor
<i>James H. Brown</i>
Certificate No.
<i>N.M.L.S. No. 542</i>

0 330 660 990 1320 1650 1980 2310 2640 2000 1500 1000 500 0

T
17
S

INSTRUCTIONS FOR COMPLETION OF FORM C-128

1. Operator shall furnish and certify to the information called for in Section A.
2. Operator shall outline the dedicated acreage for *both* oil and gas wells on the plat in Section B.
3. A registered professional engineer or land surveyor registered in the State of New Mexico or approved by the Commission shall show on the plat the location of the well and certify this information in the space provided.
4. All distances shown on the plat must be from the outer boundaries of the Section.
5. If additional space is needed for listing owners and their respective interests as required in question 3 of Section A, please use space below.