

(SUBMIT IN TRIPLICATE)

Land Office Las Cruces  
Lease No. 029509a  
Unit Lease

UNITED STATES  
DEPARTMENT OF THE INTERIOR  
GEOLOGICAL SURVEY

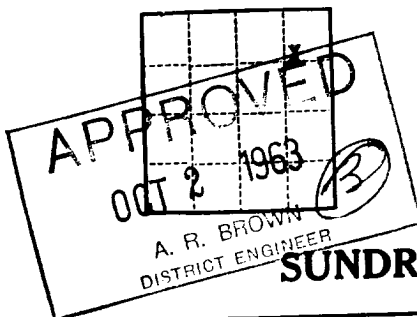

SUNDRY NOTICES AND REPORTS ON WELLS

NOTICE OF INTENTION TO DRILL	<input checked="" type="checkbox"/>	SUBSEQUENT REPORT OF WATER SHUT-OFF	
NOTICE OF INTENTION TO CHANGE PLANS		SUBSEQUENT REPORT OF SHOOTING OR ACIDIZING	
NOTICE OF INTENTION TO TEST WATER SHUT-OFF		SUBSEQUENT REPORT OF ALTERING CASING	
NOTICE OF INTENTION TO RE-DRILL OR REPAIR WELL		SUBSEQUENT REPORT OF RE-DRILLING OR REPAIR	
NOTICE OF INTENTION TO SHOOT OR ACIDIZE		SUBSEQUENT REPORT OF ABANDONMENT	
NOTICE OF INTENTION TO PULL OR ALTER CASING		SUPPLEMENTARY WELL HISTORY	
NOTICE OF INTENTION TO ABANDON WELL			

(INDICATE ABOVE BY CHECK MARK NATURE OF REPORT, NOTICE, OR OTHER DATA)

Baish "A"

October 2, 1963

Well No. 10 is located 990 ft. from [N] line and 980 ft. from [E] line of sec. 21

NE 1/4 NE 1/4 Sec. 21 17S 32E NMPH  
(1/4 Sec. and Sec. No.) (Twp.) (Range) (Meridian)  
Baish Lea New Mexico  
(Field) (County or Subdivision) (State or Territory)

The elevation of the derrick floor above sea level is NA ft.

DETAILS OF WORK

(State names of and expected depths to objective sands; show sizes, weights, and lengths of proposed casings; indicate mudding jobs, cementing points, and all other important proposed work)

On September 24, 1963, this office forwarded a form 9-331a requesting permission to drill and equip a water injection well, Baish "A" No. 10, at a location of 990' FNL and 990' FEL, Sec. 21-17S-32E. The requested location was partially covered by a hill which would require a large expenditure to level.

Permission is requested to move the location of this well 10' eastward as shown on attached plat.

I understand that this plan of work must receive approval in writing by the Geological Survey before operations may be commenced.

Company Continental Oil Company

Address Box 460

Hobbs, New Mexico

By J. A. Green  
Title Asst. Dist. Superintendent

NEW MEXICO OIL CONSERVATION COMMISSION  
WELL LOCATION AND ACREAGE DEDICATION PLAT

Form G-100  
Revised 5/1/57

SEE INSTRUCTIONS FOR COMPLETING THIS FORM ON THE REVERSE SIDE

SECTION A

Operator <b>CONTINENTAL OIL COMPANY</b>			Lease <b>BAISH "A"</b>		Well No. <b>BAISH 10</b>
Unit Letter <b>A</b>	Section <b>21</b>	Township <b>17 SOUTH</b>	Range <b>32 EAST</b>	County <b>LEA</b>	
Actual Postage Location of Well: <b>990</b> feet from the <b>NORTH</b> line and <b>990</b> feet from the <b>EAST</b> line					
Ground Level Elev.	Producing Formation <b>Yates</b>		Pool <b>BAISH</b>	Dedicated Acreage: Acres	

1. Is the Operator the only owner in the dedicated acreage outlined on the plat below? YES ☒ NO \_\_\_\_ . ("Owner" means the person who has the right to drill into and to produce from any pool and to appropriate the production either for himself or for himself and another. (65-3-29 (c) NMSA 1935 Comp.)
2. If the answer to question one is "no," have the interests of all the owners been consolidated by communitization agreement or otherwise? YES \_\_\_\_ NO \_\_\_\_ . If answer is "yes," Type of Consolidation \_\_\_\_
3. If the answer to question two is "no," list all the owners and their respective interests below:

Owner	Land Description

SECTION B

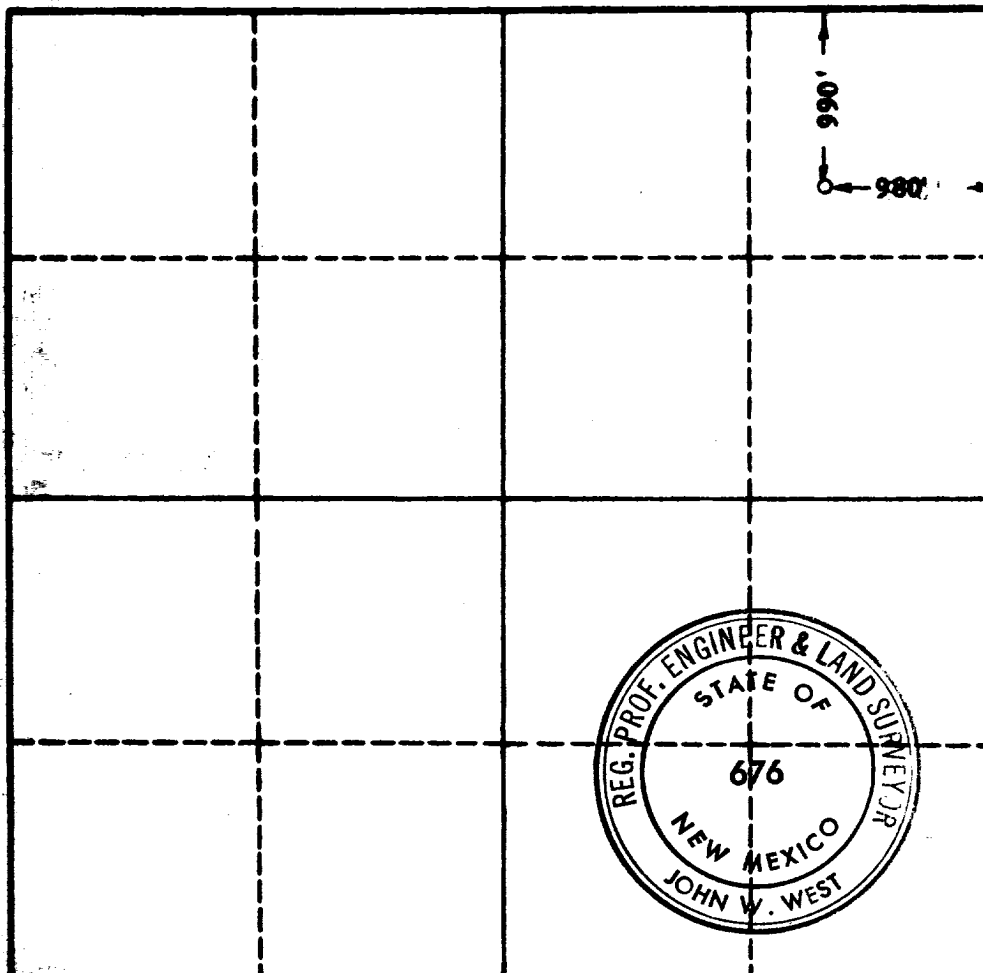

CERTIFICATION

I hereby certify that the information in SECTION A above is true and complete to the best of my knowledge and belief.

Name *J. A. Sullivan*  
Position *Asst. Dist. Supt.*  
Company *Continental Oil Company*  
Date *10-2-63*

I hereby certify that the well location shown on the plat in SECTION B was plotted from field notes of actual surveys made by me or under my supervision, and that the same is true and correct to the best of my knowledge and belief.

Date Surveyed *9-17-1963*  
Registered Professional Engineer and/or Land Surveyor, *JOHN W. WEST*  
Signature *John W. West*  
Certificate No. *N.M. - P.E. & L.S. NO. 676*

0 500 600 990 1020 1400 1800 2200 2600 3000 3400 3800 4200 4600 5000

