

30-025-29667

NO. OF COPIES RECEIVED	
DISTRIBUTION	
SANTA FE	
FILE	
G.S.	
LAND OFFICE	
OPERATOR	

NEW MEXICO OIL CONSERVATION COMMISSION

Form C-101
Revised 1-4-85

*Amended to change location.

5A. Indicate Type of Lease STATE <input checked="" type="checkbox"/> FEE <input type="checkbox"/>
5. State Oil & Gas Lease No. E-2929
7. Unit Agreement Name
8. Form or Lease Name New Mexico AP State
9. Well No. 2
10. Field and Pool, or Wildcat Undersig. Dean Permo-Pennsylvanian
12. County Lea

APPLICATION FOR PERMIT TO DRILL, DEEPEN, OR PLUG BACK

1a. Type of Well: DRILL DEEPEN PLUG BACK

b. Type of Well: OIL WELL GAS WELL OTHER
SINGLE ZONE MULTIPLE ZONE

2. Name of Operator: Exxon Corporation Attn: Melba Knippling

3. Address of Operator: P. O. Box 4600, Midland, TX 79702

4. Location of Well: UNIT LETTER F LOCATED 1895 FEET FROM THE North LINE
AND 2141 FEET FROM THE West LINE OF SEC. 36 TWP. 15S RGE. 36E NMPM

19. Proposed Depth: 11,800' 19A. Formation: Strawn 20. Rotary or C.T.: Rotary

21. Elevations (Show whether DF, RT, etc.): 3843' GR 21A. Kind & Status Plug. Bond: Blanket 21B. Drilling Contractor: Unknown 22. Approx. Date Work will start: 4-30-86

PROPOSED CASING AND CEMENT PROGRAM

SIZE OF HOLE	SIZE OF CASING	WEIGHT PER FOOT	SETTING DEPTH	SACKS OF CEMENT	EST. TOP
17 1/2	13 3/8	54.5	400	400	Surface
11 or 12 1/4	8 5/8	24, 32	4400	1200	Surface
7 7/8	5 1/2	15.5, 17, 20	11800	900	4400

Mud Program.

- 0 - 400 Spud-FW
- 400 - 4400 SBW (10.0 ppg)
- 4400-11400 FW (8.4-8.8 ppg)
- 11400-11800 FWM (8.8 - 9.3 ppg)

BOP Program

- 13 3/8" casing SA-Diverter
- 8 5/8" casing RRA-3000 psi
- Cement
- 400 sx 'c' w/2% CaCl₂ WOC 8 hrs. - Surface Casing
- 950 sx 'c' w/10% gel
- 250 sx 'c' Neat WOC 8 hrs. - Intermediate Casing

Permit Expires 6 Months From Approval
Date Unless Drilling Underway.

Diagrammatic sketch and specifications of BOP are attached.

ABOVE SPACE DESCRIBE PROPOSED PROGRAM; IF PROPOSAL IS TO DEEPEN OR PLUG BACK, GIVE DATA ON PRESENT PRODUCTIVE ZONE AND PROPOSED NEW PRODUCTIVE ZONE. GIVE BLOWOUT PREVENTER PROGRAM, IF ANY.

I hereby certify that the information above is true and complete to the best of my knowledge and belief.

Melba Knippling
(This space for State Use)

Title Section Head Date 4-29-86

Eddie W. Seay

APPROVED BY Oil & Gas Inspector TITLE DATE APR 30 1986

CONDITIONS OF APPROVAL, IF ANY:

RECEIVED
APR 30 1986
C.C.C.
HOBBY OFFICE

Exxon Lse. No. _____

NEW MEXICO OIL CONSERVATION COMMISSION

Form C-102
Supersedes C-128
Effective 1-1-65

State Lse. No. _____

WELL LOCATION AND ACREAGE DEDICATION PLAT

Federal Lse. No. _____

All distances must be from the outer boundaries of the Section.

Operator Exxon Corporation		Lease N.M. "AP" STATE		Well No. 2
Unit Letter F	Section 36	Township 15 S	Range 36 E	County LEA
Actual Footage Location of Well: 1895 feet from the NORTH line and 2141 feet from the WEST line				
Ground Level Elev. 3843	Producing Formation STRAWN	Pool UNDESIG. DEAN PERMO	Dedicated Acreage: 80 Acres	

1. Outline the acreage dedicated to the subject well by colored pencil or hachure marks on the plat below.
2. If more than one lease is dedicated to the well, outline each and identify the ownership thereof (both as to working interest and royalty).
3. If more than one lease of different ownership is dedicated to the well, have the interests of all owners been consolidated by communitization, unitization, force-pooling, etc.?

Yes No If answer is "yes," type of consolidation _____

If answer is "no," list the owners and tract descriptions which have actually been consolidated. (Use reverse side of this form if necessary.) _____

No allowable will be assigned to the well until all interests have been consolidated (by communitization, unitization, forced-pooling, or otherwise) or until a non-standard unit, eliminating such interests, has been approved by the Commission.

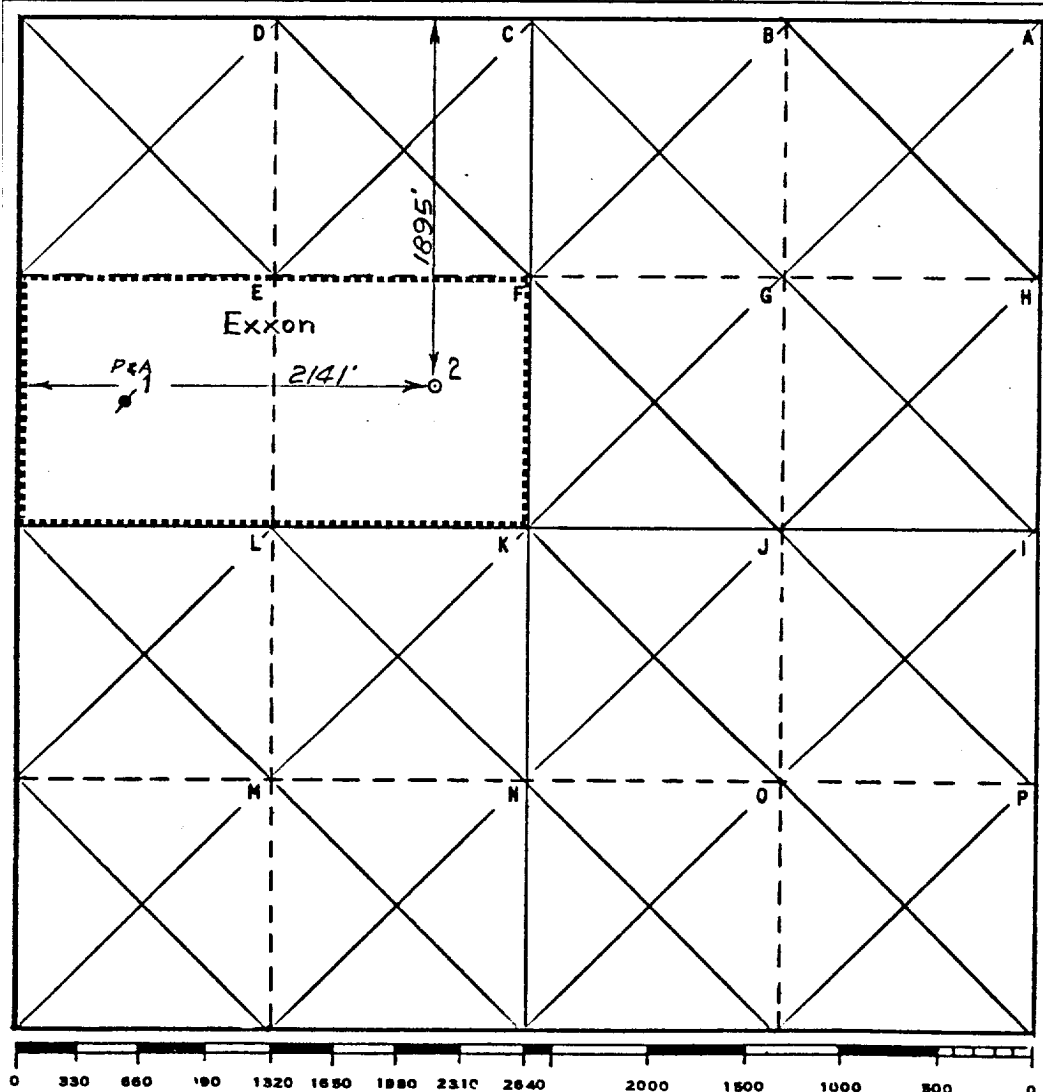

CERTIFICATION

I hereby certify that the information contained herein is true and complete to the best of my knowledge and belief.

Name
Melva Knippling
Position
UNIT HEAD
Company
Exxon Corporation
Box 1600 Midland, Texas
Date
4-29-86

I hereby certify that the well location shown on this plat was plotted from field notes of actual surveys made by me or under my supervision, and that the same is true and correct to the best of my knowledge and belief.

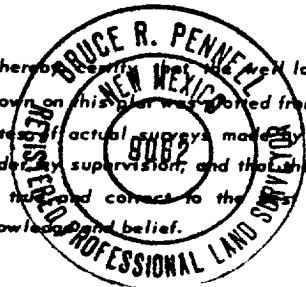

Date Surveyed
3-13-86
Registered Professional Engineer
and/or Land Surveyor

Bruce R. Pennell
Certificate No.
9062

5.6 Miles **NE** of **LOVINGTON**, New Mexico

C.E. Sec. File No. **W-A-9263**

TYPE SA DIVERTER

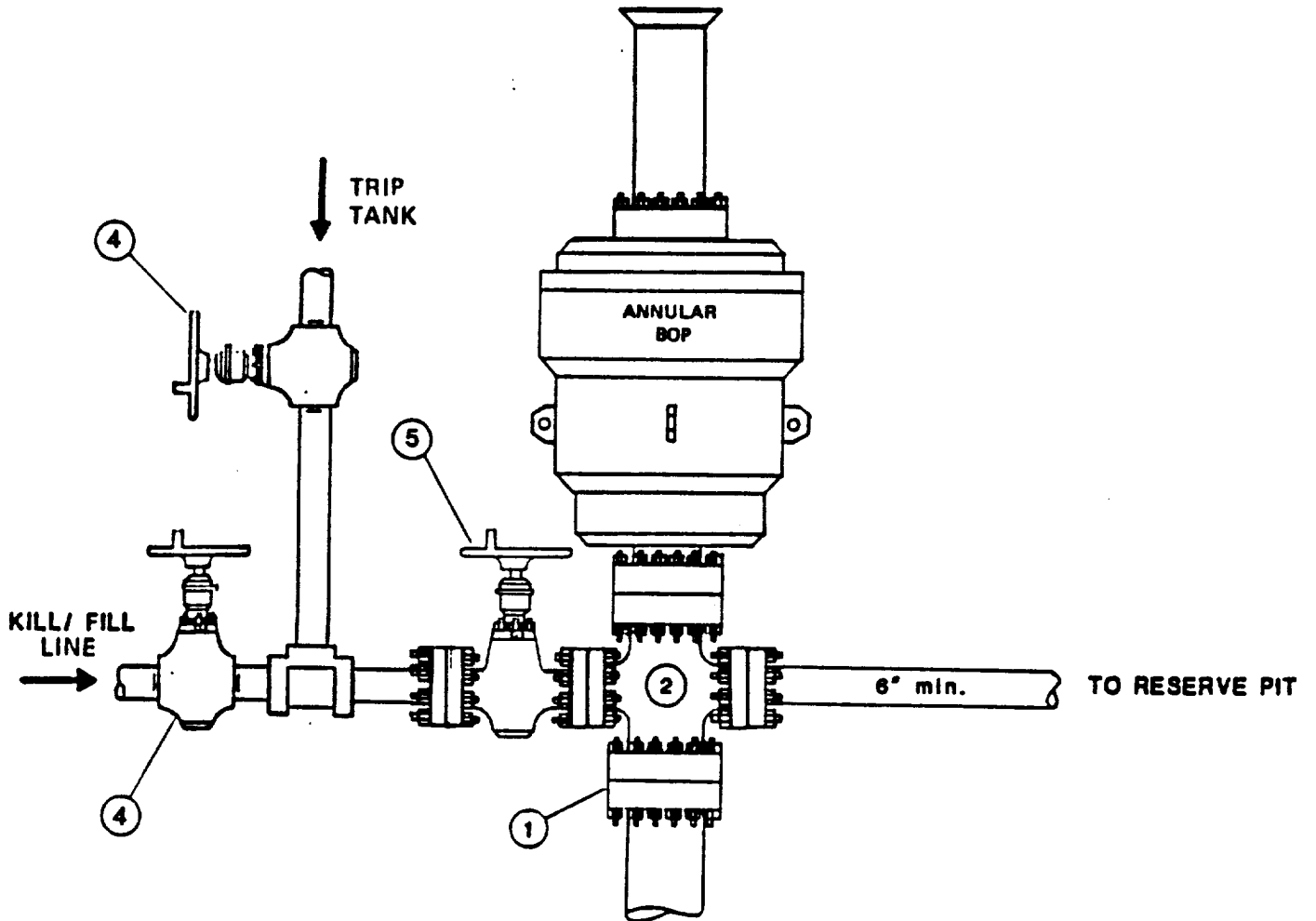

RECEIVED
APR 30 1986
C.C.P.
HOBB'S OFFICE

COMPONENT SPECIFICATIONS
Type SA Diverter

1. Wellhead or BOP Companion flange - screwed or welded to casing.
2. Flanged Drilling Spool.
3. Diverter line minimum size 6" internal diameter, steel pipe. Diverter lines must be securely anchored. Only flanged or welded connections can be used for pipe joint connections and 45° or 90° ells must not be installed on the end of diverter lines to direct flow downward.
4. Flanged or screwed gate or plug valve -- 2" minimum nominal diameter and 2000 psi minimum working pressure.
5. Full opening flanged gate or plug valve -- 2" minimum -- 2000 psi minimum working pressure.

TYPE RRA BOP STACK

THREE PREVENTERS

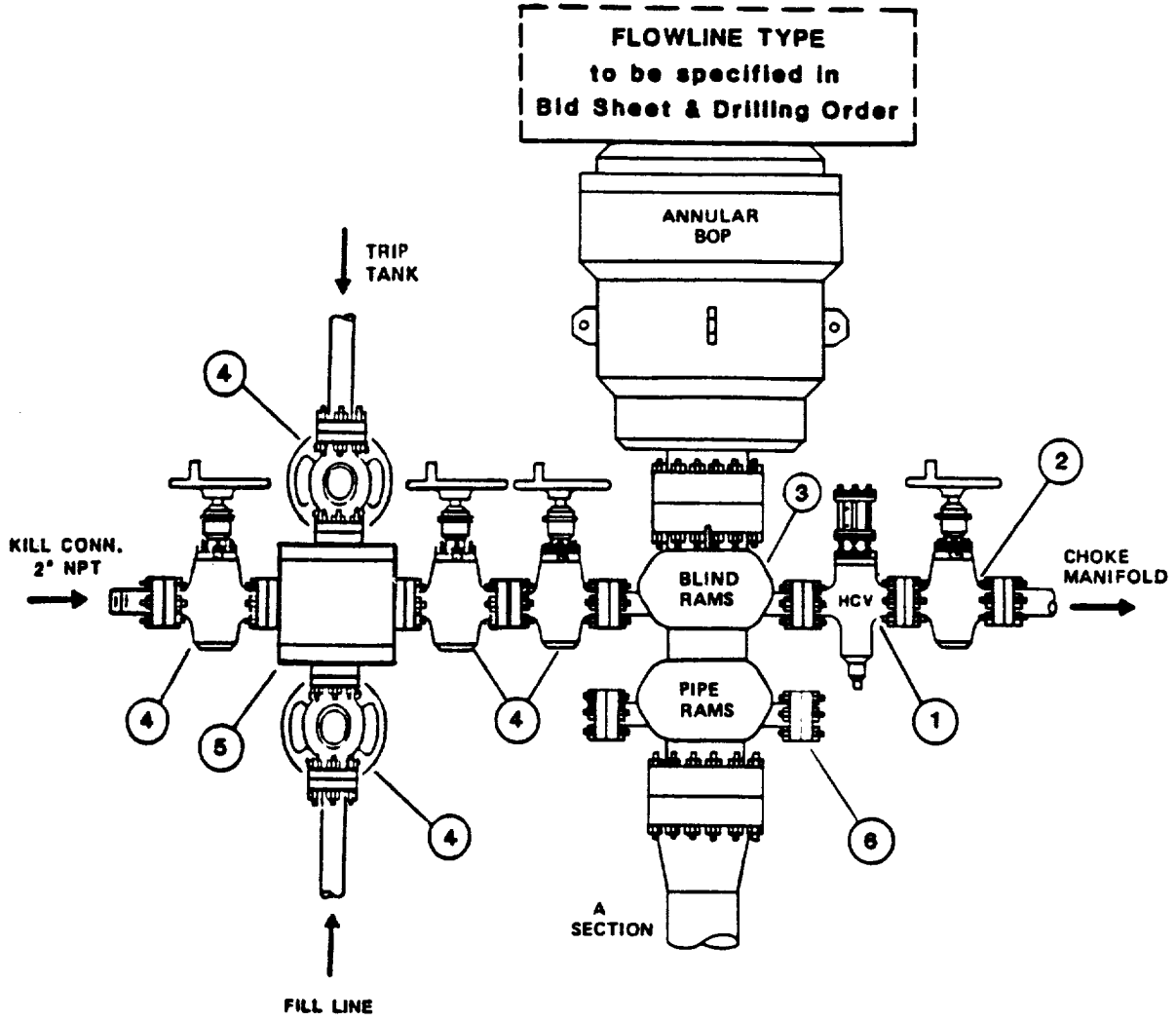

RECEIVED
APR 30 1986
C. C. O.
HOBBS OFFICE

COMPONENT SPECIFICATIONS

Type RRA BOP Stack

1. Flanged hydraulically controlled gate valve -- 3" minimum nominal diameter -- same working pressure as BOP stack.
2. Flanged plug gate valve -- 3" minimum nominal diameter -- same working pressure as BOP stack.
3. BOP outlets must be 2" minimum nominal diameter for kill line and 3" minimum diameter for choke line.
4. Flanged plug or gate valve -- 2" minimum nominal diameter -- same working pressure as BOP stack.
5. Flanged cross or two (2) flanged tees.
6. Any BOP side outlet flange, located below the bottom ram, must be equipped with a blind flange.

NOTE: Each BOP stack must have separate side outlet connections for kill and choke lines, unless specific approval for a single side-outlet is obtained from the Exxon Division Drilling Manager prior to rig-up. Such approval will not be granted unless the equipment arrangement conforms to the specifications shown on pages 14 and 15 of this Section.