

(SUBMIT IN TRIPLICATE)

UNITED STATES
DEPARTMENT OF THE INTERIOR
GEOLOGICAL SURVEY

and Office

Lease No.

Unit

RECEIVED

SUNDRY NOTICES AND REPORTS ON WELLS

NOTICE OF INTENTION TO DRILL.....	<input checked="" type="checkbox"/>	SUBSEQUENT REPORT OF WATER SHUT-OFF.....
NOTICE OF INTENTION TO CHANGE PLANS.....		SUBSEQUENT REPORT OF SHOOTING OR ACIDIZING.....
NOTICE OF INTENTION TO TEST WATER SHUT-OFF.....		SUBSEQUENT REPORT OF ALTERING CASING.....
NOTICE OF INTENTION TO RE-DRILL OR REPAIR WELL.....		SUBSEQUENT REPORT OF RE-DRILLING OR REPAIR.....
NOTICE OF INTENTION TO SHOOT OR ACIDIZE.....		SUBSEQUENT REPORT OF ABANDONMENT.....
NOTICE OF INTENTION TO PULL OR ALTER CASING.....		SUPPLEMENTARY WELL HISTORY.....
NOTICE OF INTENTION TO ABANDON WELL.....		

(INDICATE ABOVE BY CHECK MARK NATURE OF REPORT, NOTICE, OR OTHER DATA)

October 28, 1957

Well No. 3 is located 1980 ft. from N line and 689 ft. from E line of sec. 32

SE of NE of 32 (1/4 Sec. and Sec. No.) 17-S (Twp.) 22-E (Range) (Meridian)
Wilbarger (Field) Leon (County or Subdivision) New Mexico (State or Territory)

The elevation of the derrick floor above sea level is 4126 ft.

DETAILS OF WORK

(State names of and expected depths to objective sands; show sizes, weights, and lengths of proposed casings; indicate mudding jobs, cementing points, and all other important proposed work)

Grayburg top @ approx. 4100' T.D. @ 4500'
Surface casing - 8-5/8", 240' set @ 350' cemented w/150 sx.
Oil string - 5-1/2", 15.20' set @ 4500' cemented 2/250 sx.
Med program - water to 4500' 15 cc water loss.
Med to T.D. Propose to perforate for production in Grayburg formation.

I understand that this plan of work must receive approval in writing by the Geological Survey before operations may be commenced.

Company Tapata Petroleum Corporation

Address Box 2216

Midland, Texas

By M. E. Volz
M. E. Volz

Title Representative

NEW MEXICO OIL CONSERVATION COMMISSION
Well Location and Acreage Dedication Plat

Section A.

1957 NOV 4 AM 7:26

Date October 23, 1957

Operator ZAPATA PETROLEUM CORPORATION Lease Phillips-Federal
Well No. 3 Unit Letter H Section 33 Township 17 South Range 33 East NMPM
Located 1980 Feet From North Line, 660 Feet From East Line
County Lee G. L. Elevation 4116.1 Dedicated Acreage 40 Acres
Name of Producing Formation Castroville Pool Castroville

1. Is the Operator the only owner* in the dedicated acreage outlined on the plat below?
Yes _____ No _____.
2. If the answer to question one is "no," have the interests of all the owners been consolidated by communitization agreement or otherwise? Yes _____ No _____. If answer is "yes," Type of Consolidation _____
3. If the answer to question two is "no," list all the owners and their respective interests below:

Owner

Land Description

Section B

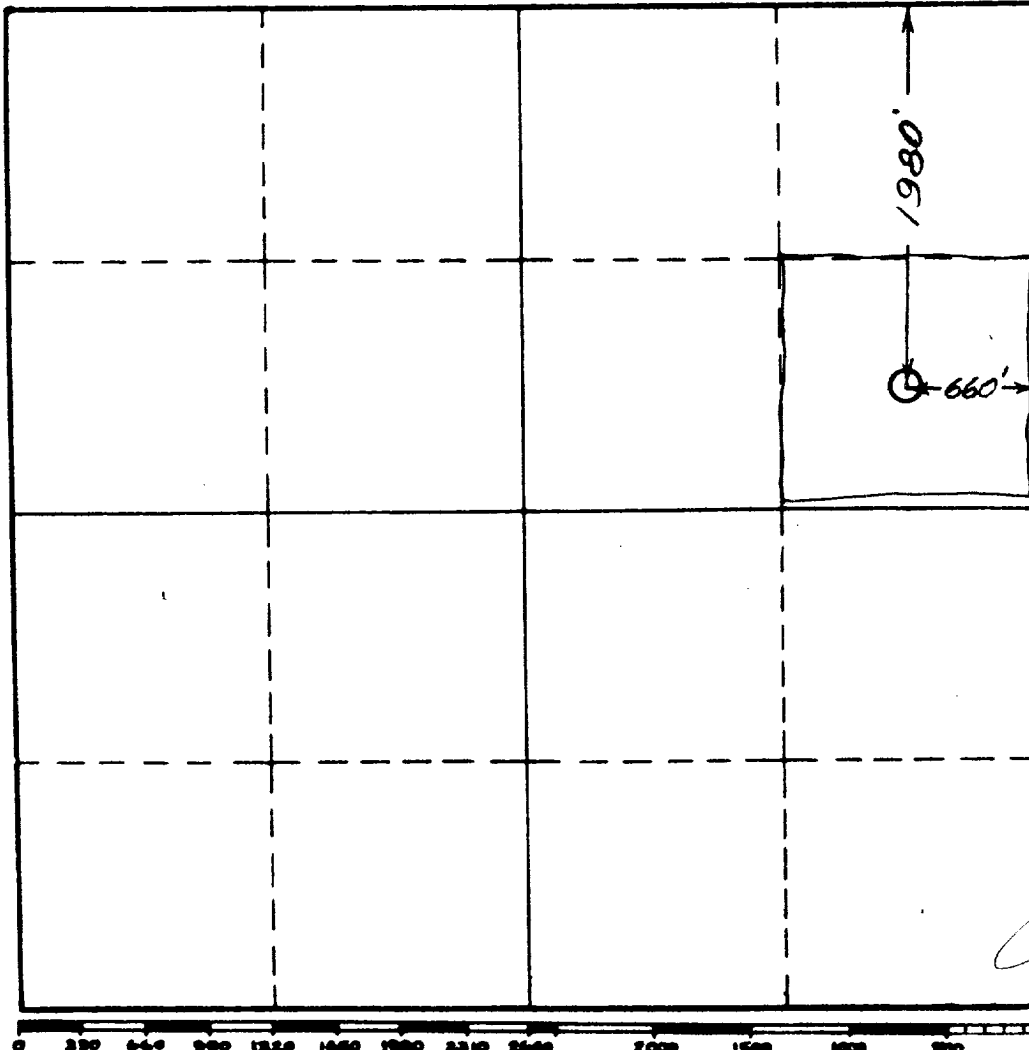

This is to certify that the information in Section A above is true and complete to the best of my knowledge and belief.

Zapata Petroleum Corporation
(Operator)

M. R. Volz
M. R. (Representative)

Box 2310, Midland, Texas
Address

This is to certify that the well location shown on the plat in Section B was plotted from field notes of actual surveys made by me or under my supervision and that the same is true and correct to the best of my knowledge and belief.

Date Surveyed Oct. 23, 1957

John W. Pearson
Registered Professional
Engineer and/or Land Surveyor.

Certificate No. 1559

(See instructions for completing this form on the reverse side)