

NEW MEXICO OIL CONSERVATION COMMISSION
Santa Fe, New Mexico

NOTICE OF INTENTION TO DRILL OR RECOMPLETE

Notice must be given to the District Office of the Oil Conservation Commission and approval obtained before drilling or recompletion begins. If changes in the proposed plan are considered advisable, a copy of this notice showing such changes will be returned to the sender. Submit this notice in QUINTUPPLICATE. One copy will be returned following approval. See additional instructions in Rules and Regulations of the Commission. If State Land submit 6 Copies

Levelland, Texas

(Place)

November 7, 1956

(Date)

OIL CONSERVATION COMMISSION
SANTA FE, NEW MEXICO

Gentlemen:

You are hereby notified that it is our intention to commence the (Drilling) (Recompletion) of a well to be known as
Arren-Bradshaw Exploration Co.

State "D"

(Company or Operator)

Well No. 5

N

located 660 feet from the South line and 1980 feet from the West line.

(GIVE LOCATION FROM SECTION LINE)

Line of Section 21, T 17 S, R 32 E, NMPM.

Bijaur

Pool, Lea

County

If State Land the Oil and Gas Lease is No. B 2148

If patented land the owner is

Address

We propose to drill well with drilling equipment as follows: Rotary tools to top of Grayburg and Cable Tools to complete.

The status of plugging bond is posted

Drilling Contractor Arren-Bradshaw Exploration Co.

We intend to complete this well in the Grayburg

formation at an approximate depth of 4400 feet.

CASING PROGRAM

We propose to use the following strings of Casing and to cement them as indicated:

Size of Hole	Size of Casing	Weight per Foot	New or Second Hand	Depth	Sacks Cement
11"	8 5/8"	24	New	300'	225
7 7/8"	5 1/2"	15.5	New	4100'	250

If changes in the above plans become advisable we will notify you immediately.

ADDITIONAL INFORMATION (If recompletion give full details of proposed plan of work.)

Approved: Nov 15 1956, 19
Except as follows:

Sincerely yours,

Arren-Bradshaw Exploration Co.

(Company or Operator)

By

Div. Prod. Supt.

Position

Send Communications regarding well to

By

OIL CONSERVATION COMMISSION

E. J. Fischer

Name

Arren-Bradshaw Exp Co

NEW MEXICO

OIL CONSERVATION COMMISSION NOV 15 9:51 AM

Form C-128

Well Location and/or Gas Proration Plat

Date 11-6-1956Operator Warren-Bradshaw Exploration Co. Lease State "D"Well No. 5 Section 21 Township 17 South Range 33 East NMPMLocated 1980 Feet From West Line, 660 Feet From South Line,Lea County, New Mexico. G. L. Elevation _____

Name of Producing Formation _____ Pool _____ Dedicated Acreage _____

(Note: All distances must be from outer boundaries of Section)

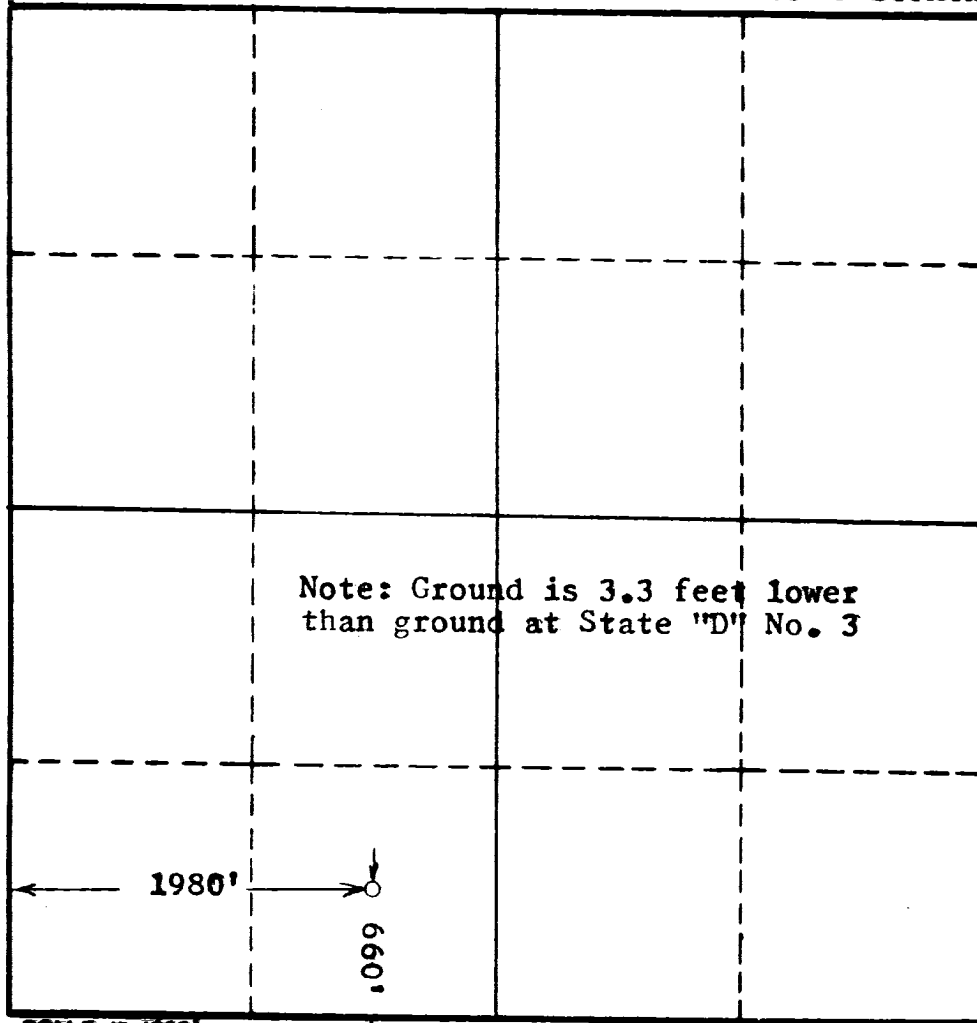

NOTE

This section of form is to be used for gas wells only.



SCALE: 1"=1000'

1. Is this Well a Dual Comp. ? Yes ___ No ___.

2. If the answer to Question 1 is yes, are there any other dually completed wells within the dedicated acreage? Yes ___ No ___.

Name _____
 Position _____
 Representing _____
 Address _____

This is to certify that the above plat was prepared from field notes of actual surveys made by me or under my supervision and that the same are true and correct to the best of my knowledge and belief.

Date Surveyed 11-5-1956

John W. West
 Registered Professional Engineer and/or
 Land Surveyor