

NEW MEXICO OIL CONSERVATION COMMISSION
Santa Fe, New Mexico

NOTICE OF INTENTION TO DRILL OR RECOMPLETE

Notice must be given to the District Office of the Oil Conservation Commission and approval obtained before drilling or recompletion begins. If changes in the proposed plan are considered advisable, a copy of this notice showing such changes will be returned to the sender. Submit this notice in QUINTUPPLICATE. One copy will be returned following approval. See additional instructions in Rules and Regulations of the Commission. If State Land submit 6 Copies

Midland, Texas

(Place)

August 7, 1958

(Date)

OIL CONSERVATION COMMISSION
SANTA FE, NEW MEXICO

Gentlemen:

You are hereby notified that it is our intention to commence the (Drilling) (Recompletion) of a well to be known as
Phillips Petroleum Company

(Company or Operator)

New Mex "B"

(Lease)

Well No. 1, in H (Unit) The well is

located 1977 feet from the North line and 661 feet from the East

(GIVE LOCATION FROM SECTION LINE)

Line of Section 22, T. 17-S, R. 33-E, NMPM.
Leasex (Penn.) Lea

Pool, County

If State Land the Oil and Gas Lease is No. E-3134

If patented land the owner is -

Address -

We propose to drill well with drilling equipment as follows: Rotary

The status of plugging bond is blanket

Drilling Contractor Phillips Petroleum Company Rig 18
Box 6666
Odessa, Texas

We intend to complete this well in the Pennsylvanian formation at an approximate depth of 12000 feet.

CASING PROGRAM

We propose to use the following strings of Casing and to cement them as indicated:

Size of Hole	Size of Casing	Weight per Foot	New or Second Hand	Depth	Sacks Cement
17-3/4"	13-3/8"	48#	New	425	Circ
12-1/4"	9-5/8"	36#	New	4700	Circ
8-3/4"	5-1/2"	23#	New	12000	Circ to 9-5/8"

If changes in the above plans become advisable we will notify you immediately.

ADDITIONAL INFORMATION (If recompletion give full details of proposed plan of work.)

Approved _____, 19_____
Except as follows:

Sincerely yours,

PHILLIPS PETROLEUM COMPANY

(Company or Operator)

By

Chief Clerk

Position Send Communications regarding well to

Name J. N. Perkins

3d Floor Permian Bldg. Midland, Texas

OIL CONSERVATION COMMISSION

By John W. Runyan

NEW MEXICO OIL CONSERVATION COMMISSION
Well Location and Acreage Dedication Plat

HOBBS OFFICE OCC
1958 AUG August 7, 1958
Date
PM 3:56

Section A.

Operator Phillips Petroleum Company Lease _____
Well No. 1 Unit Letter H Section 22 Township 17-S Range 33-E NMPM
Located 1977 Feet From North Line, 661 Feet From East Line
County Lea G. L. Elevation furnish later Dedicated Acreage .40 Acres
Name of Producing Formation Pennsylvanian Pool Hogman (Penn.)

1. Is the Operator the only owner* in the dedicated acreage outlined on the plat below?
Yes X No _____.
2. If the answer to question one is "no," have the interests of all the owners been consolidated by communitization agreement or otherwise? Yes _____ No _____. If answer is "yes," Type of Consolidation _____
3. If the answer to question two is "no," list all the owners and their respective interests below:

Owner

Land Description

SE 1/4 of NE 1/4, Sec 22, T-17-S, R-33-E

Lea County, New Mexico

State Lease E-3134

Section B

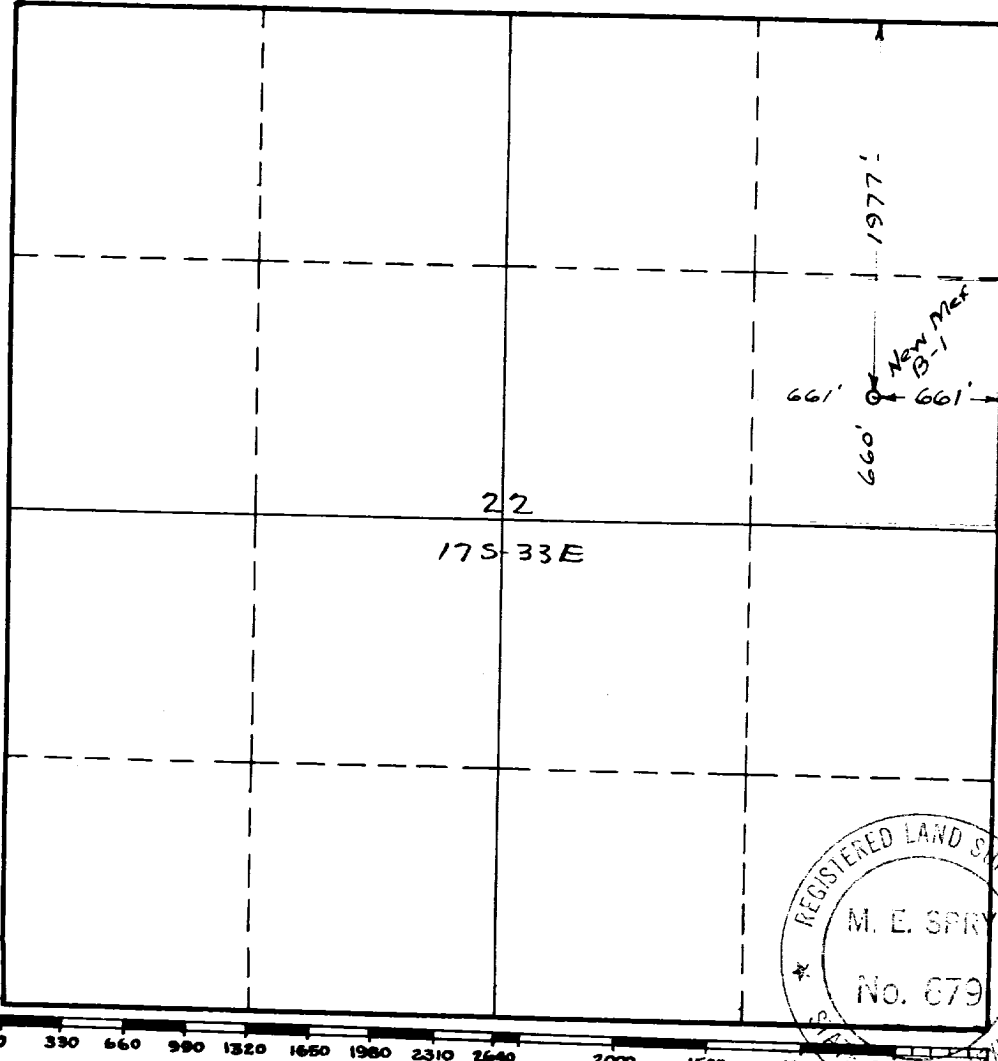

This is to certify that the information in Section A above is true and complete to the best of my knowledge and belief.

Phillips Petroleum Company
(Operator)

J. N. Perkins
(Representative)
3d Floor Permian Bldg.
Midland, Texas
Address

This is to certify that the well location shown on the plat in Section B was plotted from field notes of actual surveys made by me or under my supervision and that the same is true and correct to the best of my knowledge and belief.

Date Surveyed 8-4-58

M. E. Spry
Registered Professional
Engineer and/or Land Surveyor.

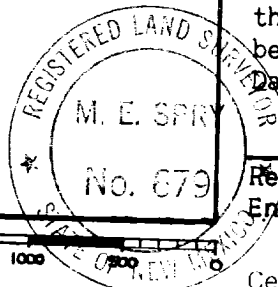

Certificate No. 679

INSTRUCTIONS FOR COMPLETION:

1. Operator shall furnish and certify to the information called for in Section A.
2. Operator shall outline the dedicated acreage for both oil and gas wells on the plat in Section B.
3. A registered professional engineer or land surveyor registered in the State of New Mexico or approved by the Commission shall show on the plat the location of the well and certify this information in the space provided.
4. All distances shown on the plat must be from the outer boundaries of Section.
5. If additional space is needed for listing owners and their respective interests as required in question 3, Section A, please use space below

* "Owner" means the person who has the right to drill into and to produce from any pool and to appropriate the production either for himself or for himself and another. (65-3-29 (e) NMSA 1953 Comp.)