

NEW MEXICO OIL CONSERVATION COMMISSION

Well Location and Acreage Dedication Plat

Form C-128
Revised 5/1/57
HOBBS OFFICE OCC

Section A.

Date 1957 DEC 16 PM 1:33

Operator ZAPATA PETROLEUM CORPORATION Lease Phillips-State of New Mexico
Well No. 10 Unit Letter J Section 28 Township 17 South Range 33 East NMPM
Located 1650 Feet From South Line, 1650 Feet From East Line
County Lea G. L. Elevation 4163.2 Dedicated Acreage 4.0 Acres
Name of Producing Formation Grayburg Pool Maljamar

1. Is the Operator the only owner* in the dedicated acreage outlined on the plat below?
Yes x No .
2. If the answer to question one is "no," have the interests of all the owners been consolidated by communitization agreement or otherwise? Yes No . If answer is "yes," Type of Consolidation
3. If the answer to question two is "no," list all the owners and their respective interests below:

<u>Owner</u>	<u>Land Description</u>

Section B

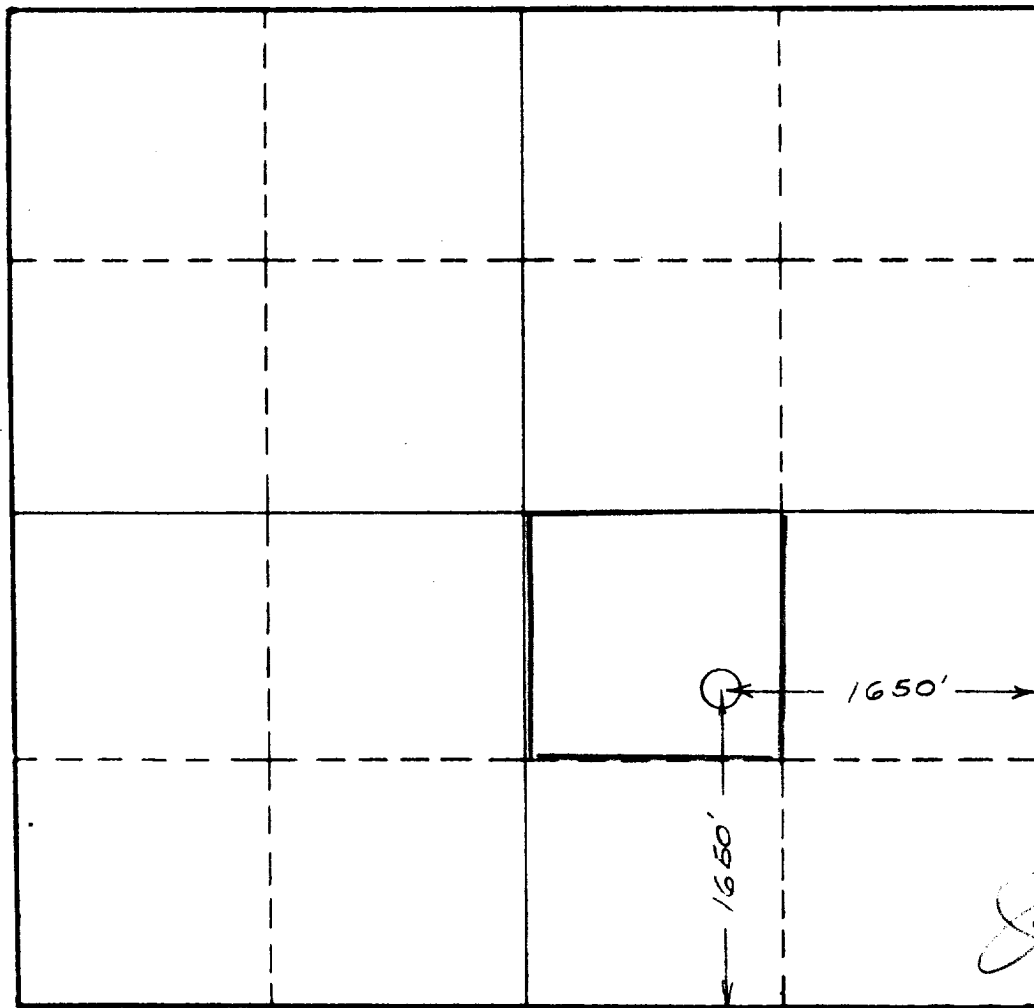

This is to certify that the information in Section A above is true and complete to the best of my knowledge and belief.

Zapata Petroleum Corp.
(Operator)
[Signature]
(Representative)

Box 2216; Midland, Texas
Address

This is to certify that the well location shown on the plat in Section B was plotted from field notes of actual surveys made by me or under my supervision and that the same is true and correct to the best of my knowledge and belief.

Date Surveyed December 14, '57

[Signature]
Registered Professional
Engineer and/or Land Surveyor.

Certificate No. 1559