

(SUBMIT IN TRIPLICATE)

UNITED STATES
DEPARTMENT OF THE INTERIOR
GEOLOGICAL SURVEY

Land Office New Mexico
Lease No. LC 363645
Unit _____

SUNDRY NOTICES AND REPORTS ON WELLS

NOTICE OF INTENTION TO DRILL	<input checked="" type="checkbox"/>	SUBSEQUENT REPORT OF WATER SHUT-OFF	
NOTICE OF INTENTION TO CHANGE PLANS		SUBSEQUENT REPORT OF SHOOTING OR ACIDIZING	
NOTICE OF INTENTION TO TEST WATER SHUT-OFF		SUBSEQUENT REPORT OF ALTERING CASING	
NOTICE OF INTENTION TO RE-DRILL OR REPAIR WELL		SUBSEQUENT REPORT OF RE-DRILLING OR REPAIR	
NOTICE OF INTENTION TO SHOOT OR ACIDIZE		SUBSEQUENT REPORT OF ABANDONMENT	
NOTICE OF INTENTION TO PULL OR ALTER CASING		SUPPLEMENTARY WELL HISTORY	
NOTICE OF INTENTION TO ABANDON WELL			

(INDICATE ABOVE BY CHECK MARK NATURE OF REPORT, NOTICE, OR OTHER DATA)

"Carper-Divley" _____, 19 50
Well No. 0 is located 1700 ft. from N line and 600 ft. from E line of sec. 13
NE 1/4 SE 1/4 13 (1/4 Sec. and Sec. No.) T2S (Twp.) R3E (Range) NMPM (Meridian)
EK Queen (Field) Lea (County or Subdivision) New Mexico (State or Territory)

The elevation of the derrick floor above sea level is 3975 ft. estimate

DETAILS OF WORK

(State names of and expected depths to objective sands; show sizes, weights, and lengths of proposed casings; indicate mudding jobs, cementing points, and all other important proposed work)

We propose to drill this well to an approximate total depth of 4425' to test the Queen formation. We will run approximately 300' of 6 5/8" casing and circulate cement to the surface. We will run 5 1/2" casing to total depth and cement with 400 sacks of Pozmix cement 4% Gel and 125 sacks of neat cement. This well will be drilled with rotary tools and the sand section will probably be cored.

I understand that this plan of work must receive approval in writing by the Geological Survey before operations may be commenced.

Company Carper Drilling Co., Inc.

Address Carper Building

Artesia, New Mexico

By [Signature]

Title Vice-President

NEW MEXICO
OIL CONSERVATION COMMISSION

Form C-128

Well Location and/or Gas Production Plat

Operator Carper Drilling Company, Inc. Lease Carper-Sivley Date May 7, 1956
Well No. 6 Section 13 Township 18 South Range 33 East NMPM
located 980' Feet From South Line, 660' Feet From East Line,
189 County, New Mexico. G. L. Elevation _____
Name of Producing Formation Queen Pool EK Queen Dedicated Acreage _____

(Note: All distances must be from outer boundaries of Section)

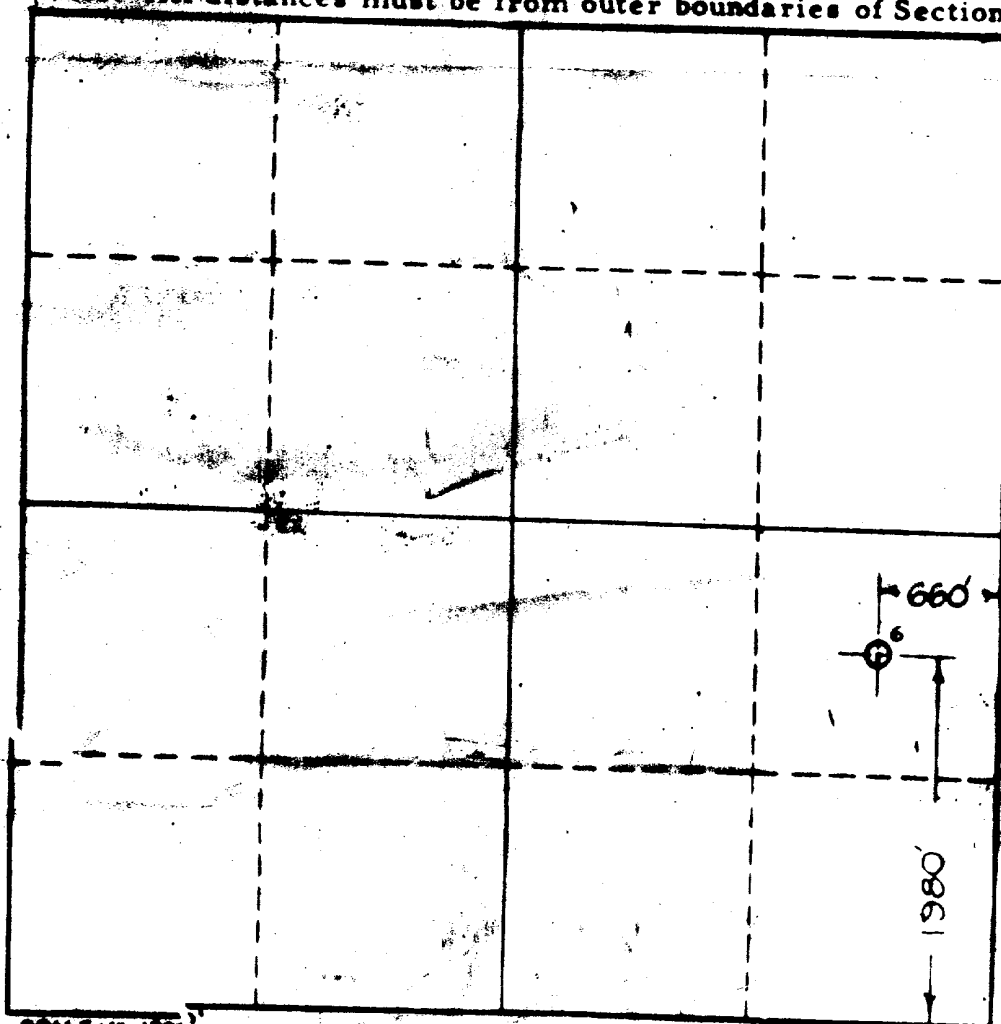

SCALE: 1"=100'

Is this Well a Dual Comp. ? Yes No

If the answer to Question 1 is yes, are there any other dually completed wells within the dedicated acreage? Yes No

By Marshall Rowley
Position Vice-President
Representing Carper Drilling Company Inc.
Address Artesia, New Mexico

This is to certify that the above plat was prepared from field notes of actual surveys made by me or under my supervision and that the same are true and correct to the best of my knowledge and belief.

Date Surveyed 6-28-55
Charles E. Stone
Registered Professional Engineer and/or
Land Surveyor