

UNITED STATES
DEPARTMENT OF THE INTERIOR
GEOLOGICAL SURVEY

SUNDRY NOTICES AND REPORTS ON WELLS

(Do not use this form for proposals to drill or to deepen or plug back to a different reservoir. Use Form 9-331-C for such proposals.)

1. Oil ☒ Gas ☐ other ☐
2. NAME OF OPERATOR
Mobil Producing TX. & N.M. Inc.
3. ADDRESS OF OPERATOR Nine Greenway Plaza,
Suite 2700, Houston, Texas 77046
4. LOCATION OF WELL (REPORT LOCATION CLEARLY. See space 17
below.)
AT SURFACE: 1980' FSL & 1980' FEL, S14, T18S, R33E
AT TOP PROD. INTERVAL: Same as surface
AT TOTAL DEPTH: Same as surface
16. CHECK APPROPRIATE BOX TO INDICATE NATURE OF NOTICE,
REPORT, OR OTHER DATA

REQUEST FOR APPROVAL TO: SUBSEQUENT REPORT OF:

TEST WATER SHUT-OFF	<input type="checkbox"/>	<input type="checkbox"/>
FRACTURE TREAT	<input type="checkbox"/>	<input type="checkbox"/>
SHOOT OR ACIDIZE	<input type="checkbox"/>	<input type="checkbox"/>
REPAIR WELL	<input type="checkbox"/>	<input type="checkbox"/>
PULL OR ALTER CASING	<input type="checkbox"/>	<input type="checkbox"/>
MULTIPLE COMPLETE	<input type="checkbox"/>	<input type="checkbox"/>
CHANGE ZONES	<input type="checkbox"/>	<input type="checkbox"/>
ABANDON*	<input checked="" type="checkbox"/>	<input type="checkbox"/>
(other)	<input type="checkbox"/>	<input type="checkbox"/>

5. LEASE
NM-04591
6. IF INDIAN, ALLOTTEE OR TRIBE NAME
7. UNIT AGREEMENT NAME
EK Queen Unit Tract 6
8. FARM OR LEASE NAME
9. WELL NO.
9
10. FIELD OR WILDCAT NAME
EK Yates Seven Rivers Queen
11. SEC., T., R., M., OR BLK. AND SURVEY OR
AREA
Sec. 14, T-18S, R-33E
12. COUNTY OR PARISH
Lea
13. STATE
New Mexico
14. API NO.
15. ELEVATIONS (SHOW DF, KDB, AND WD)
3919 GR, 3923 KB

(NOTE: Report results of multiple completion on one zone
change on Form 9-330.)

RECEIVED
DEC 29 10 11 AM '83
BUREAU OF LAND MANAGEMENT
ROSWELL DISTRICT

17. DESCRIBE PROPOSED OR COMPLETED OPERATIONS (Clearly state all pertinent details, and give pertinent dates, including estimated date of starting any proposed work. If well is directionally drilled, give subsurface locations and measured and true vertical depths for all markers and zones pertinent to this work.)*

TD 4314, Queen OHZ 4292-4314, Queen perfs 4272-4288, Casing Record 8-5/8 @ 1595, 5-1/2 @ 4292

- (1) Set cement retainer at 4245' and squeeze Queen perfs & OHZ with 25 sacks Class C cement then cap retainer with 5 sacks cement from 4245' to 4195'.
- (2) Perforate at 2900' for squeeze. Set cement retainer at 2850' and squeeze 25 sacks Class C cement through perfs then cap retainer with 10 sacks cement from 2850' to 2750'.
- (3) Perforate at 1650' for squeeze. Set cement retainer at 1600' and squeeze 25 sacks Class C cement through perfs then cap retainer with 5 sacks cement from 1600' to 1550'.
- (4) Perforate at 600' for squeeze. Set cement retainer at 550' and squeeze 20 sacks Class C cement through perfs then cap retainer with 5 sacks cement from 550' to 500'.
- (5) Spot 5 sacks cement from 50' to surface.
- (6) Erect P&A marker and clean location.

PROCEDURE DISCUSSED WITH MR. PETER CHESTER, BLM, 12/07/83.

Subsurface Safety Valve: Manu. and Type _____ Set @ _____ Ft.

18. I hereby certify that the foregoing is true and correct

SIGNED Paula A. Collins TITLE Authorized Agent DATE 12/27/83

APPROVED

(This space for Federal or State office use)

APPROVED BY (Orig. Sgd.) PETER W. CHESTER TITLE _____ DATE _____

CONDITIONS OF APPROVAL IF ANY:

FEB 1 1984

DATE 12/12/83 WELL NO. 6-9 LEASE EK Queens Unit FIELD EK Yates 7-Runs QN

LOCATION Z-14-185-33E
1980' FSL & 1980' FEL
Lea County, New Mexico

SIGNED M W DEER

G.L. 3919'
D.F. —
K.B. 3923'
ZERO 4' AGL

50' SURFACE PLUG

TOC 500'

CMT RET 550 CAPPED W/ 5 SX (50') CLC NEAR CMT

PERFS SQZ W/ 20 SX (100') CLC NEAR CMT

TOC 1550

— 8 5/8", 24" E55 csg set @ 1595' w/ 50 SX CMT. TOC N/A.

CMT. RET. CAPPED W/ 5 SX (50') CLC CMT

CMT. RET. SET @ 1600', PERFS 1650' (415 PF) SQZ W/ 25 SX CLC CMT

— TOP OF SALT @ ± 1670

← 127 cts 2 3/8" BRO + BG.

— BASE OF SALT @ ± 2880'

CMT. RETAINER CAPPED W/ 10 SX (100') CLC NEAR

SET @ ± 2850', PERFS 2900' (415 PF) SQZ W/ 20 SX CLC

— TOC @ ± 3530' (CALCULATED - 20' LOSS, 7 7/8" HOLE).

CMT RET capped w/ 5 SX (50') CLC NEAR CMT.

CMT RET set @ 4245 QN Perfs + OHZ SQZ W/ 25 SX CLC NEAR CMT.

— Queen Perfs: 4272-73, 77-79, 81-83, 85, 87, 89, 283 PF. 20 HOLES.

— 5 1/2", 14" & 15.5" E55 csg set @ 4292' w/ 125 SX. TOC @ ± 3530.

(CALCULATED).

— Queen OHZ: 4292' - 4314'

TD 4314'

TD 4314'

RECEIVED

FEB 2 1984

O.C.O.
HOURS OFFICE

R 33 E

R 34 E

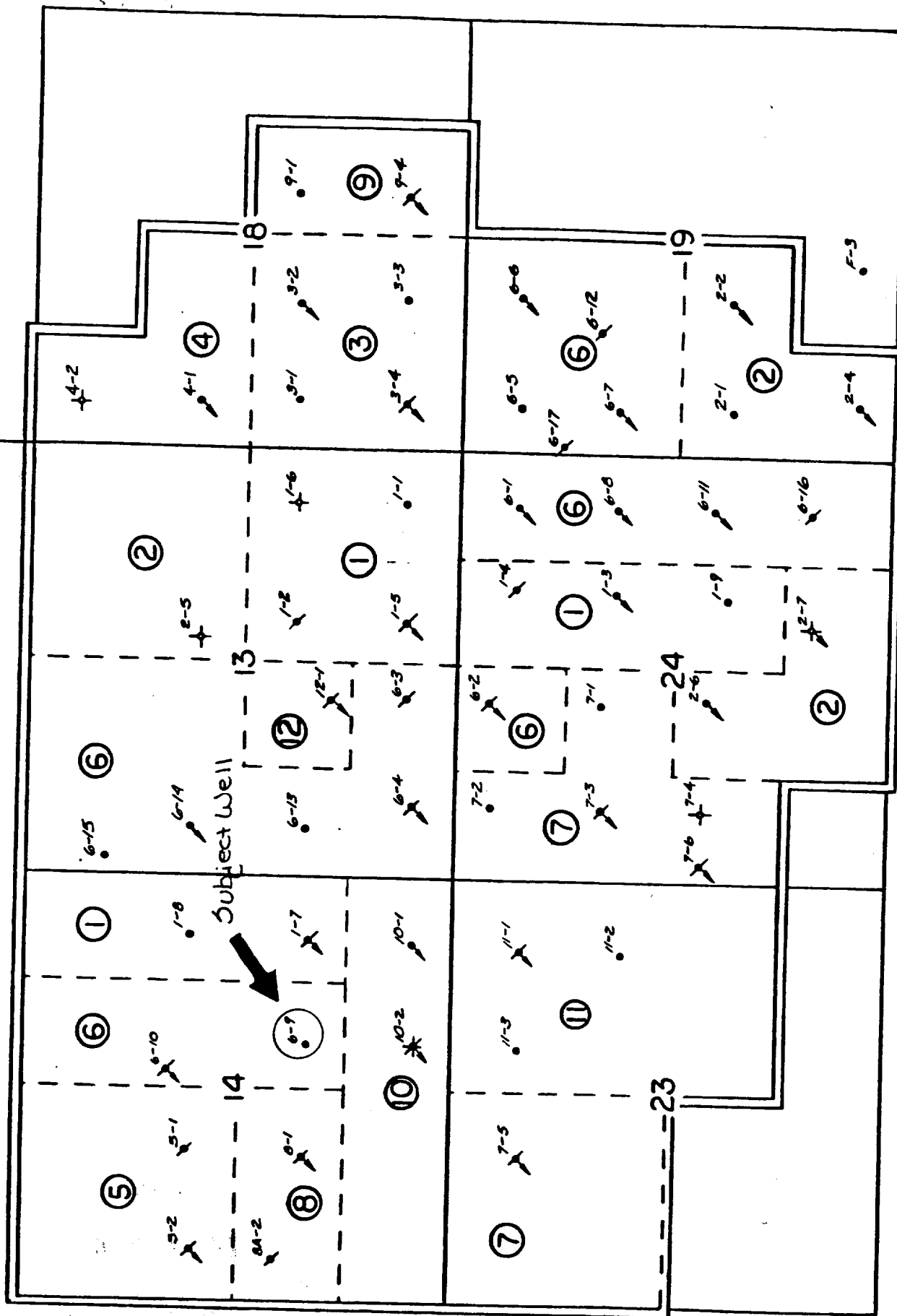

ST-BURNETT 9/10/10

RECEIVED

FEB 2 1984

O.C.D.
HOBBS OFFICE

STATEMENT OF SURFACE RESTORATION INTENTION
ATTACHMENT TO USGS FORM 9-331, SUNDRY NOTICE OF INTENT TO ABANDON

Applicable To: Mobil Producing Texas & New Mexico Inc.
Nine Greenway Plaza, Suite 2700
Houston, TX 77046

Lease Name: EK Queen Unit Tract 6

Well No: 9

Location: 1980'FSL & 1980'FEL of Sec. 14, T-18S, R-33E

This is to advise your office that surface restoration associated with the above described proposed plugging and abandonment will be conducted in accordance with applicable rules and regulations of the United States Geological Survey and the New Mexico Oil Conservation Commission; and in accordance with any existent agreement with the surface landowner, or in a manner arrived at by agreement with the surface landowner.

Such restoration work will include:

Backfilling of all pits and cellar. Levelling or contouring the location site. Clearing the location area of junk.

FORM 9-331 Dated: 12/27/83

RECEIVED

FEB 2 1984

O.C.D.
HOSBAC OFFICE