

NEW MEXICO OIL CONSERVATION COMMISSION
Santa Fe, New Mexico

NOTICE OF INTENTION TO DRILL OR RECOMPLETE

Notice must be given to the District Office of the Oil Conservation Commission and approval obtained before drilling or recompletion begins. If changes in the proposed plan are considered advisable, a copy of this notice showing such changes will be returned to the sender. Submit this notice in QUINTUPPLICATE. One copy will be returned following approval. See additional instructions in Rules and Regulations of the Commission. If State Land submit 6 Copies.

Kermit, Texas

(Place)

May 28, 1956

(Date)

OIL CONSERVATION COMMISSION
SANTA FE, NEW MEXICO

Gentlemen:

You are hereby notified that it is our intention to commence to (Drilling) (Recompletion) of a well to be known as

Magnolia Petroleum Company

(Company or Operator)

State Bridges

(Lease)

Well No. 88

in J (Unit)

The well is

located 1973 feet from the East line and 1980 feet from the South

South

of Section 12, T. 17S, R. 34E, NMPM.

(GIVE LOCATION FROM SECTION LINE)

Vacuum

Pool,

Lea

County

If State Land the Oil and Gas Lease is No. B - 1520

If patented land the owner is -

Address -

We propose to drill well with drilling equipment as follows: Rotary Only

The status of plugging land is On file

Drilling Contractor: Denver Drilling Corp.

Box 669

Odessa, Texas

We intend to complete this well in the San Andres

formation at an approximate depth of 4800 feet.

CASING PROGRAM

We propose to use the following strings of Casing and to cement them as indicated:

Size of Hole	Size of Casing	Weight per Foot	New or Second Hand	Depth	Sacks Cement
12 1/4	8 5/8	24#	new	1700	850
7 7/8	5 1/2	14#	new	4800	1400

If changes in the above plans become advisable we will notify you immediately.

ADDITIONAL INFORMATION (If recompletion give full details of proposed plan of work.)

Approved _____, 9 _____
Except as follows:

Sincerely yours,

Magnolia Petroleum Company

(Company or Operator)

By E. H. Blundell

Position: District Superintendent

Send Communications regarding well to

Name: Magnolia Petroleum Company

OIL CONSERVATION COMMISSION

By _____

NEW MEXICO
OIL CONSERVATION COMMISSION

Form C-128

Well Location and/or Gas Proration Plat

Date May 25, 1956

Operator Magnolia Petroleum Company

Lease State-Bridges

Well No. 88 Section 12 Township 17S Range 34E NMPM

Located 1980 Feet From South Line, 1973 Feet From East Line,

Lea

County, New Mexico. G. L. Elevation _____

Name of Producing Formation _____ Pool _____ Dedicated Acreage _____

(Note: All distances must be from outer boundaries of Section)

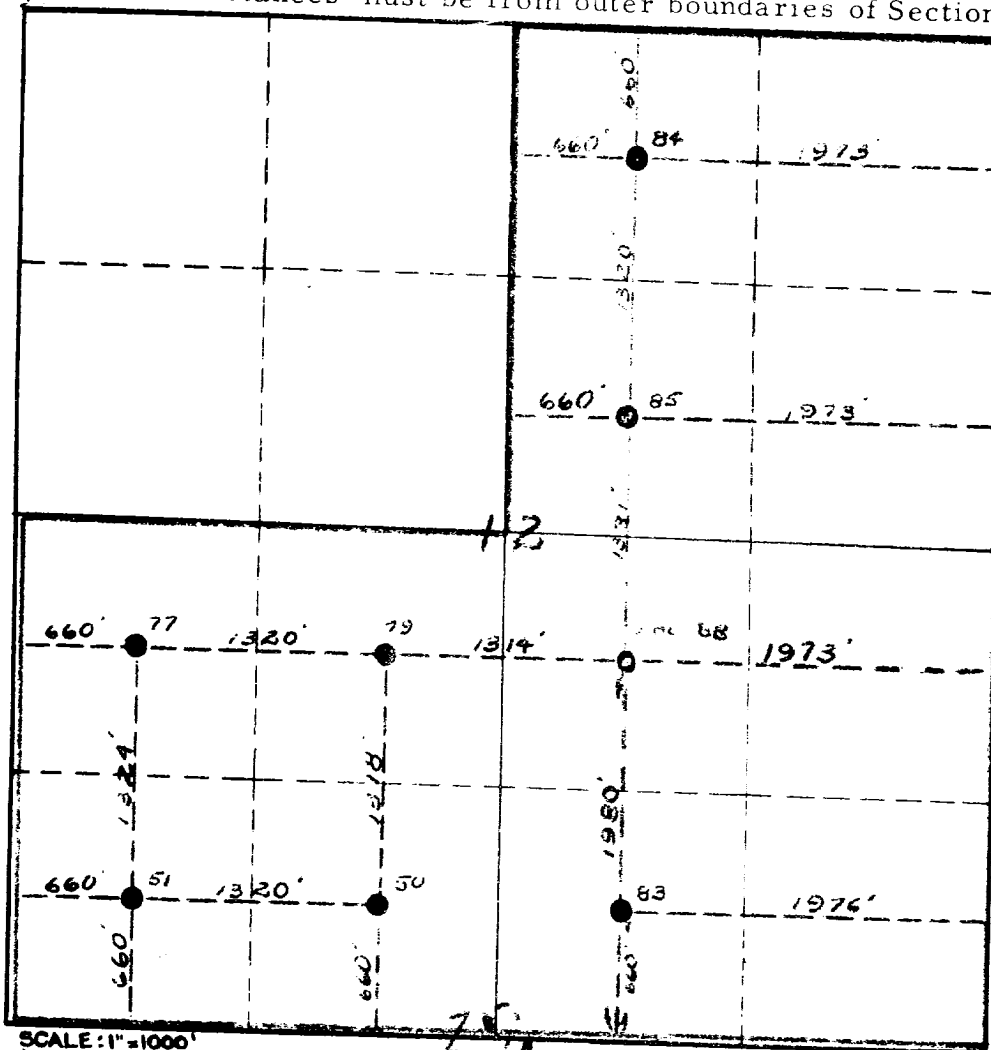

1. Is this Well a Dual Comp. ? Yes ___ No X
2. If the answer to Question 1 is yes, are there any other dually completed wells within the dedicated acreage? Yes ___ No ___

This is to certify that the above plat was prepared from field notes of actual surveys made by me or under my supervision and that the same are true and correct to the best of my knowledge and belief.

Name E. H. Blundell
Position E.G. Blundell, Dist. Superintendent
Representing Magnolia Petroleum Company
Address Box 727, Kermit, Texas

Date Surveyed 12-1-55
[Signature]
Registered Professional Engineer and/or
Land Surveyor 1415