

NOTICE OF INTENTION TO DRILL

Notice must be given to the District Office of the Oil Conservation Commission and approval obtained before drilling or recompletion begins. If changes in the proposed plan are considered advisable, a copy of this notice showing such changes will be returned to the sender. Submit this notice in **QUINTUPLICATE**. One copy will be returned following approval. See additional instructions in Rules and Regulations of the Commission. If State Land submit 6 Copies Attach Form C- 128 in triplicate to first 3 copies of form C-101

Midland, Texas
(Place)

June 10, 1963
(Date)

OIL CONSERVATION COMMISSION
SANTA FE, NEW MEXICO

Gentlemen:

You are hereby notified that it is our intention to commence the Drilling of a well to be known as

TEXACO INC.

(Company or Operator)

State of New Mexico "R" NCT-1, Well No. 7, in G. The well is
(Lease) (Unit)

located 2310 feet from the North line and 1650 feet from the

East line of Section 6, T. -18-S, R. -35-E, NMPM.

(GIVE LOCATION FROM SECTION LINE) Vacuum Abo Reef Pool, Lea County

If State Land the Oil and Gas Lease is No. B-1306-1

If patented land the owner is

Address

We propose to drill well with drilling equipment as follows: Rotary

The status of plugging bond is \$10,000 blanket surety bond of

Maryland Casualty Co. filed with State Geologist.

Drilling Contractor Unknown at present.

We intend to complete this well in the Abo Reef

formation at an approximate depth of 8850 feet.

CASING PROGRAM

We propose to use the following strings of Casing and to cement them as indicated:

Size of Hole	Size of Casing	Weight per Foot	New or Second Hand	Depth	Sacks Cement
15"	11 3/4"	23.72 & 42	New	350'	350
10 5/8"	8 5/8"	24 & 32	New	3030'	1650*
7 5/8"	2 7/8"	6.5	New	8850'	1550**

*1500 sx. 1:1 Pozmix-Portland reg. cmt. mixture w/8% gel followed by 150 sx. Port-

If changes in the above plans become advisable we will notify you immediately. land Neat.

ADDITIONAL INFORMATION (If recompletion give full details of proposed plan of work.)

FORMATIONS EXPECTED:

Anhydrite 1465' Seven Rivers 2990' Drinkard 7890'
Salt 1575' San Andres 4340' Abo Reef 8540'
Yates 2855' Glorieta 5870' Total Depth 8850'

**1300 sx. Class "C" 8% gel followed by 250 sx. Class "C" 4% gel. Use friction reducing agent in 250 sx. Class "C" 4% gel mixture to attain turbulent flow w/this batch.

Approved: JJA 12-1963, 19
Except as follows:

Sincerely yours,

TEXACO INC.

(Company or Operator)

By

J. J. Velten

Position Division Civil Engineer

Send Communications regarding well to

Name J. H. Markley

Address P.O. Box 3109, Midland, Texas

OIL CONSERVATION COMMISSION

By

Oil & Gas

NEW MEXICO OIL CONSERVATION COMMISSION
WELL LOCATION AND ACREAGE DEDICATION PLAT

FORM C-123
 Revised 5/1/57

SEE INSTRUCTIONS FOR COMPLETING THIS FORM ON THE REVERSE SIDE

SECTION A

Operator TEXACO Inc.		Lease 11 PM 2 53		Well No. 7
Unit Letter G	Section 6	Township 18 South	Range 35 East	County Lea
Actual Footage Location of Well: 2310 feet from the North line and 1650 feet from the East line Sec. 6				
Ground Level Elev. 3975	Producing Formation Abo Reef	Pool Vacuum-Abo Reef	Dedicated Acreage: 40 Acres	

1. Is the Operator the only owner in the dedicated acreage outlined on the plat below? YES ☒ NO ☐ ("Owner" means the person who has the right to drill into and to produce from any pool and to appropriate the production either for himself or for himself and another. (65-3-29 (c) NMSA 1935 Comp.)
2. If the answer to question one is "no," have the interests of all the owners been consolidated by communitization agreement or otherwise? YES ☐ NO ☐ . If answer is "yes," Type of Consolidation _____
3. If the answer to question two is "no," list all the owners and their respective interests below:

Owner	Land Description

SECTION B

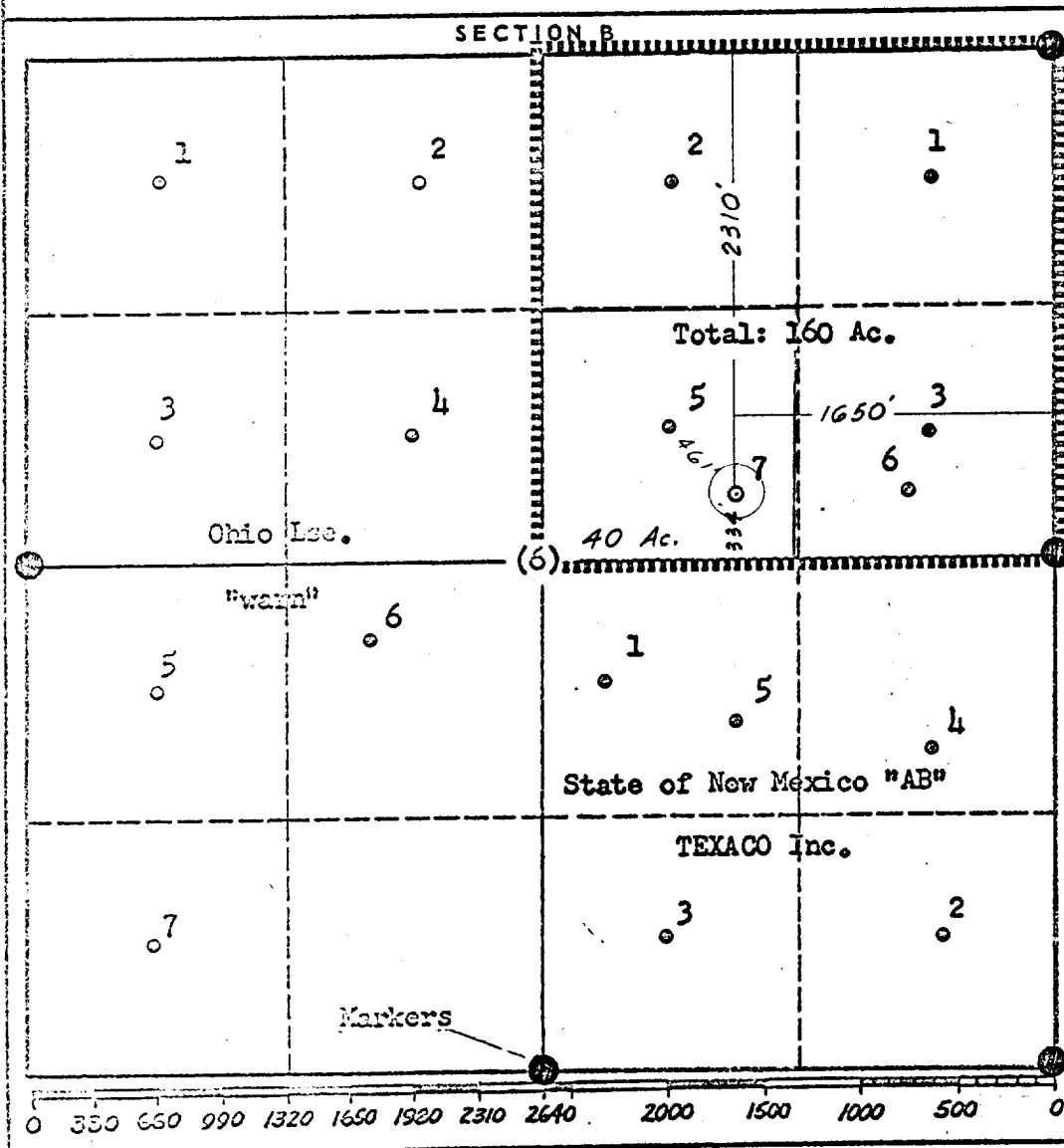

CERTIFICATION

I hereby certify that the information in SECTION A above is true and complete to the best of my knowledge and belief.

Name **J. J. Velten**
 Position **Division Civil Engineer**
 Company **TEXACO Inc.**
 Date **6/10/63**

I hereby certify that the well location shown on the plat in SECTION B was plotted from field notes of actual surveys made by me or under my supervision, and that the same is true and correct to the best of my knowledge and belief.

Date Surveyed **6/8/63**
 Registered Professional Engineer and/or Land Surveyor **J. J. Velten**
 Certificate No. **8174**

Cornat Bond Log
2/8/88