

NO. OF COPIES RECEIVED	
DISTRIBUTION	
SANTA FE	
FILE	
U.S.G.S.	
LAND OFFICE	
OPERATOR	

NL EXICO OIL CONSERVATION COMMISSION

Form C-101
Revised 1-1-65

5A. Indicate Type of Lease
STATE <input checked="" type="checkbox"/> FEE <input type="checkbox"/>
5. State Oil & Gas Lease No.
L-2945

APPLICATION FOR PERMIT TO DRILL, DEEPEN, OR PLUG BACK

1a. Type of Work		7. Unit Agreement Name	
b. Type of Well OIL WELL <input checked="" type="checkbox"/> GAS WELL <input type="checkbox"/> OTHER <input type="checkbox"/>		8. Farm or Lease Name State "N"	
2. Name of Operator THE SUPERIOR OIL COMPANY		9. Well No. 2	
3. Address of Operator P. O. Box 1900, Midland, Texas 79701		10. Field and Pool, or Wildcat Undesignated	
4. Location of Well UNIT LETTER D LOCATED 735 FEET FROM THE North LINE AND 840 FEET FROM THE West LINE OF SEC. 10 TWP. 17-S RGE. 34-E NMPM		12. County Lea	
19. Proposed Depth 9000'		19A. Formation Abo	
20. Rotary or C.T. Rotary 0-9000'			
21. Elevations (Show whether DF, RT, etc.) GR: 4070		21A. Kind & Status Plug. Bond Blanket	
21B. Drilling Contractor Delta Drig. Co.		22. Approx. Date Work will start March 3, 1972	

23.

PROPOSED CASING AND CEMENT PROGRAM

SIZE OF HOLE	SIZE OF CASING	WEIGHT PER FOOT	SETTING DEPTH	SACKS OF CEMENT	EST. TOP
15"	11-3/4"	42#	250'	350	Surface
11"	8-5/8"	24# & 32#	3100'	1000	500
7-7/8"	5-1/2"	15.5# & 17#	9000'	1250	3200'

The above well will be drilled in accordance with the above listed program, except that 5-1/2" casing will be run only if the Abo and or San Andres formations contain commercial production as determined from open hole logs and samples. The State "N" No. 2 Well will be drilled in accordance with safe drilling practices known to industry utilizing blowout preventer and Hydrill equipment for proper well control. Blowout preventer equipment used: Blowout preventers with blind and pipe rams plus Hydrill will be installed and tested prior to drilling 11" and 7-7/8" hole.

EXPIRES

RECEIVED
1-2-1972
DRILLING COMMENCED,

6-2-72

IN ABOVE SPACE DESCRIBE PROPOSED PROGRAM: IF PROPOSAL IS TO DEEPEN OR PLUG BACK, GIVE DATA ON PRESENT PRODUCTIVE ZONE AND PROPOSED NEW PRODUCTIVE ZONE. GIVE BLOWOUT PREVENTER PROGRAM, IF ANY.

I hereby certify that the information above is true and complete to the best of my knowledge and belief.

Signed T. D. Clay Title Petroleum Engineer Date February 28, 1972

(This space for State Use)

APPROVED BY

SUPERVISOR DISTRICT

DATE

MAR 2 1972

CONDITIONS OF APPROVAL, IF ANY:

RECEIVED

1972

U.S. CONSERVATION COMMISSION
NAMES, N. M.

**NEW MEXICO OIL CONSERVATION COMMISSION
WELL LOCATION AND ACREAGE DEDICATION PLAT**

Form C-102
Supersedes C-128
Effective 1-1-65

All distances must be from the outer boundaries of the Section.

Operator THE SUPERIOR OIL COMPANY			Lease STATE N		Well No. 2
Unit Letter D	Section 10	Township 17 SOUTH	Range 34 EAST	County LEA	
Actual Footage Location of Well: 735 feet from the NORTH line and 840 feet from the WEST line					
Ground Level Elev. 4070.0	Producing Formation Abo		Pool Undesignated (Abo)		Dedicated Acreage: 80 Acres

1. Outline the acreage dedicated to the subject well by colored pencil or hachure marks on the plat below.
2. If more than one lease is dedicated to the well, outline each and identify the ownership thereof (both as to working interest and royalty).
3. If more than one lease of different ownership is dedicated to the well, have the interests of all owners been consolidated by communitization, unitization, force-pooling, etc?

☒ Yes ☐ No If answer is "yes," type of consolidation NW/4 Section 10, T-17-S, R-34-E is
Common State Lease No. L-2945 and no communitization required.

If answer is "no," list the owners and tract descriptions which have actually been consolidated. (Use reverse side of this form if necessary.) _____

No allowable will be assigned to the well until all interests have been consolidated (by communitization, unitization, forced-pooling, or otherwise) or until a non-standard unit, eliminating such interests, has been approved by the Commission.

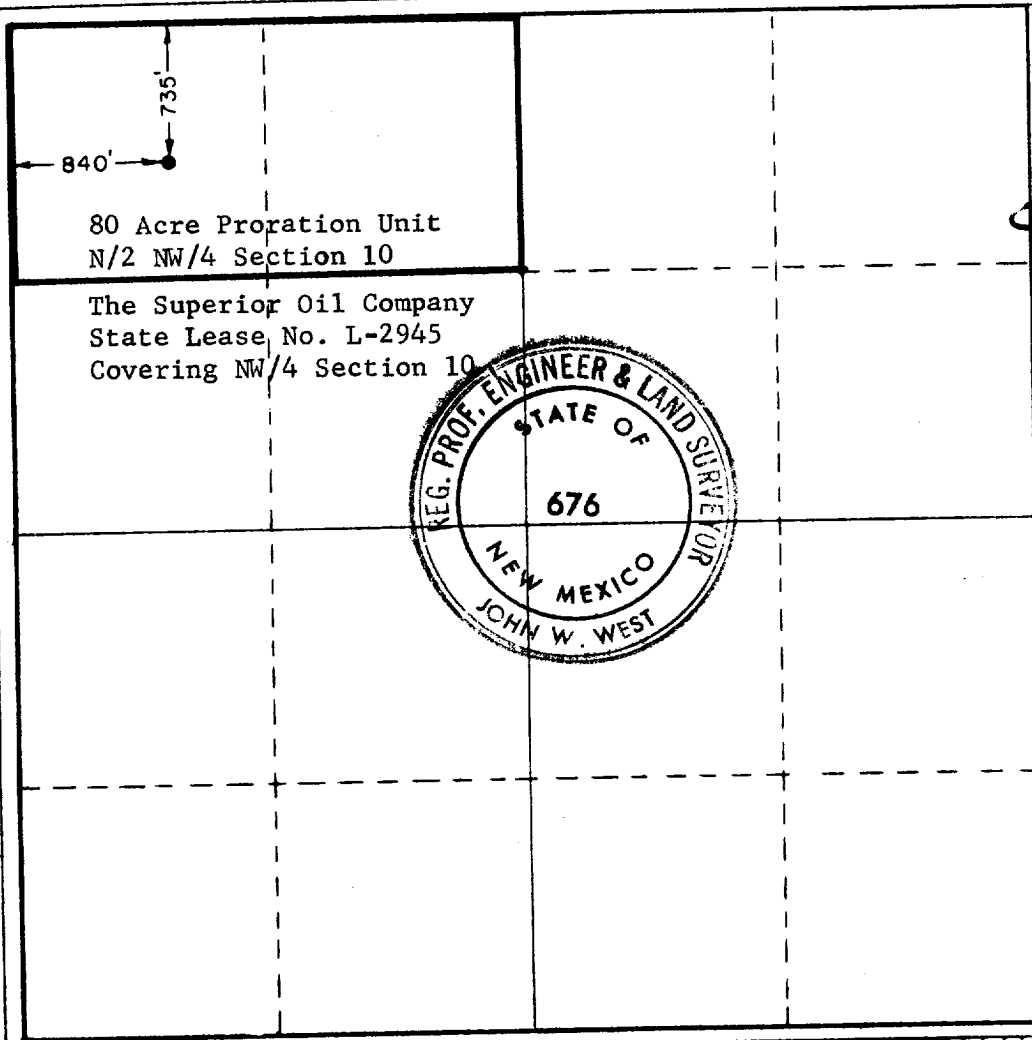

CERTIFICATION

I hereby certify that the information contained herein is true and complete to the best of my knowledge and belief.

T. D. Clay
Name
T. D. Clay

Position
Petroleum Engineer

Company
The Superior Oil Company

Date
February 28, 1972

I hereby certify that the well location shown on this plat was plotted from field notes of actual surveys made by me or under my supervision, and that the same is true and correct to the best of my knowledge and belief.

Date Surveyed
FEBRUARY 23, 1972

Registered Professional Engineer and/or Land Surveyor

John W. West
Certificate No. **676**

11

6-3-89 *Angstrom profile*

RECEIVED

MAY 1972

CONSERVATION COM. N. M.