

NEW MEXICO OIL CONSERVATION COMMISSION
 WELL LOCATION AND ACREAGE DEDICATION PLAT

Form O-128
 Supersedes O-128
 Effective 1-1-65

All distances must be from the outer boundaries of the Section

Operator AMOCO Production Co.		Lease State HQ		Well No. 1
Grid Letter P	Section 26	Township 13 South	Range 34 East	County Lea

Actual Well Location of Well:
960 feet from the **South** line and **330** feet from the **East** line

Ground Level Elev. 3974.3	Producing Formation Wolfcamp	Pool Und. Airstrip Wolfcamp	Dedicated Acreage: 40 Acres
-------------------------------------	--	---------------------------------------	---------------------------------------

1. Outline the acreage dedicated to the subject well by colored pencil or hachure marks on the plat below.
2. If more than one lease is dedicated to the well, outline each and identify the ownership thereof (both as to working interest and royalty).
3. If more than one lease of different ownership is dedicated to the well, have the interests of all owners been consolidated by communitization, unitization, force-pooling, etc?

Yes No If answer is "yes," type of consolidation _____

If answer is "no," list the owners and tract descriptions which have actually been consolidated. (Use reverse side of this form if necessary.) _____

No allowable will be assigned to the well until all interests have been consolidated (by communitization, unitization, forced-pooling, or otherwise) or until a non-standard unit, eliminating such interests, has been approved by the Commission.

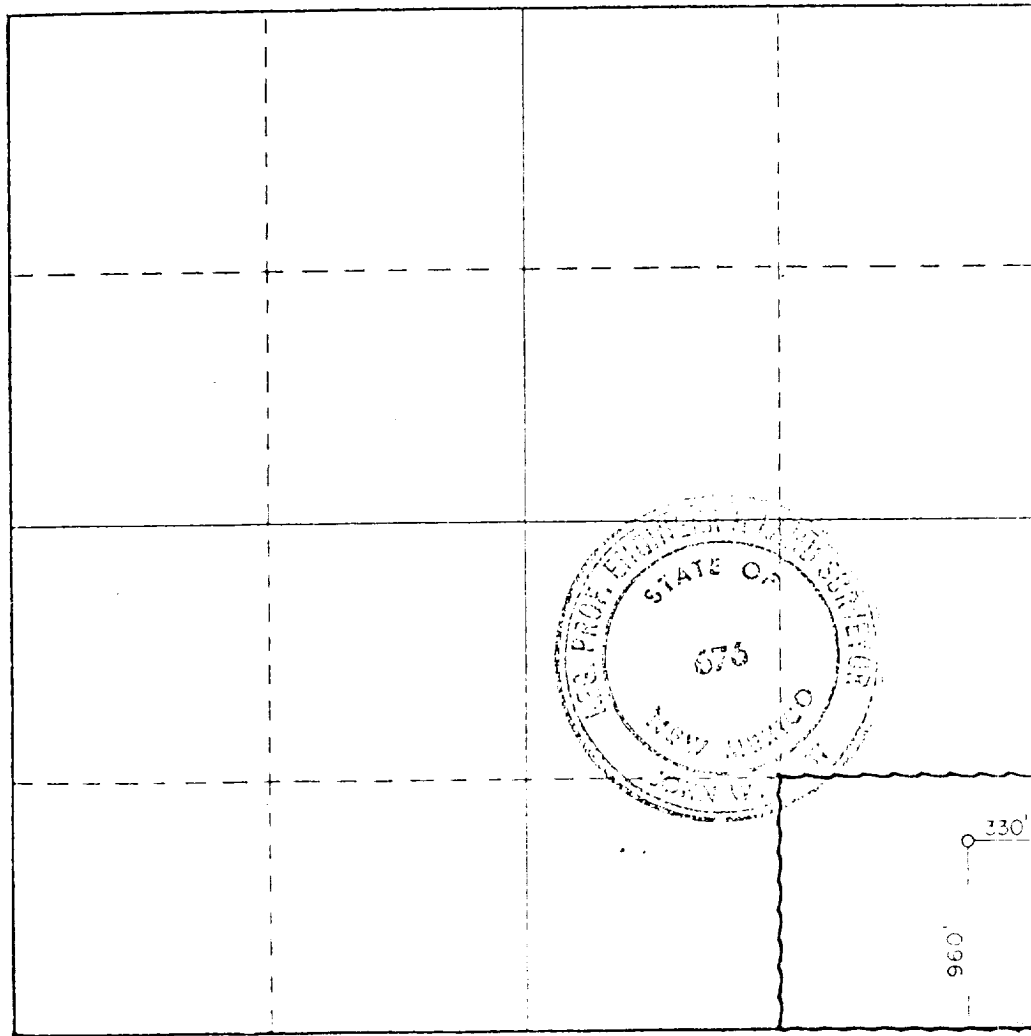

CERTIFICATION

I hereby certify that the information contained herein is true and complete to the best of my knowledge and belief.

Name: Ray Cox
 Position: Administrative Supervisor
 Company: Amoco Production Company

Date: 9-26-79

I hereby certify that the well location shown on this plat was plotted from field notes of actual surveys made by me or under my supervision, and that the same is true and correct to the best of my knowledge and belief.

Date surveyed: September 24, 1979

Registered Professional Engineer and Professional Surveyor
John W. West

Certificate No. John W. West 676
Ronald J. Eidson 3239

