

NO. OF COPIES RECEIVED	
DISTRIBUTION	
SANTA FE	
FILE	
U.S.G.S.	
LAND OFFICE	
OPERATOR	

NEW MEXICO OIL CONSERVATION COMMISSION

Form C-101  
Revised 1-1-65

5A. Indicate Type of Lease  
STATE  FEE   
5. State Oil & Gas Lease No.  
B-2131

API No. 30 625-2127

APPLICATION FOR PERMIT TO DRILL, DEEPEN, OR PLUG BACK

1a. Type of Work DRILL <input checked="" type="checkbox"/> DEEPEN <input type="checkbox"/> PLUG BACK <input type="checkbox"/>		7. Unit Agreement Name East Vacuum Gb/SA Unit	
b. Type of Well OIL WELL <input checked="" type="checkbox"/> GAS WELL <input type="checkbox"/> OTHER <input type="checkbox"/>		8. Farm or Lease Name East Vacuum Gb/SA Unit, Tract 0449	
c. Name of Operator Phillips Petroleum Company		9. Well No. 001	
3. Address of Operator Room 401, 4001 Penbrook St., Odessa, Texas 79762		10. Field and Pool, or Wildcat Vacuum Gb/SA	
4. Location of Well UNIT LETTER C LOCATED 930 FEET FROM THE North LINE AND 1400 FEET FROM THE West LINE OF SEC. 4 TWP. 18-S RGE. 35-E NMPM		12. County Lea	
19. Proposed Depth 4800'		19A. Formation Gb/SA	20. Rotary or C.T. Rotary
21. Elevations (Show whether DF, RT, etc.) 3946.5' Ground (unprepared)	21A. Kind & Status Plug. Bond blanket	21B. Drilling Contractor Advise later	22. Approx. Date Work will start Upon approval

PROPOSED CASING AND CEMENT PROGRAM

SIZE OF HOLE	SIZE OF CASING	WEIGHT PER FOOT	SETTING DEPTH	SACKS OF CEMENT	EST. TOP
11"	8-5/8"	24#, J-55	350'	(Sufficient quantity of Cl H w/2% CaCl 1/4# Flocele/sx in 1st 150 sxs)	Circ to surf
7-7/8"	5-1/2"	14#, K-55	4800'	(Sufficient TRLW w/12# salt/sx w/10% DD and 1/4#/sx Flocele plus 3# Gilsonite/sx followed by 260 sxs Cl H cmt w/8# salt/sx to circ to surf)	

(This well is in the same proration unit as Well No. 115.)

Reference NSL. (Requested by letter dated 7-10-80.)

Use mud additives as required for control.

BOP: Series 900, 3000# WP, double w/one set pipe rams and one set blind rams.

NSL-1235

THE COMMISSION MUST BE NOTIFIED  
24 HOURS PRIOR TO COMMENCING WORK

IN ABOVE SPACE DESCRIBE PROPOSED PROGRAM: IF PROPOSAL IS TO DEEPEN OR PLUG BACK, GIVE DATA ON PRESENT PRODUCTIVE ZONE AND PROPOSED NEW PRODUCTIVE ZONE. GIVE BLOWOUT PREVENTER PROGRAM, IF ANY.

I hereby certify that the information above is true and complete to the best of my knowledge and belief.

Signature W. J. Mueller Title Sr. Engineering Specialist Date July 10, 1980

(This space for State Use)

APPROVED BY John W. Thompson TITLE \_\_\_\_\_ DATE \_\_\_\_\_

CONDITIONS OF APPROVAL, IF ANY:

NEW MEXICO OIL CONSERVATION COMMISSION  
WELL LOCATION AND ACREAGE DEDICATION PLAT

Form C-102  
Supersedes C-128  
Effective 1-1-65

All distances must be from the outer boundaries of the Section

Operator <b>Phillips Petroleum Company</b>		Lease <b>E.V.G.S.A.U. #0449</b>		UNIT TRACT <b>002</b>	Well No. <b>002</b>
Unit Letter <b>D</b>	Section <b>4</b>	Township <b>T18 South</b>	Range <b>R35 East</b>	County <b>Lea</b>	
Actual Footage Location of Well: <b>980</b> feet from the <b>North</b> line and <b>90</b> feet from the <b>West</b> line					
Ground Level Elev. <b>3949.5</b>	Producing Formation <b>Gb/SA</b>	Pool <b>Vacuum Gb/SA</b>		Dedicated Acreage: <b>40</b> Acres	

- Outline the acreage dedicated to the subject well by colored pencil or hachure marks on the plat below.
- If more than one lease is dedicated to the well, outline each and identify the ownership thereof (both as to working interest and royalty).
- If more than one lease of different ownership is dedicated to the well, have the interests of all owners been consolidated by communitization, unitization, force-pooling, etc.?

Yes  No If answer is "yes," type of consolidation \_\_\_\_\_

If answer is "no," list the owners and tract descriptions which have actually been consolidated. (Use reverse side of this form if necessary.) \_\_\_\_\_

No allowable will be assigned to the well until all interests have been consolidated (by communitization, unitization, forced-pooling, or otherwise) or until a non-standard unit, eliminating such interests, has been approved by the Commission.

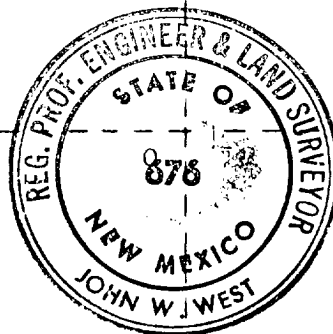
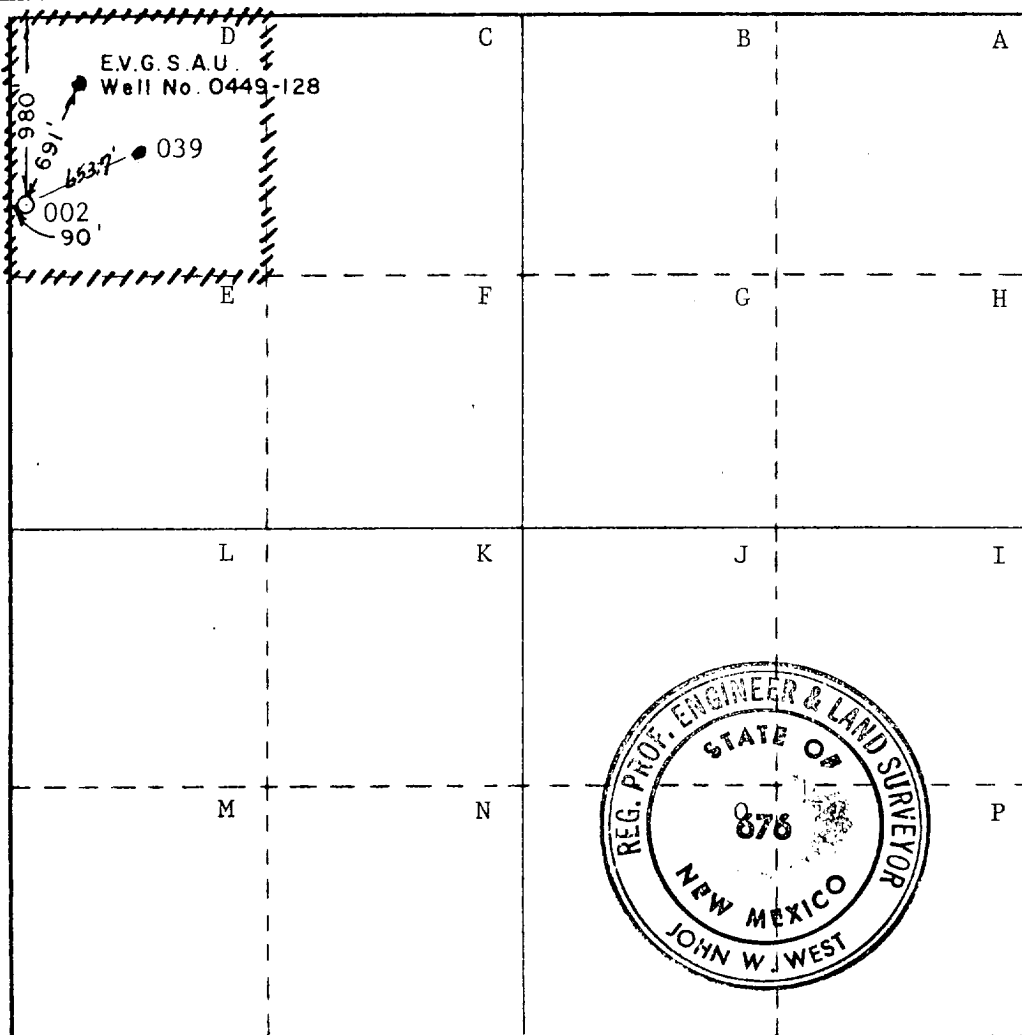

CERTIFICATION

I hereby certify that the information contained herein is true and complete to the best of my knowledge and belief.

*[Signature]*  
Name

**W. J. Mueller**  
Position  
**Sr. Engineering Specialist**

Company  
**Phillips Petroleum Company**

Date  
**7-10-80**

I hereby certify that the well location shown on this plat was plotted from field notes of actual surveys made by me or under my supervision, and that the same is true and correct to the best of my knowledge and belief.

Date Surveyed  
**June 18, 1980**

Registered Professional Engineer and/or Land Surveyor

*[Signature]*

Certificate No. **JOHN W. WEST 878**  
**PATRICK A. ROMERO 8868**  
**Ronald J. Eidson 3239**

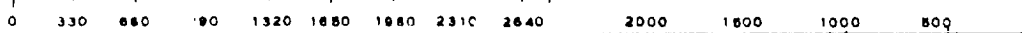

DOUBLE PREVENTER OPTION

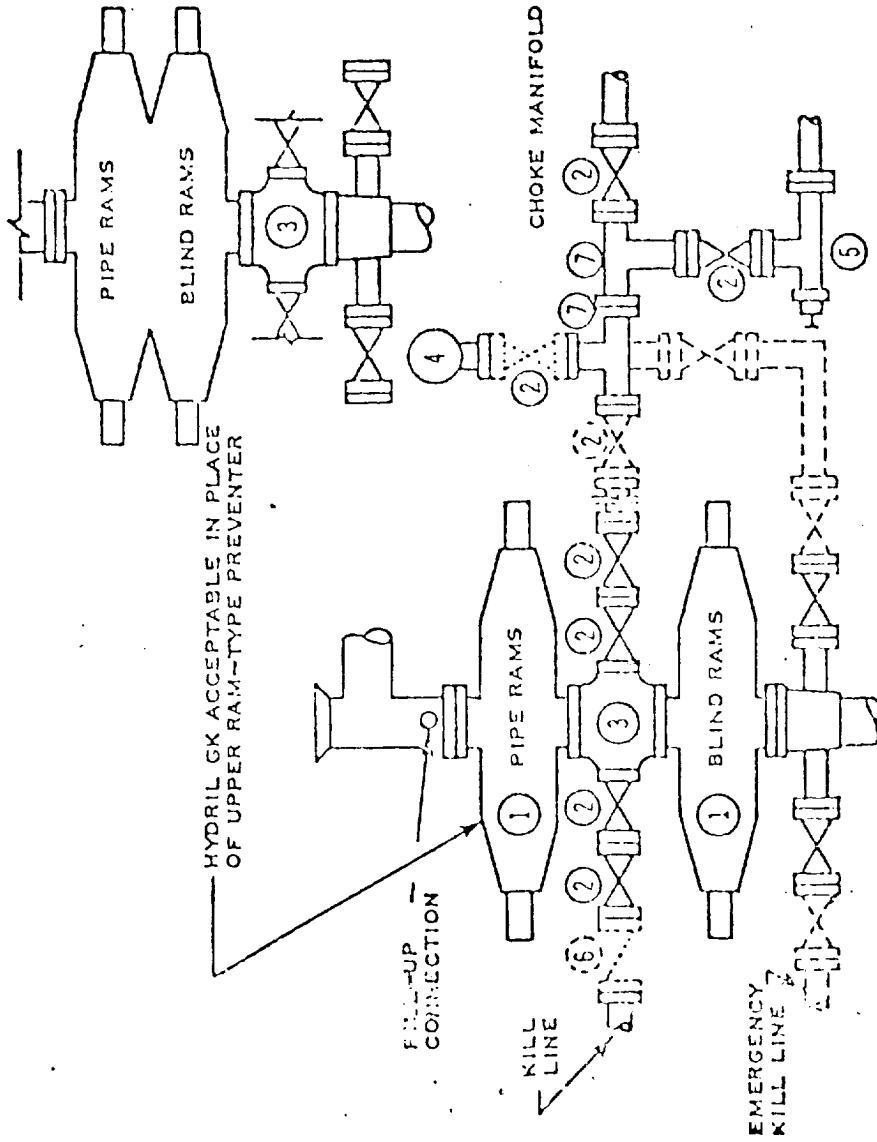

- ① SERIES 900 RAM-TYPE BOP
- ② 2" SERIES 900 VALVE
- ③ SERIES 900 DRILLING SPOOL
- ④ 2" MUD PRESSURE GAUGE
- ⑤ 2" SERIES 900 CHOKE
- ⑥ 2" SERIES 900 CHECK VALVE
- ⑦ 2" SERIES 900 STEEL TEE

NOTES:

1. 3000 PSI WP CLAMP HUBS MAY BE SUBSTITUTED FOR FLANGES
2. VALVES MAY BE EITHER HAND OR POWER OPERATED BUT, IF POWER OPERATED, THE VALVES FLANGED TO THE BOP RUN MUST BE CAPABLE OF BEING OPENED AND CLOSED MANUALLY OR CLOSE ON POWER FAILURE AND BE CAPABLE OF BEING OPENED MANUALLY

..... OPTIONAL EQUIPMENT

PHILLIPS PETROLEUM COMPANY

3000 PSI WORKING PRESSURE  
BLOWOUT PREVENTER HOOK-UP  
(SERIES 900 FLANGES OR BETTER)