

MEXICO OIL CONSERVATION COMMISSION
WELL LOCATION AND ACREAGE DEDICATION PLAT

Form C-122
Supersedes C-128
Effective 1-1-65

All distances must be from the outer boundaries of the Section

Operator Amoco Production Company		Lease SHGSAU		Well No. 222
Tract Letter L	Section 34	Township 18 South	Range 38 East	County Lea
Actual Footage Location of Well: 2019 feet from the South line and 817 feet from the West line				
Ground Level Elev. 3625.2	Producing Formation Grayburg San Andres	Pool Hobbs 86/8A	Dedicated Acreage 40 Acres	

- Outline the acreage dedicated to the subject well by colored pencil or hachure marks on the plat below.
- If more than one lease is dedicated to the well, outline each and identify the ownership thereof (both as to working interest and royalty).
- If more than one lease of different ownership is dedicated to the well, have the interests of all owners been consolidated by communitization, unitization, force-pooling, etc?

Yes No If answer is "yes," type of consolidation _____

If answer is "no," list the owners and tract descriptions which have actually been consolidated. (Use reverse side of this form if necessary.) _____

No allowable will be assigned to the well until all interests have been consolidated (by communitization, unitization, forced-pooling, or otherwise) or until a non-standard unit, eliminating such interests, has been approved by the Commission.

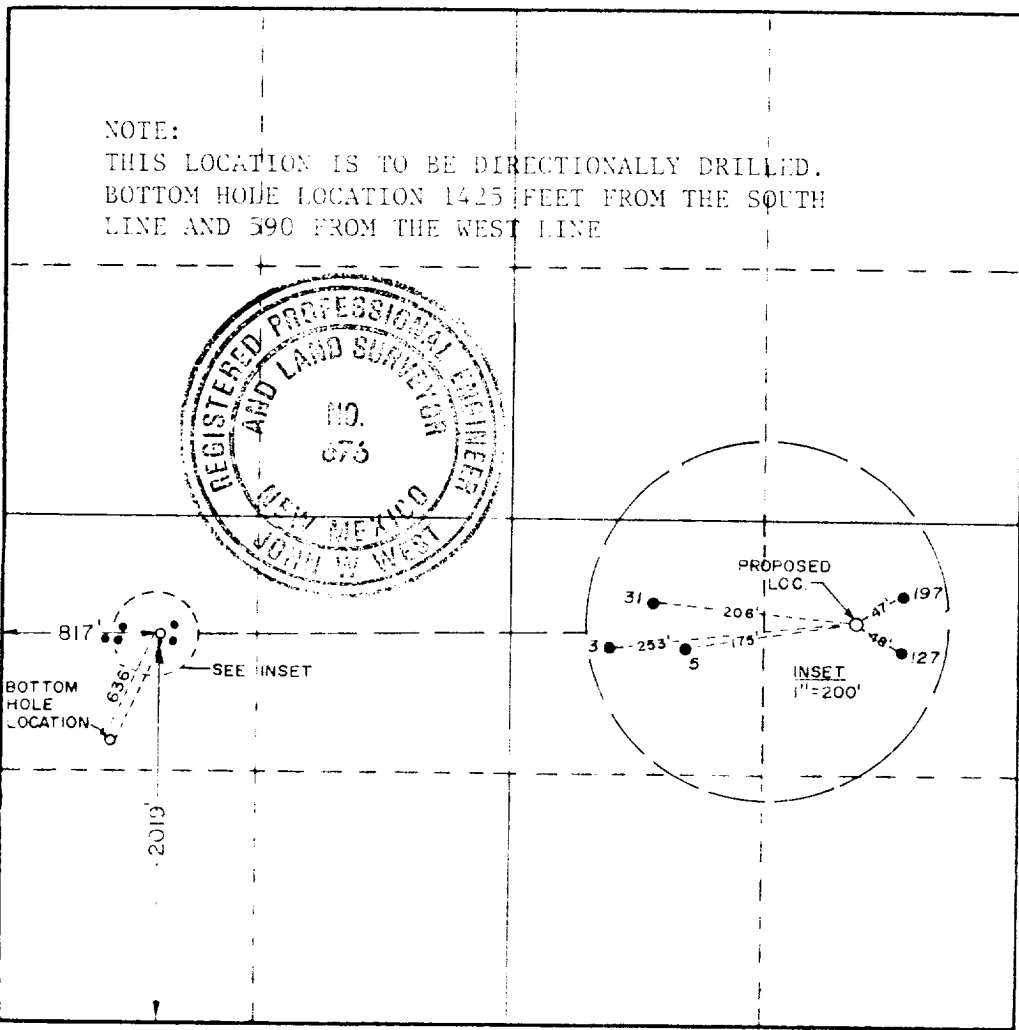

CERTIFICATION

I hereby certify that the information contained herein is true and complete to the best of my knowledge and belief.

Name: Steve Brownlee
Position: Admin Analyst
Company: Amoco Production Co.
Date: 4/3/87

I hereby certify that the well location shown on this plat was plotted from field notes of actual surveys made by me or under my supervision, and that the same is true and correct to the best of my knowledge and belief.

Date Surveyed: March 26, 1987
Registered Professional Engineer and Land Surveyor: *John W. West*
Certificate No. JOHN W. WEST, 576
RONALD J. EIDSON, 3239

RECEIVED
APR 8 1997
OCD
HOBBS OFFICE