

1 MEXICO OIL CONSERVATION COMMISS' WELL LOCATION AND ACREAGE DEDICATION PLAT APR 16 1991 Form C-102 Superseded C-128 Effective 1-1-85

All distances must be from the outer boundaries of the Section.

Operator HARVEY E. YATES CO.			Lease ATLANTIC 32 STATE			Well No. 2		
Unit Letter E	Section 32	Township 18 SOUTH	Range 33 EAST	County LEA				
Actual Footage Location of Well: 1980 feet from the NORTH line and 990 feet from the WEST line								
Ground Level Elev. 3743.5	Producing Formation Penrose		Pool Buffalo Queen			Dedicated Acreage: 40 Acres		

1. Outline the acreage dedicated to the subject well by colored pencil or nachure marks on the plat below.
2. If more than one lease is dedicated to the well, outline each and identify the ownership thereof (both as to working interest and royalty).
3. If more than one lease of different ownership is dedicated to the well, have the interests of all owners been consolidated by communitization, unitization, force-pooling, etc?

Yes No If answer is "yes," type of consolidation _____

If answer is "no," list the owners and tract descriptions which have actually been consolidated. (Use reverse side of this form if necessary.) _____

No allowable will be assigned to the well until all interests have been consolidated (by communitization, unitization, forced-pooling, or otherwise) or until a non-standard unit, eliminating such interests, has been approved by the Commission.

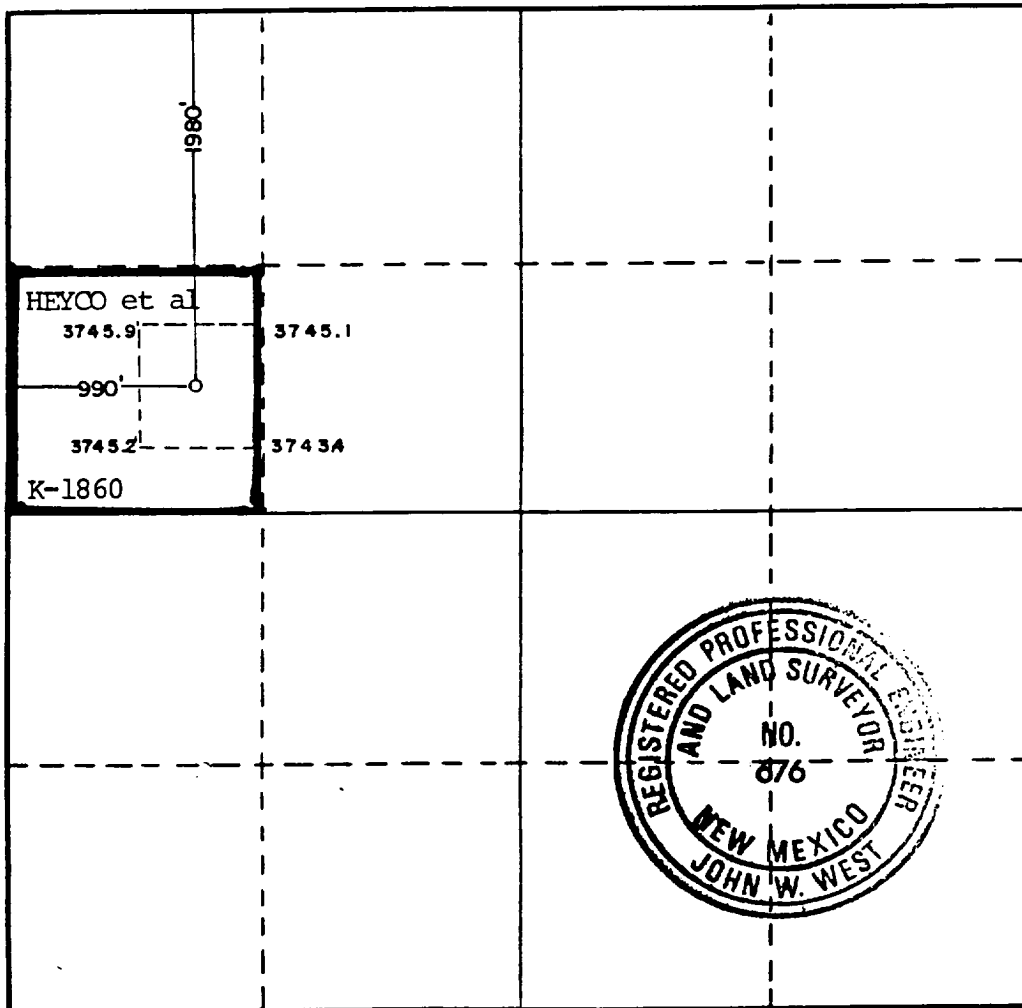

CERTIFICATION

I hereby certify that the information contained herein is true and complete to the best of my knowledge and belief.

Vickie Teel

Name	Vickie Teel
Position	Production Analyst
Company	Harvey E. Yates Company
Date	April 16, 1991

I hereby certify that the well location shown on this plat was plotted from field notes of actual surveys made by me or under my supervision, and that the same is true and correct to the best of my knowledge and belief.

Date Surveyed	4-11-91
Registered Professional Engineer and/or Land Surveyor	<i>John W. West</i>
Certificate No.	JOHN W. WEST, 876 RONALD J. EIDSON, 3239



118236