

| | | |
|------------------------|--|--|
| NO. OF COPIES RECEIVED | | |
| DISTRIBUTION | | |
| SANTA FE | | |
| FILE | | |
| U.S.G.S. | | |
| LAND OFFICE | | |
| OPERATOR | | |

NEW MEXICO OIL CONSERVATION COMMISSION

Form C-101
Revised 1-1-65

| | |
|---|------------------------------|
| 5A. Indicate Type of Lease | |
| STATE <input checked="" type="checkbox"/> | FEE <input type="checkbox"/> |
| 5. State Oil & Gas Lease No. | |

APPLICATION FOR PERMIT TO DRILL, DEEPEN, OR PLUG BACK

| | | | |
|--|--|---|--|
| 1a. Type of Work | | 7. Unit Agreement Name | |
| b. Type of Well DRILL <input type="checkbox"/> DEEPEN <input type="checkbox"/> PLUG BACK <input checked="" type="checkbox"/> | | 8. Farm or Lease Name | |
| OIL WELL <input checked="" type="checkbox"/> GAS WELL <input type="checkbox"/> OTHER <input type="checkbox"/> SINGLE ZONE <input checked="" type="checkbox"/> MULTIPLE ZONE <input type="checkbox"/> | | State A | |
| 2. Name of Operator Shell Oil Company | | 9. Well No. 5 | |
| 3. Address of Operator P. O. Box 1509, Midland, Texas 79701 | | 10. Field and Pool, or Wildcat Vacuum Glorieta | |
| 4. Location of Well UNIT LETTER <u>A</u> LOCATED <u>990</u> FEET FROM THE <u>North</u> LINE AND <u>660</u> FEET FROM THE <u>East</u> LINE OF SEC. <u>31</u> TWP. <u>17S</u> RGE. <u>35E</u> NMPM | | 12. County Lea | |
| 19. Proposed Depth PB 6250 | | 19A. Formation Glorieta | |
| 20. Rotary or C.T. | | | |
| 21. Elevations (Show whether DF, RT, etc.) 3981 DF | | 21A. Kind & Status Plug. Bond Blanket | |
| 21B. Drilling Contractor | | 22. Approx. Date Work will start Upon approval | |

23.

PROPOSED CASING AND CEMENT PROGRAM

| SIZE OF HOLE | SIZE OF CASING | WEIGHT PER FOOT | SETTING DEPTH | SACKS OF CEMENT | EST. TOP |
|---------------|----------------|-----------------|---------------|-----------------|----------|
| 17 1/2" | 13 3/8" | 48# | 293' | 300 | Surface |
| 12 1/4" | 9 5/8" | 40# | 2982' | 1250 | Surface |
| 7 7/8"-8 3/4" | 5 1/2" | 15.5#, 17# | 10300' | 1800 | |

Operation: Abandon Vacuum Abo North and recompleat in Vacuum Glorieta (Glorieta cement squeezed 7-27-72).

1. Set CIBP at 8460' and cap with 35' of cement.
2. Set CIBP at 6250'.
3. Perforate 5 1/2" casing 6069-6174' with 24 holes.
4. Acidize 6069-6174' with 3600 gal 15% NEA.
5. Test and complete as warranted.

IN ABOVE SPACE DESCRIBE PROPOSED PROGRAM: IF PROPOSAL IS TO DEEPEN OR PLUG BACK, GIVE DATA ON PRESENT PRODUCTIVE ZONE AND PROPOSED NEW PRODUCTIVE ZONE. GIVE BLOWOUT PREVENTER PROGRAM, IF ANY.

I hereby certify that the information above is true and complete to the best of my knowledge and belief.

Signed G. W. Tullos Title Senior Production Engineer Date 9-12-75

(This space for State Use)

APPROVED BY John W. Ramsey TITLE Geologist DATE SEP

CONDITIONS OF APPROVAL, IF ANY:

**NEW MEXICO OIL CONSERVATION COMMISSION
WELL LOCATION AND ACREAGE DEDICATION PLAT**

Form C-102
Supersedes C-128
Effective 1-1-65

All distances must be from the outer boundaries of the Section

| | | | | | |
|--------------------------------------|---|----------------------------|-------------------------|---------------------------|---------------------------------------|
| Operator Shell Oil Company | | | Lease State A | | Well No. 5 |
| Unit Letter A | Section 31 | Township 17S | Range 35E | County Lea | |
| Actual Footage Location of Well: | | | | | |
| 990 | | feet from the North | line and 660 | feet from the East | line |
| Ground Level Elev. 3981 DF | Producing Formation Vacuum Glorieta | | Pool Glorieta | | Dedicated Acreage: 40 Acres |

1. Outline the acreage dedicated to the subject well by colored pencil or hachure marks on the plat below.
2. If more than one lease is dedicated to the well, outline each and identify the ownership thereof (both as to working interest and royalty).
3. If more than one lease of different ownership is dedicated to the well, have the interests of all owners been consolidated by communitization, unitization, force-pooling, etc?

☐ Yes ☐ No If answer is "yes," type of consolidation _____

If answer is "no," list the owners and tract descriptions which have actually been consolidated. (Use reverse side of this form if necessary.) _____

No allowable will be assigned to the well until all interests have been consolidated (by communitization, unitization, forced-pooling, or otherwise) or until a non-standard unit, eliminating such interests, has been approved by the Commission.

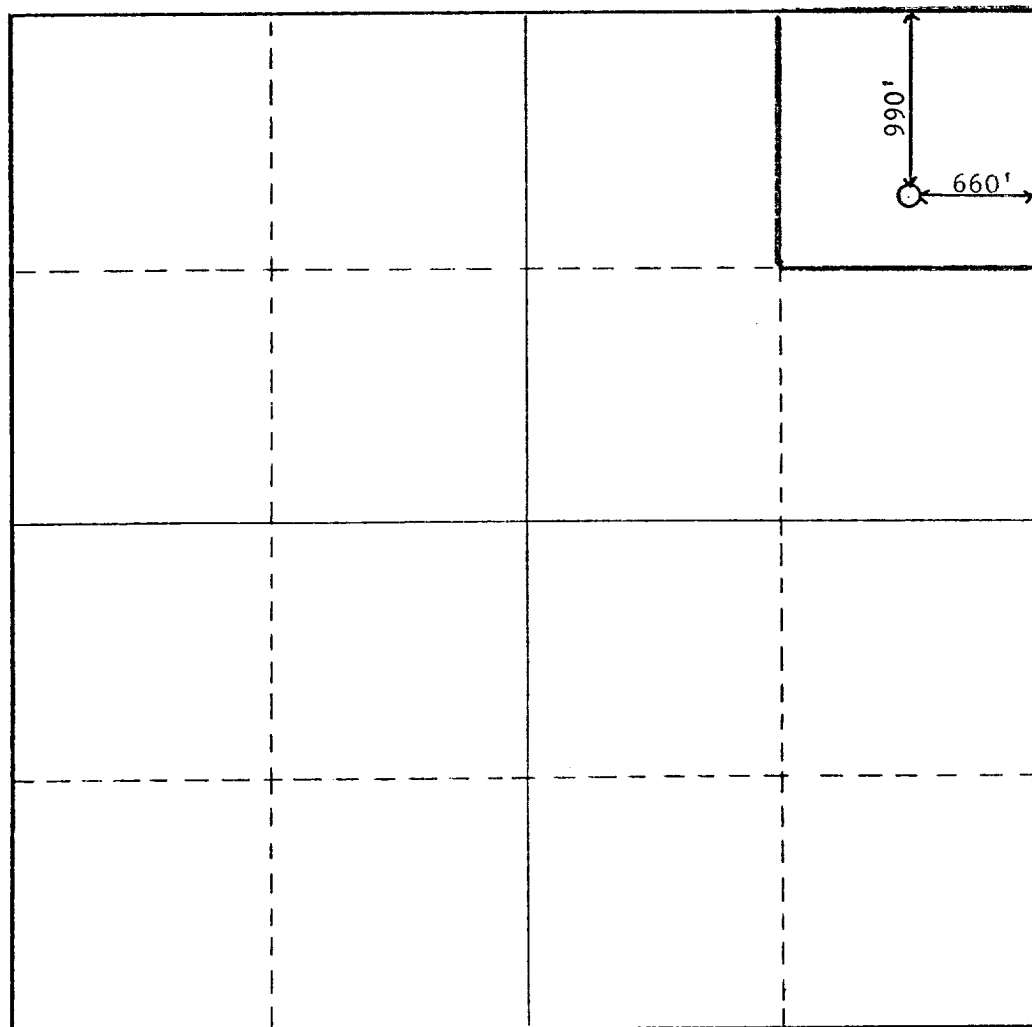

CERTIFICATION

I hereby certify that the information contained herein is true and complete to the best of my knowledge and belief.

G. W. Tullos

Name

G. W. Tullos

Position

Senior Production Engineer

Company

Shell Oil Company

Date

9-12-75

I hereby certify that the well location shown on this plat was plotted from field notes of actual surveys made by me or under my supervision, and that the same is true and correct to the best of my knowledge and belief.

Date Surveyed

Registered Professional Engineer
and/or Land Surveyor

Certificate No.

