

NO. OF COPIES RECEIVED	
DISTRIBUTION	
SANTA FE	
FILE	
U.S.G.S.	
LAND OFFICE	
OPERATOR	

NEW MEXICO OIL CONSERVATION COMMISSION

Form O-101
Revised 1-1-65

15. Indicate Type of Lease
STATE FEE

5. State Oil & Gas Lease No.
B-1501

7. Joint Agreement Name
—

8. Firm or Lease Name
Santa Fe

9. Well No.
120

10. Field and Pool, or Wildcat
Vacuum Gb.-SA

12. County
Lea

19. A. Elevation
4750'

19. B. Location
Gb.-San Andres

20. Rotary or C.T.
rotary

21. Approx. Date Work will start
upon approval

APPLICATION FOR PERMIT TO DRILL, DEEPEN, OR PLUG BACK

1a. Type of Work

b. Type of Well
DRILL DEEPEN PLUG BACK
OIL WELL GAS WELL OTHER SINGLE CORE MULTIPLE CORE

2. Name of Operator
Phillips Petroleum Company

3. Address of Operator
Room B-2, Phillips Building, Odessa, Texas 79760

4. Location of Well:
UNIT LETTER **0** SECTION **475** DIST FROM THE **south** DIST
AND **1650** FEET FROM THE **east** LINE OF SEC. **30** T-P **T-17-S** RGE **35-E** NEPTN

21. Elevations (Show whether DF, RI, etc.)
later

21A. Class & Status Plug, Back
blanket

21B. Status
later

PROPOSED CASING AND CEMENT PROGRAM

SIZE OF HOLE	SIZE OF CASING	WEIGHT PER FOOT	SETTING DEPTH	SACKS OF CEMENT	EST. TOP
12-1/4"	8-5/8"	20#	390'	(350 sx Class Hw/2% CaCl ₂) (w/1/4# Flocele/1st 150 sx)	Circulate to surface
7-7/8"	4-1/2"	11.6#	4700'	(150 sx Class Hw/40% DD) (125 sx Class H neat)	Cover all producing intervals

Add mud additive as required.

Series 900 BOP equipment, hydraulically operated.

Replacement well for Santa Fe No. 2 which will be shut in and temporarily abandoned upon completion of well No. 120

MICHAEL VAUGHN
SUPERVISOR'S EMPLOYER
(EMPLOYER COMMENCED)

EXPIRES 9-10-71

8/7/8

IN ABOVE SPACE DESCRIBE PROPOSED PROGRAM; IF DEEPEN OR PLUG BACK, GIVE DATA ON PRESENT PRODUCTIVE ZONE AND PROPOSED NEW PRODUCTIVE ZONE. GIVE BLOWOUT PREVENTER PROGRAM, IF ANY.

I hereby certify that the information above is true and complete to the best of my knowledge and belief.

Signed W.J. Mueller

Senior Reservoir Engineer

Date 6-1-71

(This space for State Use)

APPROVED BY

[Signature]
SUPERVISOR DISTRICT I

JUN 10 1971

CONDITIONS OF APPROVAL, IF ANY:

RECEIVED

JUN - 9 1971

OIL CONSERVATION COMM.
HOBBS, N. M.

RECEIVED

JUN 3 1971

OIL CONSERVATION COMM.
HOBBS, N. M.

NEW MEXICO OIL CONSERVATION COMMISSION
WELL LOCATION AND ACREAGE DEDICATION PLAT

Form C-102
Supersedes C-128
Effective 1-1-65

All distances must be from the outer boundaries of the Section.

Operator Phillips Petroleum Company		Lease Santa Fe			Well No. 120
Unit Letter 0	Section 30	Township T-17-S	Range 35-E	County Lea	
Actual Footage Location of Well: 475 feet from the south line and 1650 feet from the east line					
Ground Level Elev. later	Producing Formation Grayburg/San Andres		Pool Vacuum Grayburg/San Andres		Dedicated Acreage: 40 Acres

1. Outline the acreage dedicated to the subject well by colored pencil or hachure marks on the plat below.
2. If more than one lease is dedicated to the well, outline each and identify the ownership thereof (both as to working interest and royalty).
3. If more than one lease of different ownership is dedicated to the well, have the interests of all owners been consolidated by communitization, unitization, force-pooling, etc?

Yes No If answer is "yes," type of consolidation _____

If answer is "no," list the owners and tract descriptions which have actually been consolidated. (Use reverse side of this form if necessary.) _____

No allowable will be assigned to the well until all interests have been consolidated (by communitization, unitization, forced-pooling, or otherwise) or until a non-standard unit, eliminating such interests, has been approved by the Commission.

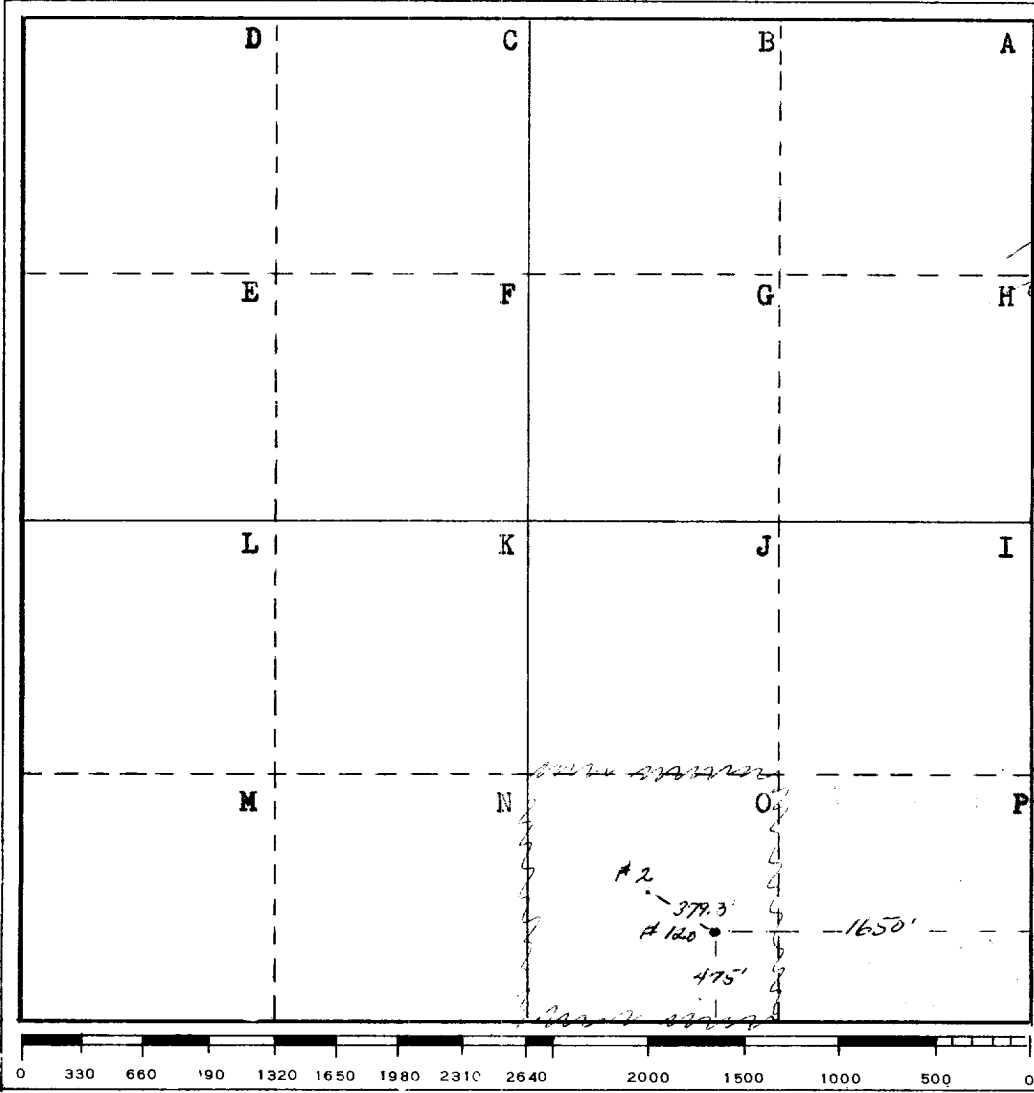

CERTIFICATION

I hereby certify that the information contained herein is true and complete to the best of my knowledge and belief.

Name: *W.J. Mueller*
W.J. Mueller
 Position: **Senior Reservoir Engineer**
 Company: **Phillips Petroleum**
 Date: **6-1-71**

I hereby certify that the well location shown on this plat was plotted from field notes of actual surveys made by me or under my supervision, and that the same is true and correct to the best of my knowledge and belief.

Date Surveyed: **5-28-71**
 Registered Professional Engineer and/or Land Surveyor: *Roger L. Leffler*
Roger L. Leffler

Certificate No. **4357**

RECEIVED

JUN - 9 1971

OIL CONSERVATION COMM.
HOBBS, N. M.

JTE

RECEIVED

JUN 8 1971

OIL CONSERVATION COMM.
HOBBS, N. M.