

NO. OF COPIES RECEIVED	
DISTRIBUTION	
SANTA FE	
FILE	
U.S.G.S.	
LAND OFFICE	
OPERATOR	

NEW MEXICO OIL CONSERVATION COMMISSION

Form C-101
Revised 1-1-65

API No. 30-025-2717

5A. Indicate Type of Lease
STATE FEE

5. State Oil & Gas Lease No.
B-1839-1

APPLICATION FOR PERMIT TO DRILL, DEEPEN, OR PLUG BACK

1a. Type of Work DRILL <input checked="" type="checkbox"/> DEEPEN <input type="checkbox"/> PLUG BACK <input type="checkbox"/>		7. Unit Agreement Name East Vacuum Gb/SA Unit	
b. Type of Well OIL WELL <input checked="" type="checkbox"/> GAS WELL <input type="checkbox"/> OTHER <input type="checkbox"/>		8. Farm or Lease Name East Vacuum Gb/SA Unit, Tract 2738	
c. Name of Operator Phillips Petroleum Company		9. Well No. 008	
3. Address of Operator Room 401, 4001 Penbrook St., Odessa, Texas 79762		10. Field and Pool, or Wildcat Vacuum Gb/SA	
4. Location of Well UNIT LETTER <u>F</u> LOCATED <u>1500</u> FEET FROM THE <u>North</u> LINE AND <u>2500</u> FEET FROM THE <u>West</u> LINE OF SEC. <u>27</u> TWP. <u>17-S</u> RGE. <u>35-E</u> NMPM		12. County Lea	
19. Proposed Depth 4800'		19A. Formation Gb/SA	20. Rotary or C.T. Rotary
21. Elevations (Show whether DE, RI, etc.) Ground 3935.1	21A. Kind & Status Plug. Bond Blanket	21B. Drilling Contractor Advise later	22. Approx. Date Work will start Upon approval

PROPOSED CASING AND CEMENT PROGRAM

SIZE OF HOLE	SIZE OF CASING	WEIGHT PER FOOT	SETTING DEPTH	SACKS OF CEMENT	EST. TOP
12-1/4"	8-5/8"	24#, K-55	350'	(Sufficient quantity of Cl H w/2% CaCl 1/4# Flocele/sx in 1st 150/sx)	circ to surface.
7-7/8"	5-1/2"	14#, K-55	4800'	(Suff. TRW w/12# salt/sx w/10% DD and 1/4#/sx Flocele plus 3# Gilsonite/sx followed by 300 sxs Cl H cmt w/8# salt per sx; circd to surface).	

(This well is in the same proration unit as Well No. 002.)

Reference NSL. 1257.

Use mud additives as required for control.

BOP: Series 900, 3000# WP, double w/one set pipe rams and one set blind rams.

APPROVAL VALID
FOR 90 DAYS UNLESS
DRILLING COMMENCED,

EXPIRES 1/27/81

IN ABOVE SPACE DESCRIBE PROPOSED PROGRAM; IF PROPOSAL IS TO DEEPEN OR PLUG BACK, GIVE DATA ON PRESENT PRODUCTIVE ZONE AND PROPOSED NEW PRODUCTIVE ZONE. GIVE BLOWOUT PREVENTER PROGRAM, IF ANY.

I hereby certify that the information above is true and complete to the best of my knowledge and belief.

W. J. Mueller Title Sr. Engineering Specialist Date October 23, 1980

(This space for State Use)

APPROVED BY _____ TITLE _____ DATE _____

CONDITIONS OF APPROVAL, IF ANY:

aj

**NEW MEXICO OIL CONSERVATION COMMISSION
WELL LOCATION AND ACREAGE DEDICATION PLAT**

Form C-102
Supersedes C-128
Effective 1-1-65

All distances must be from the outer boundaries of the Section

Operator Phillips Petroleum Company		Lease East Vacuum Gb/San Andres Unit Tr 2738			Well No. 008
Unit Letter F	Section 27	Township T- 17 South	Range R- 35 East	County Lea	
Actual Footage Location of Well:					
1500		feet from the	North	line and	2500
				feet from the	West
Ground Level Elev. 3935.1	Producing Formation Grayburg/San Andres		Pool Vacuum Gb/San Andres	Dedicated Acreage 40	

(unprepared)

- Outline the acreage dedicated to the subject well by colored pencil or hachure marks on the plat below.
- If more than one lease is dedicated to the well, outline each and identify the ownership thereof (both as to working interest and royalty).
- If more than one lease of different ownership is dedicated to the well, have the interests of all owners been consolidated by communitization, unitization, force-pooling, etc?

Yes No If answer is "yes," type of consolidation _____

If answer is "no," list the owners and tract descriptions which have actually been consolidated (Use reverse side of this form if necessary.) _____

No allowable will be assigned to the well until all interests have been consolidated (by communitization, unitization, forced-pooling, or otherwise) or until a non-standard unit, eliminating such interests, has been approved by the Commission.

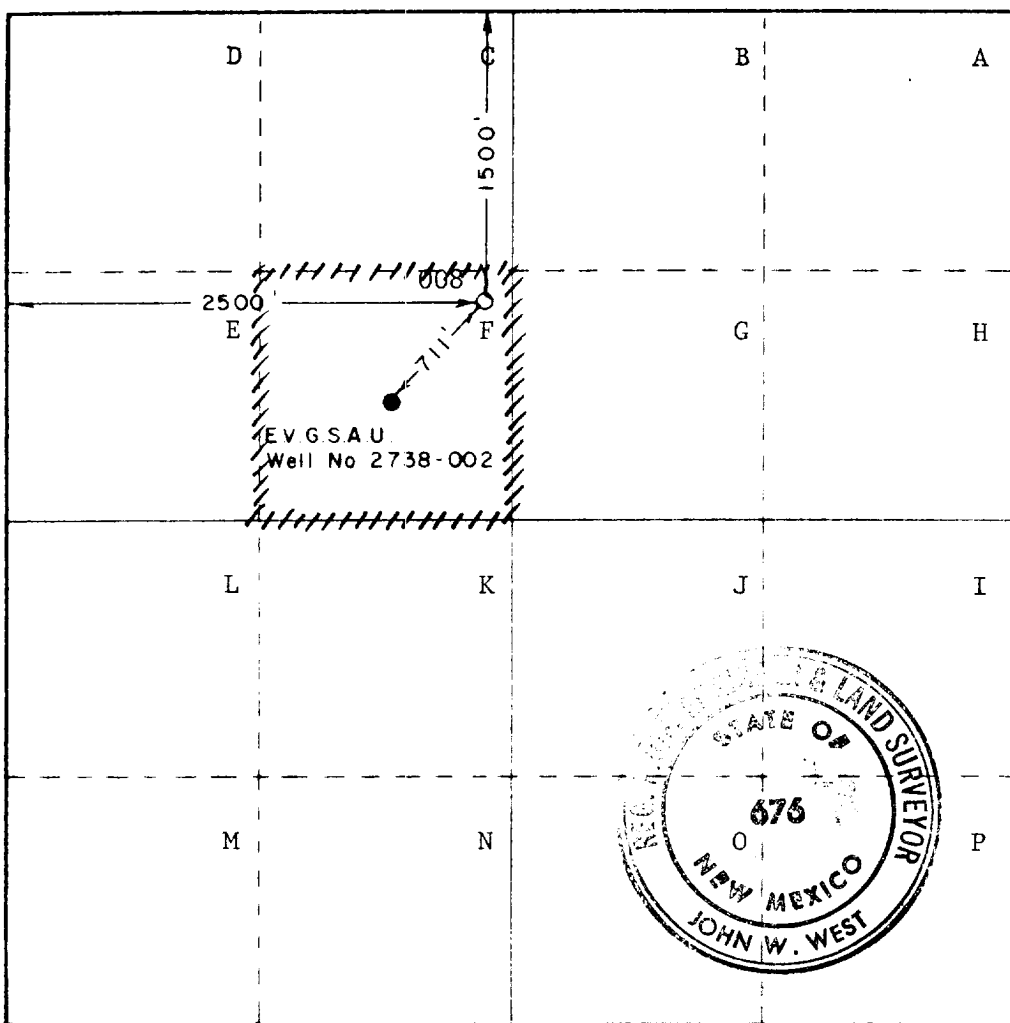

CERTIFICATION	
I hereby certify that the information contained herein is true and complete to the best of my knowledge and belief.	
<i>W.J. Mueller</i>	
Name W.J. Mueller	
Position Sr. Engineering Specialist	
Company Phillips Petroleum Company	
Date 8-13-80	
I hereby certify that the well location shown on this plat was plotted from field notes of actual surveys made by me or under my supervision, and that the same is true and correct to the best of my knowledge and belief.	
Date Surveyed June 20, 1980	
Registered Professional Engineer and/or Land Surveyor <i>John W. West</i>	
Certificate No	JOHN W. WEST 676
	PATRICK A. ROMERO 6663
	Ronald J. Eidson 3239



DOUBLE PREVENTER OPTION

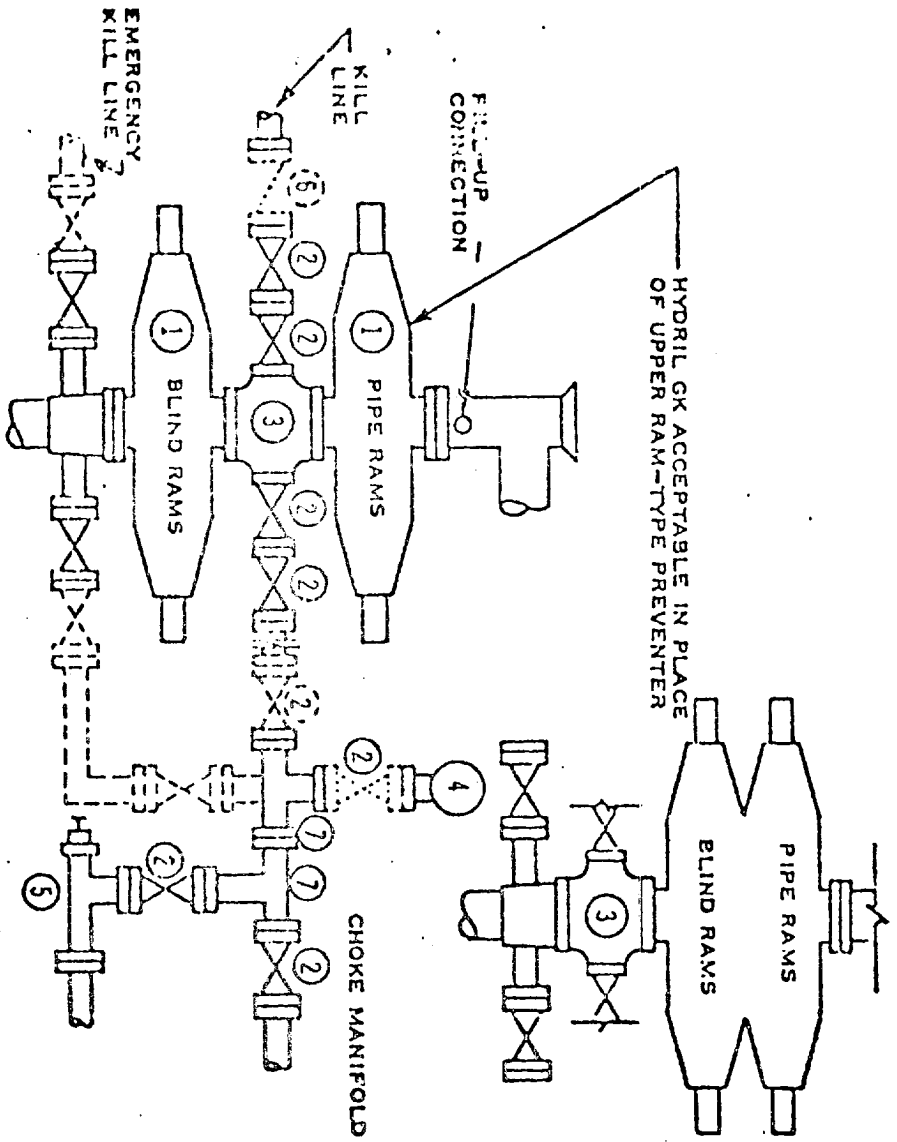

- ① SERIES 900 RAM-TYPE BOP
- ② 2" SERIES 900 VALVE
- ③ SERIES 900 DRILLING SPOOL
- ④ 2" MUD PRESSURE GAUGE
- ⑤ 2" SERIES 900 CHOKE
- ⑥ 2" SERIES 900 CHECK VALVE
- ⑦ 2" SERIES 900 STEEL TEE

NOTES:

1. 3000 PSI WP CLAMP HUGS MAY BE SUBSTITUTED FOR FLANGES
2. VALVES MAY BE EITHER HAND OR POWER OPERATED BUT, IF POWER OPERATED, THE VALVES FLANGED TO THE BOP RUN MUST BE CAPABLE OF BEING OPENED AND CLOSED MANUALLY OR CLOSE ON POWER FAILURE AND BE CAPABLE OF BEING OPENED MANUALLY

..... OPTIONAL EQUIPMENT

PHILLIPS PETROLEUM COMPANY

3000 PSI WORKING PRESSURE
BLOWOUT PREVENTER HOOK-UP
(SERIES 900 FLANGES OR BETTER)