

Well Location and Acreage Dedication Plat

Section A.

Date January 4, 1960

Operator Shell Oil Company Lease Madison-Federal
Well No. 3 Unit Letter H Section 26 Township 28N Range 33E NMPM
Located 660 Feet From corner Line, 660 Feet From corner Line ED
County Lea G. L. Elevation not available Dedicated Acreage 10 Acres
Name of Producing Formation Tobacco-Sierra River Pool Wildcat

1. Is the Operator the only owner* in the dedicated acreage outlined on the plat below? Yes 2 No _____.
2. If the answer to question one is "no," have the interests of all the owners been consolidated by communitization agreement or otherwise? Yes _____ No _____. If answer is "yes," Type of Consolidation _____
3. If the answer to question two is "no," list all the owners and their respective interests below:

Owner

Land Description

ILLEGIBLE

Section B

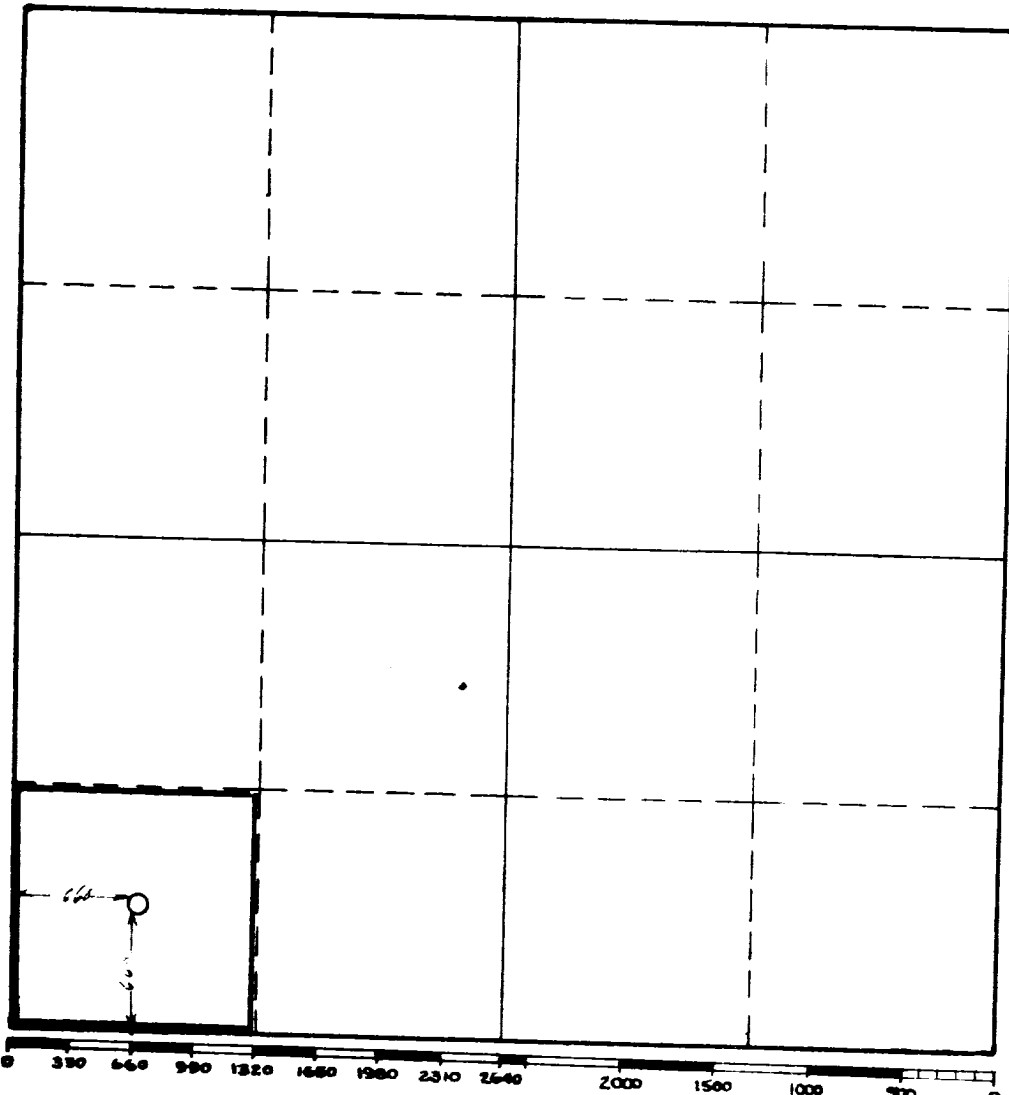

This is to certify that the information in Section A above is true and complete to the best of my knowledge and belief.

Shell Oil Company
(Operator)

Original Signed By
R. A. Lowery R. A. LOWERY
(Representative)

Box 845, Roswell, New Mexico
Address

This is to certify that the well location shown on the plat in Section B was plotted from field notes of actual surveys made by me or under my supervision and that the same is true and correct to the best of my knowledge and belief.

Date Surveyed Dec 31, 1959

Ed Bauman
Registered Professional
Engineer and/or Land Surveyor.

Certificate No. 3068

(See instructions for completing this form)