

**WELL LOCATION AND ACREAGE DEDICATION PLAT**

SEE INSTRUCTIONS FOR COMPLETING THIS FORM ON THE REVERSE SIDE

**SECTION A**

Operator: Cactus Drilling Co. Lease: 1590 APR 27 AM 9:35 Well No. 4  
 Unit Letter: H Section: 31 Township: 19 South Range: 35 East County: Lea County  
 Actual Footage Location of Well: 330 feet from the East line and 1650 feet from the North line  
 Ground Level Elev. 3722.6 Producing Formation Luzen Pool Pearl Luzen Dedicated Acreage: 40 Acres

1. Is the Operator the only owner in the dedicated acreage outlined on the plat below? YES  NO  ("Owner" means the person who has the right to drill into and to produce from any pool and to appropriate the production either for himself or for himself and another. (65-3-29 (e) NMSA 1935 Comp.)
2. If the answer to question one is "no," have the interests of all the owners been consolidated by communitization agreement or otherwise? YES  NO . If answer is "yes," Type of Consolidation \_\_\_\_\_
3. If the answer to question two is "no," list all the owners and their respective interests below:

Owner	Land Description

**SECTION B**

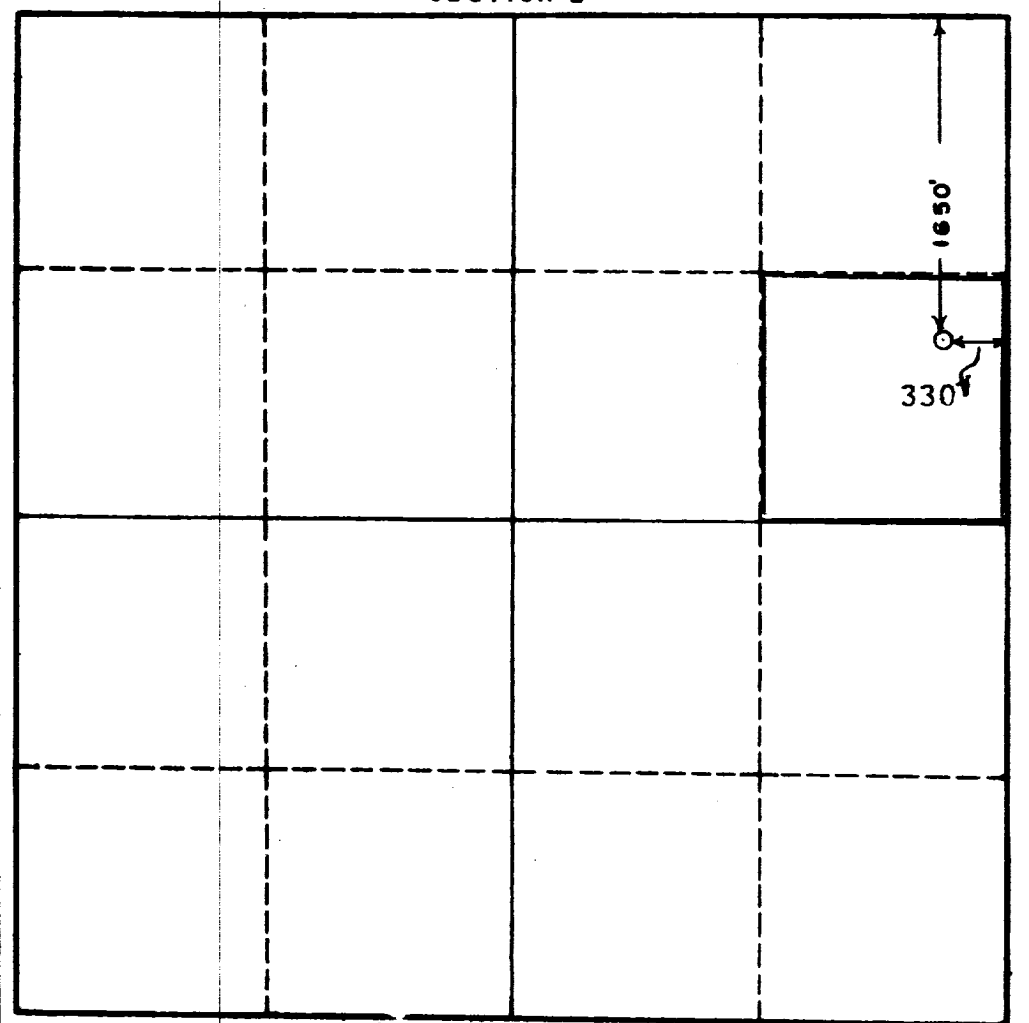

**CERTIFICATION**

I hereby certify that the information in SECTION A above is true and complete to the best of my knowledge and belief.

Name: Leag. Baker  
 Position: Vice-President  
 Company: Cactus Drilling Co.  
 Date: \_\_\_\_\_

I hereby certify that the information shown on this plat in SECTION B was plotted from field notes of actual surveys made by me or under my supervision, and that the same is true and correct to the best of my knowledge and belief.

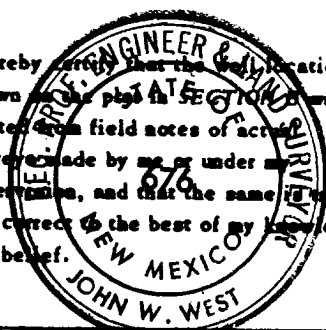

Date Surveyed: 4-26-60  
 Registered Professional Engineer and/or Land Surveyor, JOHN W. WEST  
 Signature: John W. West  
 Certificate No. \_\_\_\_\_  
 N. M. - P. E. & L. S. NO. 676

