

Form 9-331a  
(Feb. 1951)

SEP 15 1961 (SUBMIT IN TRIPLICATE)

HOBBS

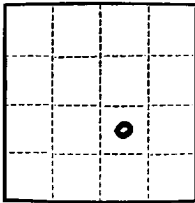

E. W. STANDLEY UNITED STATES  
DISTRICT ENGINEER DEPARTMENT OF THE INTERIOR  
GEOLOGICAL SURVEY

Land Office \_\_\_\_\_  
Lease No. L.C. 06031  
Unit Federal

1961 SEP 10 AM 9 53

SUNDRY NOTICES AND REPORTS ON WELLS

NOTICE OF INTENTION TO DRILL.....	<input checked="" type="checkbox"/>	SUBSEQUENT REPORT OF WATER SHUT-OFF.....	
NOTICE OF INTENTION TO CHANGE PLANS.....		SUBSEQUENT REPORT OF SHOOTING OR ACIDIZING.....	
NOTICE OF INTENTION TO TEST WATER SHUT-OFF.....		SUBSEQUENT REPORT OF ALTERING CASING.....	
NOTICE OF INTENTION TO RE-DRILL OR REPAIR WELL.....		SUBSEQUENT REPORT OF RE-DRILLING OR REPAIR.....	
NOTICE OF INTENTION TO SHOOT OR ACIDIZE.....		SUBSEQUENT REPORT OF ABANDONMENT.....	
NOTICE OF INTENTION TO PULL OR ALTER CASING.....		SUPPLEMENTARY WELL HISTORY.....	
NOTICE OF INTENTION TO ABANDON WELL.....			

(INDICATE ABOVE BY CHECK MARK NATURE OF REPORT, NOTICE, OR OTHER DATA)

September 14, 19 61

Well No. 3 is located 1980 ft. from S line and 1980 ft. from E line of sec. 4  
NW/4 SE/4 Sec. 4 20 S 35 E N.M.P.M.  
(1/4 Sec. and Sec. No.) (Twp.) (Range) (Meridian)  
Pearl-Queen Lea N.M.  
(Field) (County or Subdivision) (State or Territory)

The elevation of the derrick floor above sea level is \_\_\_\_\_ ft.

DETAILS OF WORK

(State names of and expected depths to objective sands; show sizes, weights, and lengths of proposed casings; indicate mudding jobs, cementing points, and all other important proposed work)

Propose to:

1. Drill with rotary tools to 5100' TD.
2. Set a minimum of 200' of 8-5/8" - 24# casing and circulate cement to surface.
3. Cement 5-1/2" - 15.5# new casing at TD with sufficient cement to come above the base of the salt.

I understand that this plan of work must receive approval in writing by the Geological Survey before operations may be commenced.

Company JAMES G. BROWN & ASSOCIATES

Address P. O. Box 1625

Midland, Texas

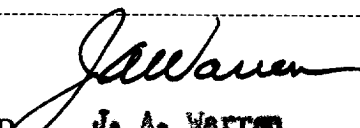
By   
J. A. Warren

Title Production Superintendent

**NEW MEXICO OIL CONSERVATION COMMISSION  
WELL LOCATION AND ACREAGE DEDICATION PLAT**

FORM C-125  
Revised 5/1/57

SEE INSTRUCTIONS FOR COMPLETING THIS FORM ON THE REVERSE SIDE

SECTION A 19 AM 9 55

Operator <b>James G. Brown &amp; Associates</b>		Lease <b>Federal</b>		Well No. <b>3</b>
Unit Letter <b>J</b>	Section <b>4</b>	Township <b>20 South</b>	Range <b>35 East</b>	County <b>Lea</b>
Actual Footage Location of Well: <b>1980</b> feet from the <b>South</b> line and <b>1980</b> feet from the <b>East</b> line				
Ground Level Elev. <b>3675</b>	Producing Formation <b>Queen</b>	Pool <b>Pearl Queen</b>	Dedicated Acreage: <b>40</b> Acres	

1. Is the Operator the only owner in the dedicated acreage outlined on the plat below? YES \_\_\_\_\_ NO  . ("Owner" means the person who has the right to drill into and to produce from any pool and to appropriate the production either for himself or for himself and another. (65-3-29 (e) NMSA 1935 Comp.)
2. If the answer to question one is "no," have the interests of all the owners been consolidated by communitization agreement or otherwise? YES \_\_\_\_\_ NO  . If answer is "yes," Type of Consolidation \_\_\_\_\_
3. If the answer to question two is "no," list all the owners and their respective interests below:

Owner	Land Description
<b>Gulf Oil Corp. has rights below 5100 feet.</b>	

SECTION B

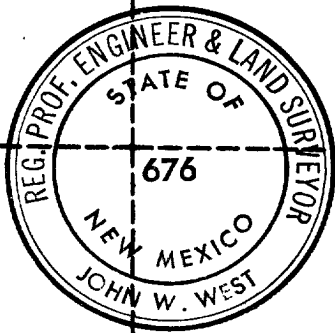
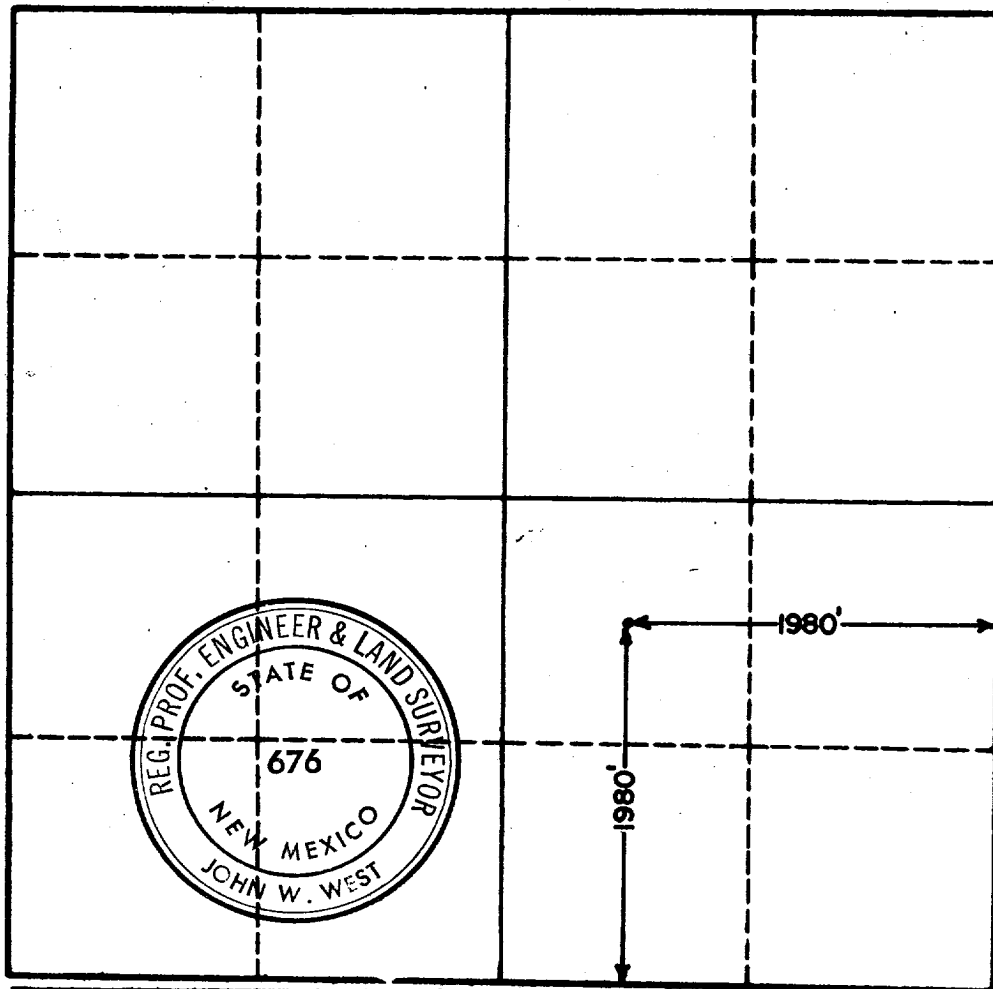

CERTIFICATION

I hereby certify that the information in SECTION A above is true and complete to the best of my knowledge and belief.

Name	<i>J. W. Brown</i>
Position	<b>Prod. Superintendent</b>
Company	<b>James G. Brown &amp; Associates</b>
Date	<b>9-14-61</b>

I hereby certify that the well location shown on the plat in SECTION B was plotted from field notes of actual surveys made by me or under my supervision, and that the same is true and correct to the best of my knowledge and belief.

Date Surveyed	<b>10-1-60</b>
Registered Professional Engineer and/or Land Surveyor,	<b>JOHN W. WEST</b>
Certificate No.	<i>John W. West</i>
N. M. - P. E. & L. S. NO. 676	

