

APPROVED

Budget Bureau No. 42-R358.4
Approval expires 12-31-60.

Form 9-331a
(Feb. 1961)

OCT 3 1961

(SUBMIT IN TRIPLICATE)

Land Office Las Cruces

Lease No. 060001

Unit Federal

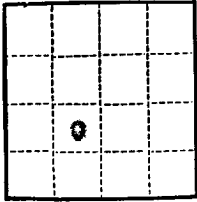

E. W. STANDLEY
DISTRICT ENGINEER

UNITED STATES
DEPARTMENT OF THE INTERIOR
GEOLOGICAL SURVEY

SUNDRY NOTICES AND REPORTS ON WELLS

NOTICE OF INTENTION TO DRILL.....	<input checked="" type="checkbox"/>	SUBSEQUENT REPORT OF WATER SHUT-OFF.....	
NOTICE OF INTENTION TO CHANGE PLANS.....		SUBSEQUENT REPORT OF SHOOTING OR ACIDIZING.....	
NOTICE OF INTENTION TO TEST WATER SHUT-OFF.....		SUBSEQUENT REPORT OF ALTERING CASING.....	
NOTICE OF INTENTION TO RE-DRILL OR REPAIR WELL.....		SUBSEQUENT REPORT OF RE-DRILLING OR REPAIR.....	
NOTICE OF INTENTION TO SHOOT OR ACIDIZE.....		SUBSEQUENT REPORT OF ABANDONMENT.....	
NOTICE OF INTENTION TO PULL OR ALTER CASING.....		SUPPLEMENTARY WELL HISTORY.....	
NOTICE OF INTENTION TO ABANDON WELL.....			

(INDICATE ABOVE BY CHECK MARK NATURE OF REPORT, NOTICE, OR OTHER DATA)

September 30, 1961

Well No. 6 is located ^{1650 DWW}~~1980~~ ft. from ^{XNK}S line and ^{XEX}~~1980~~ ft. from W line of sec. 4

N2 1/4 SW 1/4 Sec. 4 (1/4 Sec. and Sec. No.) 20 S (Twp.) 35 E (Range) NMPM (Meridian)
Pearl-Queen (L.M.) (Field) Lee (County or Subdivision) New Mexico (State or Territory)

The elevation of the derrick floor above sea level is 3690 ft. Set.

DETAILS OF WORK

(State names of and expected depths to objective sands; show sizes, weights, and lengths of proposed casings; indicate mudding jobs, cementing points, and all other important proposed work)

Propose to:

1. Drill with rotary tools to test Queen sands to 3100' TD.
2. Set a minimum of 200' of 8-5/8" - 24# surface casing and circulate cement to surface.
3. Cement 5-1/2" - 15.5# new J-55 casing at TD with sufficient cement to come above the base of the salt.

I understand that this plan of work must receive approval in writing by the Geological Survey before operations may be commenced.

Company James G. Brown and Associates

Address P. O. Box 1625

Midland, Texas

By Jawarun

Title Production Superintendent

NEW MEXICO OIL CONSERVATION COMMISSION
WELL LOCATION AND ACREAGE DEDICATION PLAT

FORM C-128
Revised 5/1/57

SEE INSTRUCTIONS FOR COMPLETING THIS FORM ON THE REVERSE SIDE

1961 SECTION A/M 9 01				
Operator James G. Brown & Associates			Lease Federal	
			Well No. 6	
Unit Letter K	Section 4	Township 20 South	Range 35 East	County Lea
Actual Footage Location of Well: 1650 feet from the South line and 1980 feet from the West line				
Ground Level Elev. 3672	Producing Formation Queen		Pool Pearl Queen	Dedicated Acreage: 40 Acres

1. Is the Operator the only owner in the dedicated acreage outlined on the plat below? YES _____ NO . ("Owner" means the person who has the right to drill into and to produce from any pool and to appropriate the production either for himself or for himself and another. (65-3-29 (e) NMSA 1935 Comp.)
2. If the answer to question one is "no," have the interests of all the owners been consolidated by communitization agreement or otherwise? YES _____ NO . If answer is "yes," Type of Consolidation _____
3. If the answer to question two is "no," list all the owners and their respective interests below:

Owner	Land Description
Gulf Oil Corp. is owner below 5100'.	

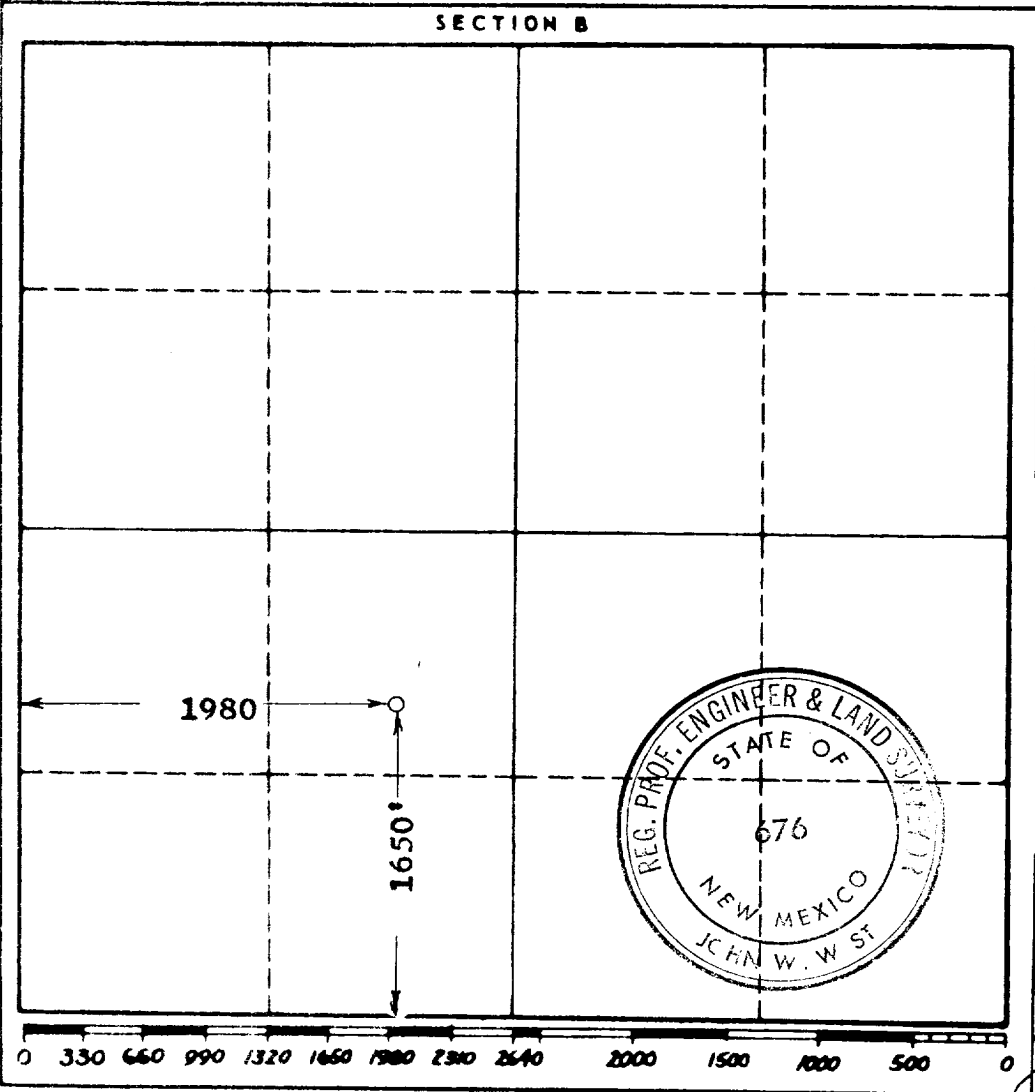

CERTIFICATION

I hereby certify that the information in SECTION A above is true and complete to the best of my knowledge and belief.

John W. West

Name _____

By *John W. West*

Position **Supt. of Production**

Company **James G. Brown & Assoc.**

Date **Oct 2, 1961**

I hereby certify that the well location shown on the plat in SECTION B was plotted from field notes of actual surveys made by me or under my supervision, and that the same is true and correct to the best of my knowledge and belief.

Date Surveyed **9-27-1961**

Registered Professional Engineer and/or Land Surveyor, **JOHN W. WEST**

John W. West

Certificate No. **N.M. - P.E. & L.S. NO. 676**