

APPROVED

SUBJECT TO IT  
NOV 10 1960

Budget Bureau No. 42-R358.4  
Approval expires 12-31-60.

Form 9-331a  
(Feb. 1961)

(SUBMIT IN TRIPLICATE)

Land Office Santa Fe  
L.C. Osby  
Lease No. 1-1/8 of 11/4 Section 9  
Unit T-204, 2-35  
Tanque County, New Mexico

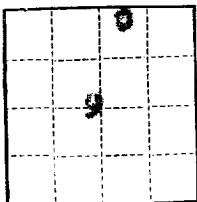

E. W. STANDLEY  
DISTRICT ENGINEER

UNITED STATES  
DEPARTMENT OF THE INTERIOR  
GEOLOGICAL SURVEY

RECORDED

SUNDRY NOTICES AND REPORTS ON WELLS NOV 10 1960

NOTICE OF INTENTION TO DRILL.....	<input checked="" type="checkbox"/>	SUBSEQUENT REPORT OF WATER SHUT-OFF.....	
NOTICE OF INTENTION TO CHANGE PLANS.....		SUBSEQUENT REPORT OF SHOOTING OR ACIDIZING.....	
NOTICE OF INTENTION TO TEST WATER SHUT-OFF.....		SUBSEQUENT REPORT OF ALTERING CASING.....	
NOTICE OF INTENTION TO RE-DRILL OR REPAIR WELL.....		SUBSEQUENT REPORT OF RE-DRILLING OR REPAIR.....	
NOTICE OF INTENTION TO SHOOT OR ACIDIZE.....		SUBSEQUENT REPORT OF ABANDONMENT.....	
NOTICE OF INTENTION TO PULL OR ALTER CASING.....		SUPPLEMENTARY WELL HISTORY.....	
NOTICE OF INTENTION TO ABANDON WELL.....			

(INDICATE ABOVE BY CHECK MARK NATURE OF REPORT, NOTICE, OR OTHER DATA)

November 8, 1960

Federal Numbers

Well No. A is located 330 ft. from N line and 1900 ft. from E line of sec. 9  
1/4 11/4 Section 9 20-3 35-4 RSM  
(1/4 Sec. and Sec. No.) (Twp.) (Range) (Meridian)  
Undesignated Los County New Mexico  
(Field) (County or Subdivision) (State or Territory)

The elevation of the derrick floor above sea level is 3574.4 ft. Q.L.

DETAILS OF WORK

ILLEGIBLE

(State names of and expected depths to objective sands; show sizes, weights, and lengths of proposed casings; indicate mudding jobs, cementing points, and all other important proposed work)

The objective sand is the Queen Formation. The anticipated depth is an approx. 4935'. Estimated TD 5050'.

Proposed Casing program:

350' of 8-5/8" casing cemented to surface  
5050' of 5-1/2" casing cemented with 300 sacks.

Well to be drilled with rotary tools.

\* Sufficient cement be placed behind the 5 1/2" to fill above the base of the salt section.

I understand that this plan of work must receive approval in writing by the Geological Survey before operations may be commenced.

Company NORTHERN UNION GAS COMPANY

Address Fidelity Union Tower Building

Dallas, Texas

By J. E. Munnich  
L. E. Munnich

Title Exploration Engineer

**NEW MEXICO OIL CONSERVATION COMMISSION**  
**WELL LOCATION AND ACREAGE DEDICATION PLAT**

FORM C-128  
 Revised 5/1/57

SEE INSTRUCTIONS FOR COMPLETING THIS FORM ON THE REVERSE SIDE

**SECTION A**

Operator <b>Southern Union Gas Company</b>		Lease <b>1960 NOV 10 AM 8:17</b>		Well No. <b>1</b>
Unit Letter <b>B</b>	Section <b>9</b>	Township <b>20 South</b>	Range <b>35 East</b>	County <b>Lea</b>
Actual Footage Location of Well: <b>330</b> feet from the <b>North</b> line and <b>1980</b> feet from the <b>East</b> line				
Ground Level Elev. <b>3674.4 ft.</b>	Producing Formation <b>Galena</b>	Pool <b>Undesignated</b>	Dedicated Acreage: <b>0.00</b> Acres	

1. Is the Operator the only owner in the dedicated acreage outlined on the plat below? YES  NO  ("Owner" means the person who has the right to drill into and to produce from any pool and to appropriate the production either for himself or for himself and another. (65-3-29 (e) NMSA 1955 Comp.)
2. If the answer to question one is "no," have the interests of all the owners been consolidated by communitization agreement or otherwise? YES  NO . If answer is "yes," Type of Consolidation \_\_\_\_\_
3. If the answer to question two is "no," list all the owners and their respective interests below:

Owner	Land Description

**RECEIVED**  
**NOV 10 1960**  
 U. S. GEOLOGICAL SURVEY  
 HOBBS

**SECTION B**

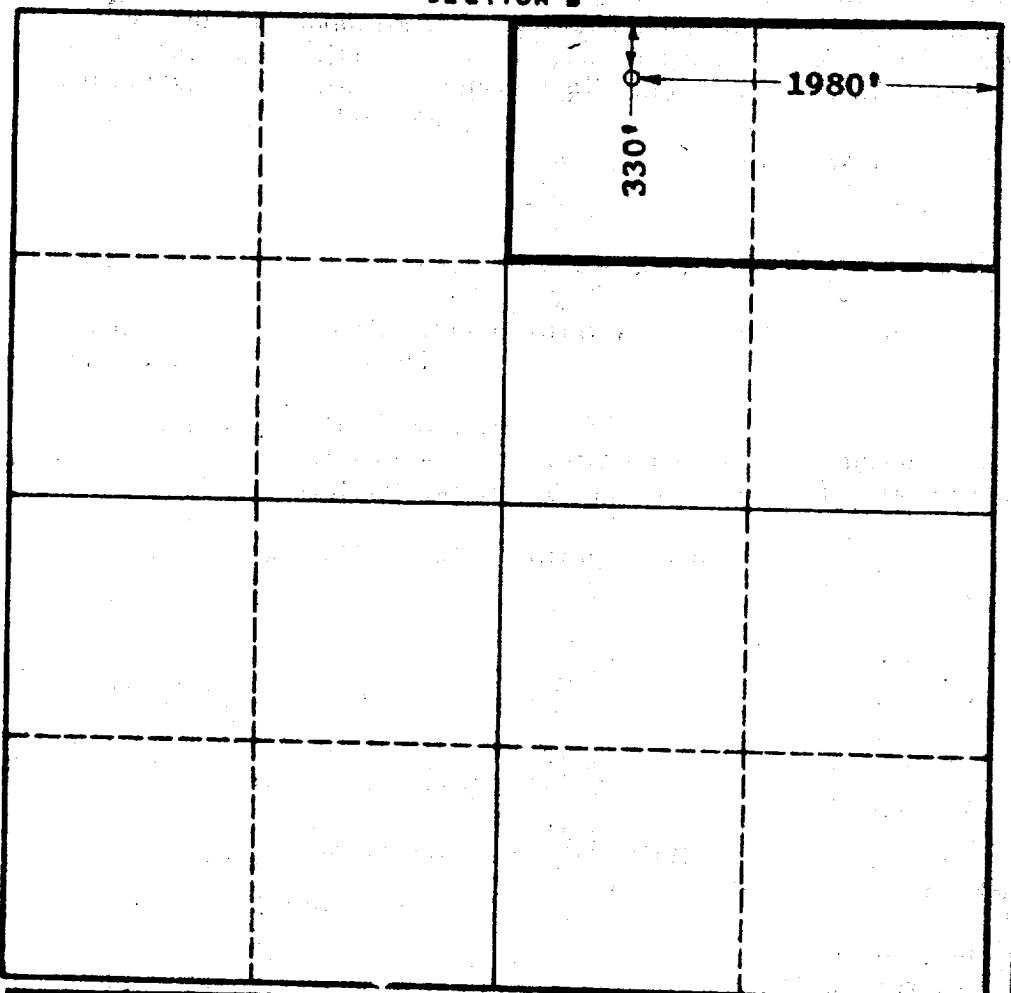

**CERTIFICATION**

I hereby certify that the information in SECTION A above is true and complete to the best of my knowledge and belief.

*J. L. Munn*  
 Name **J. L. Munn**  
 Position **Exploration Engineer**  
 Company **SOUTHERN UNION GAS CO.**  
 Date **November 8, 1960**

I hereby certify that the well location shown on the plat in SECTION B was plotted from field notes of actual surveys made by me or under my supervision, and that the same is true and correct to the best of my knowledge and belief.

Date Surveyed **October 21, 1960**  
 Registered Professional Engineer and Land Surveyor **JOHN W. WEST**  
 Certificate No. **876**  
 State of **NEW MEXICO**  
 N. M. **JOHN W. WEST**

