

APPROVED

COPY TO O. C. G.

Budget Bureau No. 42-R368.4
Approval expires 12-31-60.

Form 9-331a
(Feb. 1951)

JUN 21 1961

(SUBMIT IN TRIPLICATE)

Land Office **Santa Fe**
L.C. 065649

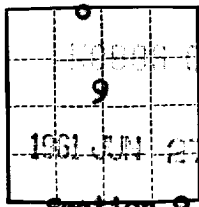

Section 9

EDWARD STANLEY
DISTRICT ENGINEER

UNITED STATES
DEPARTMENT OF THE INTERIOR
GEOLOGICAL SURVEY

Lease No. **NE/4 NW/4 Section 9**
Unit **T-208, R-35 East in Lea County, New Mexico**

AM 8 09

SUNDRY NOTICES AND REPORTS ON WELLS

NOTICE OF INTENTION TO DRILL.....	<input checked="" type="checkbox"/>	SUBSEQUENT REPORT OF WATER SHUT-OFF.....	<input type="checkbox"/>
NOTICE OF INTENTION TO CHANGE PLANS.....	<input type="checkbox"/>	SUBSEQUENT REPORT OF SHOOTING OR ACIDIZING.....	<input type="checkbox"/>
NOTICE OF INTENTION TO TEST WATER SHUT-OFF.....	<input type="checkbox"/>	SUBSEQUENT REPORT OF ALTERING CASING.....	<input type="checkbox"/>
NOTICE OF INTENTION TO RE-DRILL OR REPAIR WELL.....	<input type="checkbox"/>	SUBSEQUENT REPORT OF RE-DRILLING OR REPAIR.....	<input type="checkbox"/>
NOTICE OF INTENTION TO SHOOT OR ACIDIZE.....	<input type="checkbox"/>	SUBSEQUENT REPORT OF ABANDONMENT.....	<input type="checkbox"/>
NOTICE OF INTENTION TO PULL OR ALTER CASING.....	<input type="checkbox"/>	SUPPLEMENTARY WELL HISTORY.....	<input type="checkbox"/>
NOTICE OF INTENTION TO ABANDON WELL.....	<input type="checkbox"/>		

(INDICATE ABOVE BY CHECK MARK NATURE OF REPORT, NOTICE, OR OTHER DATA)

June 12, 1961

Federal Saunders

Well No. **No. 4** is located **330** ft. from **N** line and **1980** ft. from **W** line of sec. **9**
NE/4 NW/4 of Sec. 9 **20-S** **35-E** **N.M.P.M.**
Pearl Queen **Lea County** **New Mexico**
(1/4 Sec. and Sec. No.) (Twp.) (Range) (Meridian) (Field) (County or Subdivision) (State or Territory)

The elevation of the derrick floor above sea level is **3675.2** ft. **G.L.**

DETAILS OF WORK

(State names of and expected depths to objective sands; show sizes, weights, and lengths of proposed casings; indicate mudding jobs, cementing points, and all other important proposed work)

The objective sand is Queen Formation. The anticipated depth is approx. 4960' Estimated TD 5050'.

Proposed casing program.

200' of 8-5/8" casing cemented to surface
5,050' of 4-1/2" casing cemented w/400 sacks. **

Well to be drilled with rotary tools.

** Sufficient cement to fill above base of salt section.

I understand that this plan of work must receive approval in writing by the Geological Survey before operations may be commenced.

Company **SOUTHERN UNION PRODUCTION COMPANY**

Address **1434 Fidelity Union Tower**
Dallas, Texas

By **Robert J. Graf**
Robert J. Graf
Title **Exploration Engineer**

NEW MEXICO OIL CONSERVATION COMMISSION

FORM C-128
Revised 5/1/57

HOBBS OFFICE
WELL LOCATION AND ACREAGE DEDICATION PLAT

SEE INSTRUCTIONS FOR COMPLETING THIS FORM ON THE REVERSE SIDE

1961 JUN 27 AM 8:09

SECTION A

Operator Southern Union Gas Co.		Lease Federal Numbers		Well No. No. 4
Unit Letter C	Section 9	Township 20 South	Range 35 East	County Lea County
Actual Footage Location of Well: 1980 feet from the West line and 330 feet from the North line				
Ground Level Elev. 3675.2	Producing Formation Queen	Pool Pearl Queen	Dedicated Acreage: 40 Acres	

1. Is the Operator the only owner in the dedicated acreage outlined on the plat below? YES NO ("Owner" means the person who has the right to drill into and to produce from any pool and to appropriate the production either for himself or for himself and another. (65-3-29 (e) NMSA 1955 Comp.)
2. If the answer to question one is "no," have the interests of all the owners been consolidated by communitization agreement or otherwise? YES NO . If answer is "yes," Type of Consolidation _____
3. If the answer to question two is "no," list all the owners and their respective interests below:

Owner	Land Description

SECTION B

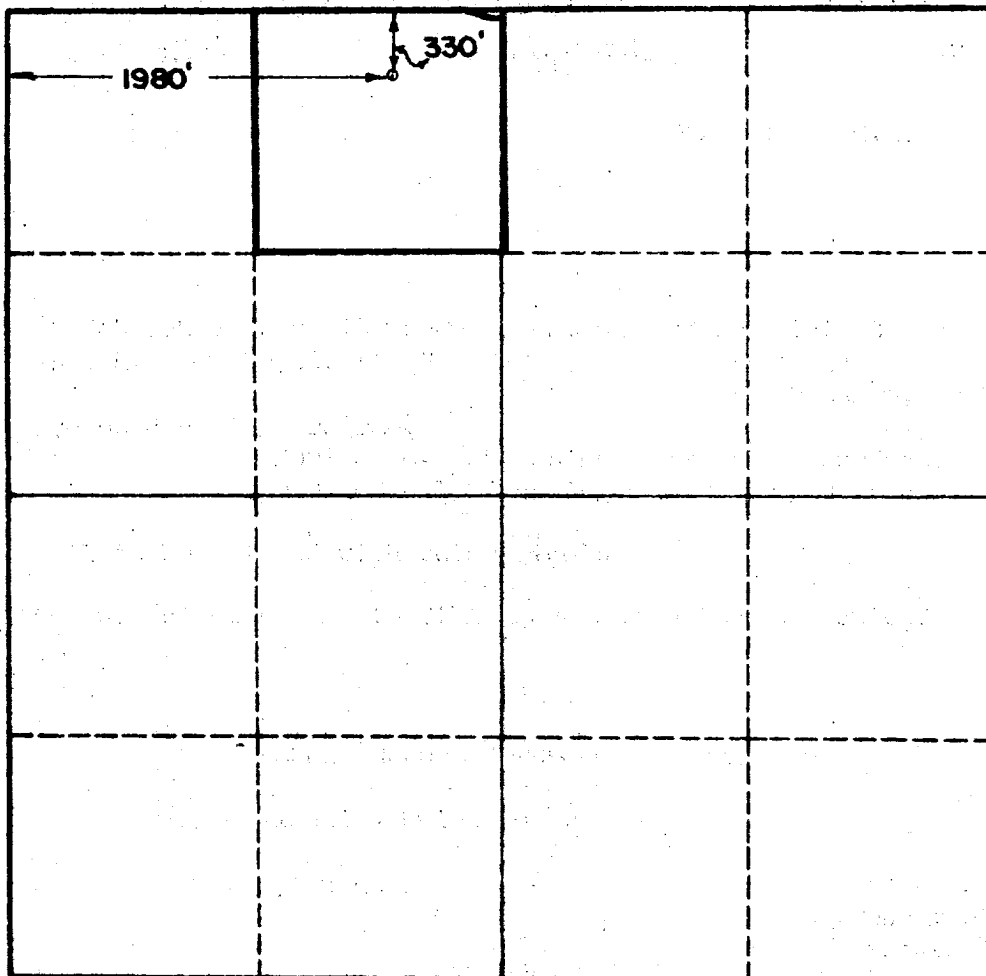

CERTIFICATION

I hereby certify that the information in SECTION A above is true and complete to the best of my knowledge and belief.

R. J. Graf
Name **R. J. Graf**
Exploration Engineer

Position
Southern Union Production Co.

Company
June 12, 1961

Date

I hereby certify that the well location shown on the plat in SECTION B was plotted from field notes or actual surveys made by me or under my supervision, and that the same are true and correct to the best of my knowledge and belief.

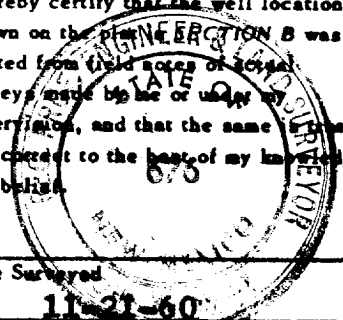

Date Surveyed
11-21-60

Registered Professional Engineer and/or Land Surveyor, **JOHN W. WEST**

John W. West
Certificate No.
N. M. - P. E. & L. S. NO. 675

