

NEW MEXICO OIL CONSERVATION COMMISSION
Santa Fe, New Mexico

Form C-101
 Revised (12/1/55)

NOTICE OF INTENTION TO DRILL

Notice must be given to the District Office of the Oil Conservation Commission and approval obtained before drilling or recompletion begins. If changes in the proposed plan are considered advisable, a copy of this notice showing such changes will be returned to the sender. Submit this notice in **QUINTUPLICATE**. One copy will be returned following approval. See additional instructions in Rules and Regulations of the Commission. If State Land submit 6 Copies Attach Form C- 128 in triplicate to first 3 copies of form C-101

Midland, Texas

(Place)

July 29, 1958

(Date)

OIL CONSERVATION COMMISSION
 SANTA FE, NEW MEXICO

Gentlemen:

You are hereby notified that it is our intention to commence the Drilling of a well to be known as

Southern Minerals Corporation

(Company or Operator)

Simmons - State of New Mexico

(Lease)

Well No. **1**, in **D** (Unit) The well is

located **63.9** feet from the **North** line and **1905.6** feet from the **East** line of Section **4**, T **19-South**, R **36-East**, NMPM.

(GIVE LOCATION FROM SECTION LINE) **Midland** Pool, **Los** County

If State Land the Oil and Gas Lease is No. **B-7263-3**

If patented land the owner is.....

Address.....

We propose to drill well with drilling equipment as follows: **Rotary to Approximately 1700-1800 feet - Complete with Cable Tools.**

The status of plugging bond is: **Blanket Bond Filed with Commission.**

Drilling Contractor **Cactus Drilling Company**
El Paso, New Mexico

We intend to complete this well in the **San Andres** formation at an approximate depth of **5500** feet.

CASING PROGRAM

We propose to use the following strings of Casing and to cement them as indicated:

Size of Hole	Size of Casing	Weight per Foot	New or Second Hand	Depth	Sacks Cement
18"	13 3/8	40#	New	250'	180
18"	8 5/8	24#	Good Sec. Hand	1800'	Agassal Mat
7 7/8"	5 1/2	15#	New	5500'	250

If changes in the above plans become advisable we will notify you immediately.

ADDITIONAL INFORMATION (If recompletion give full details of proposed plan of work.)

Approved....., 19.....
 Except as follows:

CEMENT MUST BE CIRCULATED DEEP
13 3/8 CASING
OIL CONSERVATION COMMISSION

By *[Signature]*

Sincerely yours,

SOUTHERN MINERALS CORPORATION
 (Company or Operator)

By *[Signature]* **J. Samples**

Position **District Manager**
 Send Communications regarding well to

Name **Southern Minerals Corporation**

Address **P.O. Box 1816, Midland, Texas**

NEW MEXICO OIL CONSERVATION COMMISSION

Well Location and Acreage Dedication Plat

Section A.

Date July 28, 1958

Operator SOUTHERN MINERALS CORPORATION Lease SIMMONS-STATE OF NEW MEXICO
 Well No. 1 Unit Letter B Section 4 Township 19 South Range 36 East NMPM
 Located 643.9 Feet From North Line, 1985.6 Feet From East Line
 County Lea G. L. Elevation 3805 Dedicated Acreage 39.42 Acres
 Name of Producing Formation _____ Pool Wildcat

1. Is the Operator the only owner* in the dedicated acreage outlined on the plat below?
 Yes No
2. If the answer to question one is "no," have the interests of all the owners been consolidated by communitization agreement or otherwise? Yes No . If answer is "yes," Type of Consolidation _____
3. If the answer to question two is "no," list all the owners and their respective interests below:

<u>Owner</u>	<u>Land Description</u>

Section B

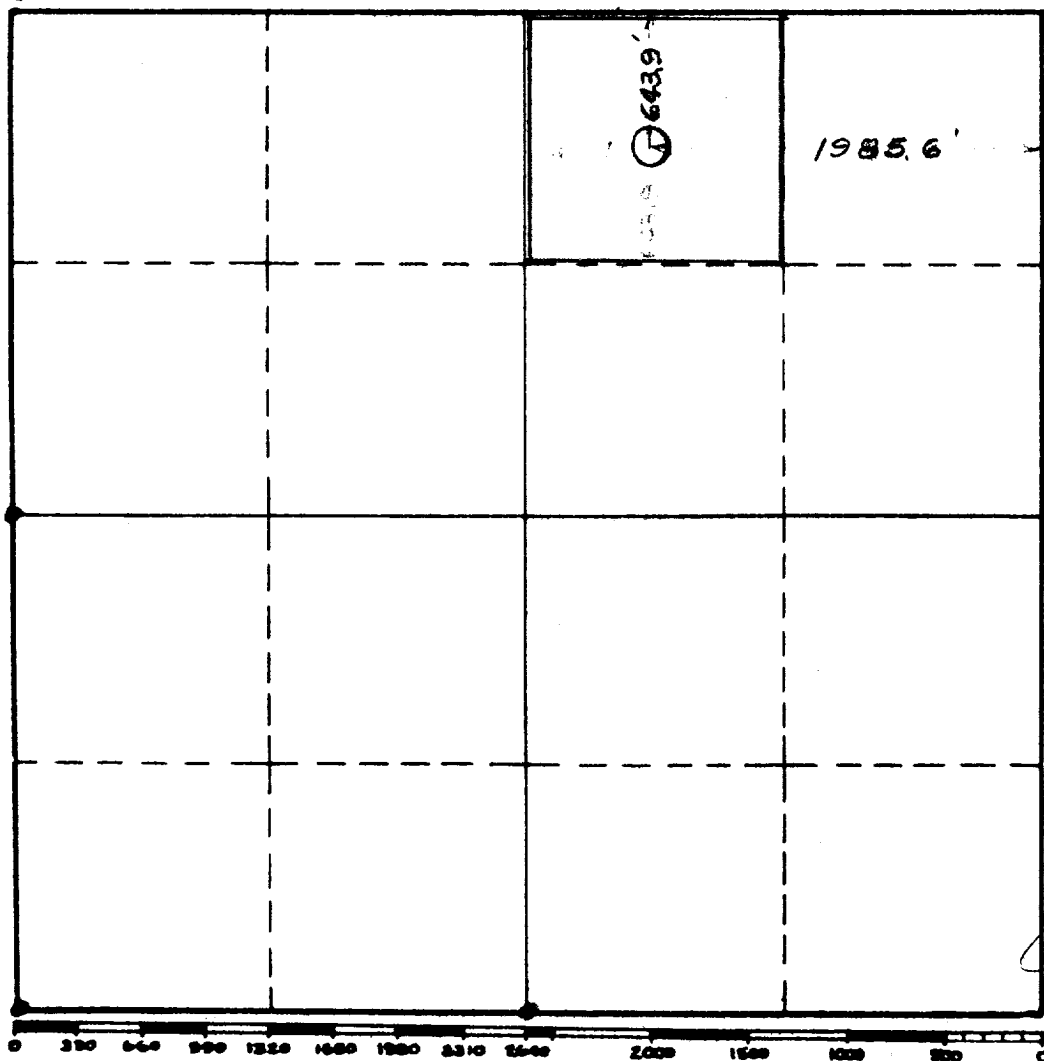

This is to certify that the information in Section A above is true and complete to the best of my knowledge and belief.

SOUTHERN MINERALS CORPORATION
 (Operator)
J. Samples
 (Representative)
P.O. Box 1816
Midland, Texas
 Address

This is to certify that the well location shown on the plat in Section B was plotted from field notes of actual surveys made by me or under my supervision and that the same is true and correct to the best of my knowledge and belief.

Date Surveyed July 25, 1958
John W. Pheasant
 Registered Professional Engineer and/or Land Surveyor.

Certificate No. 1559