

NEW MEXICO  
OIL CONSERVATION COMMISSION

Form C-128

Well Location and/or Gas Proration Plat

Date 2-18-56

Operator AMERADA PET. CORP. Lease STATE WMD

Well No. 2 Section 15 Township 19S Range 36E NMPM

Located 1980 Feet From SOUTH Line, 660 Feet From EAST Line,  
LEA County, New Mexico. G. L. Elevation \_\_\_\_\_

Name of Producing Formation \_\_\_\_\_ Pool \_\_\_\_\_ Dedicated Acreage \_\_\_\_\_

(Note: All distances must be from outer boundaries of Section)

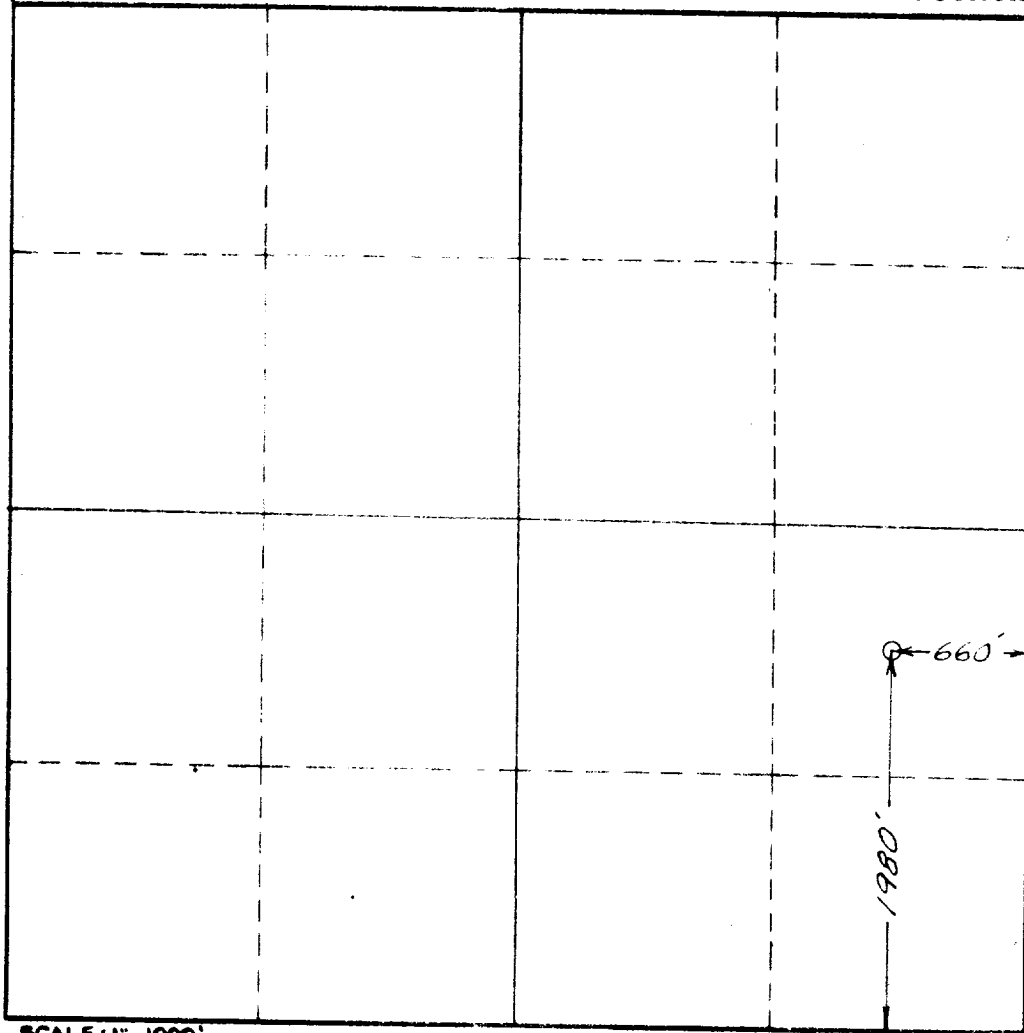

SCALE: 1" = 1000'

1. Is this Well a Dual Comp. ? Yes  No
2. If the answer to Question 1 is yes, are there any other dually completed wells within the dedicated acreage ? Yes  No

This is to certify that the above plat was prepared from field notes of actual surveys made by me or under my supervision and that the same are true and correct to the best of my knowledge and belief.

Name \_\_\_\_\_  
Position \_\_\_\_\_  
Representing \_\_\_\_\_  
Address \_\_\_\_\_

Date Surveyed 2-18-56  
John W. West  
Registered Professional Engineer and/or  
Land Surveyor