

NEW MEXICO  
OIL CONSERVATION COMMISSION

Form C-128

Well Location and/or Gas Proration Plat

Date 3-13-56

Operator SKELLY OIL CO. Lease HOBBS "B"

Well No. 1 Section 27 Township 19S Range 36E NMPM

Located 2315.9 Feet From WEST Line, 997 Feet From NORTH Line,

LEA County, New Mexico. G. L. Elevation \_\_\_\_\_

Name of Producing Formation \_\_\_\_\_ Pool \_\_\_\_\_ Dedicated Acreage \_\_\_\_\_

(Note: All distances must be from outer boundaries of Section)

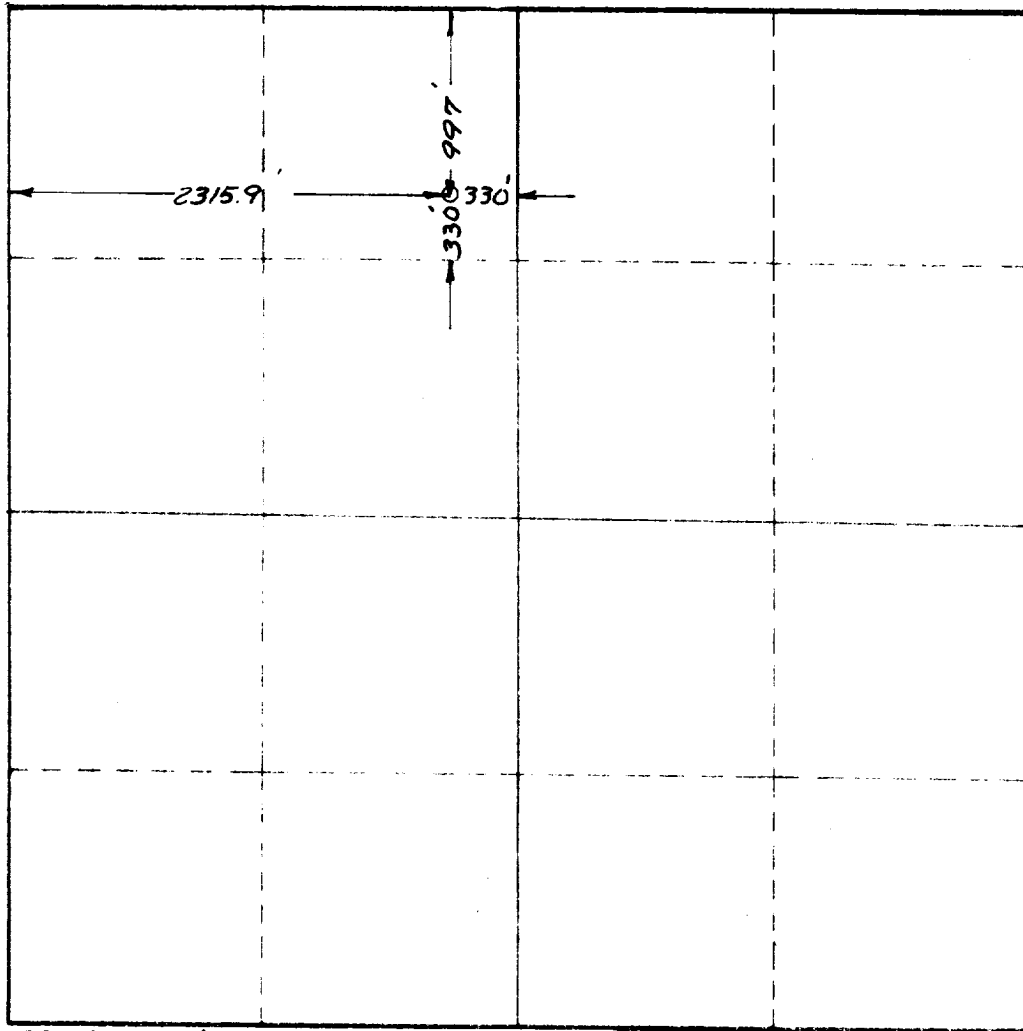

SCALE: 1" = 1000'

1. Is this Well a Dual Comp.? Yes \_\_\_ No X
2. If the answer to Question 1 is yes, are there any other dually completed wells within the dedicated acreage? Yes \_\_\_ No \_\_\_

This is to certify that the above plat was prepared from field notes of actual surveys made by me or under my supervision and that the same are true and correct to the best of my knowledge and belief.

Name [Signature]  
Position Dist. Supt.  
Representing Skelly Oil Company  
Address Box 38 - Hobbs, New Mexico

Date Surveyed 3-13-56  
[Signature]  
Registered Professional Engineer and/or  
Land Surveyor