

NORDBS OFFICE 000

STAKING PLAT

1904 SEP 13 AM 7:52

Reeler and Sheldon                      Smith                      2  
Operator                                      Lease                                      Well

Lee County, New Mexico

990 feet from west and 1980 feet from south lines of  
Section 34, Township 19, Range 36

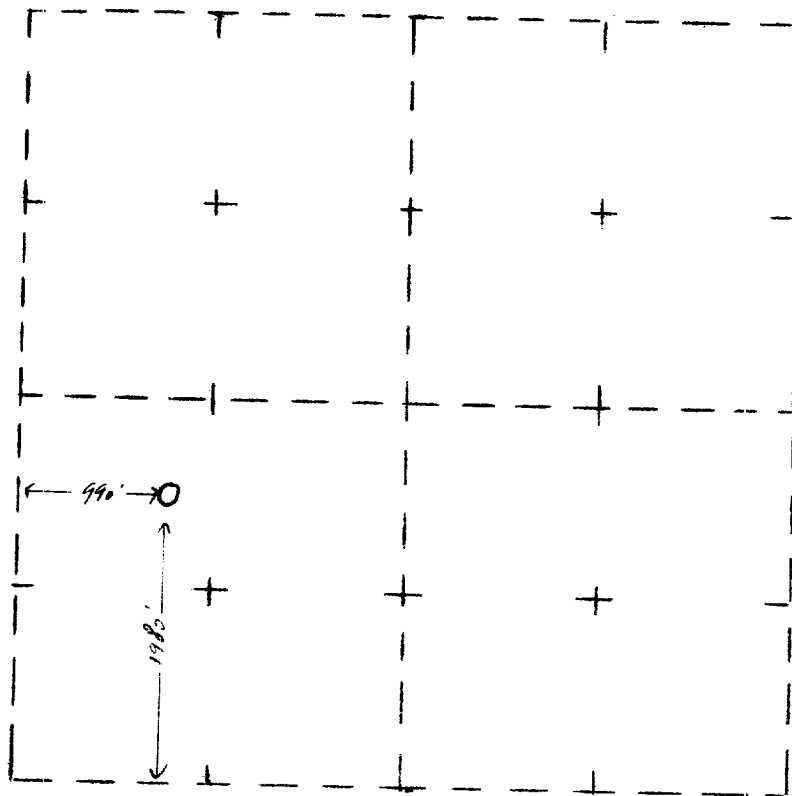

Certificate

The undersigned is registered as a Land Surveyor in the State of New Mexico and hereby swears that this plat was prepared from field notes made under his direction, and that it is true and correct to the best of his knowledge and belief.

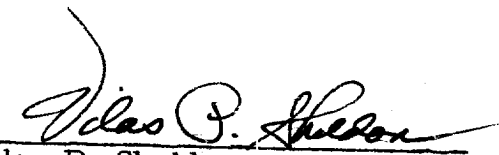
  
Vilas P. Sheldon

