

Producing

NO. OF COPIES RECEIVED	
DISTRIBUTION	
SANTA FE	
FILE	
U.S.G.S.	
LAND OFFICE	
OPERATOR	

NEW MEXICO OIL CONSERVATION COMMISSION

Form C-103
Supersedes Old
C-102 and C-103
Effective 1-1-65

5a. Indicate Type of Lease State <input checked="" type="checkbox"/> Fee <input type="checkbox"/>
5. State Oil & Gas Lease No. B-2656
7. Unit Agreement Name
8. Farm or Lease Name State AC Com
9. Well No. 1
10. Field and Pool, or Wildcat Eunice Monument GSA
12. County Lea

SUNDRY NOTICES AND REPORTS ON WELLS
(DO NOT USE THIS FORM FOR PROPOSALS TO DRILL OR TO DEEPEN OR PLUG BACK TO A DIFFERENT RESERVOIR.
USE "APPLICATION FOR PERMIT" (FORM C-101) FOR SUCH PROPOSALS.)

1. ☒ OIL WELL ☐ GAS WELL ☐ OTHER

2. Name of Operator
CONOCO INC.

3. Address of Operator
P. O. Box 460, Hobbs, N.M. 88240

4. Location of Well
UNIT LETTER L 1980 FEET FROM THE South LINE AND 660 FEET FROM
THE WEST LINE, SECTION 19 TOWNSHIP 19S RANGE 37E NMPM.

15. Elevation (Show whether DF, RT, GR, etc.)

15. Check Appropriate Box To Indicate Nature of Notice, Report or Other Data
NOTICE OF INTENTION TO:

PERFORM REMEDIAL WORK <input type="checkbox"/>	PLUG AND ABANDON <input type="checkbox"/>	REMEDIAL WORK <input type="checkbox"/>	ALTERING CASING <input type="checkbox"/>
TEMPORARILY ABANDON <input type="checkbox"/>	CHANGE PLANS <input type="checkbox"/>	COMMENCE DRILLING OPNS. <input type="checkbox"/>	PLUG AND ABANDONMENT <input type="checkbox"/>
PULL OR ALTER CASING <input type="checkbox"/>		CASING TEST AND CEMENT JOBS <input type="checkbox"/>	
OTHER <input type="checkbox"/>		OTHER <u>piping arrangement on csq strings</u> <input checked="" type="checkbox"/>	

17. Describe Proposed or Completed Operations (Clearly state all pertinent details, and give pertinent dates, including estimated date of starting any proposed work, SEE RULE 1103.

Wellhead has prod. casing and 3 other casings. The upper casing is facing south $21\frac{1}{2}''$ and $38''$ down. The middle casing is facing southwest $21\frac{1}{2}''$ and $69\frac{1}{2}''$ down. The lower casing is facing southwest $20''$ and $83''$ down.

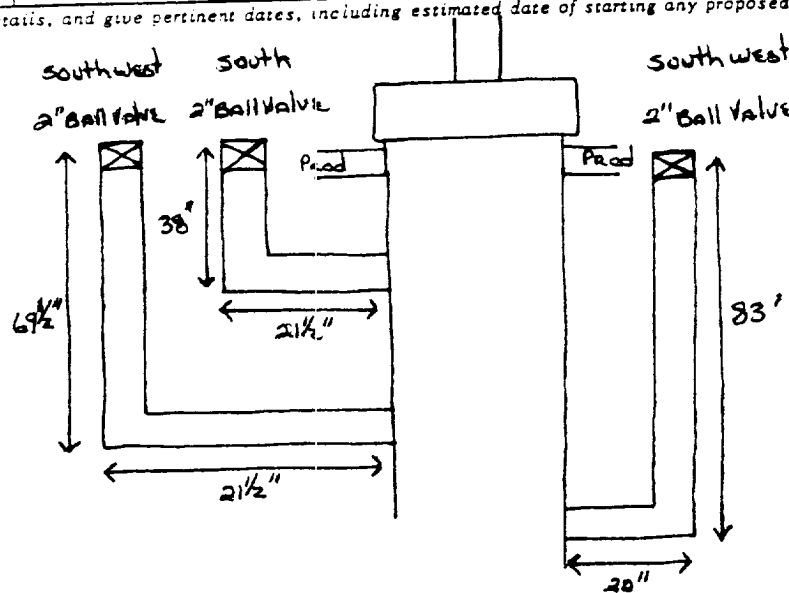

18. I hereby certify that the information above is true and complete to the best of my knowledge and belief.

SIGNED [Signature]

TITLE Head Maintenance Operator

DATE 6/12/86

APPROVED BY [Signature]

TITLE OIL & GAS INSPECTOR

DATE JUN 26 1986