

NEW MEXICO OIL CONSERVATION COMMISSION

Santa Fe, New Mexico

NOTICE OF INTENTION TO DRILL OR RECOMPLETE

Notice must be given to the District Office of the Oil Conservation Commission and approval obtained before drilling or recompletion begins. If changes in the proposed plan are considered advisable, a copy of this notice showing such changes will be returned to the sender. Submit this notice in QUINTUPLICATE. One copy will be returned following approval. See additional instructions in Rules and Regulations of the Commission.

Moriment, New Mexico

(Place)

December 14, 1956

(Date)

OIL CONSERVATION COMMISSION
SANTA FE, NEW MEXICO

Gentlemen:

You are hereby notified that it is our intention to commence the (Drilling) (~~Recompletion~~) of a well to be known as

Amerada Petroleum Corporation

(Company or Operator)

State EM "A"

(Lease)

Well No. **1**, in **L** (Unit) The well is

located **1980** feet from the **South** line and **660** feet from the

West line of Section **22**, T. **19-S**, R. **37-E**, NMPM.

(GIVE LOCATION FROM SECTION LINE) **Ement** Pool, **Lea** County

If State Land the Oil and Gas Lease is No. **A-1469**

If patented land the owner is

Address

We propose to drill well with drilling equipment as follows: **Rotary tools all the way**

The status of plugging bond is **Blanket**

Drilling Contractor **McQueen & Stout Drilling Company**

1601 West Texas Street

Midland, Texas

We intend to complete this well in the **Penrose**

formation at an approximate depth of **4250** feet.

CASING PROGRAM

We propose to use the following strings of Casing and to cement them as indicated:

Size of Hole	Size of Casing	Weight per Foot	New or Second Hand	Depth	Sacks Cement
12-1/4"	8-5/8"	24#	New	300'	250
7-7/8"	5-1/2"	15.5#	New	4250'	400

If changes in the above plans become advisable we will notify you immediately.

ADDITIONAL INFORMATION (If recompletion give full details of proposed plan of work.)

Approved _____, 19____
Except as follows:

OIL CONSERVATION COMMISSION

By *[Signature]*

Title _____

Sincerely yours,

Amerada Petroleum Corporation

(Company or Operator)

[Signature]
Foreman

Position **See Communications regarding well to**

Name **Amerada Petroleum Corporation**

Address **Drawer D**

Moriment, New Mexico

NEW MEXICO
IL CONSERVATION COMMIS N

Form C-128

Well Location and/or Gas Proration Plat

Date 12-13-56

Operator AMERADA PET. CORP

Lease STATE EMA

Well No. 1 Section 22 Township 19 SOUTH Range 37 EAST NMPM

Located 1980 Feet From SOUTH Line, 680 Feet From WEST Line,

LEA

County, New Mexico. G. L. Elevation

Name of Producing Formation _____ Pool _____ Dedicated Acreage _____

(Note: All distances must be from outer boundaries of Section)

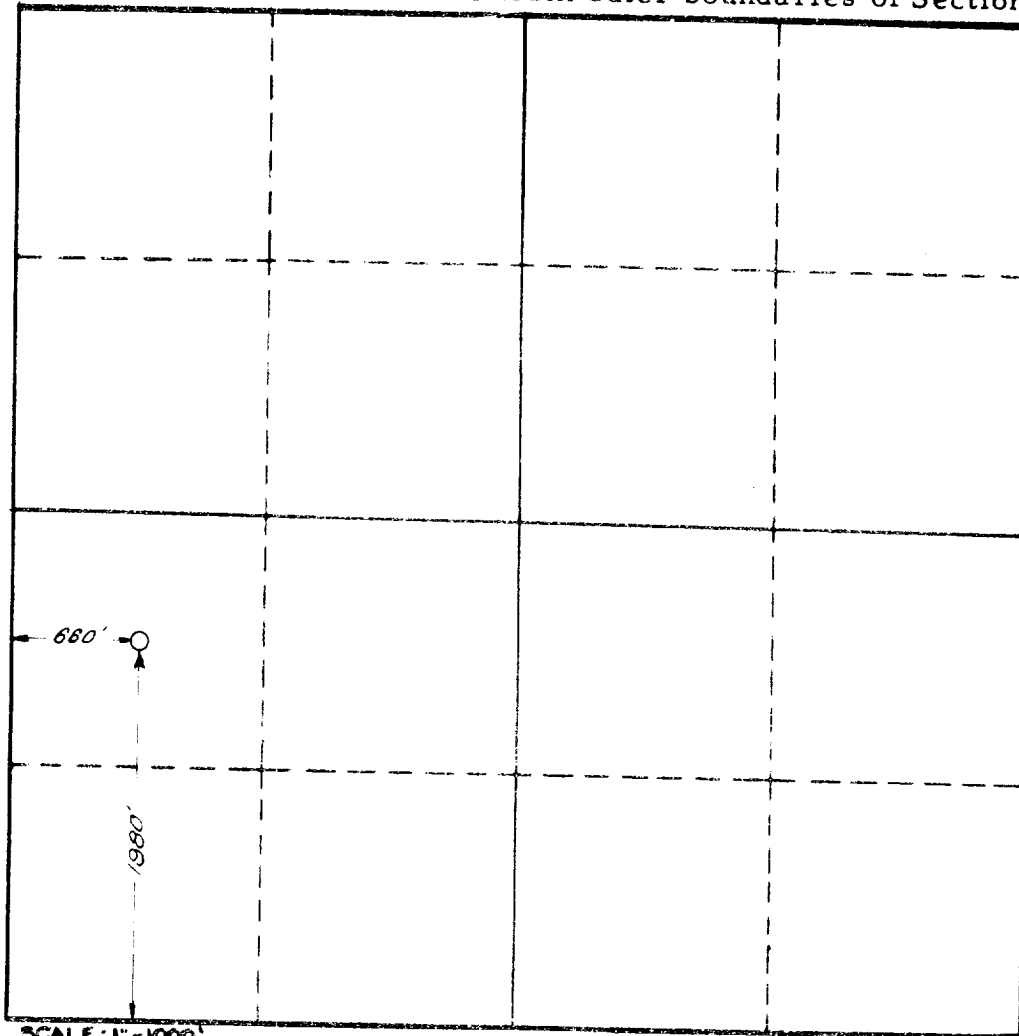

SCALE: 1" = 1000'

1. Is this Well a Dual Comp. ? Yes ☐ No ☐
2. If the answer to Question 1 is yes, are there any other dually completed wells within the dedicated acreage? Yes ☐ No ☐

This is to certify that the above plat was prepared from field notes of actual surveys made by me or under my supervision and that the same are true and correct to the best of my knowledge and belief.

Name _____
Position _____
Representing _____
Address _____

Date Surveyed 12-13-56

John W. West
Registered Professional Engineer and/or
Land Surveyor