

NEW MEXICO  
OIL CONSERVATION COMMISSION

Form C-128

Well Location and/or Gas Proration Plat

Date 1-14-1957

Operator Gulf Oil Corp Lease F. W. Kutter NCT-F

Well No. 1 Section 27 Township 19 South Range 37 East NMPM

Located 1980' Feet From North Line, 1980 Feet From East Line,

Lea County, New Mexico. G. L. Elevation \_\_\_\_\_

Name of Producing Formation \_\_\_\_\_ Pool \_\_\_\_\_ Dedicated Acreage \_\_\_\_\_

(Note: All distances must be from outer boundaries of Section)

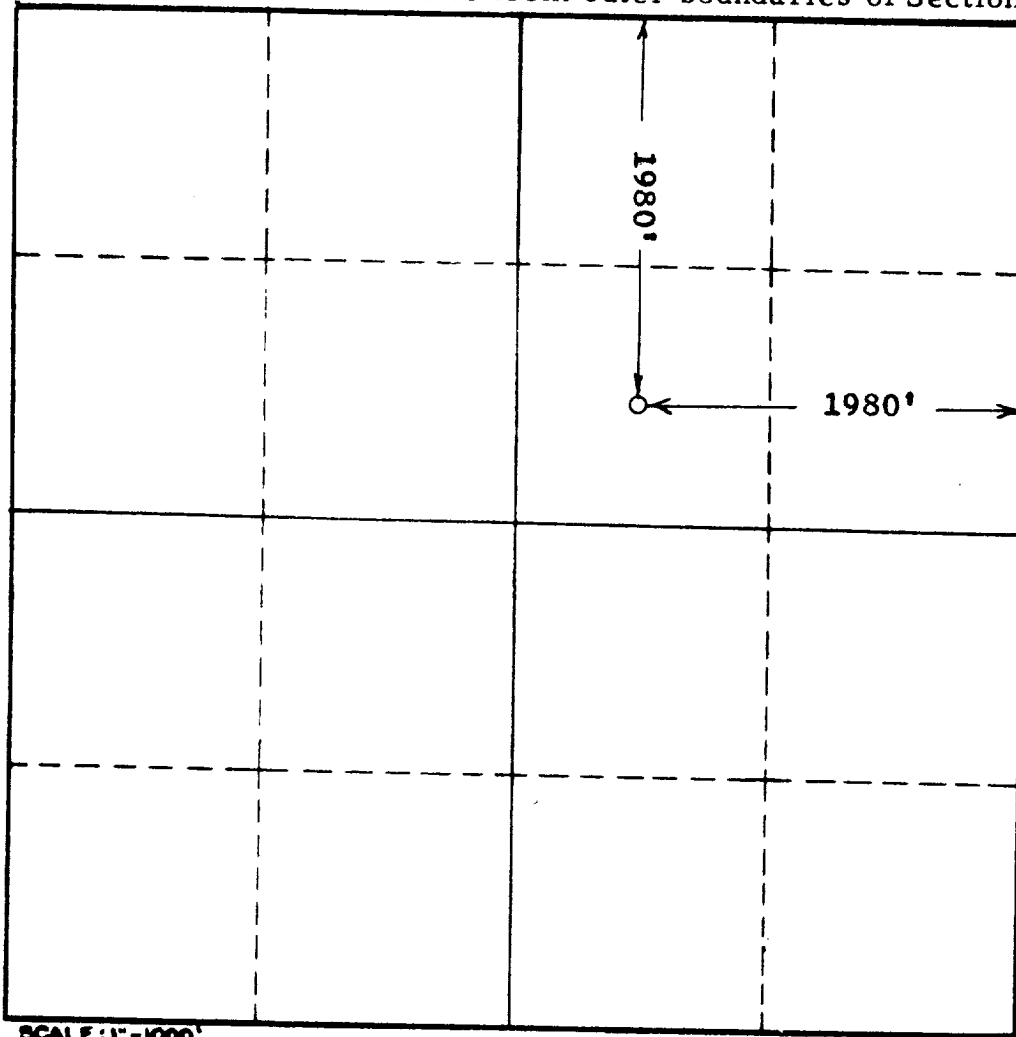

NOTE

This section of form is to be used for gas wells only.



SCALE: 1" = 1000'

1. Is this Well a Dual Comp. ? Yes  No
2. If the answer to Question 1 is yes, are there any other dually completed wells within the dedicated acreage ? Yes  No

Name \_\_\_\_\_  
 Position \_\_\_\_\_  
 Representing \_\_\_\_\_  
 Address \_\_\_\_\_

This is to certify that the above plat was prepared from field notes of actual surveys made by me or under my supervision and that the same are true and correct to the best of my knowledge and belief.

Date Surveyed 1-14-1957

John W. West  
Registered Professional Engineer and/or  
Land Surveyor