

INSTRUCTIONS

1. Is this gas well a dual completion? ~~Yes~~ _____ No **X** .

2. If the answer to Question 1 is Yes, are there any other dually completed wells within the dedicated acreage? Yes _____ No _____

A separate plat must be filed for each gas well, outlining the area dedicated to such well and showing the location of all other wells (oil and gas) within the outlined area.

Mail in duplicate to the district office for the district in which the well is located.

DUPLICATE

NEW MEXICO
OIL CONSERVATION COMMISSION

Gas Well Plat

Date February 1, 1954

Sinclair Oil & Gas Co. Joseph A. Phillips "A" 6
Operator Lease Well No.

Name of Producing Formation Queen Pool Eumont

No. Acres Dedicated to the Well 160

SECTION 31 TOWNSHIP 19-South RANGE 37-East

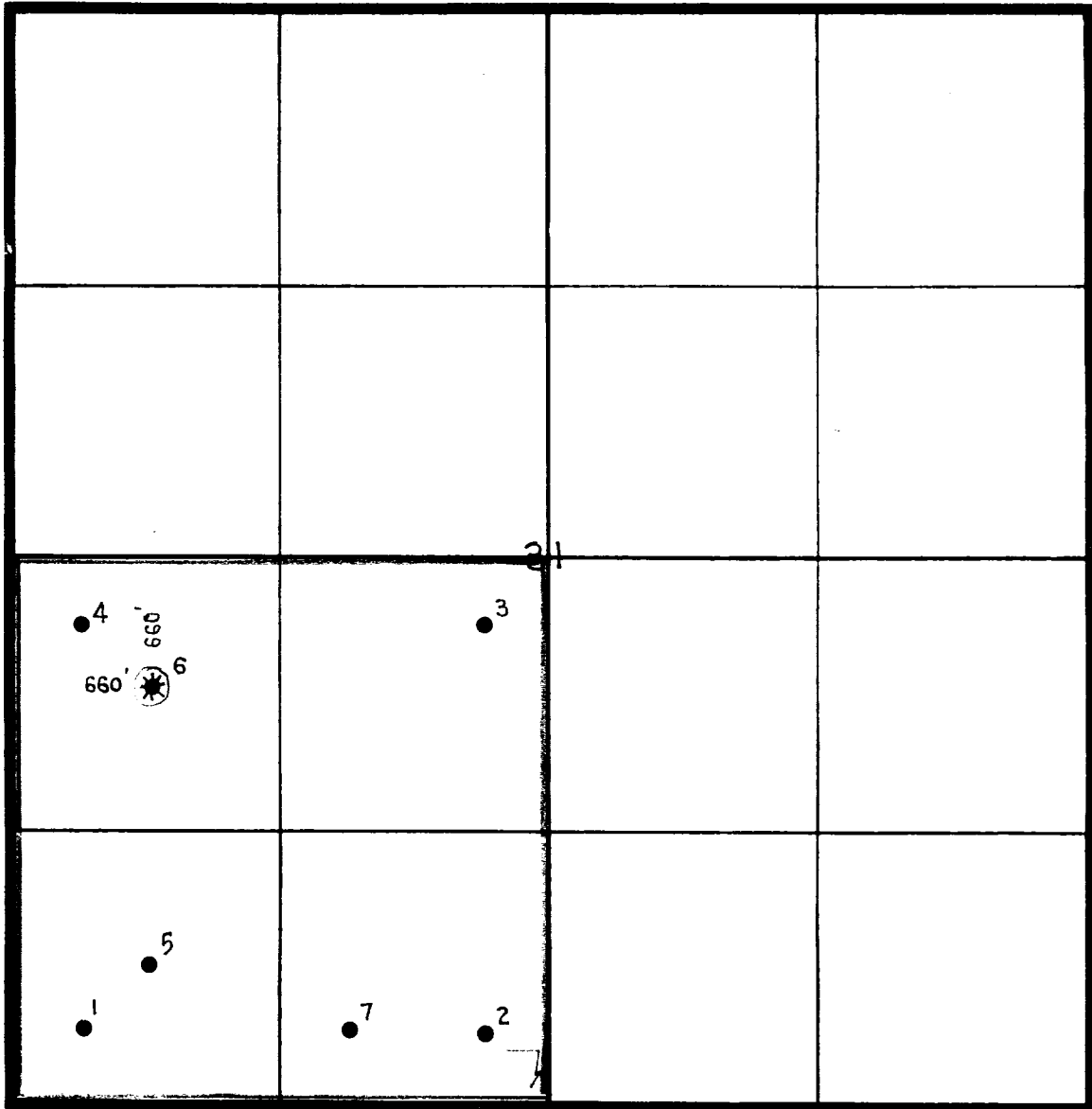

I hereby certify that the information given above is true and complete to the best of my knowledge.

Name C. Williams
Position Administrative Assistant
Representing Sinclair Oil & Gas Co.
Address P.O. Box 521 - Tulsa, Oklahoma

(over)



STATE OF NEW MEXICO
ENERGY, MINERALS AND NATURAL RESOURCES DEPARTMENT
OIL CONSERVATION DIVISION



BRUCE KING
GOVERNOR

ANITA LOCKWOOD
CABINET SECRETARY

December 4, 1992

POST OFFICE BOX 2088
STATE LAND OFFICE BUILDING
SANTA FE, NEW MEXICO 87504
(505) 827-5800

ARCO Oil and Gas Company
P.O. Box 1610
Midland, TX 79702

Attention: Kevin D. Renfro

Administrative Order SD-92-7

Dear Mr. Renfro:

Per your application dated October 2, 1992, you are hereby authorized to simultaneously dedicate Eumont Gas Pool production to the existing non-standard 160-acre gas spacing and proration unit comprising the SW/4 of Section 31, Township 19 South, Range 37 East, NMPM, Lea County, New Mexico from the existing J. R. Phillips A Well No. 6 located at a standard location 1980 feet from the South line and 660 feet from the West line (Unit L) of said Section 31 with the J. R. Phillips A Well No. 9 to be recompleted from the Monument McKee Pool and located at a standard location 800 feet from the South line and 660 feet from the West line (Unit M) of said Section 31.

Further, you are permitted to produce the allowable assigned said 160-acre unit from both wells in any proportion.

Sincerely,

William J. LeMay
Director

WJL/MES/amg

cc: Oil Conservation Division - Hobbs

New Mexico Oil Conservation Division
C-102 Instructions

IF THIS IS AN AMENDED REPORT, CHECK THE BOX LABELED "AMENDED REPORT" AT THE TOP OF THIS DOCUMENT.

Surveyors shall use the latest United States government survey or dependent resurvey. Well locations will be in reference to the New Mexico Principal Meridian. If the land is not surveyed contact the appropriate OCD district office. Independent subdivision surveys will not be acceptable.

1. The OCD assigned API number for this well
2. The pool code for this (proposed) completion
3. The pool name for this (proposed) completion
4. The property code for this (proposed) completion
5. The property name (well name) for this (proposed) completion
6. The well number for this (proposed) completion
7. The operator's OGRID number
8. The operator's name
9. The ground level elevation of this well
10. The surveyed surface location of this well measured from the section lines NOTE: If the United States government survey designates a Lot Number for this location use that number in the "UL or lot no." box. Otherwise use the OCD unit letter.
11. Proposed bottom hole location. If this is a horizontal hole indicate the location of the end of the hole.
12. The calculated acreage dedicated to this completion to the nearest hundredth of an acre
13. Put a Y if more than one completion will be sharing this same acreage or N if this is the only completion on this acreage
14. If more than one lease of different ownership has been dedicated to the well show the consolidation code from the following table:
C Communitization
U Unitization
F Forced pooling
O Other
P Consolidation pending

16. This grid represents a standard section. You may superimpose a non-standard section over this grid. Outline the dedicated acreage and the separate leases within that dedicated acreage. Show the well surface location and bottom hole location, if it is directionally drilled, with the dimensions from the section lines in the cardinal directions. (Note: A legal location is determined from the perpendicular distance to the edge of the tract.) If this is a high angle or horizontal hole show that portion of the well bore that is open within this pool.

Show all lots, lot numbers, and their respective acreage.

If more than one lease has been dedicated to this completion, outline each one and identify the ownership as to both working interest and royalty.

17. The signature, printed name, and title of the person authorized to make this report, and the date this document was signed.
18. The registered surveyors certification. This section does not have to be completed if this form has been previously accepted by the OCD and is being filed for a change of pool or dedicated acreage.

NO ALLOWABLE WILL BE ASSIGNED TO THIS COMPLETION UNTIL ALL INTERESTS HAVE BEEN CONSOLIDATED OR A NON-STANDARD UNIT HAS BEEN APPROVED BY THE DIVISION!

15. Write in the OCD order(s) approving a non-standard location, non-standard spacing, or directional or horizontal drilling

REC'D
OCD DISTRICT OFFICE

District I
 PO Box 1908, Hobbs, NM 88241-1908
 District II
 PO Drawer DD, Artesia, NM 88211-0719
 District III
 1008 Rio Brazos Rd., Aztec, NM 87410
 District IV
 PO Box 2088, Santa Fe, NM 87504-2088

State of New Mexico
 Energy, Minerals & Natural Resources Department

OIL CONSERVATION DIVISION
 PO Box 2088
 Santa Fe, NM 87504-2088

Form 6
 Revised February 10,
 Instructions on
 Submit to Appropriate District Office
 State Lease - 4 Cop
 Fee Lease - 3 Cop

AMENDED REPORT

WELL LOCATION AND ACREAGE DEDICATION PLAT

API Number 30-025-05778		Pool Code 76480	Pool Name Eumont Yates SRQ Gas
Property Code 001512	Property Name J.R. Phillips A		Well Number 6
OGRID No. 000990	Operator Name ARCO Oil and Gas Company		Elevation 3578'

10 Surface Location

UL or lot no.	Section	Township	Range	Lot Ida	Feet from the	North/South line	Feet from the	East/West line	County
L	31	19S	37E		1980	S	660	W	Lea

11 Bottom Hole Location If Different From Surface

UL or lot no.	Section	Township	Range	Lot Ida	Feet from the	North/South line	Feet from the	East/West line	County

12 Ductile	1 Acres	13 Joint or Infill	14 Consolidation Code	15 Order No.

NO ALLOWABLE WILL BE ASSIGNED TO THIS COMPLETION UNTIL ALL INTERESTS HAVE BEEN CONSOLIDATED OR A NON-STANDARD UNIT HAS BEEN APPROVED BY THE DIVISION

16	Section 31, T19S, R37E	17 OPERATOR CERTIFICATION I hereby certify that the information contained herein is true and complete to the best of my knowledge and belief <i>Kellie D. Murrish</i> Signature Kellie D. Murrish Printed Name Records Clerk II Title 05/10/94 Date
		18 SURVEYOR CERTIFICATION I hereby certify that the well location shown on this plat was plotted from field notes of actual surveys made by me or under my supervision, and that the same is true and correct to the best of my belief. Date of Survey Signature and Seal of Professional Surveyer: Certificate Number

660' *6
1980'

Submit to Appropriate
District Office
State Lease - 4 copies
Fee Lease - 3 copies

State of New Mexico
Energy, Minerals and Natural Resources Department

Form C-102
Revised 1-1-89

OIL CONSERVATION DIVISION
P.O. Box 2088
Santa Fe, New Mexico 87504-2088

DISTRICT I
P.O. Box 1980, Hobbs, NM 88240

DISTRICT II
P.O. Drawer DD, Artesia, NM 88210

DISTRICT III
1000 Rio Brazos Rd., Aztec, NM 87410

WELL LOCATION AND ACREAGE DEDICATION PLAT
All Distances must be from the outer boundaries of the section

Operator ARCO OIL AND GAS COMPANY			Lease J. R. PHILLIPS "A"		Well No. 6
Unit Lease L	Section 31	Township T-19-S	Range R-37-E	County LEA COUNTY	
Actual Footage Location of Well: 1980 feet from the SOUTH line and 660 feet from the WEST line					
Ground level Elev. 3578	Producing Formation EUMONT		Pool EUMONT GAS		Dedicated Acreage: 160 Acres

- Outline the acreage dedicated to the subject well by colored pencil or hatchure marks on the plat below.
- If more than one lease is dedicated to the well, outline each and identify the ownership thereof (both as to working interest and royalty).
- If more than one lease of different ownership is dedicated to the well, have the interest of all owners been consolidated by communitization, unitization, force-pooling, etc?
 Yes No If answer is "yes" type of consolidation _____
 If answer is "no" list the owners and tract descriptions which have actually been consolidated. (Use reverse side of this form if necessary).
 No allowable will be assigned to the well until all interests have been consolidated (by communitization, unitization, forced-pooling, or otherwise) or until a see-standard test, eliminating such interest, has been approved by the Division.

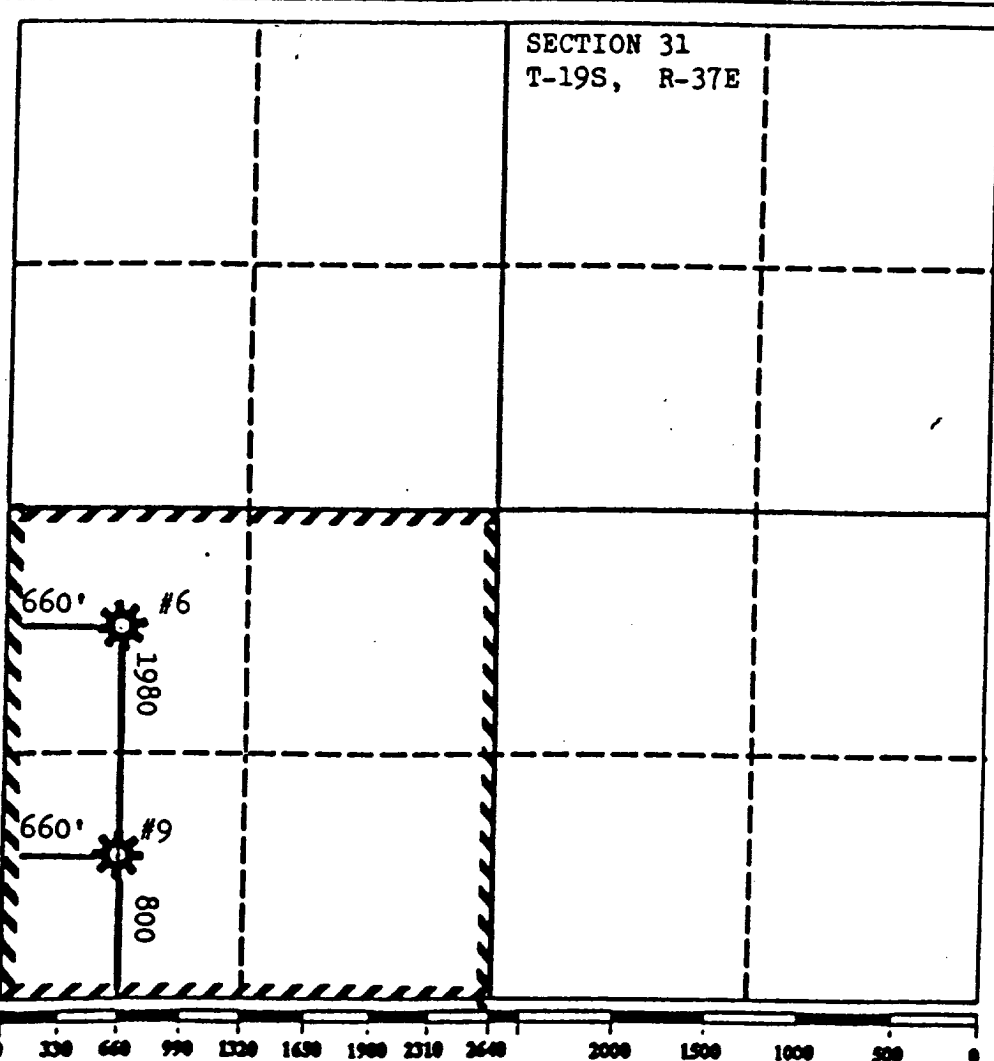

OPERATOR CERTIFICATION
I hereby certify that the information contained herein is true and complete to the best of my knowledge and belief.
Signature: *Evelyn E. Gilson*
EVELYN E. GILSON
Printed Name
ENGINEERING TECHNICIAN
Position
ARCO OIL AND GAS COMPANY
Company
SEPTEMBER 24, 1992
Date

SURVEYOR CERTIFICATION
I hereby certify that the well location shown on this plat was plotted from field notes of actual surveys made by me or under my supervision, and that the same is true and correct to the best of my knowledge and belief.
Date Surveyed: _____
Signature & Seal of Professional Surveyor: _____
Certificate No. _____