

NEW MEXICO
OIL CONSERVATION COMMISSION

Form C-128

Well Location and/or Gas Production Plat

Date 12-5-56

Operator Tidewater Oil Co.

Lease State AL

DEED 7 AL 10-05

Well No. 1 Section 35 Township 19 South Range 37 East NMPM

Located 330 Feet From North Line, 990 Feet From West Line,

Lea County, New Mexico. G. L. Elevation _____

Name of Producing Formation Queen Pool Eumont Dedicated Acreage 40 Ac.

(Note: All Distances must be from outer boundaries of Section)

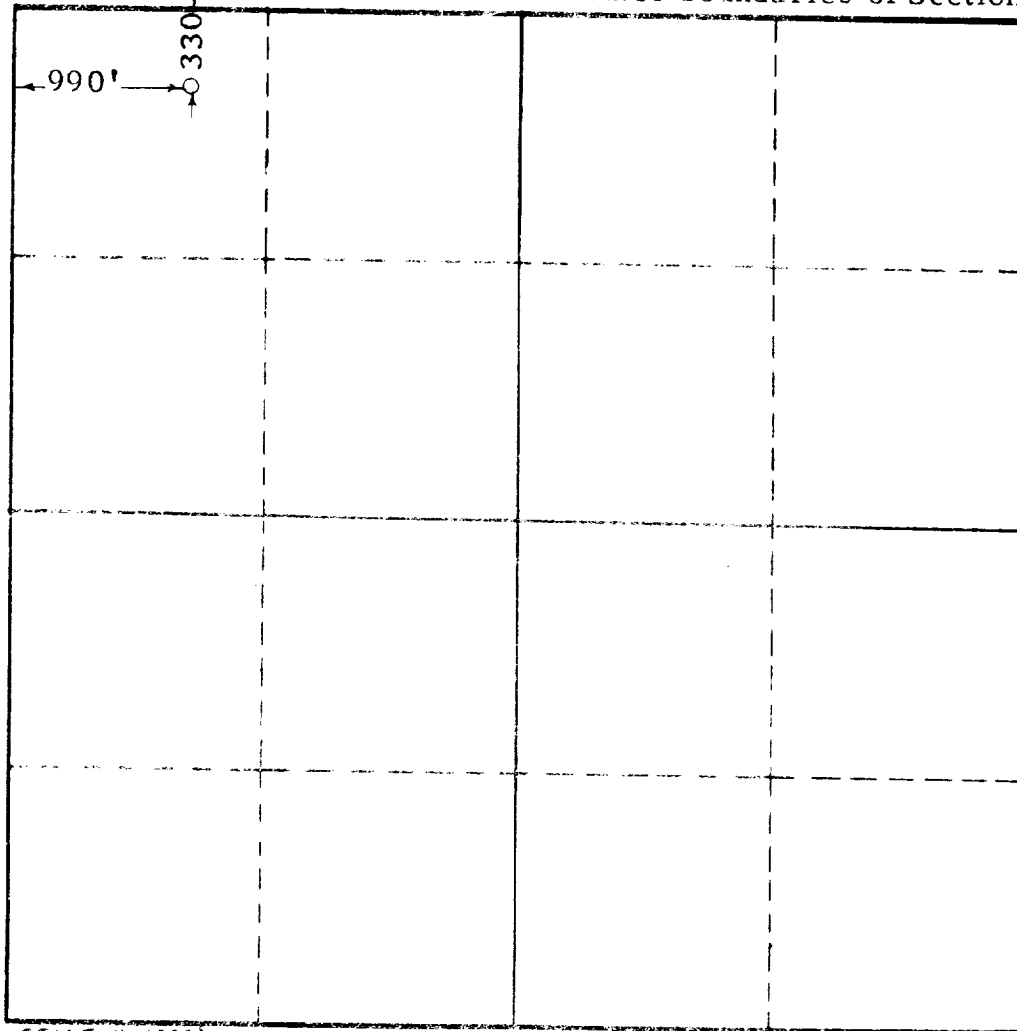

SCALE: 1" = 1000'

1. Is this Well a Dual Comp.? Yes No

2. If the answer to Question 1 is yes, are there any other dually completed wells within the dedicated acreage? Yes No

This is to certify that the above plat was prepared from field notes of actual surveys made by me or under my supervision and that the same are true and correct to the best of my knowledge and belief.

Name _____
Position _____
Representing _____
Address _____

Date Surveyed 12-5-56

John W West
Registered Professional Engineer and/or
Land Surveyor