

District I
1625 N. French Dr., Hobbs, NM 88240
District II
1301 W. Grand Avenue, Artesia, NM 88210
District III
1000 Rio Brazos Road, Aztec, NM 87410
District IV
1220 S. St. Francis Dr., Santa Fe, NM 87505

State of New Mexico
Energy Minerals and Natural Resources

Oil Conservation Division
1220 South St. Francis Dr.
Santa Fe, NM 87505

Form C-101
Revised March 17, 1999

Submit to appropriate District Office
State Lease - 6 Copies
Fee Lease - 5 Copies

☐ AMENDED REPORT

APPLICATION FOR PERMIT TO DRILL, RE-ENTER, DEEPEN, PLUGBACK, OR ADD A ZONE

| | | |
|--|--|---|
| ¹ Operator Name and Address Matador Operating Company 8340 Meadow Road #150 Dallas, TX 75231 | | ² OGRID Number 14245 |
| | | ³ API Number 30-025-35958 |
| ³ Property Code 25471 | ⁵ Property Name Laughlin | ⁶ Well No. 9 |

⁷ Surface Location

| UL or lot no. | Section | Township | Range | Lot Idn | Feet from the | North/South line | Feet from the | East/West line | County |
|---------------|---------|----------|-------|---------|---------------|------------------|---------------|----------------|--------|
| I | 4 | 20S | 37E | | 1650 | South | 330 | East | Lea |

⁸ Proposed Bottom Hole Location If Different From Surface

| UL or lot no. | Section | Township | Range | Lot Idn | Feet from the | North/South line | Feet from the | East/West line | County |
|--|---------|----------|-------|---------|-------------------------------|------------------|---------------|----------------|--------|
| | | | | | | | | | |
| ⁹ Proposed Pool 1 Monument; Tubb | | | | | ¹⁰ Proposed Pool 2 | | | | |

| | | | | |
|-----------------------------------|---------------------------------------|--------------------------------------|---------------------------------------|---|
| ¹¹ Work Type Code N | ¹² Well Type Code O | ¹³ Cable/Rotary Rotary | ¹⁴ Lease Type Code P | ¹⁵ Ground Level Elevation 3552' |
| ¹⁶ Multiple No | ¹⁷ Proposed Depth 6800' | ¹⁸ Formation Tubb | ¹⁹ Contractor Patterson | ²⁰ Spud Date 7/25/02 |

²¹ Proposed Casing and Cement Program

| Hole Size | Casing Size | Casing weight/foot | Setting Depth | Sacks of Cement | Estimated TOC |
|-----------|-------------|--------------------|---------------|-----------------|---------------|
| 12-1/4" | 8-5/8" | 24# | 1350' | 500 | Surface |
| 7-7/8" | 4-1/2" | 11.6# | 6800' | 750 | 2000' |
| | | | | | |
| | | | | | |
| | | | | | |

²² Describe the proposed program. If this application is to DEEPEN or PLUG BACK, give the data on the present productive zone and proposed new productive zone.
Describe the blowout prevention program, if any. Use additional sheets if necessary.

Drill 12-1/4" hole to top of Anhydrite @ 1350'. Run and cement to surface 8-5/8" casing. Nipple up 11" 3M BOP assembly and test to 3000 psi. Drill 7-7/8" hole to 6800'. Evaluate to run production casing.

Permit Expires 1 Year From Approval
Date Unless Drilling Underway

*Note: Second well in unit

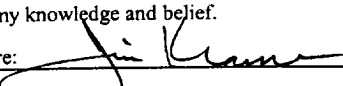
| | | |
|--|--|---|
| ²³ I hereby certify that the information given above is true and complete to the best of my knowledge and belief. Signature:  Printed name: Jim Kramer Title: Sr. Drilling Engineer Date: 7/18/02 Phone: 214 987-7128 | | OIL CONSERVATION DIVISION Approved by: ORIGINAL SIGNED BY Title: PAUL F. KAUTZ PETROLEUM ENGINEER Approval Date: JUL 23 2002 Expiration Date: Conditions of Approval: Attached <input type="checkbox"/> |
|--|--|---|

35
C
A

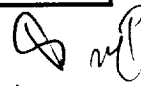

DISTRICT I
P. O. Box 1980
Hobbs, NM 88241-1980

State of New Mexico
Energy, Minerals, and Natural Resources Department

Form C-102
Revised 02-10-94
Instructions on back

DISTRICT II
P. O. Drawer DD
Artesia, NM 88211-0719

OIL CONSERVATION DIVISION

P. O. Box 2088
Santa Fe, New Mexico 87504-2088

Submit to the Appropriate
District Office
State Lease - 4 copies
Fee Lease - 3 copies

☐ AMENDED REPORT

DISTRICT III
1000 Rio Brazos Rd.
Aztec, NM 87410

DISTRICT IV
P. O. Box 2088
Santa Fe, NM 87507-2088

WELL LOCATION AND ACREAGE DEDICATION PLAT

| | | | | | |
|-------------------------------------|--|--|--|-------------------------------|----------------------|
| 1 API Number 30-025-35958 | | 2 Pool Code 47090 | | 3 Pool Name Monument; Tubb | |
| 4 Property Code 25471 | | 5 Property Name LAUGHLIN | | | 6 Well Number 9 |
| 7 GRID No. 14245 | | 8 Operator Name MATADOR OPERATING COMPANY | | | 9 Elevation 3552' |

10 SURFACE LOCATION

| | | | | | | | | | |
|--------------------|--------------|----------------------|----------------------------|---------|------------------------|---------------------------|-----------------------|------------------------|---------------|
| UL or lot no. I | Section 4 | Township 20 SOUTH | Range 37 EAST, N.M.P.M. | Lot Ida | Feet from the 1650' | North/South line SOUTH | Feet from the 330' | East/West line EAST | County LEA |
|--------------------|--------------|----------------------|----------------------------|---------|------------------------|---------------------------|-----------------------|------------------------|---------------|

11 BOTTOM HOLE LOCATION IF DIFFERENT FROM SURFACE

| | | | | | | | | | |
|---------------|---------|----------|-------|---------|---------------|------------------|---------------|----------------|--------|
| UL or lot no. | Section | Township | Range | Lot Ida | Feet from the | North/South line | Feet from the | East/West line | County |
|---------------|---------|----------|-------|---------|---------------|------------------|---------------|----------------|--------|

| | | | |
|--------------------------|--------------------|-----------------------|--------------|
| 12 Dedicated Acres 80 | 13 Joint or Infill | 14 Consolidation Code | 15 Order No. |
|--------------------------|--------------------|-----------------------|--------------|

NO ALLOWABLE WELL BE ASSIGNED TO THIS COMPLETION UNTIL ALL INTERESTS HAVE BEEN
CONSOLIDATED OR A NON-STANDARD UNIT HAS BEEN APPROVED BY THE DIVISION

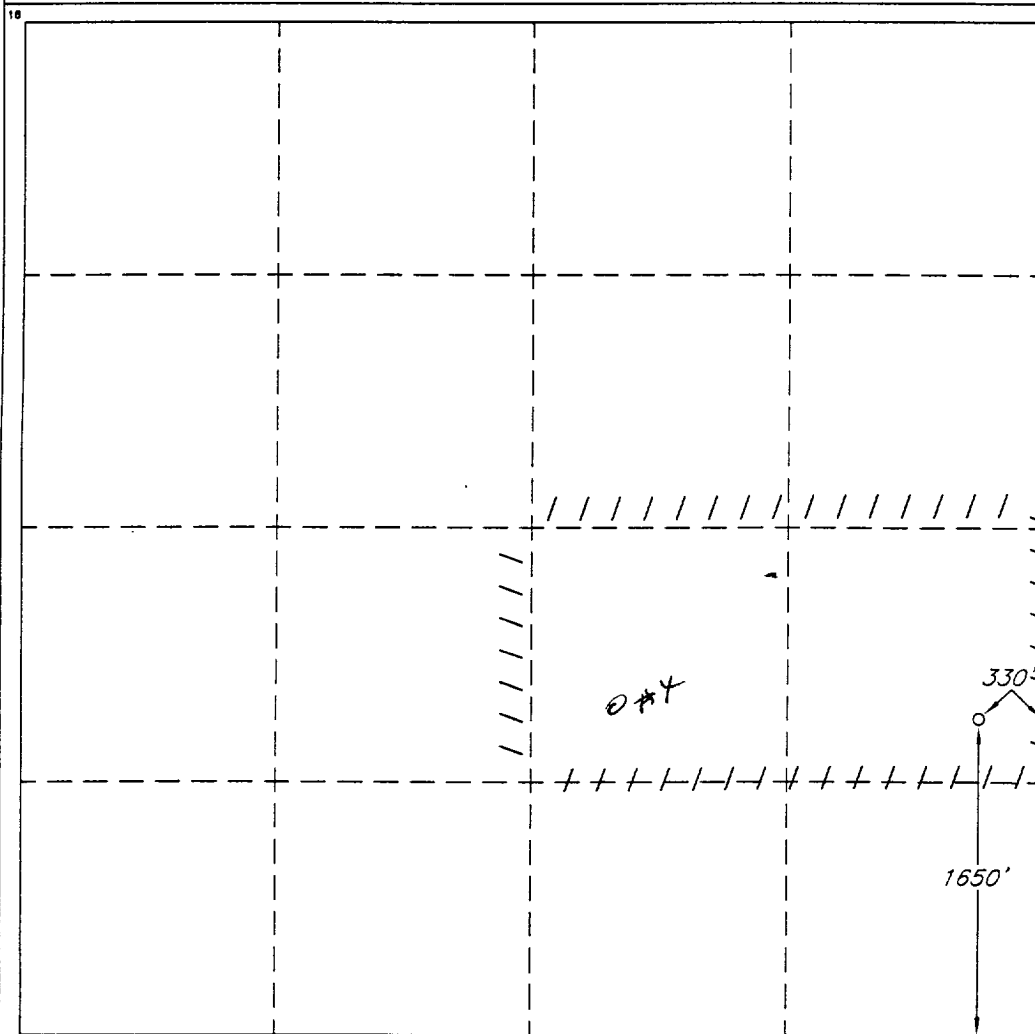

OPERATOR CERTIFICATION

I hereby certify that the information
contained herein is true and complete
to the best of my knowledge and belief.

| |
|--------------------------------|
| Signature <i>Jim Kramer</i> |
| Printed Name Jim Kramer |
| Title Sr. Drilling Engineer |
| Date 7/18/02 |

SURVEYOR CERTIFICATION

I hereby certify that the well
location shown on this plat was
plotted from field notes of actual
surveys made by me or under
my supervision, and that the
same is true and correct to the
best of my belief.

| |
|---|
| Date of Survey MARCH 12, 2002 |
| Signature and Seal of Professional Surveyor <i>Jim Kramer</i> |
| Certificate No. V. L. BEZNER R.P.S. #7920 |
| JOB #80815 / 71 SE / J.C.P. |

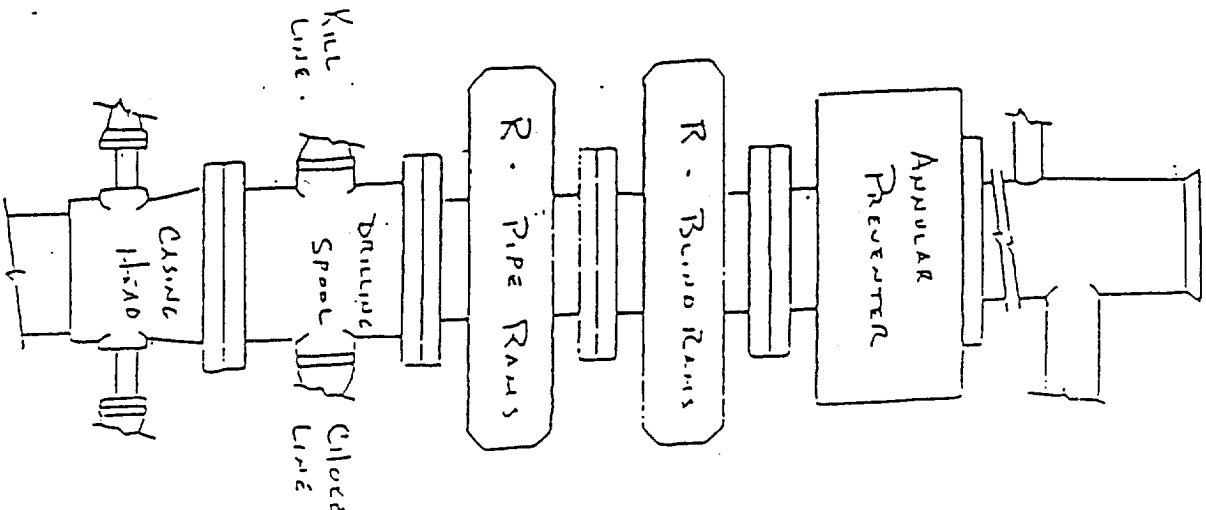

3000 PSI
WORKING PRESSURE

MATADOR OPERATING COMPANY
LAUGHLIN #9
SEC. 4, T20S, R37E
LEA COUNTY, NEW MEXICO

BLOWOUT PREVENTER

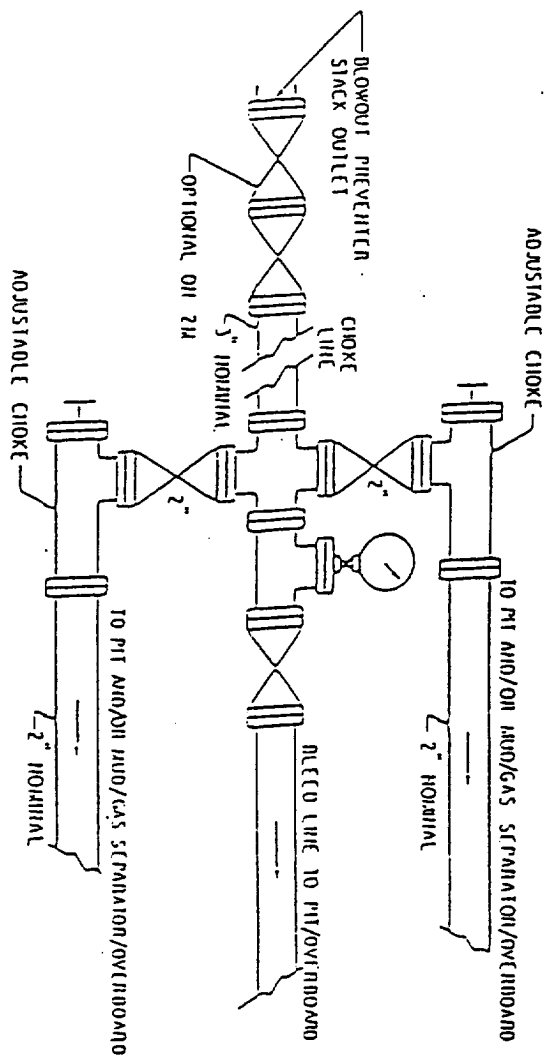

ELF
12/2/62
ABOVE DATE DOES NOT
INDICATE WHEN
CONFIDENTIAL LOGS
WILL BE RELEASED