

DUPLICATE

NOTICE OF INTENTION TO DRILL

Notice must be given to the District Office of the Oil Conservation Commission and approval obtained before drilling or recompletion begins. If changes in the proposed plan are considered advisable, a copy of this notice showing such changes will be returned to the sender. Submit this notice in QUINTUPPLICATE. One copy will be returned following approval. See additional instructions in Rules and Regulations of the Commission. If State Land submit 6 Copies Attach Form C-128 in triplicate to first 3 copies of form C-101

Hobbs, New Mexico
(Place)

3-12-57
(Date)

OIL CONSERVATION COMMISSION
SANTA FE, NEW MEXICO

Gentlemen:

You are hereby notified that it is our intention to commence the Drilling of a well to be known as

Felmont Oil Corp.

(Company or Operator)

Terry

(Lease)

, Well No. 1

, in C

(Unit)

The well is

located 1980 feet from the West line and 660 feet from the

North

line of Section 17, T 19 South, R 38 East, NMPM.

(GIVE LOCATION FROM SECTION LINE)

Pool, County

D	X	B	A
E	F	G	H
L	K	J	I
M	N	O	P

If State Land the Oil and Gas Lease is No.

If patented land the owner is Will Terry

Address Star Route B, Hobbs, New Mexico

We propose to drill well with drilling equipment as follows: Rotary

The status of plugging bond is Current

Drilling Contractor La Mance Drilling Co.

We intend to complete this well in the Grayburg

formation at an approximate depth of 4200 feet.

CASING PROGRAM

We propose to use the following strings of Casing and to cement them as indicated:

Size of Hole	Size of Casing	Weight per Foot	New or Second Hand	Depth	Sacks Cement
12 1/4	9 5/8	36	New	1600	Circulate
8 3/4	7	23	New	4200	500

If changes in the above plans become advisable we will notify you immediately.

ADDITIONAL INFORMATION (If recompletion give full details of proposed plan of work.)

Approved, 19.....
Except as follows:

OIL CONSERVATION COMMISSION

By W. A. Gressett
Oil & Gas Inspector

Sincerely yours,

Felmont Oil Corp.
(Company or Operator)

By

Position Engineer

Send Communications regarding well to

Name Felmont Oil Corp.

Address Box 1855 Midland, Texas

Form C-128

Well Location and/or Gas Proration Plat OFFICE OCC
Date 3-13-57

Well No. 1 Section 17 Township 19 S Range 38 E NMPM

Located 1980 Feet From West Line, 660 Feet From North Line,

Loc	County, New Mexico.	C. I.	Elevation
1	Albuquerque	100	5000
2	Albuquerque	100	5000
3	Albuquerque	100	5000
4	Albuquerque	100	5000
5	Albuquerque	100	5000
6	Albuquerque	100	5000
7	Albuquerque	100	5000
8	Albuquerque	100	5000
9	Albuquerque	100	5000
10	Albuquerque	100	5000
11	Albuquerque	100	5000
12	Albuquerque	100	5000
13	Albuquerque	100	5000
14	Albuquerque	100	5000
15	Albuquerque	100	5000
16	Albuquerque	100	5000
17	Albuquerque	100	5000
18	Albuquerque	100	5000
19	Albuquerque	100	5000
20	Albuquerque	100	5000
21	Albuquerque	100	5000
22	Albuquerque	100	5000
23	Albuquerque	100	5000
24	Albuquerque	100	5000
25	Albuquerque	100	5000
26	Albuquerque	100	5000
27	Albuquerque	100	5000
28	Albuquerque	100	5000
29	Albuquerque	100	5000
30	Albuquerque	100	5000
31	Albuquerque	100	5000
32	Albuquerque	100	5000
33	Albuquerque	100	5000
34	Albuquerque	100	5000
35	Albuquerque	100	5000
36	Albuquerque	100	5000
37	Albuquerque	100	5000
38	Albuquerque	100	5000
39	Albuquerque	100	5000
40	Albuquerque	100	5000
41	Albuquerque	100	5000
42	Albuquerque	100	5000
43	Albuquerque	100	5000
44	Albuquerque	100	5000
45	Albuquerque	100	5000
46	Albuquerque	100	5000
47	Albuquerque	100	5000
48	Albuquerque	100	5000
49	Albuquerque	100	5000
50	Albuquerque	100	5000
51	Albuquerque	100	5000
52	Albuquerque	100	5000
53	Albuquerque	100	5000
54	Albuquerque	100	5000
55	Albuquerque	100	5000
56	Albuquerque	100	5000
57	Albuquerque	100	5000
58	Albuquerque	100	5000
59	Albuquerque	100	5000
60	Albuquerque	100	5000
61	Albuquerque	100	5000
62	Albuquerque	100	5000
63	Albuquerque	100	5000
64	Albuquerque	100	5000
65	Albuquerque	100	5000
66	Albuquerque	100	5000
67	Albuquerque	100	5000
68	Albuquerque	100	5000
69	Albuquerque	100	5000
70	Albuquerque	100	5000
71	Albuquerque	100	5000
72	Albuquerque	100	5000
73	Albuquerque	100	5000
74	Albuquerque	100	5000
75	Albuquerque	100	5000
76	Albuquerque	100	5000
77	Albuquerque	100	5000
78	Albuquerque	100	5000
79	Albuquerque	100	5000
80	Albuquerque	100	5000
81	Albuquerque	100	5000
82	Albuquerque	100	5000
83	Albuquerque	100	5000
84	Albuquerque	100	5000
85	Albuquerque	100	5000
86	Albuquerque	100	5000
87	Albuquerque	100	5000
88	Albuquerque	100	5000
89	Albuquerque	100	5000
90	Albuquerque	100	5000
91	Albuquerque	100	5000
92	Albuquerque	100	5000
93	Albuquerque	100	5000
94	Albuquerque	100	5000
95	Albuquerque	100	5000
96	Albuquerque	100	5000
97	Albuquerque		

Name of Producing Formation	Pool	Dedicated Acreage
-----------------------------	------	-------------------

(Note: All distances must be from outer boundaries of Section)

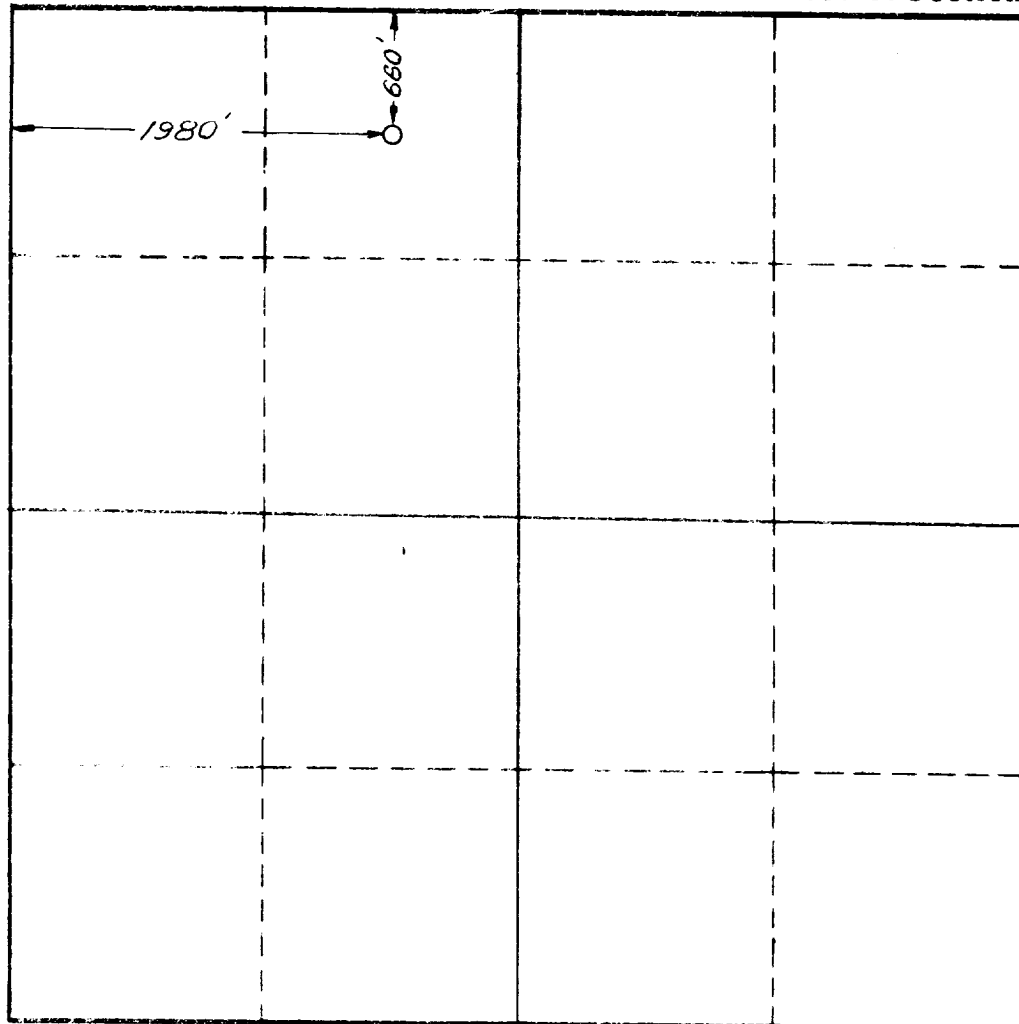

SCALE: 1" = 1000'

1. Is this well a Dual Comp. ? Yes ___ No ___.
2. If the answer to Question 1 is yes, are there any other dually completed wells within the dedicated acreage? Yes ___ No ___.

This is to certify that the above plat was prepared from field notes of actual surveys made by me or under my supervision and that the same are true and correct to the best of my knowledge and belief.

Name _____
Position _____
Representing _____
Address _____

Date Surveyed. 3-12-57

John W. West
Registered Professional Engineer and/or
Land Surveyor