

NEW MEXICO OIL CONSERVATION COMMISSION

FORM C-128
Revised 5/1/57

WELL LOCATION AND ACREAGE DEDICATION PLAT

SEE INSTRUCTIONS FOR COMPLETING THIS FORM ON THE REVERSE SIDE

SECTION A

Operator MORRIS R. ANTWEIL		Lease JULIE ANN		Well No. 1
Unit Letter P	Section 10	Township 19 SOUTH	Range 36 EAST	County LEA
Actual Footage Location of Well: 660 feet from the SOUTH line and 660 feet from the EAST line				
Ground Level Elev. 3740.6	Producing Formation Ubo	Pool Wildcat	Dedicated Acreage: 40 Acres	

1. Is the Operator the only owner in the dedicated acreage outlined on the plat below? YES NO . ("Owner" means the person who has the right to drill into and to produce from any pool and to appropriate the production either for himself or for himself and another. (65-3-29 (e) NMSA 1935 Comp.)
2. If the answer to question one is "no," have the interests of all the owners been consolidated by communitization agreement or otherwise? YES NO . If answer is "yes," Type of Consolidation _____
3. If the answer to question two is "no," list all the owners and their respective interests below:

Owner	Land Description

SECTION B

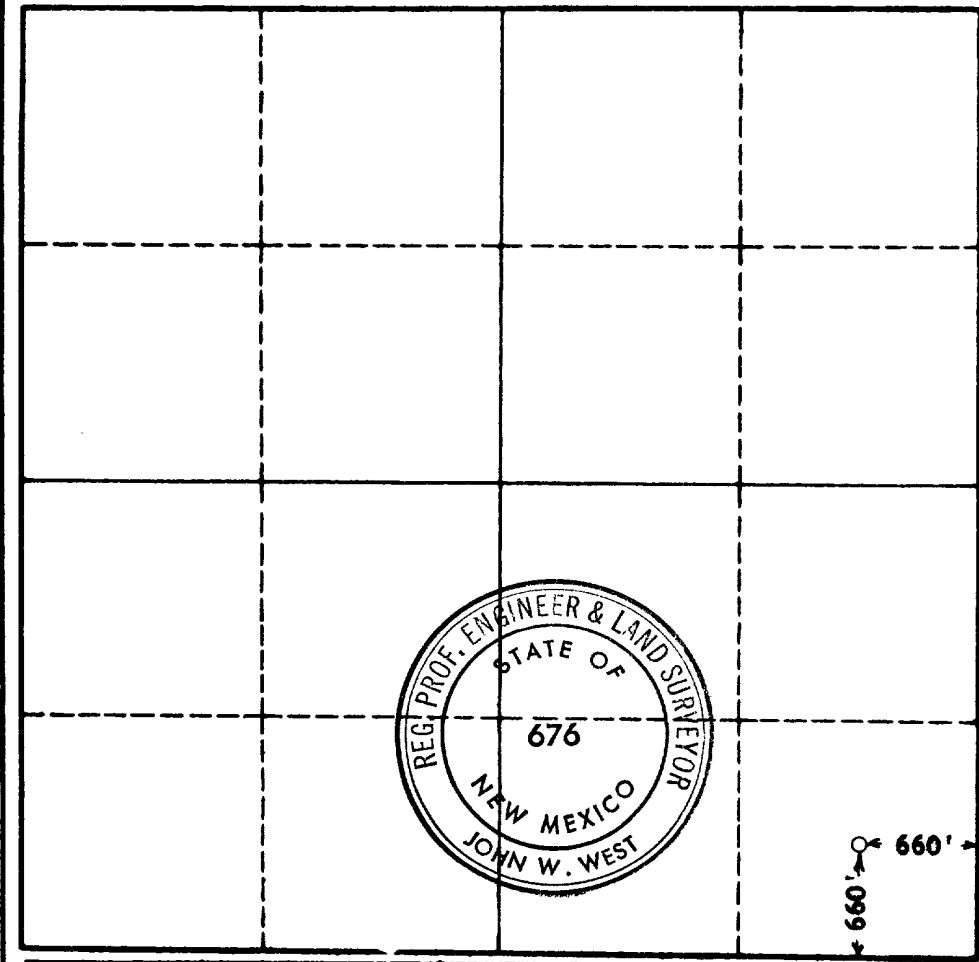

CERTIFICATION

I hereby certify that the information in SECTION A above is true and complete to the best of my knowledge and belief.

Name	<i>Burton Peters</i>
Position	<i>Agent</i>
Company	<i>Morris R. Antweil</i>
Date	<i>6/7/63</i>

I hereby certify that the well location shown on the plat in SECTION B was plotted from field notes of actual surveys made by me or under my supervision, and that the same is true and correct to the best of my knowledge and belief.

Date Surveyed	5-17-1963
Registered Professional Engineer and/or Land Surveyor,	JOHN W. WEST
Certificate No.	<i>John W. West</i>
N. M. - P. E. & L. S. NO. 676	

0 350 660 990 1320 1680 1980 2340 2640 2000 1500 1000 500 0

Antweil, Morris R., #1 Julie Ann - Sec. 10-19S-36E
Wildcat

-cont.-

8-5-63 DST 7745-7835', open 90", GTS 6", rec 658' &
HG&OCM, 752' O&GC Salt Wtr, & 2350' salt wtr,
90" ISIP 3011#, FP 368-1648#, 90" FSIP 2875#.
TD 8010', PB 7741', swbg.
WLT 7714-17', open 1 hr 5 mins, rec .36 CFG +
3800 cc's filtrate water, 25" FSIP 3050#.
WLT 7681-84', open 1 hr, rec .31 CFG + 1200
cc's wtr.
Perf 6/7860-63', 4/7865-67', treated 500 gals
acid, swbd salt wtr, w/3 to 5% oil.
Set BP @ 7770'. Perf 22/7627-38', 8/7680-84',
20/7709-19', 14/7722-29', treated 1500 gals acid,
swbd 35 BF (16 BO), no time.
Re-set BP @ 7741' with packer @ 7609'.

8-12-63 TD 8010', PB 7741', prep to P&A.
Swbd 19 BO + 42 BW/no time.
8-19-63 TD 8010', PB 7741', prep to P&A.
8-26-63 TD 8010', PB 7741', prep to P&A.
9-3-63 TD 8010', PB 7741', PLUGGED & ABANDONED.