

STATE LEASE NO.

Well Location and Acreage Dedication Plat

Revised 5/1/57

FEDERAL LEASE NO.

Section A.

Date Sept. 20, 1963

Operator Humble Oil & Ref. Co. Lease New Mexico State "A.O." 5'  
 Well No. 2 Unit Letter N Section 11 Township 19 South Range 36 East NMPM  
 Located 600 Feet From South Line, 1920 Feet From West Line  
 County Lea G. L. Elevation Later Dedicated Acreage 40 Acres  
 Name of Producing Formation Yeso Pool Abo

1. Is the Operator the only owner\* in the dedicated acreage outlined on the plat below?  
 Yes ☒ No ☐
2. If the answer to question one is "no", have the interests of all the owners been consolidated by communitization agreement or otherwise? Yes ☐ No ☐ If answer is "yes," Type of Consolidation \_\_\_\_\_
3. If the answer to question two is "no," list all the owners and thier respective interests below:

OwnerLand Description

Section B

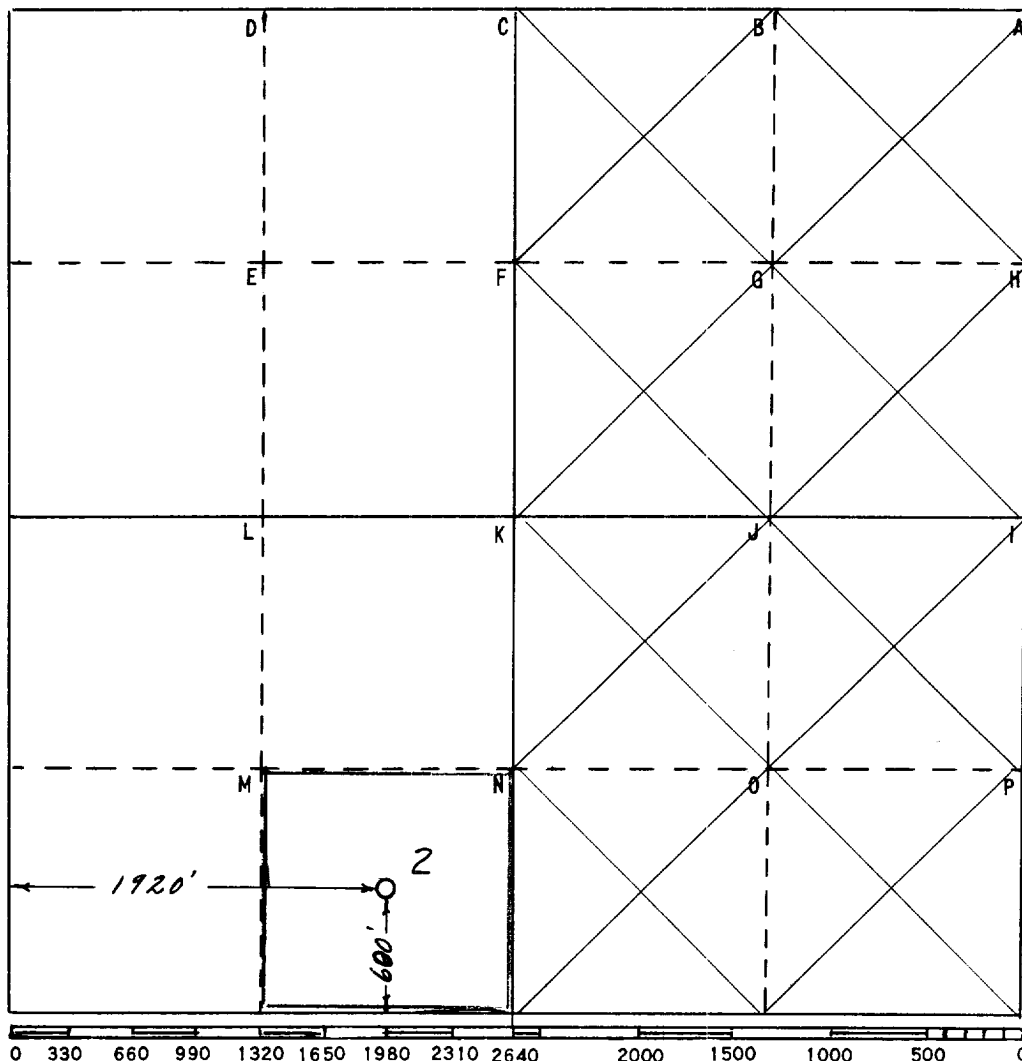

This is to certify that the information in Section A above is true and complete to the best of my knowledge and belief

HUMBLE OIL & REFG. CO.

(Operator)

H. P. Hensley  
 (Representative)

Box 1600 Midland, Texas  
 Address

This is to certify that the well location shown on the plat in Section B was plotted from field notes of actual surveys made by me or under my supervision and that the same is true and correct to the best of my knowledge and belief.

Date Surveyed 9/20/63

H. S. Westersfield  
 Registered Professional  
 Engineer and/or Land Surveyor

Certificate No. 1382

FILE NO. W-A-2078