

UNITED STATES
DEPARTMENT OF THE INTERIOR
GEOLOGICAL SURVEY

APPLICATION FOR PERMIT TO DRILL, DEEPEN, OR PLUG BACK

1a. TYPE OF WORK
 DRILL DEEPEN PLUG BACK

b. TYPE OF WELL
 OIL WELL GAS WELL OTHER SINGLE ZONE MULTIPLE ZONE

2. NAME OF OPERATOR
CARL EDGEMALL

3. ADDRESS OF OPERATOR
P. O. Box 1708, Roswell, New Mexico

4. LOCATION OF WELL (Report location clearly and in accordance with any State requirements.)*
 At surface
**2310' from the SOUTH and 900' from the WEST lines
 At proposed prod. zone
 SAME**

14. DISTANCE IN MILES AND DIRECTION FROM NEAREST TOWN OR POST OFFICE*
18 miles southeast of Maljamar, New Mexico

15. DISTANCE FROM PROPOSED* LOCATION TO NEAREST PROPERTY OR LEASE LINE, FT. (Also to nearest drlg. unit line, if any) 230'
 16. NO. OF ACRES IN LEASE 80
 17. NO. OF ACRES ASSIGNED TO THIS WELL 80

18. DISTANCE FROM PROPOSED LOCATION* TO NEAREST WELL, DRILLING, COMPLETED, OR APPLIED FOR, ON THIS LEASE, FT. 900'
 19. PROPOSED DEPTH 3600'
 20. ROTARY OR CABLE TOOLS ROTARY

21. ELEVATIONS (Show whether DF, RT, GR, etc.)
Not available at present

22. APPROX. DATE WORK WILL START*
1 August 1968

5. LEASE DESIGNATION AND SERIAL NO.
LC-04788-A

6. IF INDIAN, ALLOTTEE OR TRIBE NAME

7. UNIT AGREEMENT NAME

8. FARM OR LEASE NAME
SINCLAIR-FEDERAL

9. WELL NO.
1

10. FIELD AND POOL, OR WILDCAT
WEAS

11. SEC., T., R., M., OR BLK. AND SURVEY OR AREA
Sec. 14, T-20-S, R-22-S

12. COUNTY OR PARISH STATE
LEA NEW MEXICO

PROPOSED CASING AND CEMENTING PROGRAM

| SIZE OF HOLE | SIZE OF CASING | WEIGHT PER FOOT | SETTING DEPTH | QUANTITY OF CEMENT |
|--------------|----------------|-----------------|---------------|--------------------|
| 1 1/2" | 9 5/8" | 307 | 900' | 400 sacks |
| 7 7/8" | 5 1/8" | 237 | 3600' | 600 sacks |

This casing and cementing program has been proposed and will be used in accordance with MMSCE Order # R-111-A as amended by Order # H-2028.

-all

IN ABOVE SPACE DESCRIBE PROPOSED PROGRAM: If proposal is to deepen or plug back, give data on present productive zone and proposed new productive zone. If proposal is to drill or deepen directionally, give pertinent data on subsurface locations and measured and true vertical depths. Give blowout preventer program, if any.

24. SIGNED Carl Edgemall TITLE Operator DATE 28 July 1968

(This space for Federal or State office use)

PERMIT NO. _____ APPROVAL DATE _____

APPROVED BY _____ TITLE _____ DATE _____

CONDITIONS OF APPROVAL, IF ANY:

[Signature]

Instructions

General: This form is designed for submitting proposals to perform certain well operations, as indicated, on all types of lands and leases for appropriate action by either a Federal or a State agency, or both, pursuant to applicable Federal and/or State laws and regulations. Any necessary special instructions concerning the use of this form and the number of copies to be submitted, particularly with regard to local, area, or regional procedures and practices, either are shown below or will be issued by, or may be obtained from, the local Federal and/or State office.

Item 1: If the proposal is to redrill to the same reservoir at a different subsurface location or to a new reservoir, use this form with appropriate notations. Consult applicable State or Federal regulations concerning subsequent work proposals or reports on the well.

Item 4: If there are no applicable State requirements, locations on Federal or Indian land should be described in accordance with Federal requirements. Consult local State or Federal office for specific instructions.

Item 14: Needed only when location of well cannot readily be found by road from the land or lease description. A plat, or plats, separate or on this reverse side, showing the roads to, and the surveyed location of, the well, and any other required information, should be furnished when required by Federal or State agency offices.

Items 15 and 18: If well is to be, or has been directionally drilled, give distances for subsurface location of hole in any present or objective production zone.

Item 22: Consult applicable Federal or State regulations, or appropriate officials, concerning approval of the proposal before operations are started.

NEW MEXICO OIL CONSERVATION COMMISSION
WELL LOCATION AND ACREAGE DEDICATION PLAT

Form C-102
Supersedes C-128
Effective 1-1-65

All distances must be from the outer boundaries of the Section.

| | | | | |
|---|---|----------------------------------|---|----------------------|
| Operator CARL ENGWALL | | Lease SINCLAIR FEDERAL | | Well No. 1 |
| Unit Letter L | Section 14 | Township 20 SOUTH | Range 33 EAST | County LEA |
| Actual Footage Location of Well: 2310 feet from the SOUTH line and 990 feet from the WEST line | | | | |
| Ground Level Elev. 3579.1 | Producing Formation WASH. SANDS | Pool WAS | Dedicated Acreage: 0.00 Acres | |

JUL 27 11 25 AM '65

1. Outline the acreage dedicated to the subject well by colored pencil or hachure marks on the plat below.
2. If more than one lease is dedicated to the well, outline each and identify the ownership thereof (both as to working interest and royalty).
3. If more than one lease of different ownership is dedicated to the well, have the interests of all owners been consolidated by communitization, unitization, force-pooling, etc?

Yes No If answer is "yes," type of consolidation _____

If answer is "no," list the owners and tract descriptions which have actually been consolidated. (Use reverse side of this form if necessary.) _____

No allowable will be assigned to the well until all interests have been consolidated (by communitization, unitization, forced-pooling, or otherwise) or until a non-standard unit, eliminating such interests, has been approved by the Commission.

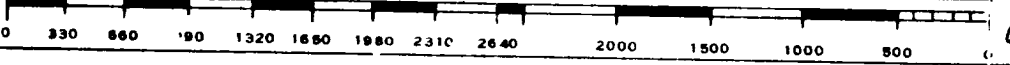
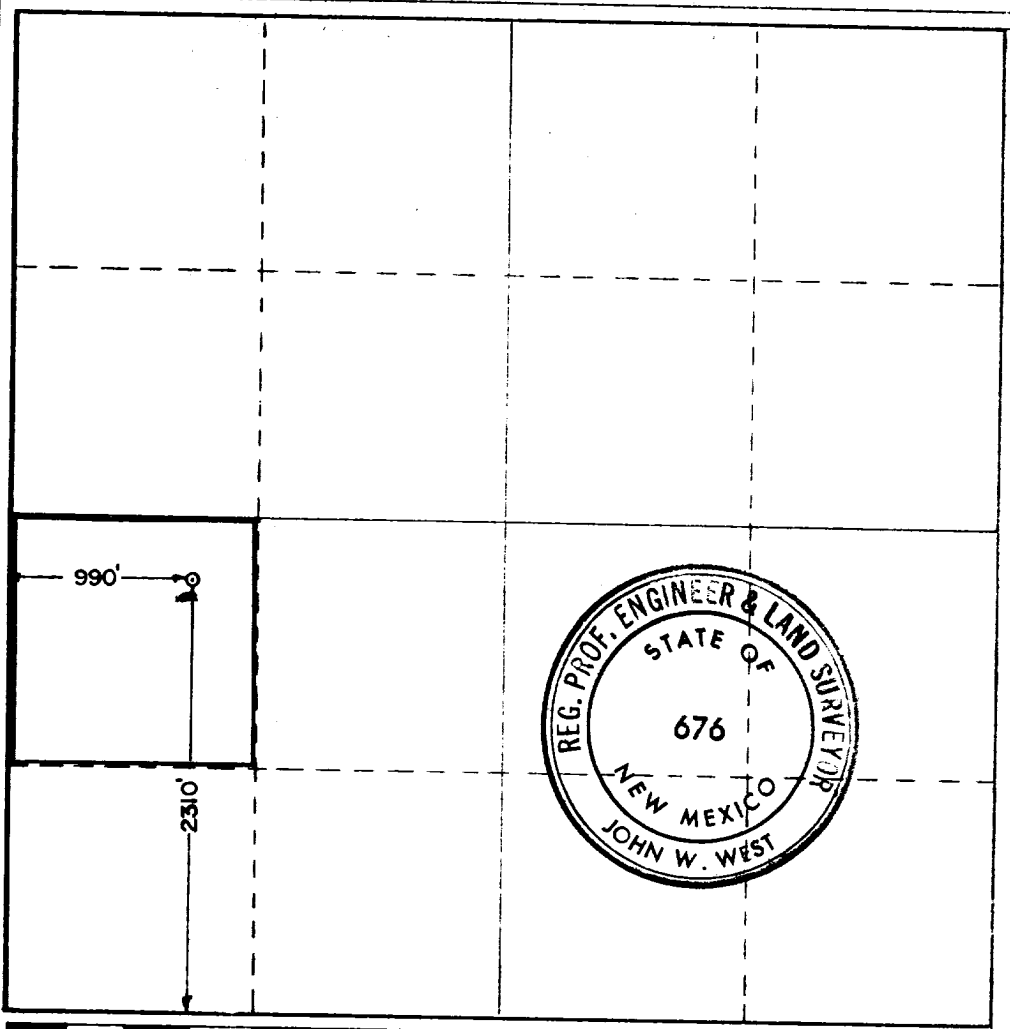

CERTIFICATION

I hereby certify that the information contained herein is true and complete to the best of my knowledge and belief.

Carl Engwall

Name
CARL ENGWALL

Position
OWNER

Company
SELF

Date
22 JULY 1965

I hereby certify that the well location shown on this plat was plotted from field notes of actual surveys made by me or under my supervision, and that the same is true and correct to the best of my knowledge and belief.

JULY 19, 1965

Date Surveyed

Registered Professional Engineer and/or Land Surveyor

John W. West

Certificate No.