

NEW MEXICO OIL CONSERVATION COMMISSION
WELL LOCATION AND ACREAGE DEDICATION PLAT
 REGISTRY OFFICE O. C. C.

Form C-102
 Supersedes C-128
 Effective 1-4-65

All distances must be from the outer boundaries of the Section.

Operator ROGER C. HANKS			Lease AUG 17 11 31 AM '66 U. S. GOVERNMENT (Federal)		Well No. 1
Init Letter J	Section 3	Township 20 South	Range 33 East	County Lea	
Actual Footage Location of Well: 1070 feet from the North line and 1980 feet from the East line					
Ground Level Elev. 3880	Producing Formation Sedan Rivers (3800')		Pool Wildcat	Dedicated Acreage: 40 Acres	

1. Outline the acreage dedicated to the subject well by colored pencil or hachure marks on the plat below.
2. If more than one lease is dedicated to the well, outline each and identify the ownership thereof (both as to working interest and royalty)
3. If more than one lease of different ownership is dedicated to the well, have the interests of all owners been consolidated by communitization, unitization, force-pooling, etc?

Yes No If answer is "yes," type of consolidation _____

If answer is "no," list the owners and tract descriptions which have actually been consolidated. (Use reverse side of this form if necessary) _____

No allowable will be assigned to the well until all interests have been consolidated (by communitization, unitization, forced-pooling, or otherwise) or until a non-standard unit, eliminating such interests, has been approved by the Commission.

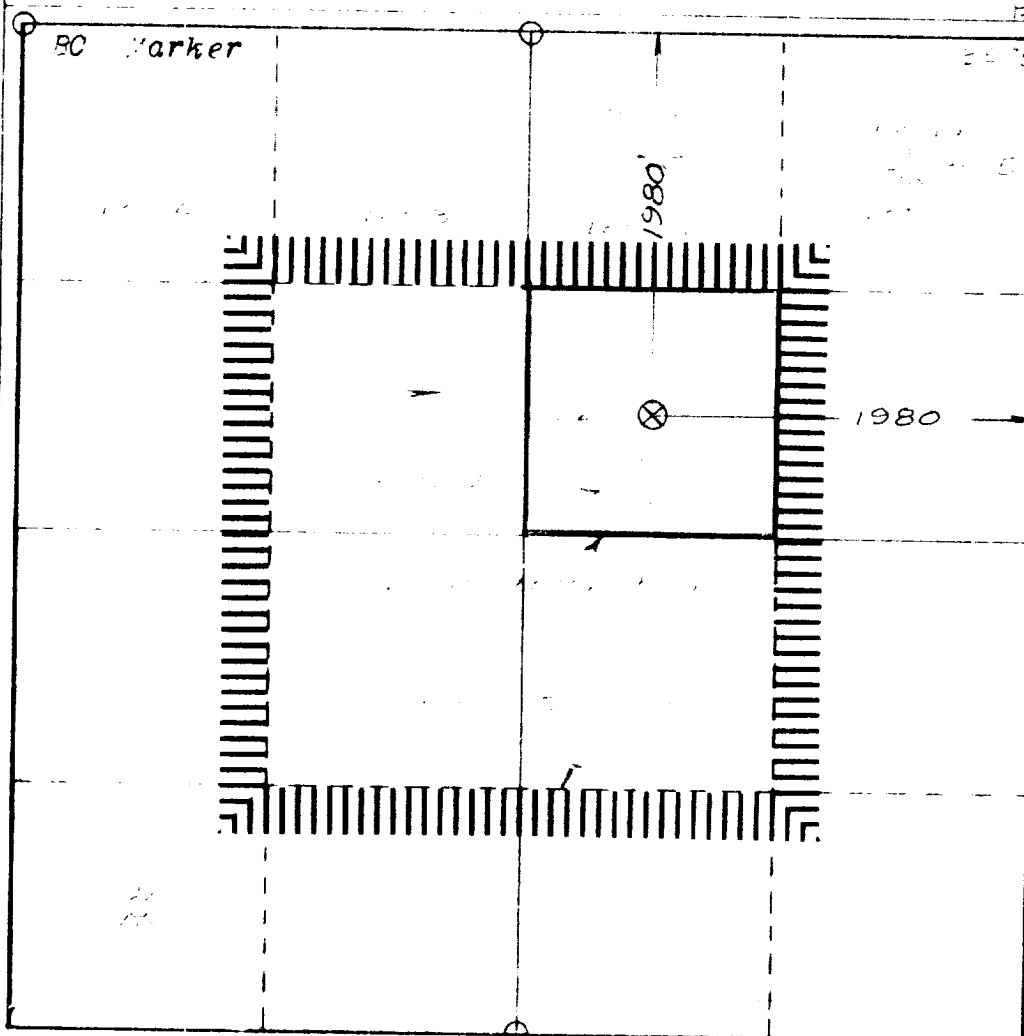

CERTIFICATION

I hereby certify that the information contained herein is true and complete to the best of my knowledge and belief.

Name
John W. Shearn
 Position
Agent & Surveyor
 Company
Roger C. Hanks
 Date
August 9, 1966

I hereby certify that the well location shown on this plat was plotted from field notes of actual surveys made by me or under my supervision, and that the same is true and correct to the best of my knowledge and belief.

Date Surveyed
August 5, 1966
 Registered Professional Engineer
 and/or Land Surveyor

John W. Shearn
 Certificate No. **1500**

