



IN REPLY REFER TO:

UNITED STATES
DEPARTMENT OF THE INTERIOR
GEOLOGICAL SURVEY

Drawer 1857
Roswell, New Mexico 88201

March 13, 1974

MRM Petroleum Corporation
259 Mid-American Building
Midland, Texas 79701

Gentlemen:

Your Application for Permit to Drill well No. 1 Federal "22" in the NW $\frac{1}{4}$ sec. 22, T. 20 S., R. 34 E., Lea County, New Mexico, lease NM 9030, to a depth of 3,750 feet to test the Yates formation in the Potash Area is hereby approved.

One copy of the application is returned herewith. Please notify the District Engineer, Geological Survey, P. O. Box 1157, Hobbs, New Mexico 88240, in sufficient time for a representative to witness all cementing operations. The Hobbs office telephone number is Area Code 505-393-3612.

Sincerely yours,

(ORIG. SGN) CARL C. TRAYWICK

CARL C. TRAYWICK
Acting Area Oil & Gas Supervisor

Enclosure

cc: Regional Manager, Denver
Area Mining Supervisor (2)
NMOCC-Hobbs (2) (w/2 cys. Notice) ✓
Hobbs
Roswell (2)

UNITED STATES
DEPARTMENT OF THE INTERIOR
GEOLOGICAL SURVEY

APPLICATION FOR PERMIT TO DRILL, DEEPEN, OR PLUG BACK

1a. TYPE OF WORK
 DRILL DEEPEN PLUG BACK

b. TYPE OF WELL
 OIL WELL GAS WELL OTHER
 SINGLE ZONE MULTIPLE ZONE

2. NAME OF OPERATOR
 NRM PETROLEUM CORPORATION

3. ADDRESS OF OPERATOR
 259 Mid-America Building, Midland, Tx 79701

4. LOCATION OF WELL (Report location clearly and in accordance with any State requirements.)*
 At surface 660' FWL & 990' FNL
 At proposed prod. zone 660' FWL & 990' FNL

14. DISTANCE IN MILES AND DIRECTION FROM NEAREST TOWN OR POST OFFICE*
 NA

15. DISTANCE FROM PROPOSED* LOCATION TO NEAREST PROPERTY OR LEASE LINE, FT. (Also to nearest drlg. unit line, if any) 660'

16. NO. OF ACRES IN LEASE 80

17. NO. OF ACRES ASSIGNED TO THIS WELL 40

18. DISTANCE FROM PROPOSED LOCATION* TO NEAREST WELL, DRILLING, COMPLETED, OR APPLIED FOR, ON THIS LEASE, FT. NA

19. PROPOSED DEPTH 3750'

20. ROTARY OR CABLE TOOLS Rotary

21. ELEVATIONS (Show whether DF, RT, GR, etc.) 3651' DF (Est)

22. APPROX. DATE WORK WILL START* March 20, 1974

5. LEASE DESIGNATION AND SERIAL NO. NM - 9030

6. IF INDIAN, ALLOTTEE OR TRIBE NAME

7. UNIT AGREEMENT NAME

8. FARM OR LEASE NAME Federal "22"

9. WELL NO. 1

10. FIELD AND POOL, OR WILDCAT Lynch Middle Yates

11. SEC., T., R., M., OR BLK. AND SURVEY OR AREA 22-20S-34E NMPM

12. COUNTY OR PARISH Lea 13. STATE New Mexico

23. PROPOSED CASING AND CEMENTING PROGRAM

SIZE OF HOLE	SIZE OF CASING	WEIGHT PER FOOT	SETTING DEPTH	QUANTITY OF CEMENT
11	8 5/8"	20	250-300	150 sacks CIRCULATE
7 7/8	4 1/2" or 5 1/2"	9.5 or 15.5	3750	400 sacks CIRCULATE

IN ABOVE SPACE DESCRIBE PROPOSED PROGRAM: If proposal is to deepen or plug back, give data on present productive zone and proposed new productive zone. If proposal is to drill or deepen directionally, give pertinent data on subsurface locations and measured and true vertical depths. Give blowout preventer program, if any.

24. SIGNED [Signature] TITLE Vice President DATE March 5, 1974

(This space for Federal or State office use)

PERMIT NO. _____ APPROVAL DATE _____

APPROVED BY _____ TITLE _____ DATE _____

CONDITIONS OF APPROVAL, IF ANY:

NEW MEXICO OIL CONSERVATION COMMISSION
WELL LOCATION AND ACREAGE DEDICATION PLAT

Form C-102
Supersedes C-128
Effective 1-1-65

All distances must be from the outer boundaries of the Section.

Operator N R M PETROLEUM CORPORATION			Lease FEDERAL		Well No. 1
Unit Letter D	Section 22	Township 20 - S	Range 34 - E	County LEA	
Actual Footage Location of Well: 990' feet from the NORTH line and 660 feet from the WEST line					
Ground Level Elev. 3651 DF (est)	Producing Formation Yates		Pool Middle Lynch Yates-7 Riv.	Dedicated Acreage 40 Acres	

1. Outline the acreage dedicated to the subject well by colored pencil or hachure marks on the plat below.
2. If more than one lease is dedicated to the well, outline each and identify the ownership thereof (both as to working interest and royalty).
3. If more than one lease of different ownership is dedicated to the well, have the interests of all owners been consolidated by communitization, unitization, force-pooling, etc?

Yes No If answer is "yes," type of consolidation N.A.

If answer is "no," list the owners and tract descriptions which have actually been consolidated. (Use reverse side of this form if necessary.) N.A.

No allowable will be assigned to the well until all interests have been consolidated (by communitization, unitization, forced-pooling, or otherwise) or until a non-standard unit, eliminating such interests, has been approved by the Commission.

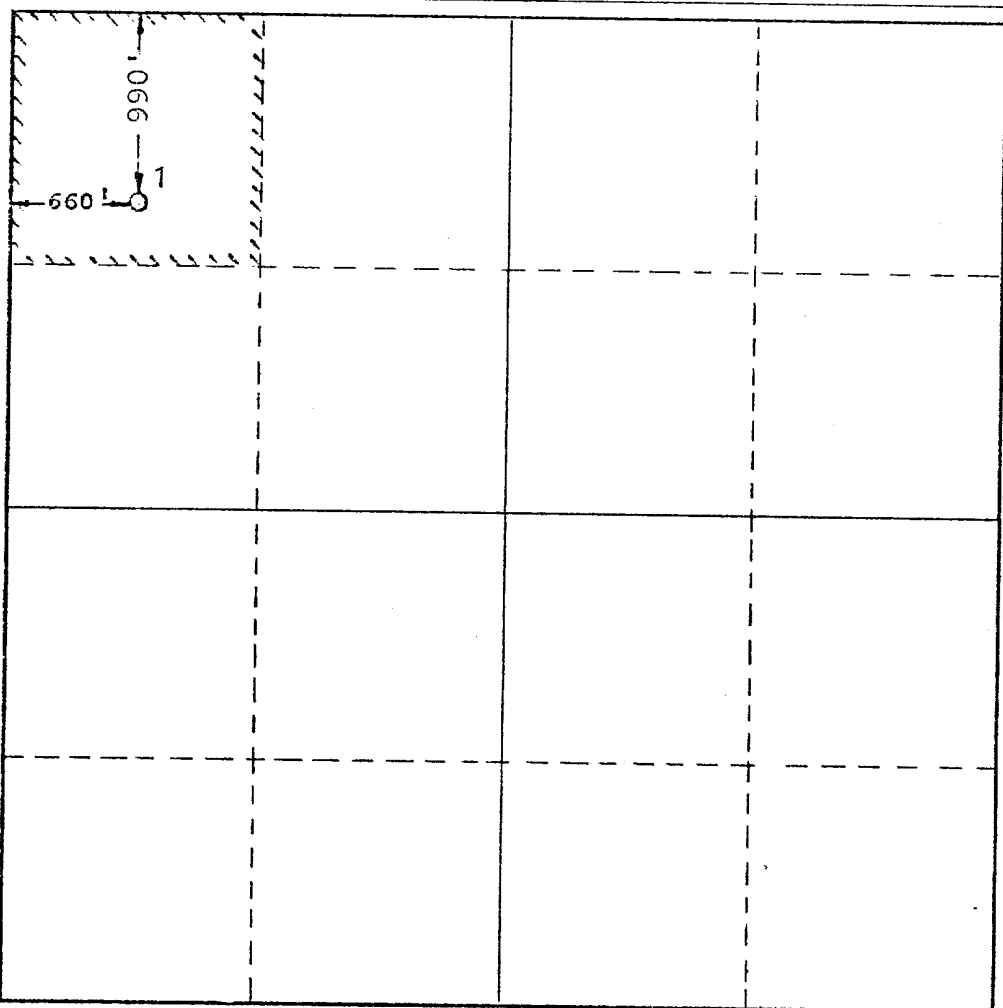

CERTIFICATION

I hereby certify that the information contained herein is true and complete to the best of my knowledge and belief.

[Signature]
Name

Vice President
Position

NRM Petroleum Corp.
Company

6 March 1974
Date

Date

I hereby certify that the well location shown on this plat was plotted from field notes of actual surveys made by me or under my supervision, and that the same is true and correct to the best of my knowledge and belief.

Date Surveyed
March 4 1974

Registered Professional Engineer and/or Land Surveyor

[Signature]

Certificate No.
2189

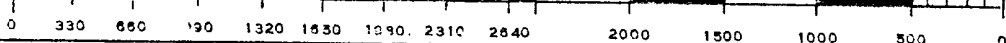

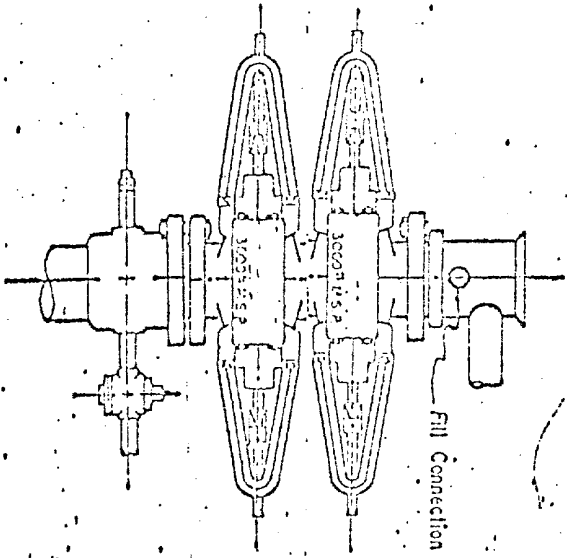

**3,000 PSI WORKING PRESSURE
BLOWOUT PREVENTER HOOK-UP**

Series 900 Flanges, or Better

DEVELOPMENT PLAN FOR SURFACE USE
FEDERAL "22" #1
660' FWL and 990' FNL SECTION 22-20S-34E
LEA COUNTY, NEW MEXICO

1. Existing roads are shown on the attached Maljamar Quadrangle 107 map and a 1" = 4000' scale county map.
2. We plan to build 330' South from existing road to the proposed location. The proposed road is shown in blue on the attached county map. Road width will be about 25' and will be compacted rather than surfaced.
3. See attached county map.
4. See attached county map.
5. See attached county map.
6. Water for drilling will be hauled.
7. Cuttings will be disposed into the reserve pit. Garbage and trash will be buried in a small, separate pit near the reserved pits.
8. Not applicable.
9. Not applicable.
10. A layout diagram for Cactus Drilling Company Rig No. 65 is attached. The drilling pad will be compacted.
11. All pits will be covered and the location levelled.
12. The topography is flat. The country is sandy with mesquite bushes. No vegetation.

Representative Responsible for Compliance
with Development Plan for Surface Use:

David G. Griffin
Vice-President
915/684-7871

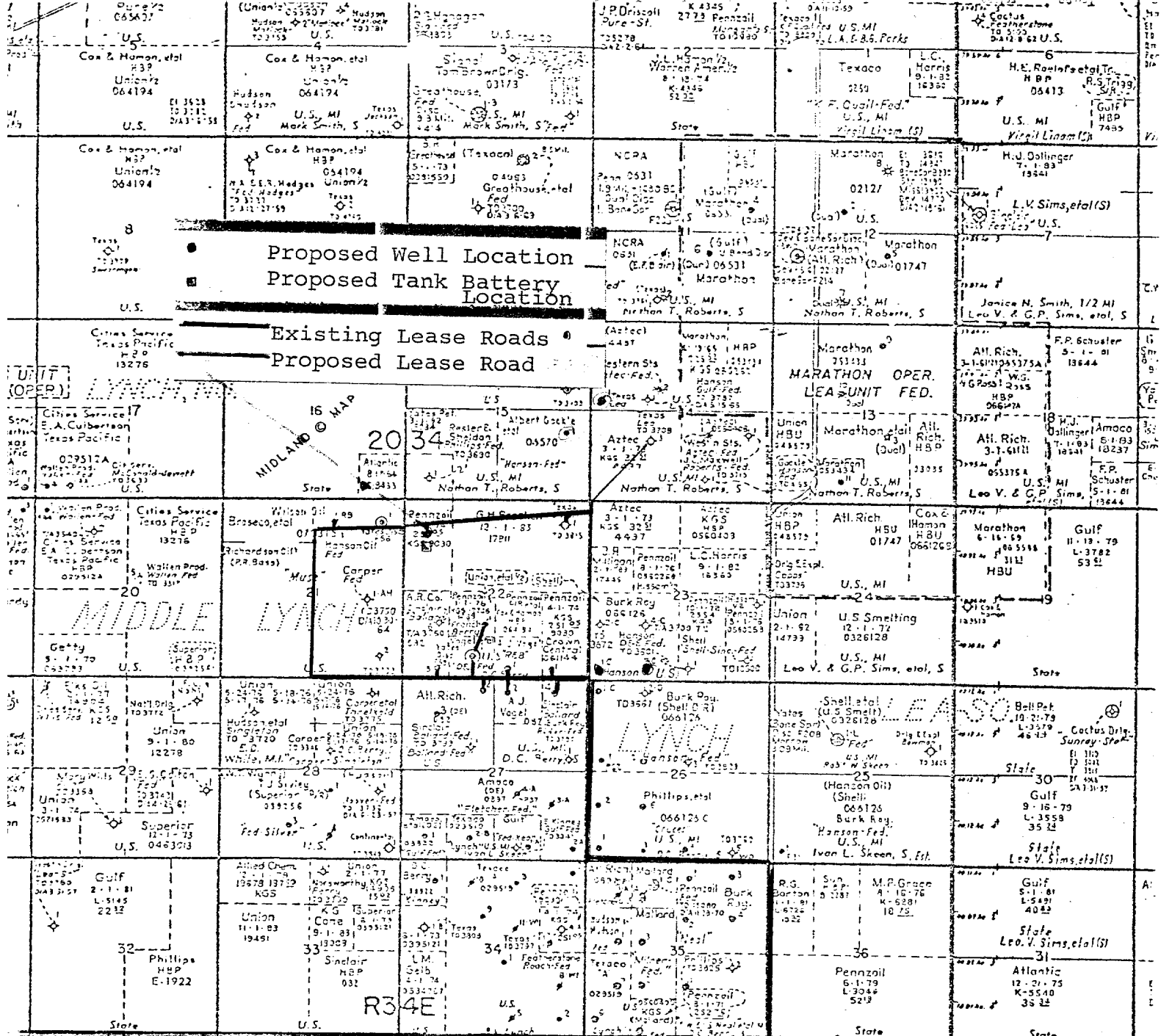

Proposed Well Location
 Proposed Tank Location
 Proposed Battery Location

Existing Lease Roads
 Proposed Lease Road

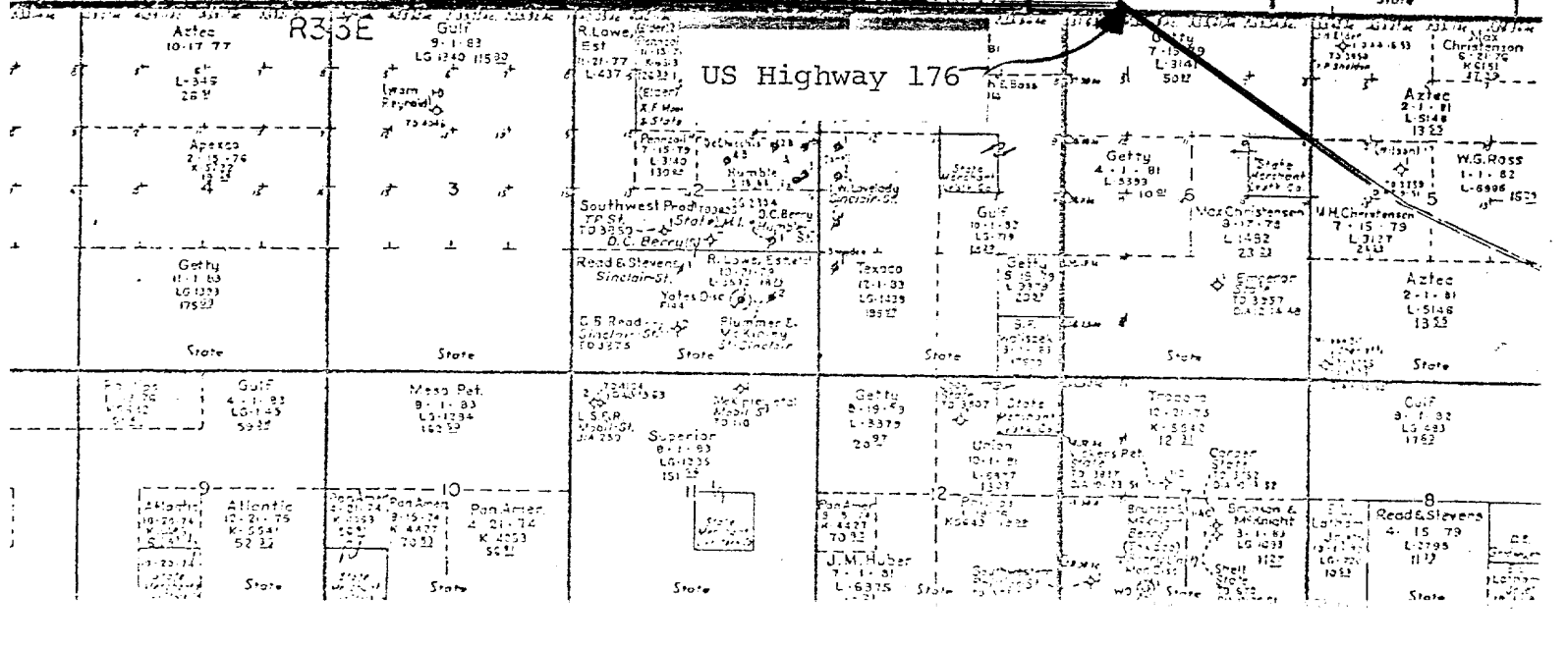

US Highway 176

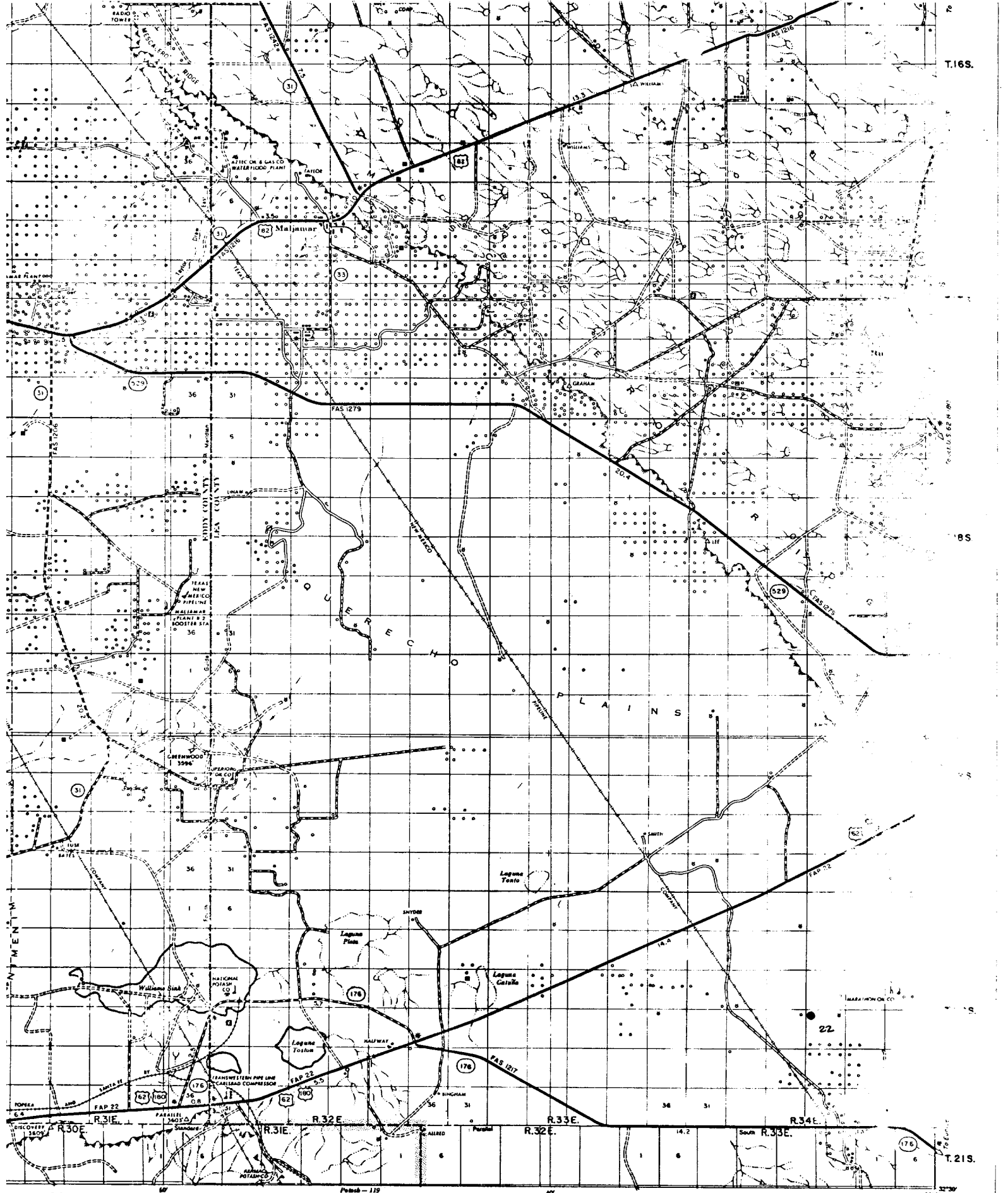

R.30E. R.31E. R.32E. R.33E. R.34E.

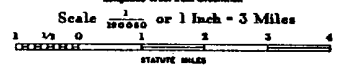

DATE OF INVENTORY
 EDDY COUNTY 1965
 LEA CO 1963
 CHAVES COUNTY 1966

MALJAMAR QUADRANGLE
 107

NEW WELL DRILLING PAD

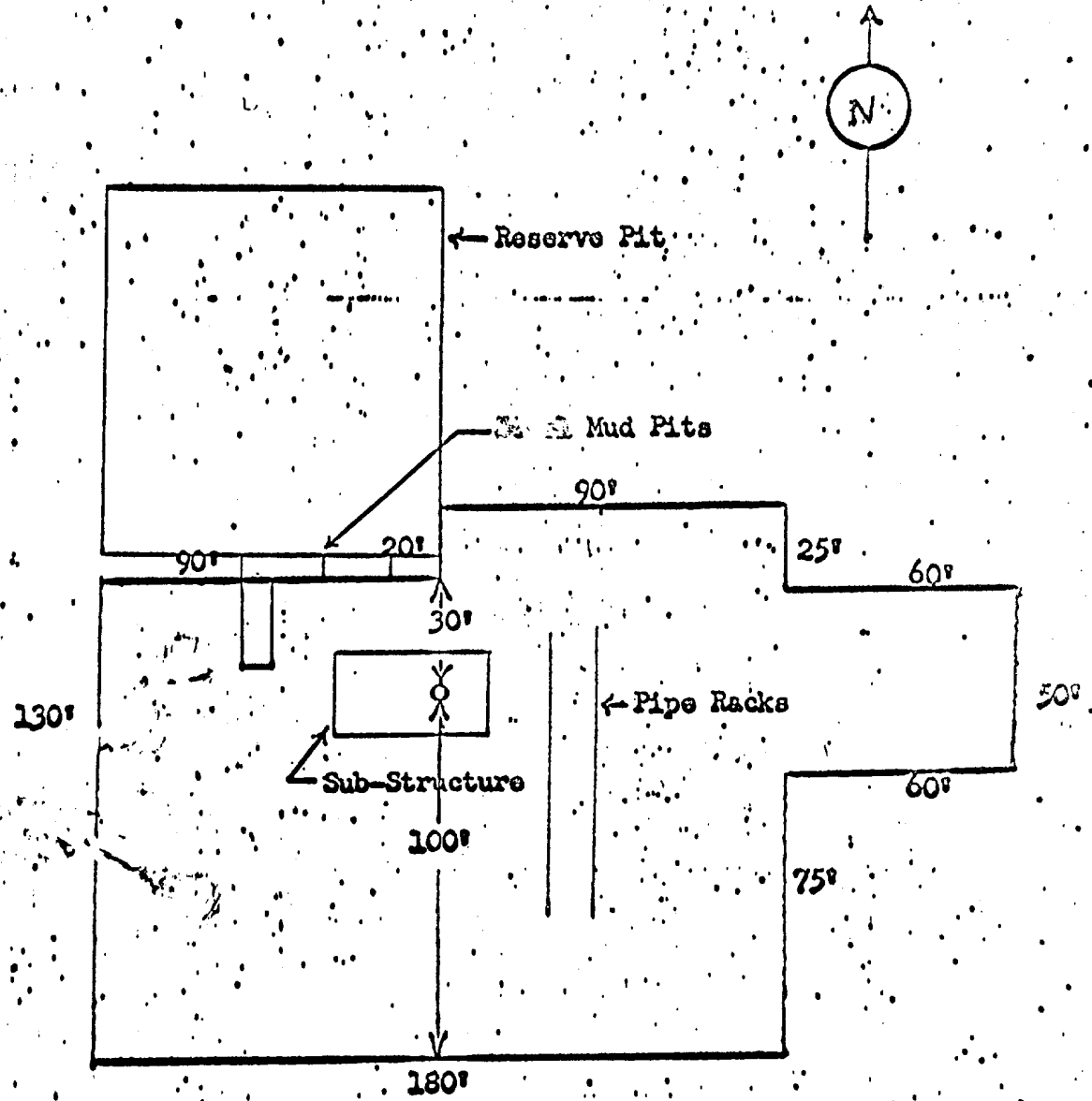

To 5000' Well
Scale: 1" = 50'