

NO. OF COPIES RECEIVED		
DISTRIBUTION		
SANTA FE		
FILE		
U.S.G.S.		
LAND OFFICE		
OPERATOR		

NEW MEXICO OIL CONSERVATION COMMISSION

Form C-101
Revised 1-1-65

5A. Indicate Type of Lease	
STATE <input type="checkbox"/>	FEE <input checked="" type="checkbox"/>

5. State Oil & Gas Lease No.

APPLICATION FOR PERMIT TO DRILL, DEEPEN, OR PLUG BACK

1a. Type of Work		7. Unit Agreement Name	
b. Type of Well OIL WELL <input checked="" type="checkbox"/> GAS WELL <input type="checkbox"/> OTHER <input type="checkbox"/>		8. Farm or Lease Name Wallen Fee	
2. Name of Operator Walter W. Krug DBA Wallen Production Company		9. Well No. # 1	
3. Address of Operator P. O. Box 1960 - Midland, Texas 79701		10. Field and Pool, or Wildcat Undesignated	
4. Location of Well UNIT LETTER <u>D</u> LOCATED <u>330'</u> FEET FROM THE <u>N</u> LINE AND <u>990</u> FEET FROM THE <u>W</u> LINE OF SEC. <u>28</u> TWP. <u>20S</u> RGE. <u>34E</u> NMPM		12. County Lea	
21. Elevations (Show whether DF, RT, etc.) GR 3680		19. Proposed Depth 4000 ?	19A. Formation Yates Seven Rivers
21A. Kind & Status Plug. Bond multiple	21B. Drilling Contractor Wallen Drilling	20. Rotary or C.T. C.T.	
22. Approx. Date Work will start 2-11-76			

PROPOSED CASING AND CEMENT PROGRAM

SIZE OF HOLE	SIZE OF CASING	WEIGHT PER FOOT	SETTING DEPTH	SACKS OF CEMENT	EST. TOP
15"	13 3/8"	76	225	mudded in	
12 3/4"	10 3/4"	48	900	mudded in	
10"	8 5/8"	34	1250	mudded in	
8"	7"	23	3300	1050 sxs	surface of ground
* 6 3/8"	4 1/2"	10 1/2	3600	60 sxs	top of liner

THE COMMISSION MUST BE NOTIFIED
24 HOURS PRIOR TO RUNNING
CASING.

* 600' liner set on 2 3/8" tubing

13 3/8" C.S.G. MUST BE CEMENTED TO THE SURFACE

IN ABOVE SPACE DESCRIBE PROPOSED PROGRAM: IF PROPOSAL IS TO DEEPEN OR PLUG BACK, GIVE DATA ON PRESENT PRODUCTIVE ZONE AND PROPOSED NEW PRODUCTIVE ZONE. GIVE BLOWOUT PREVENTER PROGRAM, IF ANY.

I hereby certify that the information above is true and complete to the best of my knowledge and belief.

Signed Walter W. Krug Title Engineer Date 2-8-1976

(This space for Sign. Use by)

Jerry Sexton

SUPERVISOR DISTRICT

FEB 16 1976

APPROVED BY Dist. A. Super. TITLE _____ DATE _____

CONDITIONS OF APPROVAL, IF ANY:

NEW MEXICO OIL CONSERVATION COMMISSION
WELL LOCATION AND ACREAGE DEDICATION PLAT

Form C-102
Supersedes C-128
Effective 1-1-65

All distances must be from the outer boundaries of the Section.

Operator WALLEN PRODUCTION CO.		Lease WALLEN FEE		Well No. 1	
Unit Letter "D"	Section 28	Township 20-S	Range 34-E	County LEA	
Actual Footage Location of Well: 330 feet from the NORTH line and 990 feet from the WEST line					
Ground Level Elev. 3680	Producing Formation YATES	Pool UNDESIGNATED		Dedicated Acreage: 40 Acres	

1. Outline the acreage dedicated to the subject well by colored pencil or hachure marks on the plat below.
2. If more than one lease is dedicated to the well, outline each and identify the ownership thereof (both as to working interest and royalty).
3. If more than one lease of different ownership is dedicated to the well, have the interests of all owners been consolidated by communitization, unitization, force-pooling, etc?

☐ Yes ☐ No If answer is "yes," type of consolidation _____

If answer is "no," list the owners and tract descriptions which have actually been consolidated. (Use reverse side of this form if necessary.) _____

No allowable will be assigned to the well until all interests have been consolidated (by communitization, unitization, forced-pooling, or otherwise) or until a non-standard unit, eliminating such interests, has been approved by the Commission.

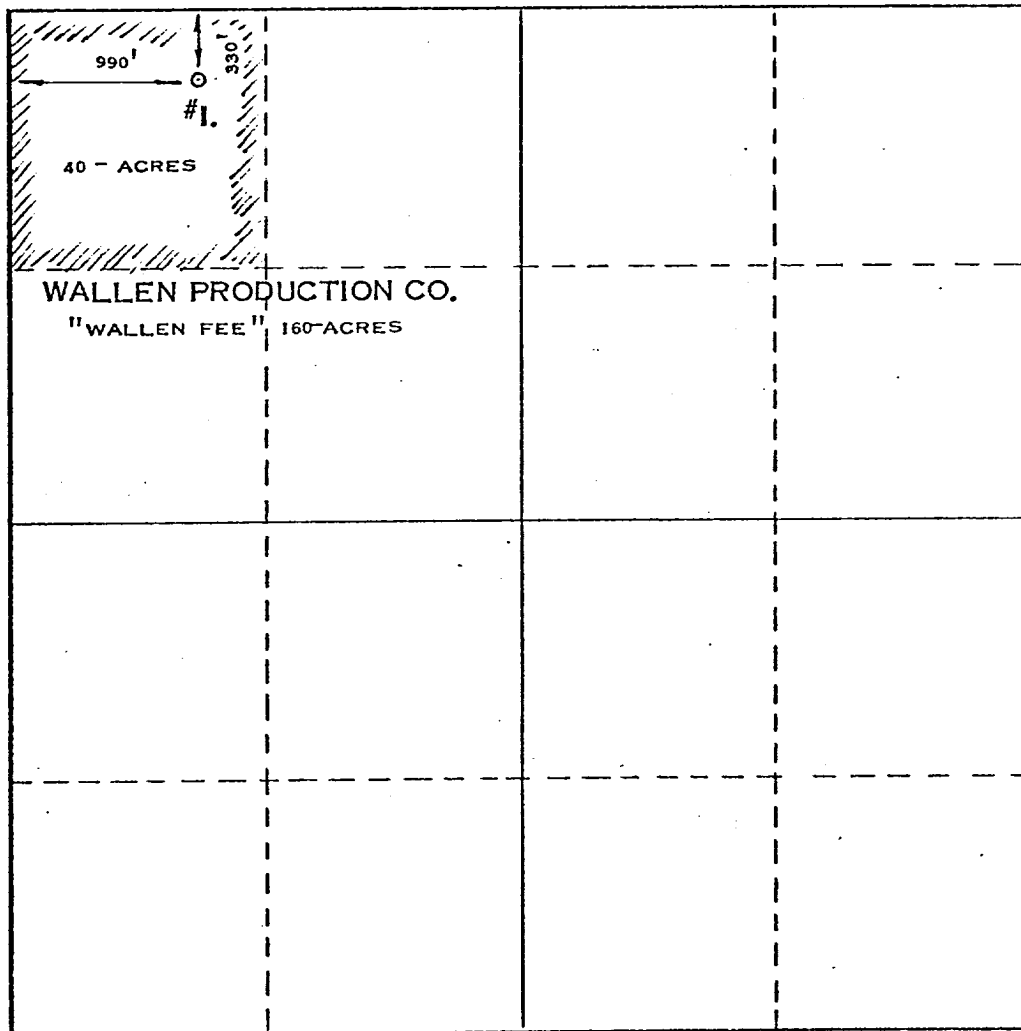

CERTIFICATION

I hereby certify that the information contained herein is true and complete to the best of my knowledge and belief.

Name

Position

Company

Date

I hereby certify that the well location shown on this plat was plotted from field notes of actual surveys made by me or under my supervision, and that the same is true and correct to the best of my knowledge and belief.

Date Surveyed

JANUARY 20, 1976

Registered Professional Engineer and/or Land Surveyor

MAX A SCHUMANN JR

Certificate No.

1510

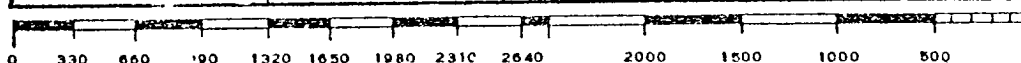

NO. OF COPIES RECEIVED	
DISTRIBUTION	
SANTA FE	
FILE	
U.S.G.S.	
LAND OFFICE	
OPERATOR	

NEW MEXICO OIL CONSERVATION COMMISSION

Form C-103
Supersedes Old
C-102 and C-103
Effective 1-1-65

<p align="center">SUNDRY NOTICES AND REPORTS ON WELLS</p> <p align="center"><small>(DO NOT USE THIS FORM FOR PROPOSALS TO DRILL OR TO REFIN. OR PLUG BACK TO A DIFFERENT RESERVOIR. USE APPLICATION FOR PERMIT - FORM C-101 FOR SUCH PROPOSALS.)</small></p>		<p>5a. Indicate Type of Lease State <input type="checkbox"/> Fee <input checked="" type="checkbox"/></p> <p>5. State Oil & Gas Lease No.</p>																				
<p>1. <input checked="" type="checkbox"/> OIL WELL <input type="checkbox"/> GAS WELL <input type="checkbox"/> OTHER</p> <p>2. Name of Operator Walter W. Krug DBA Wallen Production Company</p> <p>3. Address of Operator Box 1960 Midland, Texas 79701</p> <p>4. Location of Well UNIT LETTER <u>D</u> <u>330'</u> FEET FROM THE <u>N</u> LINE AND <u>990'</u> FEET FROM THE <u>W</u> LINE, SECTION <u>28</u> TOWNSHIP <u>20S</u> RANGE <u>34 E</u> N.M.P.M.</p>	<p>7. Unit Agreement Date</p> <p>8. Form or Lease Name Wallen Fee</p> <p>9. Well No. # <u>1</u></p> <p>10. Field and Pool, or Wildcat undesigned</p>	<p>12. County Lea</p>																				
<p>15. Elevation (Show whether DF, RT, GR, etc.) GR 3680</p>																						
<p>16. Check Appropriate Box To Indicate Nature of Notice, Report or Other Data</p> <table border="0"> <tr> <td colspan="2">NOTICE OF INTENTION TO:</td> <td colspan="2">SUBSEQUENT REPORT OF:</td> </tr> <tr> <td>PERFORM REMEDIAL WORK <input type="checkbox"/></td> <td>PLUG AND ABANDON <input type="checkbox"/></td> <td>REMEDIAL WORK <input type="checkbox"/></td> <td>ALTERING CASING <input type="checkbox"/></td> </tr> <tr> <td>TEMPORARILY ABANDON <input type="checkbox"/></td> <td>CHANGE PLANS <input type="checkbox"/></td> <td>COMMENCE DRILLING OPNS. <input type="checkbox"/></td> <td>PLUG AND ABANDONMENT <input type="checkbox"/></td> </tr> <tr> <td>PULL OR ALTER CASING <input type="checkbox"/></td> <td>OTHER <input type="checkbox"/></td> <td>CASING TEST AND CEMENT JOB <input type="checkbox"/></td> <td></td> </tr> <tr> <td></td> <td></td> <td>OTHER <u>blowout preventor or control head</u></td> <td></td> </tr> </table>			NOTICE OF INTENTION TO:		SUBSEQUENT REPORT OF:		PERFORM REMEDIAL WORK <input type="checkbox"/>	PLUG AND ABANDON <input type="checkbox"/>	REMEDIAL WORK <input type="checkbox"/>	ALTERING CASING <input type="checkbox"/>	TEMPORARILY ABANDON <input type="checkbox"/>	CHANGE PLANS <input type="checkbox"/>	COMMENCE DRILLING OPNS. <input type="checkbox"/>	PLUG AND ABANDONMENT <input type="checkbox"/>	PULL OR ALTER CASING <input type="checkbox"/>	OTHER <input type="checkbox"/>	CASING TEST AND CEMENT JOB <input type="checkbox"/>				OTHER <u>blowout preventor or control head</u>	
NOTICE OF INTENTION TO:		SUBSEQUENT REPORT OF:																				
PERFORM REMEDIAL WORK <input type="checkbox"/>	PLUG AND ABANDON <input type="checkbox"/>	REMEDIAL WORK <input type="checkbox"/>	ALTERING CASING <input type="checkbox"/>																			
TEMPORARILY ABANDON <input type="checkbox"/>	CHANGE PLANS <input type="checkbox"/>	COMMENCE DRILLING OPNS. <input type="checkbox"/>	PLUG AND ABANDONMENT <input type="checkbox"/>																			
PULL OR ALTER CASING <input type="checkbox"/>	OTHER <input type="checkbox"/>	CASING TEST AND CEMENT JOB <input type="checkbox"/>																				
		OTHER <u>blowout preventor or control head</u>																				
<p>17. Describe Proposed or Completed Operations (Clearly state all pertinent details, and give pertinent dates, including estimated date of starting any proposed work) SEE RULE 1103.</p>																						

The blowout preventor or control head that I plan to use for this well is a regular cabletool type capable of pressures of 1500 lbs + I can obtain a control head that is capable of 3500lbs in case of need.

18. I hereby certify that the information above is true and complete to the best of my knowledge and belief.

SIGNED <u>Walter W. Krug</u>	TITLE <u>Engineer</u>	DATE <u>2-11-76</u>
APPROVED BY <u>Jerry Sexton</u>	TITLE <u>Eng. In Charge</u>	DATE <u>FEB 10 1976</u>

CONDITIONS OF APPROVAL, IF ANY:

COUNTY	TEA	FIELD	Undesignated	STATE	NM	
OPR	WALLEN PRODUCTION CO.			API	86-029-2828*	
NO	1	LEASE	Wallen Fee	SERIAL	6-4-11 NM	
Sec 28, T20S, R34E				MAP		
206' ENL, 990' FWL of Sec				CO-ORD		
20 mi E/Halfway				ELEV		
SPD	2-22-76	CMP	5-27-76			
CSG				WELL CLASS:	INIT	
13 1/8" at 227' w/102 sx 7" at 3300' w/866 sx 4 1/2" Inn 3124-3692' w/600sx			FORMATION	DATUM	FORMATION	DATUM
			TD	3713'	PBD	3640'
(Water) Perfs 3489-3535' P 65 RO; TD + 15' SW. Inc based on test. GOR 1040; gty 34.8						
CONTR	Sec 28, T20S	OPN'S ELEV	3680'	PD	400'	

F.R. 2-23-76
(Seven Rivers)
2-22-76 Drlg 970'
3-1-76 Drlg 1110'
3-9-76 Drlg 1420'
3-15-76 Drlg 1610'
3-23-76 Drlg 1692' anhy
3-30-76 Drlg 1810'
4-6-76 TD 3300'; WOC
4-10-76 Drlg 3410'
4-27-76 TD 3713'; WOC
5-10-76 TD 3713'; WOCU
6-14-76 TD 3713'; PBD 3640'; WOSI
Perf (Yates) 3489-92';
Acid (3489-3535') 300 gal.

6-103

Y

LEA
WARREN PRODUCTION CO.

Undesignated
1 Wallen Fee
Sec 28, T20S, R34E

NM
Page #2

6-19-76 Continued
Frac (3489-3535') 10,000 gals + 10,000# ad
LOG TOPS: Anhydrite 1608', Salt 1731', Base
Salt 3278', Yates 3448', Seven Rivers 3662'
6-21-76 TD 3713'; FBD 3640'; Complete
LOGS RUN: GRNL, GRSL
6-26-76 COMPLETION ISSUED

6-4-11 NM
M 30-025-70051-76