

NO. OF COPIES RECEIVED	
DISTRIBUTION	
SANTA FE	
FILE	
U.S.G.S.	
LAND OFFICE	
OPERATOR	

NEW MEXICO OIL CONSERVATION COMMISSION

Form C-101  
Revised 1-1-65

5A. Indicate Type of Lease  
STATE  FEDERAL   
5. State Oil & Gas Lease No.

APPLICATION FOR PERMIT TO DRILL, DEEPEN, OR PLUG BACK

1a. Type of Work  
b. Type of Well DRILL  DEEPEN  PLUG BACK   
OIL WELL  GAS WELL  OTHER  SINGLE ZONE  MULTIPLE ZONE

2. Name of Operator  
AMOCO PRODUCTION COMPANY

3. Address of Operator  
P.O. DRAWER A LEVELLAND, TEXAS 79336

4. Location of Well UNIT LETTER C LOCATED 1272 FEET FROM THE North LINE  
AND 1420 FEET FROM THE West LINE OF SEC. 5 TWP. 19-S RGE. 38-E N.M.P.M.

7. Unit Agreement Name  
8. Form of Lease Name  
South Hobbs (GSA) Unit  
9. Well No.  
120  
13. Field and Pool, if existing  
Und. San Andres  
17. County  
Lea

15. Proposed Depth  
4270'  
16A. Formation  
San Andres  
16. Nature of C.I.  
Rotary

21. Elevations (Show whether DE, RI, etc.)  
3620.2 GR  
21A. Kind & Status Plug. Bond  
Blanket on file  
21B. Drilling Contractor  
ND  
22. Approx. Date Work will start  
11-1-78

PROPOSED CASING AND CEMENT PROGRAM

SIZE OF HOLE	SIZE OF CASING	WEIGHT PER FOOT	SETTING DEPTH	SACKS OF CEMENT	EST. TOP
17 1/2"	13-3/8"	48#	400'	Circulate to surface	
12 1/4"	8-5/8"	24#	3870'	Circulate to surface	
7-7/8"	5 1/2" (liner)	14#	3670'-4270'	Tie back to	8-5/8"

After drilling well, logs will be run and evaluation made. Perforating and/or stimulating as necessary in attempting commercial production.

Mud program: 0-400' Native mud and water  
400'-3870' Commercial mud and brine to maintain good hole condition  
3870'-4270' Will core 400' with lease crude

BOP program attached

Unorthodox location has been approved by hearing on 9/13/78.  
Order No. R-5833

IN ABOVE SPACE DESCRIBE PROPOSED PROGRAM; IF PROPOSAL IS TO DEEPEN OR PLUG BACK, GIVE DATA ON PRESENT PRODUCTIVE ZONE AND PROPOSED NEW PRODUCTIVE ZONE. GIVE BLOWOUT PREVENTER PROGRAM, IF ANY.

I hereby certify that the information above is true and complete to the best of my knowledge and belief.

Signed Dennis Evans Title Asst. Admn. Analyst Date 10-13-78

(This space for State Use)

APPROVED BY [Signature] TITLE SUPERVISOR DISTRICT 1 DATE NOV 6 1978

CONDITIONS OF APPROVAL, IF ANY:

0+4 - AMOCC-H 1 - SUSP  
1 - REG 1 - DE

NEW MEXICO OIL CONSERVATION COMMISSION  
WELL LOCATION AND ACREAGE DEDICATION PLAT

Form O-102  
Superseded O-228  
Effective 1-1-65

All distances must be from the outer boundaries of the Section

Operator Amoco Production Co.		Lease South Hobbs CSAU			Well No. 120
Section Letter C	Section 5	Township 19 South	Range 38 East	County Lea	
Approximate Location of Well:					
1272 feet from the North line and		1420 feet from the West line			
Spot Elevation 3620.2	Producing Formation SAN ANDRES		Pool Hnd	Dedicated Acreage 40 (39.90)	

- Outline the acreage dedicated to the subject well by colored pencil or hachure marks on the plat below.
- If more than one lease is dedicated to the well, outline each and identify the ownership thereof (both as to working interest and royalty).
- If more than one lease of different ownership is dedicated to the well, have the interests of all owners been consolidated by communitization, unitization, force-pooling, etc?

Yes  No If answer is "yes," type of consolidation \_\_\_\_\_

If answer is "no," list the owners and tract descriptions which have actually been consolidated. (Use reverse side of this form if necessary.) \_\_\_\_\_

No allowable will be assigned to the well until all interests have been consolidated (by communitization, unitization, forced-pooling, or otherwise) or until a non-standard unit, eliminating such interests, has been approved by the Commission.

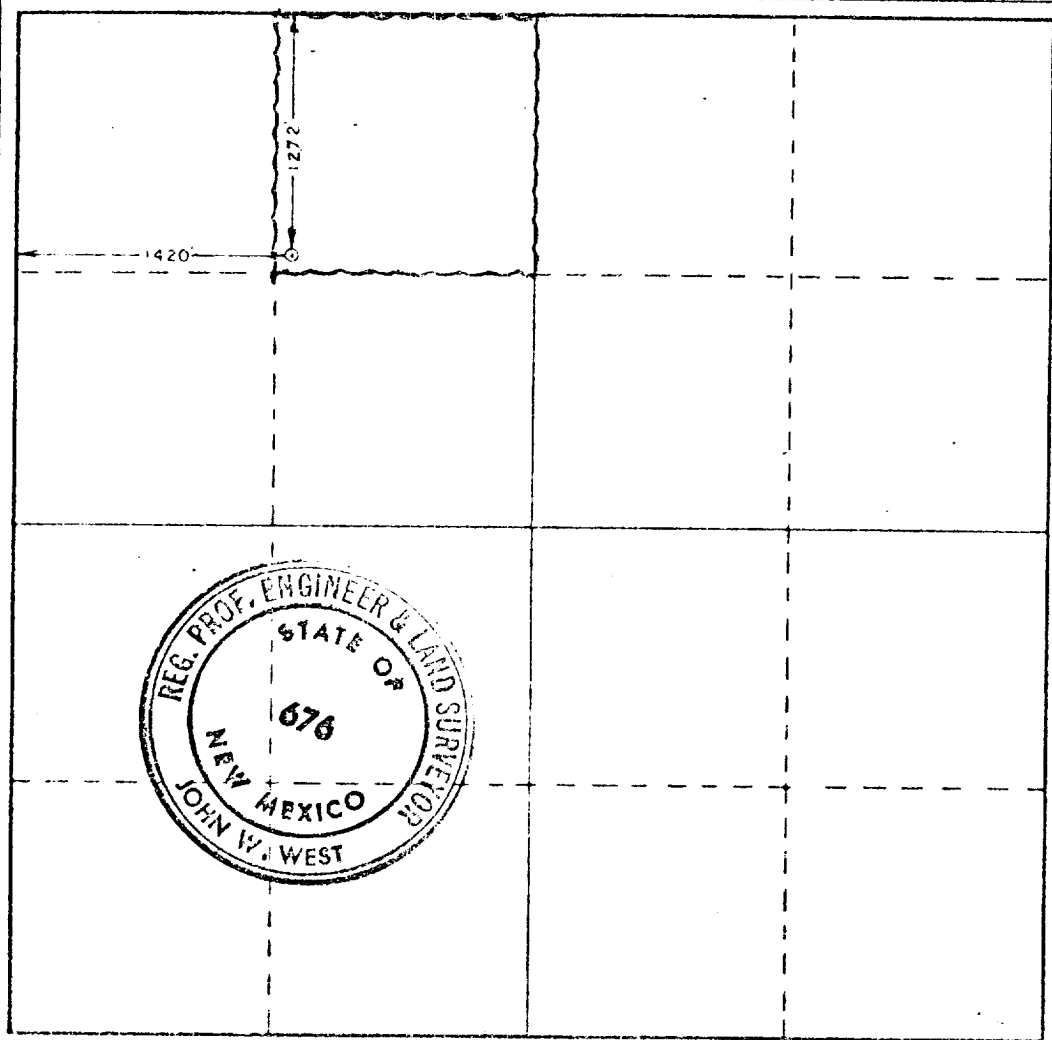

CERTIFICATION

I hereby certify that the information contained herein is true and complete to the best of my knowledge and belief.

Name: Dennis Evans  
Position: Assist. Chem. Analyst  
Company: AMOCO Prod. Co  
Date: 10-13-78

I hereby certify that the well location shown on this plat was plotted from field notes of actual surveys made by me or under my supervision, and that the same is true and correct to the best of my knowledge and belief.

Date Surveyed: August 17, 1978  
Registered Professional Engineer and/or Land Surveyor: [Signature]  
Certificate No.: John W. West 676  
Ronald J. Eidson 3239

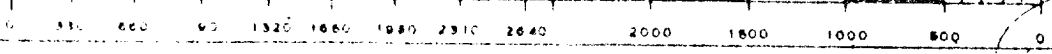

RECEIVED  
0072 01313  
U.S. DEPARTMENT OF COMMERCE  
WASHINGTON, D.C.

ATTACHMENT "B"  
NOTES

1. Blow-out preventers and master valve to be fluid operated and oil fittings must be in good condition, 3,000# W.P. (6,000 p.s.i. test), minimum.
2. Equipment through which bit must pass shall be as large as the inside diameter of the casing that is being drilled through.
3. Nipple above blow-out preventer shall be same size as casing being drilled through.
4. Kelly cock required, 3,000# W.P. (6,000 p.s.i. test) minimum.
5. OMSCO or comparable safety valve must be available on rig floor at all times with proper connection or sub, 3,000# W.P. (6,000 p.s.i. test), minimum.
6. Blow-out preventers and master valve while drilling intermediate hole to 6000' may be 2,000# W.P. (4,000 p.s.i. test), minimum.
7. Choke assembly, beyond second valve from cross, may be positioned (Optional) outside of derrick foundation.
8. Spool or cross may be eliminated if connections are available in the lower part of the blow-out preventer body.
9. Plug valves - gate valves are optional. Valves shown as 2" are minimum size.
10. Casing head and casing head spool, including attached valves, to be furnished by Amoco.
11. Rams in preventers will be installed as follows:  

When drilling, use: Top Preventer - Drill pipe rams Bottom Preventer - Blind rams or master valve	When running casing, use: Top Preventer - Casing rams Bottom Preventer - Blind rams or master valve
---	---

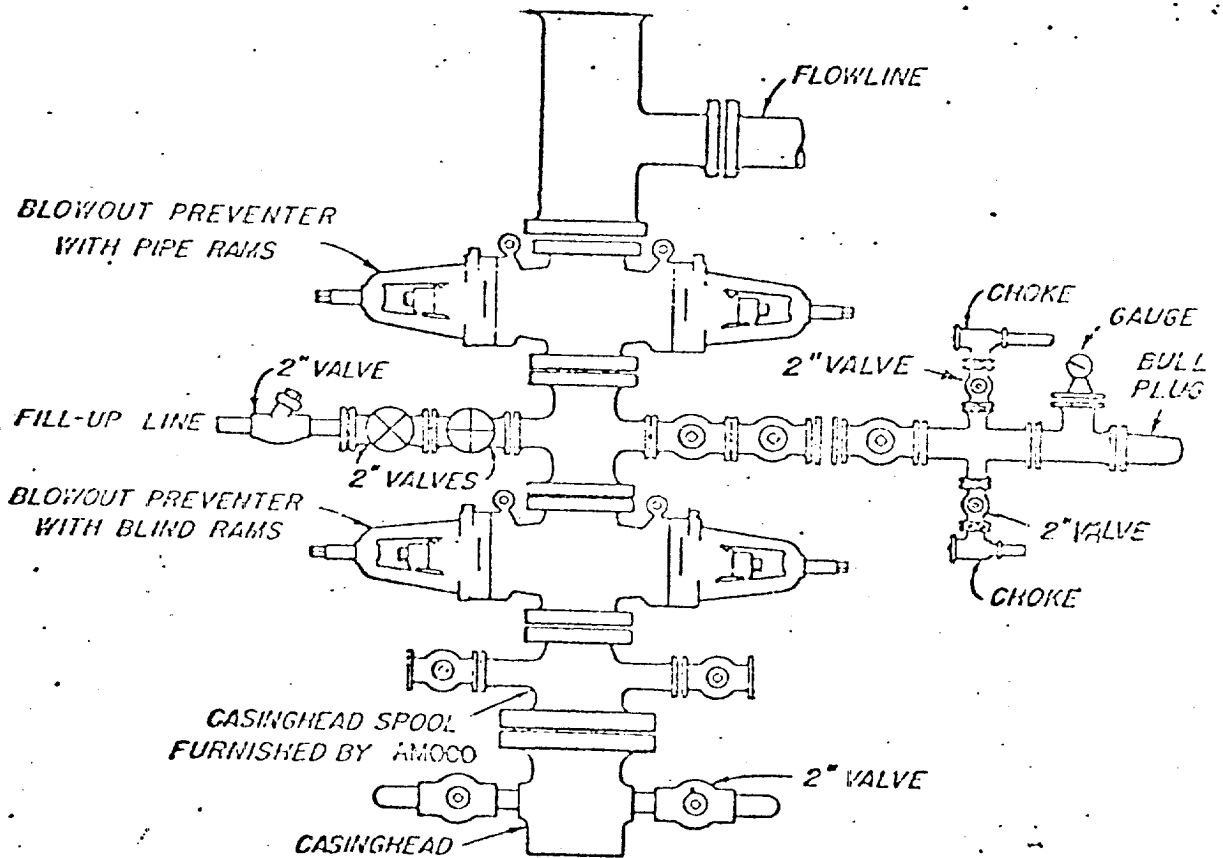

**BLOWOUT PREVENTER HOOK-UP**  
AMOCO PRODUCTION COMPANY

EXHIBIT D-1 MODIFIED

JUNE 1, 1962

RECEIVED  
JUN 20 1978  
THE CONGRESSIONAL COMMISSION  
ON THE M...

178