

N. M. P.
P. O.

30-025-26272

Form 3160-5
(June 1990)

UNITED STATES
DEPARTMENT OF THE INTERIOR
BUREAU OF LAND MANAGEMENT

FORM APPROVED
Budget Bureau No. 1004-0135
Expires: March 31, 1993

RECEIVED
AUG 5 11 07 AM '92

SUNDRY NOTICES AND REPORTS ON WELLS

Do not use this form for proposals to drill or to deepen or reentry to a different reservoir.
Use "APPLICATION FOR PERMIT—" for such proposals

5. Lease Designation and Serial No.
LC-064194

6. If Indian, Allottee or Tribe Name

7. If Unit or CA, Agreement Designation

SUBMIT IN TRIPLICATE

1. Type of Well
 Oil Well Gas Well Other *Re-entry*

8. Well Name and No.
Union Federal

2. Name of Operator
Snow Oil & Gas, Inc.

9. API Well No.
1

3. Address and Telephone No.
P.O. Box 1277, Andrews, Texas 79714 (915) 524-2371

10. Field and Pool, or Exploratory Area
Lea (Poma) Undersymulid

4. Location of Well (Footage, Sec., T., R., M., or Survey Description)
1980 FSL & 1980 FEL, Sec 9, T20S, R34E *Unit 3*

11. County or Parish, State
Lea Co., NM

12. CHECK APPROPRIATE BOX(S) TO INDICATE NATURE OF NOTICE, REPORT, OR OTHER DATA

TYPE OF SUBMISSION	TYPE OF ACTION
<input checked="" type="checkbox"/> Notice of Intent	<input type="checkbox"/> Abandonment
<input type="checkbox"/> Subsequent Report	<input type="checkbox"/> Recompletion
<input type="checkbox"/> Final Abandonment Notice	<input type="checkbox"/> Plugging Back
	<input type="checkbox"/> Casing Repair
	<input type="checkbox"/> Altering Casing
	<input checked="" type="checkbox"/> Other <i>Re-entry to recomplete well</i>
	make pressure maintenance well
	<input type="checkbox"/> Change of Plans
	<input type="checkbox"/> New Construction
	<input type="checkbox"/> Non-Routine Fracturing
	<input type="checkbox"/> Water Shut-Off
	<input type="checkbox"/> Conversion to Injection
	<input type="checkbox"/> Dispose Water

13. Describe Proposed or Completed Operations (Clearly state all pertinent details, and give pertinent dates, including estimated date of starting any proposed work. If well is directionally drilled, give subsurface locations and measured and true vertical depths for all markers and zones pertinent to this work.)*

Secretary's Petosh

- Level and top location, fix road.
- Set anchors for P.U. Dig out dry hole marker.
- Weld on well head to 9 5/8 csg, install B.O.P.
- R.U.C.U. & R.U. drill out CMT plugs to top of stub w/ 8 3/4" bit.
- Change bit stabilize BHA to drill into 5 1/2 stub w/ 3 3/4" bit.
- Pull out stabilizers RIH w/ 4 1/2" bit and CSG scraper for 5 1/2" csg.
- Drill & clean out hole to CIBP @ 7250' POOH.
- RIH w/ 5 1/2" PKR & test CIBP, perfs B @ 6852-6920 and 5 1/2" csg. Stub @ 4700'.
- If perfs @ 6852-6920, give up non-commercial fluid - set CIBP @ 6800'± on wire line if commercial set RBP @ 6800'.
- Perf 11 holes 5740-5750' Delaware. Spot acid, break down, and swab, acidize w/ 1000 gallons 15% NEFE.
- Evaluate zone, if needed frac zone.
- If commercial set pumping unit, put on production.
- ~~If not commercial, set injection packer @ 5580'. Corrosion inhibit annulus and place on injection.~~

Signed *Jim Snow* Title Engineer Date 8-3-92

(This space for Federal or State office use)
Approved by _____ Title _____ Date 8-26-92
Conditions of approval, if any:

Title 18 U.S.C. Section 1001, makes it a crime for any person knowingly and willfully to make to any department or agency of the United States any false, fictitious or fraudulent statements or representations as to any matter within its jurisdiction.

RECEIVED

6/15 2 8 1992

CCD HOBBS OFFICE

UNITED STATES
DEPARTMENT OF THE INTERIOR
BUREAU OF LAND MANAGEMENT

APPLICATION FOR PERMIT TO DRILL, DEEPEN, OR PLUG BACK

1a. TYPE OF WORK
DRILL DEEPEN PLUG BACK

b. TYPE OF WELL
OIL WELL GAS WELL OTHER SWD SINGLE ZONE MULTIPLE ZONE

2. NAME OF OPERATOR
Snow Oil & Gas, Inc.

3. ADDRESS OF OPERATOR
P.O. Box 1277, Andrews, Texas 79714

4. LOCATION OF WELL (Report location clearly and in accordance with any State requirements.)*
At surface
1980 FSL & 1930 FEL
At proposed prod. zone

14. DISTANCE IN MILES AND DIRECTION FROM NEAREST TOWN OR POST OFFICE*
25.5 miles West of Hobbs, NM

10. DISTANCE FROM PROPOSED* LOCATION TO NEAREST PROPERTY OR LEASE LINE, FT. (Also to nearest drlg. unit line, if any)
16. NO. OF ACRES IN LEASE
2000

18. DISTANCE FROM PROPOSED LOCATION* TO NEAREST WELL, DRILLING, COMPLETED, OR APPLIED FOR, ON THIS LEASE, FT.
19. PROPOSED DEPTH
7250

21. ELEVATIONS (Show whether DF, RT, GR, etc.)
3636.5 GR

23. PROPOSED CASING AND CEMENTING PROGRAM

SIZE OF HOLE	SIZE OF CASING	WEIGHT PER FOOT	SETTING DEPTH	QUANTITY OF CEMENT
17 1/2	13 3/8		857	725 SX CIRC
12 1/4	9 5/8	36#/40#	5215	2900 SX CIRC
8 3/4	5 1/2	17#/20#	13599	960 SX TOP @ 4750
TOP 4700				

Propose to re-enter this well to depth of 7250 and evaluate a possible producing zone @ 5700+ and or convert to salt water injection for pressure maintenance.

See Sundry notice.

Exhibits:

Surface plan
Drilling plan

IN ABOVE SPACE DESCRIBE PROPOSED PROGRAM: If proposal is to deepen or plug back, give data on present productive zone and proposed new productive zone. If proposal is to drill or deepen directionally, give pertinent data on subsurface locations and measured and true vertical depths. Give blowout preventer program, if any.

24. SIGNED Sam L. Snow TITLE Engineer DATE 8-3-92

(This space for Federal or State office use)

PERMIT NO. _____ APPROVAL DATE _____

APPROVED BY _____ TITLE _____ DATE _____

CONDITIONS OF APPROVAL, IF ANY:

*See Instructions On Reverse Side

RECEIVED
AUG 28 1992
JCD HOESS OFFICE

MEXICO OIL CONSERVATION COMMISSION
 LOCATION AND ACREAGE DEDICATION PLAT

Form 0-1
 Supersede. Ed.
 Effective 1-1-65

REVISED

REVISED

All distances must be from the outer boundaries of the Section

Operator Estoril Producing Corp.		Lease Union Federal		Well No. 1
Section J	Section 9	Range 20 South	Range 24 East	County Lea
1930 feet from the South		1930 feet from the East		Line
Depth over Flow 3636.5	Producing Formation Morrow	Pool Wildcat	Dedicated Acreage 160	

1. Outline the acreage dedicated to the subject well by colored pencil or hachure marks on the plat below.
2. If more than one lease is dedicated to the well, outline each and identify the ownership thereof (both as to working interest and royalty).
3. If more than one lease of different ownership is dedicated to the well, have the interests of all owners been consolidated by communitization, unitization, force-pooling, etc?

Yes No If answer is "yes," type of consolidation _____

If answer is "no," list the owners and tract descriptions which have actually been consolidated (Use reverse side of this form if necessary.) _____

No allowable will be assigned to the well until all interests have been consolidated (by communitization, unitization, forced-pooling, or otherwise) or until a non-standard unit, eliminating such interests, has been approved by the Commission.

RECEIVED
 FEB 9 1982

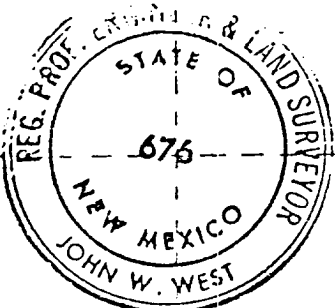
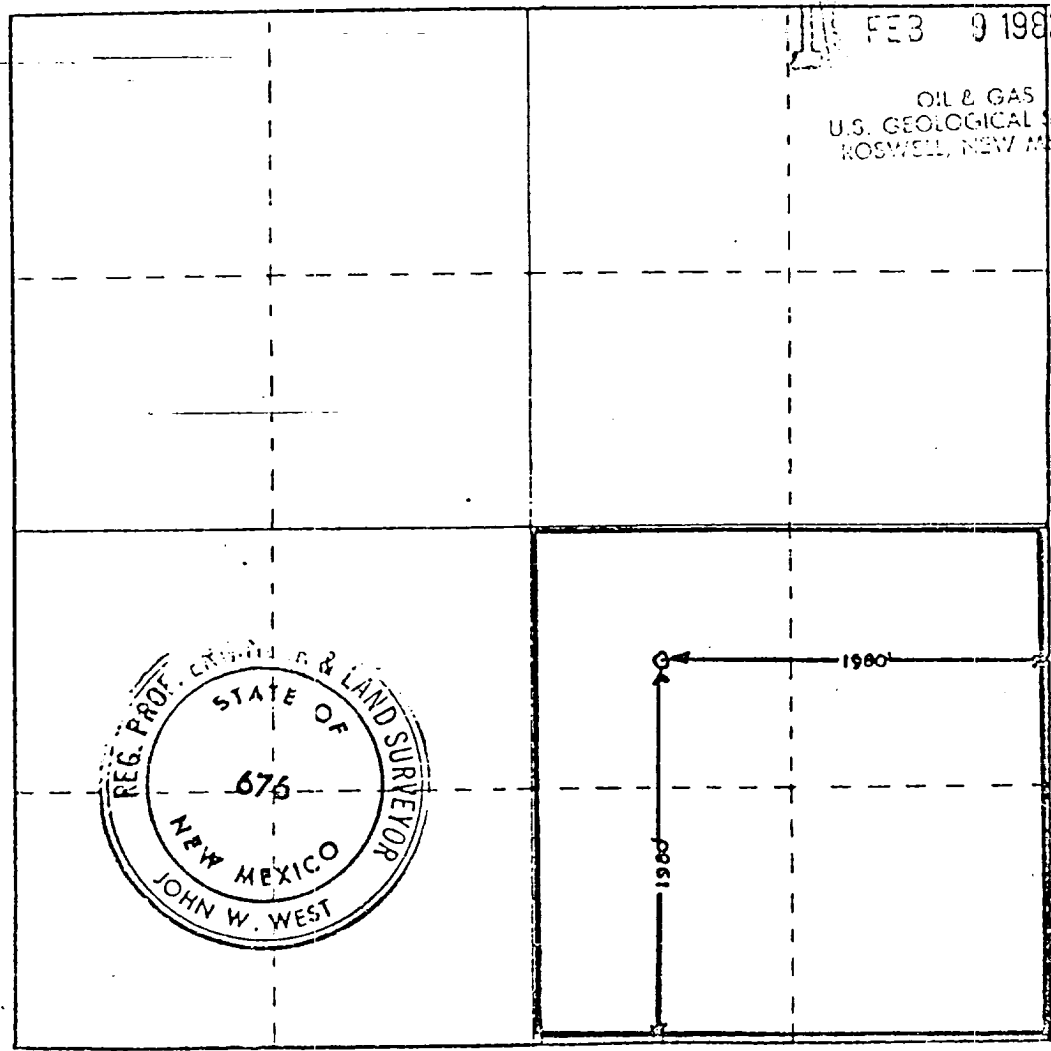

CERTIFICATION

I hereby certify that the information contained herein is true and complete to the best of my knowledge and belief.

Bruce C. Monroe
 Name
 Bruce C. Monroe
 Position
 Production Superintendent
 Company
 Estoril Producing Corp
 Date
 July 26, 1979

I hereby certify that the well location shown on this plat was plotted from field notes of actual surveys made by me or under my supervision, and that the same is true and correct to the best of my knowledge and belief.

Date Surveyed
 January 9, 1979

Registered Professional Engineer and/or Land Surveyor

John W. West
 Certificate No. John W. West 6

RECEIVED
AUG 28 1992
JCD HOBBS OFFICE

SNOW OIL & GAS, INC

BOP DIAGRAM

EXHIBIT

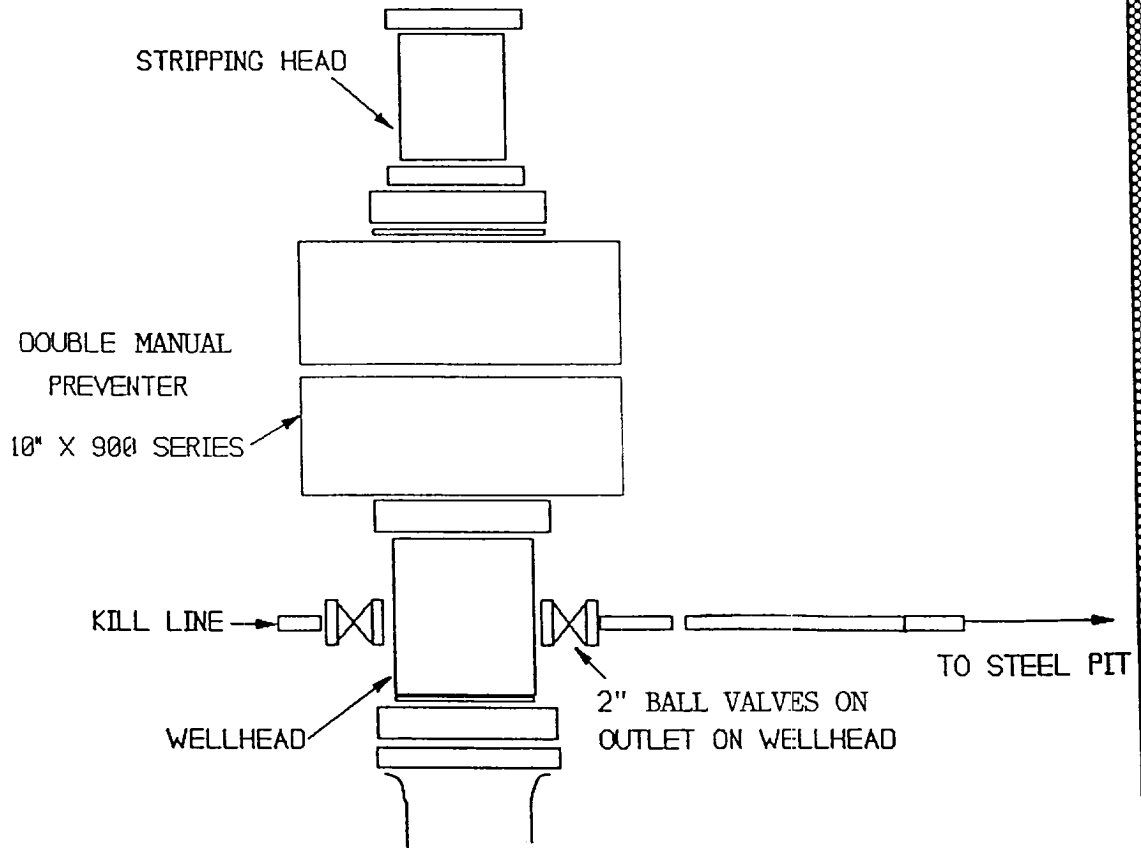

(3M)

RECEIVED
AUG 28 1992
OCD HOBBS OFFICE