

WALLEN PRODUCTION CO. - Bass # 2
SW/4, SE/4, SW/4, Sec. 21, T20S, R34E
LEA COUNTY, NEW MEXICO

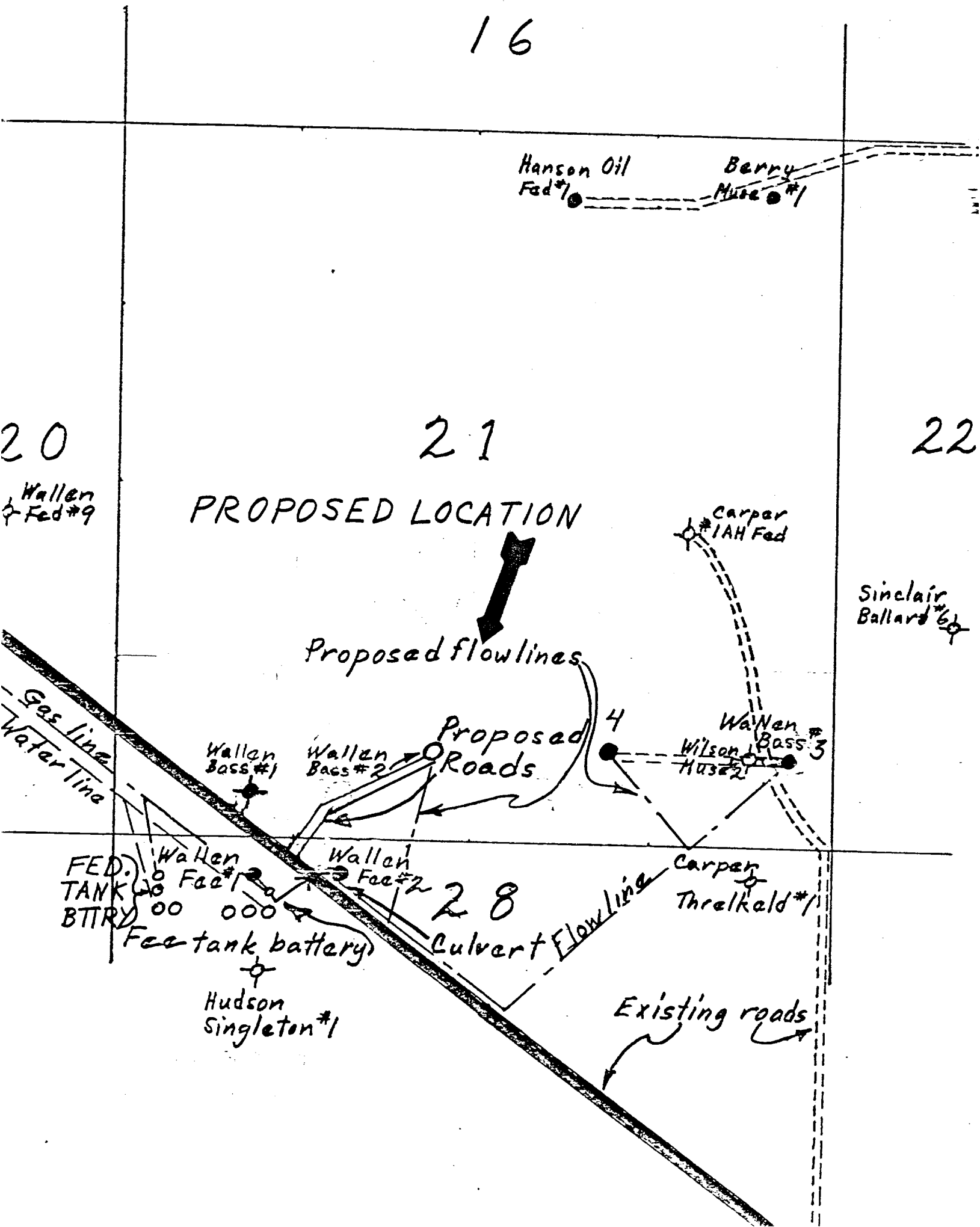

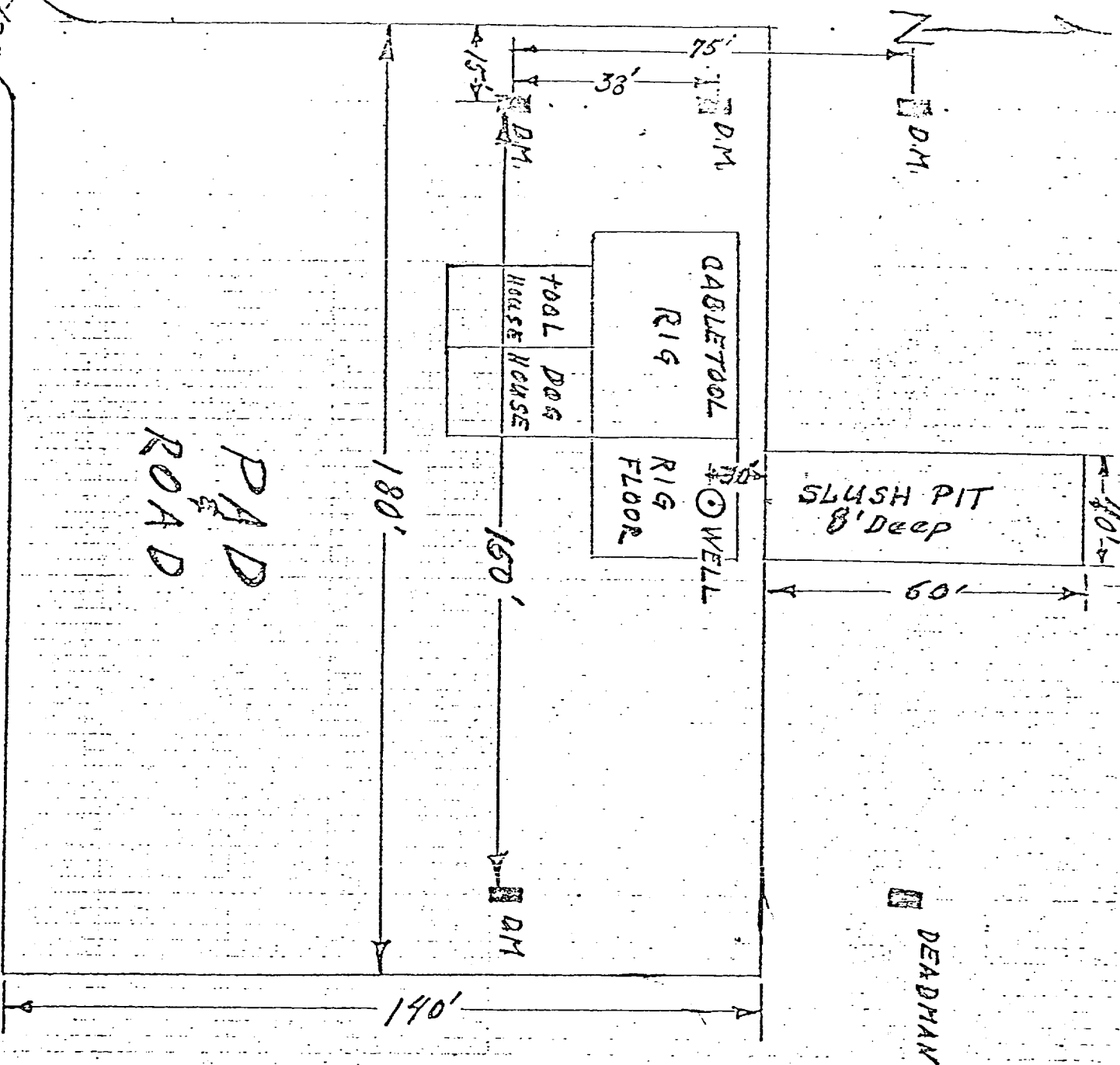

PAD
ROAD

SLUSH PIT
8' Deep

CABLE TOOL
RIG

RIG
FLOOR

TOOL
HOUSE

DOG
HOUSE

DEADMAN

CALLI CHE PAD ROAD
8" Mat Compacted

DEADMAN
7" Pipe, 6' Long &
6' Deep (or Umbrella 14")
1" = 30'

RECEIVED

AUG 31 1955

O.C.D. HOBBS, OFFICE