

30-025-26880

NEW MEXICO OIL CONSERVATION COMMISSION

Form C-101
Revised 1-1-65

NO. OF COPIES RECEIVED	
DISTRIBUTION	
SANTA FE	
FILE	
U.S.G.S.	
LAND OFFICE	
OPERATOR	

5A. Indicate Type of Lease
STATE FEE

5. State Oil & Gas Lease No.

APPLICATION FOR PERMIT TO DRILL, DEEPEN, OR PLUG BACK

1a. Type of Work
b. Type of Well
DRILL DEEPEN PLUG BACK
OIL WELL GAS WELL OTHER SINGLE ZONE MULTIPLE ZONE

7. Unit Agreement Name

8. Farm or Lease Name
McNeil

2. Name of Operator
Kenai Oil and Gas Inc.

9. Well No.
1

3. Address of Operator
Suite 1001 Petroleum Bldg, Midland, TX 79701

10. **UNDESIGNATED**
Nadine Drinkard-Abo

4. Location of Well
UNIT LETTER A LOCATED 660 FEET FROM THE north LINE
AND 660 FEET FROM THE east LINE OF SEC. 27 TWP. 19S RGE. 38E NMPM

12. County
Lea

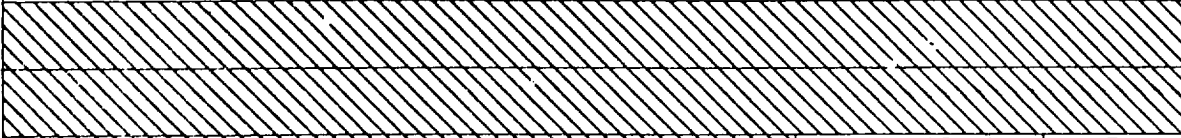

19. Proposed Depth 7800'	19A. Formation Drinkard-Abo	20. Rotary or C.T. Rotary
21. Elevations (Show whether DF, RT, etc.) 3589.0' GL	21A. Kind & Status Plug. Bond Blanket	21B. Drilling Contractor Kenai Drilling Of Tex.
		22. Approx. Date Work will start 7-1-80

23. PROPOSED CASING AND CEMENT PROGRAM

SIZE OF HOLE	SIZE OF CASING	WEIGHT PER FOOT	SETTING DEPTH	SACKS OF CEMENT	EST. TOP
12-1/4"	10-3/4"	40.50#	380'	400	Surface
9-7/8"	7-5/8"	29.70#	4300'	1620	Surface or overlap
6-1/2"	4-1/2"	11.60#	7800'	500	4100'

DRILLING PROGRAM

- Spud 12-1/4" hole and drill to 380', set 10-3/4" csg @ 380', cmt w/400 sx, more if needed, to cmt to surface.
- Drill 9-7/8" hole to 4300', set 7-5/8" csg @ 4300', cmt w/1320 sx, more if needed to cmt to surface. Test BOP and csg to 1000# psi.
- Drill 6-1/2" hole to approx 7800" using mud as hole condition requires.
- If well proves commercial run 4-1/2" csg and cmt w/500 sx or sufficient amount to overlap.
- 10" Series 900 BOP will be used.

APPROVAL VALID FOR 90 DAYS
PERMIT EXPIRES 9-22-80
UNLESS DRILLING UNDERWAY

IN ABOVE SPACE DESCRIBE PROPOSED PROGRAM: IF PROPOSAL IS TO DEEPEN OR PLUG BACK, GIVE DATA ON PRESENT PRODUCTIVE ZONE AND PROPOSED NEW PRODUCTIVE ZONE. GIVE BLOWOUT PREVENTER PROGRAM, IF ANY.

I hereby certify that the information above is true and complete to the best of my knowledge and belief.
Signed Lorraine Maroney Title Drig & Prod Assistant Date 6-17-80

(This space for State Use)
APPROVED BY [Signature] TITLE SUPERVISOR DISTRICT DATE JUN 23 1980

CONDITIONS OF APPROVAL, IF ANY:

NEW MEXICO OIL CONSERVATION COMMISSION
WELL LOCATION AND ACREAGE DEDICATION PLAT

Form C-102
Supersedes C-128
Effective 1-1-65

All distances must be from the outer boundaries of the Section.

Operator Kenai Oil & Gas, Inc.,		Lease McNeil		Well No. 1
Grid Letter A	Section 27	Township 19 South	Range 38 East	County Lea
Actual Footage Location of Well:				
660 feet from the North line and		660 feet from the East line		
Ground Level Elev. 3589.0	Producing Formation Drinkard-Abo	Pool Nadine	Dedicated Acreage: 40 Acres	

1. Outline the acreage dedicated to the subject well by colored pencil or hachure marks on the plat below.
2. If more than one lease is dedicated to the well, outline each and identify the ownership thereof (both as to working interest and royalty).
3. If more than one lease of different ownership is dedicated to the well, have the interests of all owners been consolidated by communitization, unitization, force-pooling, etc?

Yes No If answer is "yes," type of consolidation _____

If answer is "no," list the owners and tract descriptions which have actually been consolidated. (Use reverse side of this form if necessary.) _____

No allowable will be assigned to the well until all interests have been consolidated (by communitization, unitization, forced-pooling, or otherwise) or until a non-standard unit, eliminating such interests, has been approved by the Commission.

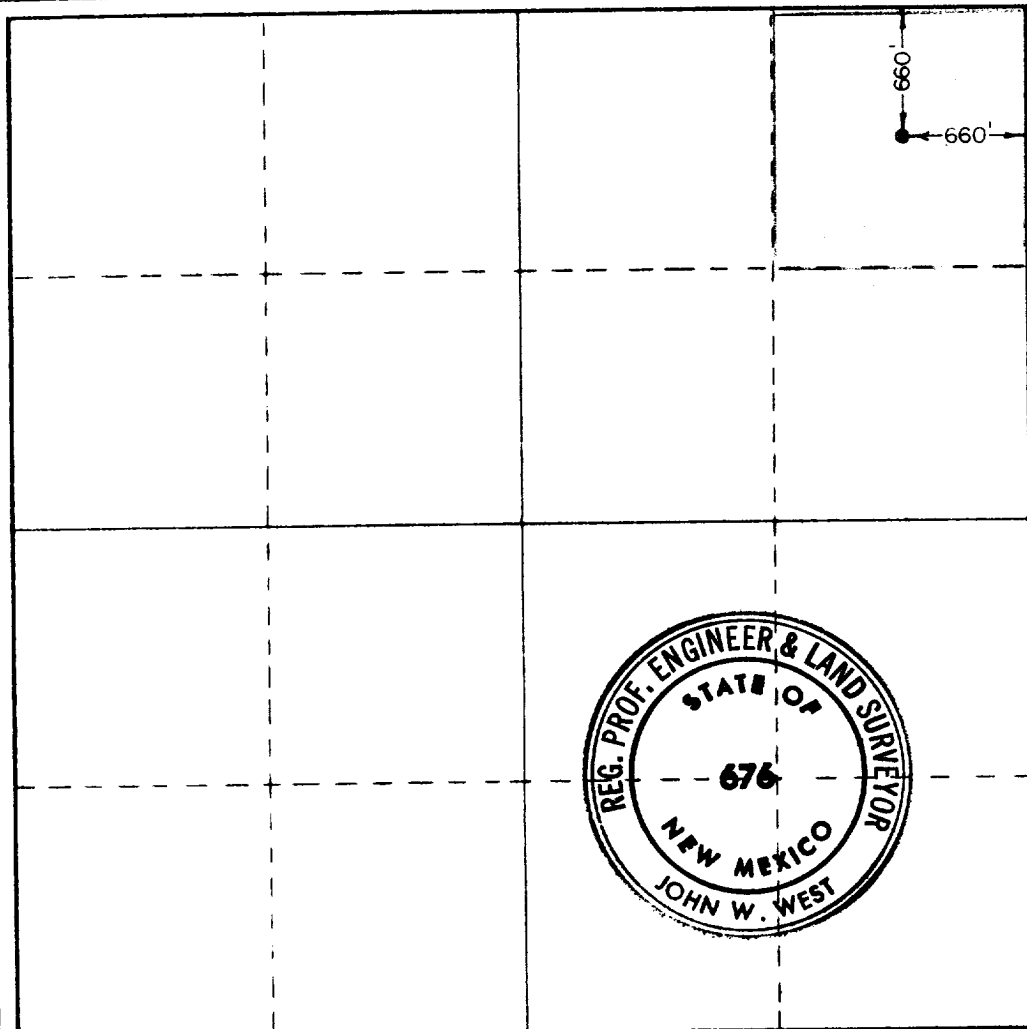

CERTIFICATION

I hereby certify that the information contained herein is true and complete to the best of my knowledge and belief.

Lorraine Maroney

Name
Lorraine Maroney
Position
Drilg & Prod Assistant
Company
Kenai Oil and Gas Inc.

Date
6-17-80

I hereby certify that the well location shown on this plat was plotted from field notes of actual surveys made by me or under my supervision, and that the same is true and correct to the best of my knowledge and belief.

Date Surveyed
June 12, 1980

Registered Professional Engineer and/or Land Surveyor

John W. West
Certificate No. **JOHN W. WEST 676**
PATRICK A. ROMERO 6665
Ronald J. Eidson 3239

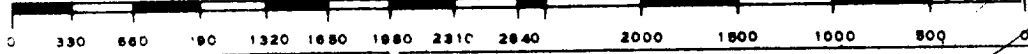

RECEIVED
JUN 18 1980
OIL CONSERVATION DIV

RECEIVED
JUN 23 1980
OIL CONSERVATION DIV.

FILE